

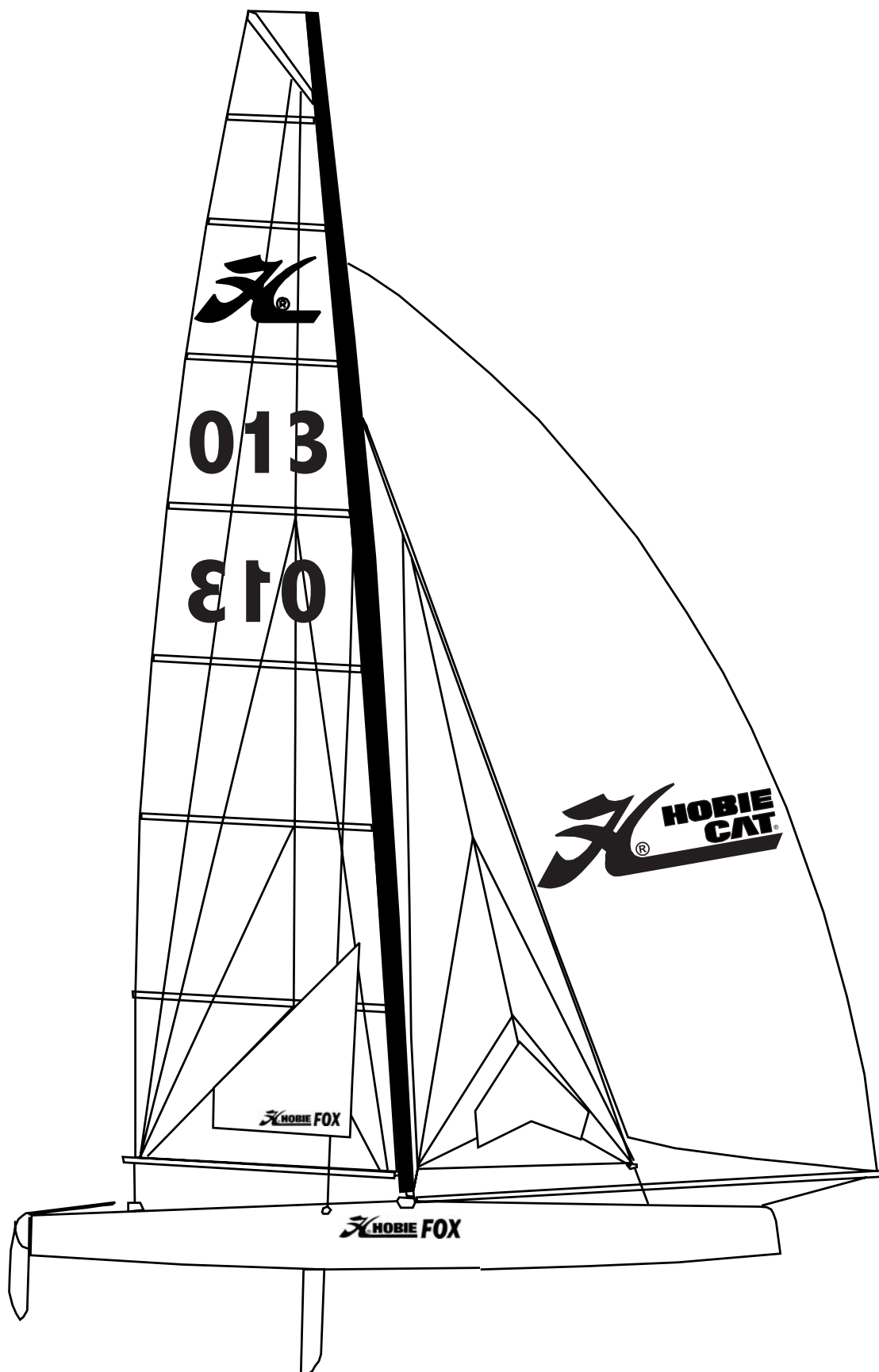

HOBIE FOX



Hobie FOX

Coque/Hull/Rumpf

G/L/L=20556005 - D/R/R =20556015

20560500 : Jeux de câbles/Cable set/Käbelsatz
 20570400 : Sac de cordages/Rope bag/Leinensatz
 20580300 : Sac accastillage/Rig bag/Takelagesack

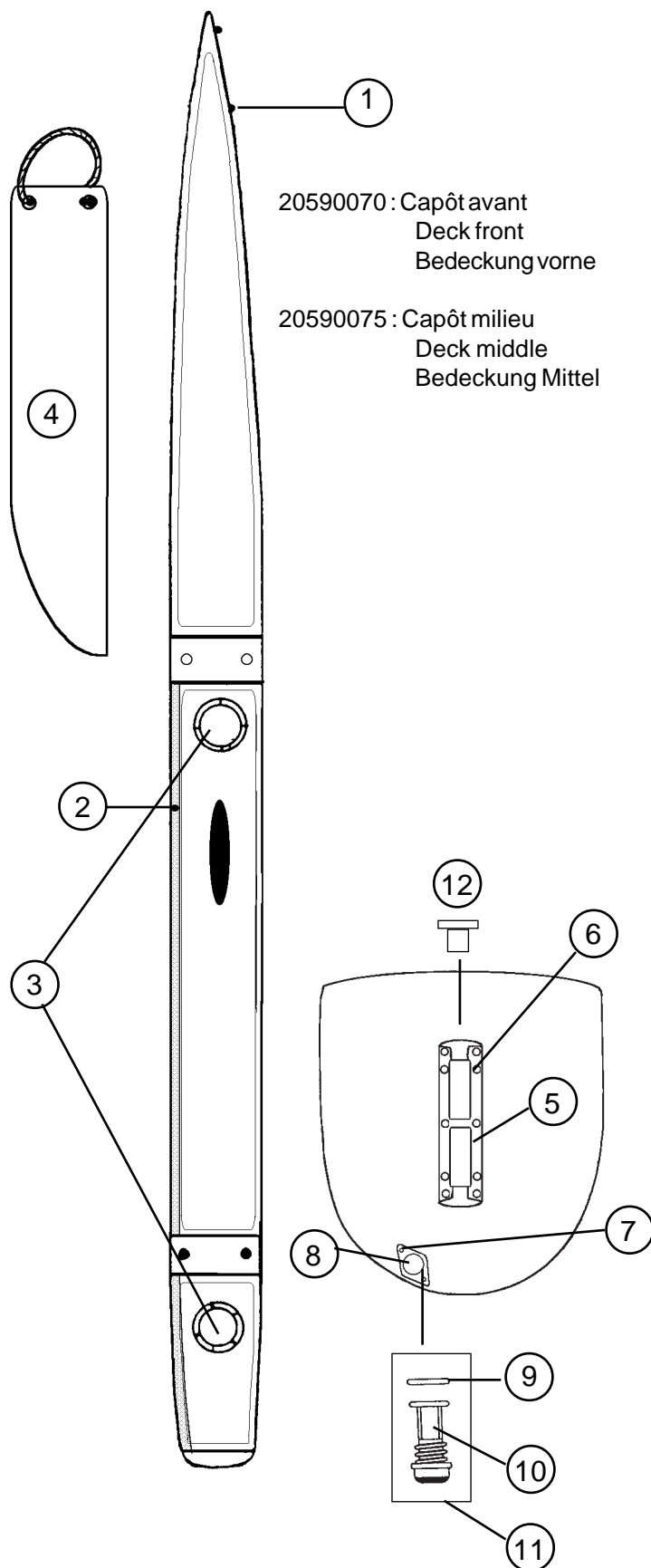

AUTOCOLLANTS COQUES/HULL STICKERS/ RUMPF-AUFKLEBER

99056045 : Hobie noir/black/schwarz
 20556520 : "Fox" Rouge/red/rot
 99056039 : Logo "H" 150 mm

- 1 - 20560300 (G) : Platine de bride
 20560305 (D) Bow plate
 Hahnpot Platte
- 2 - 21056028 : Vis cadène
 Anchor pin
 Schraube für Püttingeisen
- 3 - 18056033 : Trappe de visite
 Inspection port
 Luckendeckel
- 4 - 20550905 : Dérive sabre Fox
 Fox daggerboard
 Steckschwert 18 Tiger/Fox
- 5 - 18056005 : Fémelot
 Gudgeon
 Heckbeschlag
- 6 - 99220855 : Vis TC fémelot
 (x10) Screw TC gudgeon
 Schraube TC Heckbeschlag
- 7 - 99220845 : Vis TF Bouchon
 (x10) Screw TF plug
 Ablassplatte-Schraube
- 8 - 99056012 : Platine bouchon vidange
 Drain housing
 Platine f. Ablassschraube
- 9 - 99220048 : Joint bouchon vidange
 (x10) Drain plug gasket
 Dichtung Ablassschraube
- 10 - 99056232 : Bouchon vidange
 (x10) Drain plug
 Ablassschraube
- 11 - 99220043 : Joint + bouchon
 (x10) Gasket + drain plug
 Dichtung + Ablassschraube
- 12 - 99220128 : Entretoise
 (x10) Plastic bushing

99506060 : kit cale derive/Daggerboard holder

- 99501200 Cale dérive/holder (4 pcs)
- 99056285 Passant sangle plastique/Fixing plate (4 pcs)
- 99220078 Vis/Screw 4,8x38 (8 pcs)

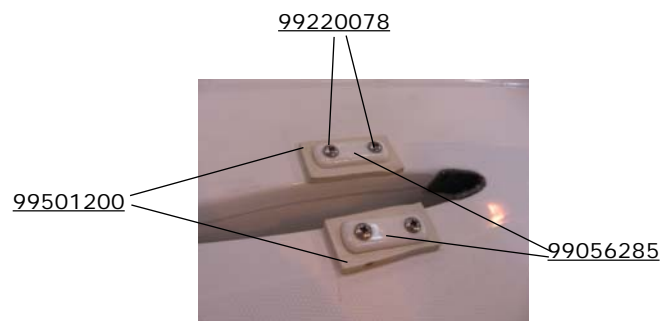

Gouvernail droit complet/Rudder assy right complet
 Ruderanlage komplett rechts :
 20562110 = blanc/white/weiss - 20562125 = carbone
 Gouvernail gauche complet/Rudder assy compl. left
 Ruderanlage komplett links :
 20562100 = blanc/white/weiss - 20562120 = carbone

Hobie FOX

Safran/Rudder/Ruderblatt

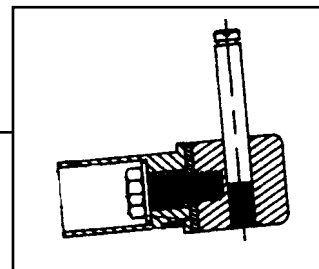
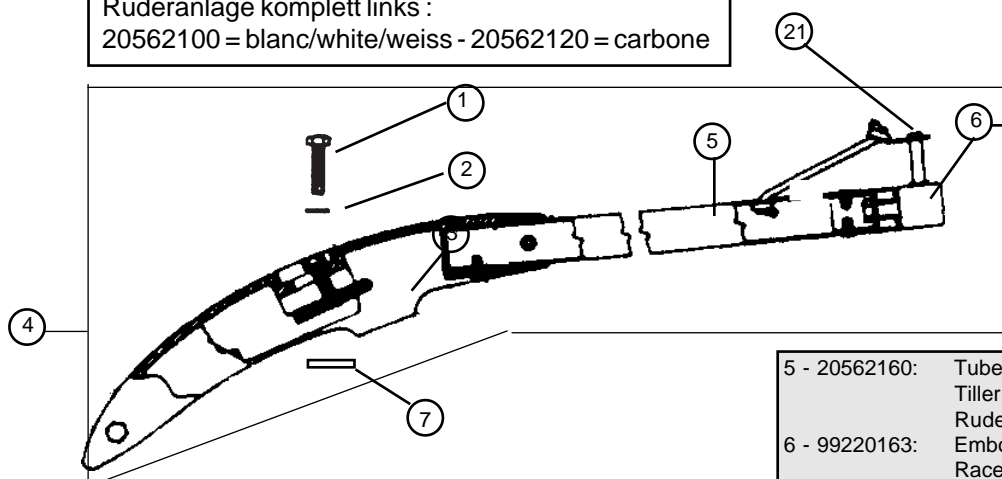

- | | |
|---------------|---------------------------|
| 1 - 99220930: | Vis TH 8x30 casting |
| (x10) | Cast.bolt |
| 2 - 99220750: | Rondelle Guît. |
| (x10) | Washer |
| 3 - 17000010: | Casting supérieur Gouv. |
| | Upper rudder casting |
| 4 - 20562155: | Bras gouv.droit complet |
| | Tiller arm right complete |
| | Ruderarm rechts komplett |
| 20562150: | Bras gouv.gauche complet |
| | Tiller arm left complete |
| | Ruderarm links komplett |

- | | |
|----------------|------------------------|
| 5 - 20562160: | Tube de Gouvernail |
| | Tiller tube |
| 6 - 99220163: | Embout gouvernail Race |
| | Race tiller end cap |
| 7 - 14061122: | Platine dural |
| | Cam stop plate |
| 8 - 14061183: | Came safran |
| (x10) | Plastic cam |
| 9 - 16041756: | Goupille élastique |
| (x10) | Maststep pin |
| 10- 99502270 : | Lame safran Race |
| | Rudder blade Race |
| 11- 99220880: | Vis safran 8x60 |
| (x10) | Rudder bolt |
| | Schraube Ruderblatt |

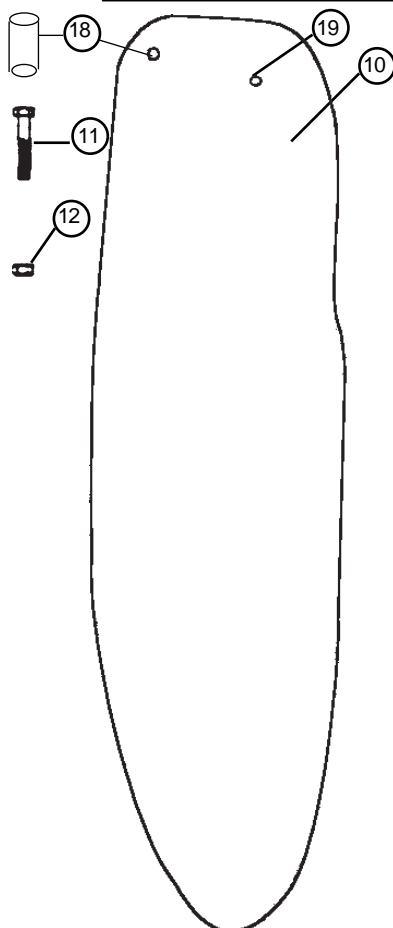

- | | |
|----------------|-------------------------------|
| 12- 99056239: | Ecrou Nylstop |
| (x10) | Nylstop nut |
| 13- 18000155: | Selbstsichernde Mutter |
| | Casting inf. gouv |
| 14- 21080335 | Lower rudder casting |
| (inox) | Unteres Rudergehäuse |
| 15- 14061106: | Aiguillot + goupille |
| (x10) | Rudder pin + cotter pin |
| 16- 99220685: | Ruderbolzen + Splint |
| (x10) | |
| 17- 99220825: | Pene safran |
| (x10) | Plunger |
| 18- 99502130: | Gegenstück Rudernock |
| | |
| 19- 14041711: | Ressort inox |
| | Spring |
| 20- 17062680 : | Feder |
| | |
| | Vis safran delrin |
| | Tension screw |
| | Druckschraube |
| | Insert lame safran |
| | Sheave pin rudder blade |
| | Bolzen Ruderblatt |
| | Axe tête de mât |
| | Mastkopf Achse |
| | Casting inférieur monté |
| | Unteres Rudergehäuse montiert |

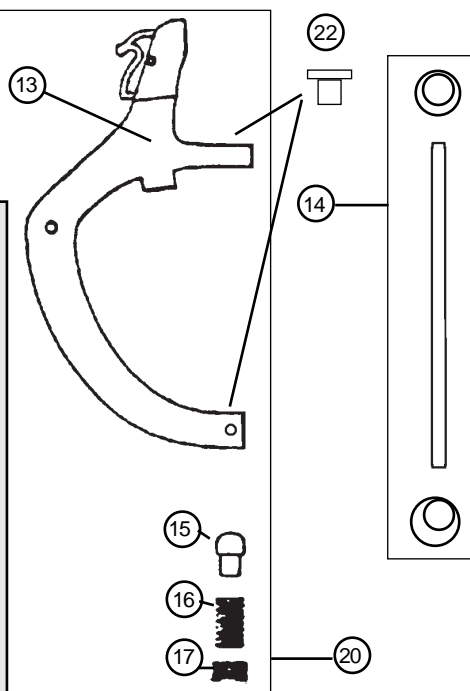

- | | |
|-----------------|-----------------|
| 21- 99220169 : | Clip rapide |
| (x2) | Retainer clip |
| 22 - 99220128 : | Sicherungsclip |
| (x10) | Entretoise |
| | Plastic Bushing |
| | Nylon Buchse |

Hobie FOX

Etai & drisse de foc/Forestay and jib halyard Vorstag und Fockfall

- | | |
|----------------|---|
| 1 - 20560520 : | Etai câble sans pivot
Forestay wire w/o swivel
Vorstagkabel o. Wirbel |
| 2 - 99500480 : | Emerillon enrouleur
Forestay Swivel
FockvorstagWirbel |
| 3 - 20560530 : | Estrope
Pigtail
Pigtail |

- | | |
|----------------|---|
| 6 - 99220660 : | Manille lyre 4 mm
Shackle 4 mm
Schäkel 4 mm |
|----------------|---|

- | | |
|-----------------|---|
| 11 - 99056230 : | Axe percé latte ridoire
Clevis pin
Bolzen f. Locheisen geb. |
| 12 - 99220230 : | Anneau brisé
Split ring
Ringsplint |

- | | |
|----------------|--|
| 99056249 : | Manchon D4
Sleeve
Hülse |
| 4 - 99500474 : | Poulie drisse de foc
Jib halyard block assy
Fockfallumlenk-Block |
| 5 - 20560550 : | Drisse cable de foc
Jib halyard wire
Fockfall Kabel |

- | | |
|-----------------|--|
| 7 - 18080100 : | Poulie drisse de foc
Jib halyard block
Fockfallblock |
| 8 - 99500481 : | Enrouleur de foc
Jib furler
Fockwickler |
| 9 - 20560580 : | Bride
Bridle
Hahnepot |
| 10 - 99220355 : | Latte ridoire
Stay adjuster
Wantenspanner |

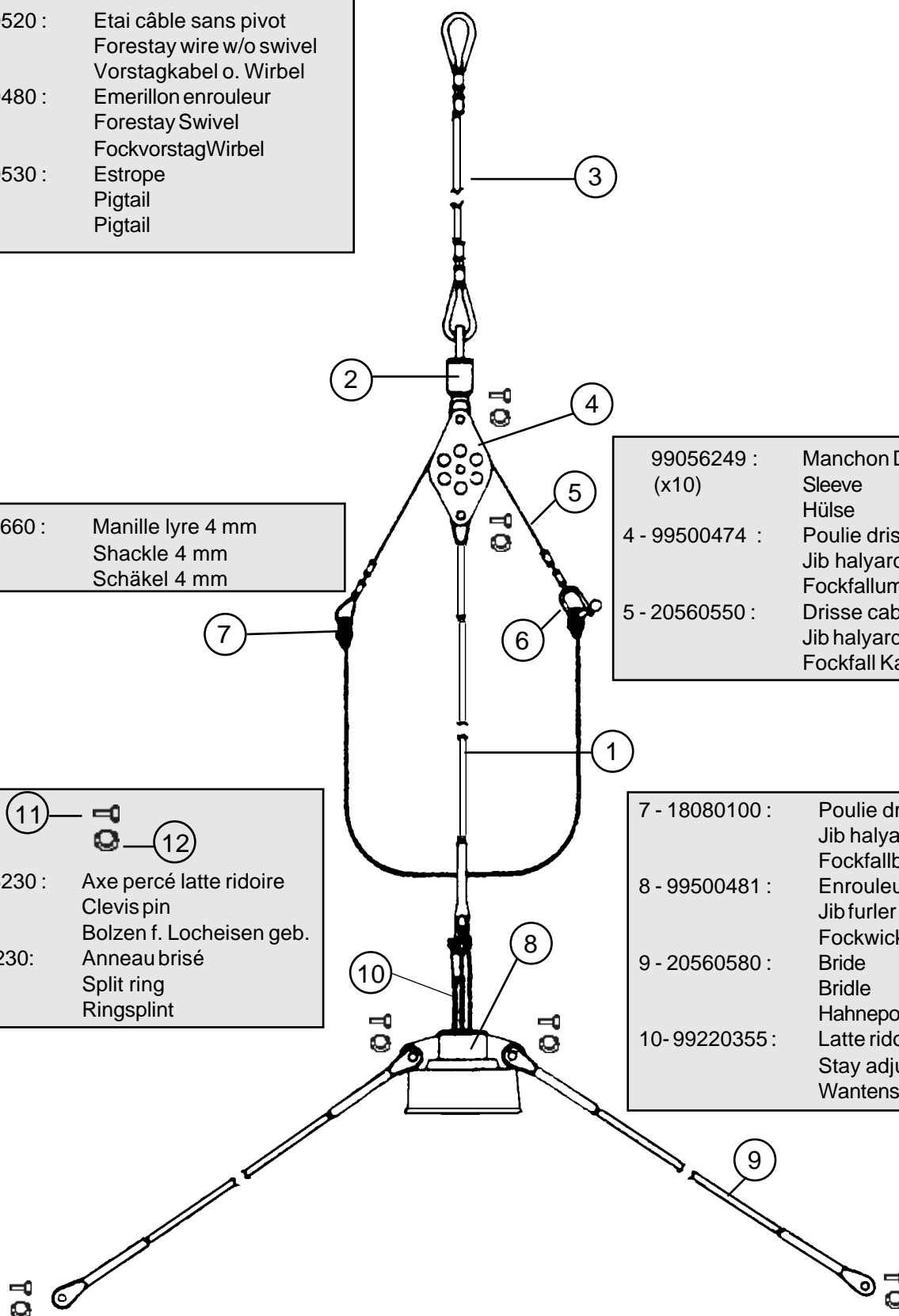

Hobie FOX

Trapèze équipier/Trapeze crew /Trapez Crew

1- 20560560 :	Cable trapeze Trapez wire Trapezkabel
2- 16080552:	Poignée Trapèze Trapeze handle Trapezgriff
3 - 99300126 : (x10)	Manchon Sleeve Hülse
4 - 99300058 : (x10)	Cosse Thimble Kausch
5 - 99500365 :	Taquet de trapeze noir Trapeze Cleat black Trapezklemme schwarz
6 - 99500105 :	Poulie ringot Becket block Block

20560565 :	Kit trapèze (2) Trapeze Kit (2) Trapezsatz (2)
------------	--

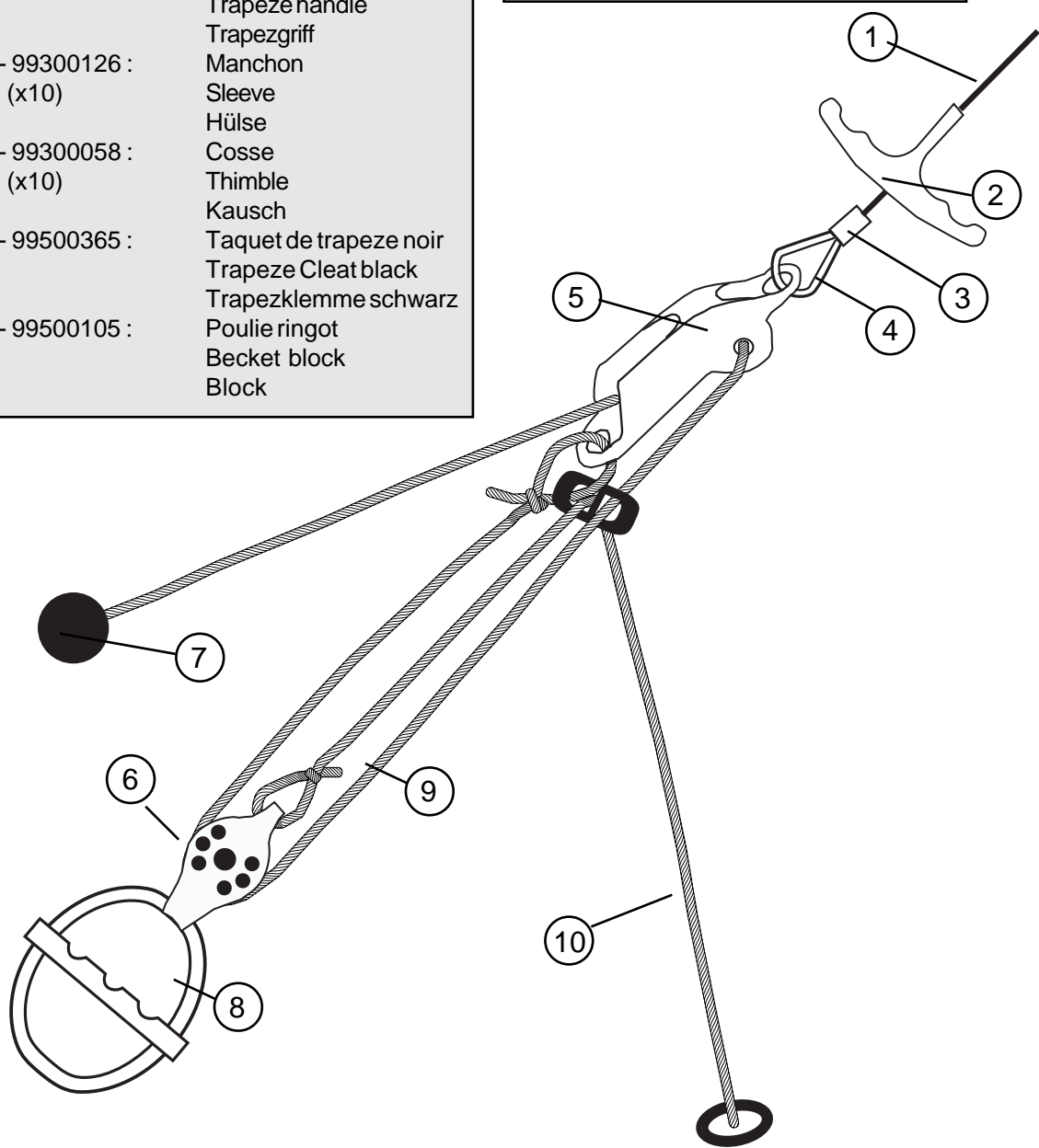

7 - 99500290 : (x5)	Boule d'arrêt Stop ball Kugelstopper
8 - 99500031 : (x10)	Poignée J&H Handle J&H Griff J&H
9- 18060413 :	Cordage de trapèze Trapeze line Trapezleine
10- 20580500:	Sandow trapèze Trapez shock cord Gummistrop Trapez

Hobie FOX

Trapèze barreur/Trapeze skipper/Trapez skipper

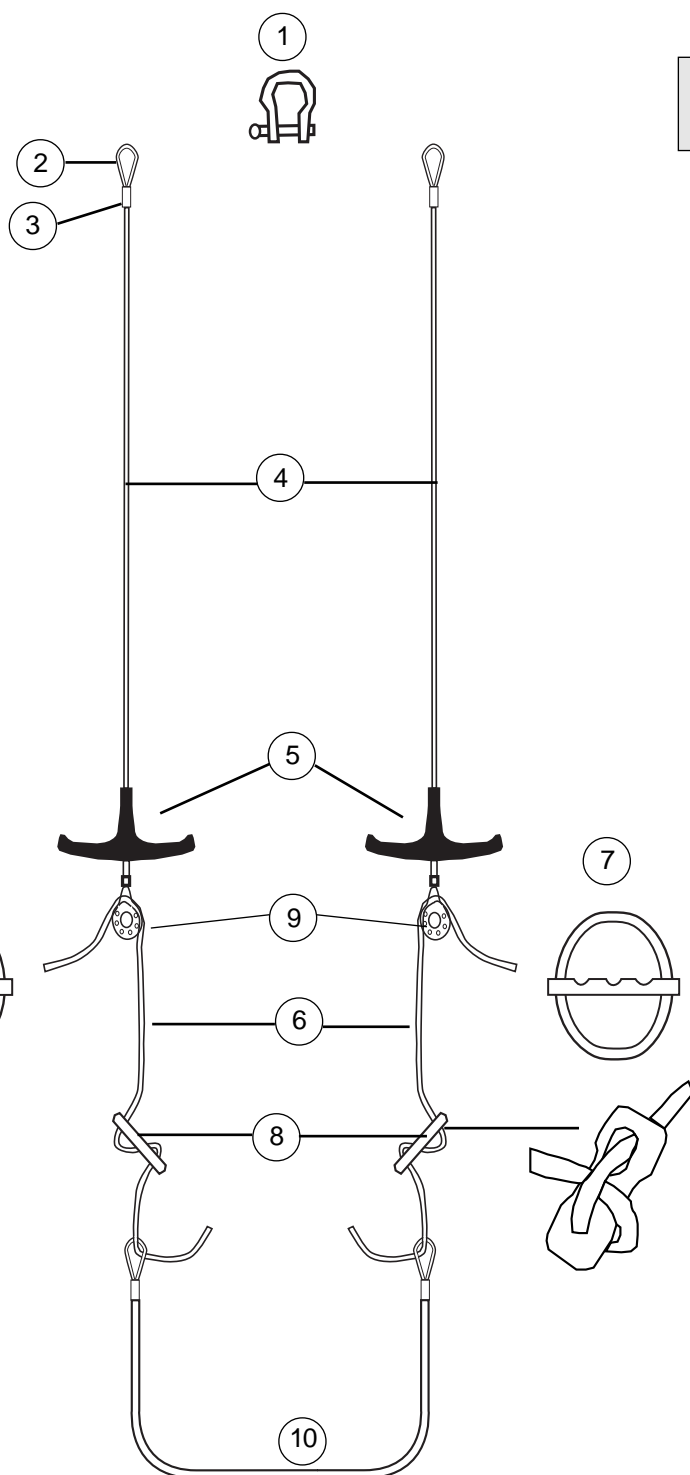

TRAPEZE KIT SKIPPER : 20560575

- | | |
|----------------|--|
| 1 - 99220665 : | Manille Lyre 6 mm
Shackle 6 mm
Schäkel 6 mm |
| 2 - 99300058: | Cosse
Thimble
Kausch |
| 3 - 99300126: | Manchon
Sleeve
Hülse |
| 4 - 20560570: | Cable trapeze
Trapez wire
Trapezkabel |
| 5 - 16080552: | Poignée Trapèze
Trapeze handle
Trapezgriff |
| 6 - 18060413: | Cordage de réglage
Trapeze line
Trapezleine |
| 7 - 99500031: | Poignée J&H
Handle J&H
Griff J&H |
| 8 - 18060314: | Double anneau
Rope lock |
| 18060312 (x20) | Trapezstopper |
| 9 - 17070150 : | Poulie
Block
Block |
| 10-20580500: | Sandow de trapèze
Trapeze shock cord
Gummistrop Trapez |

Hobie FOX

Haubans/Shrouds/Wanten

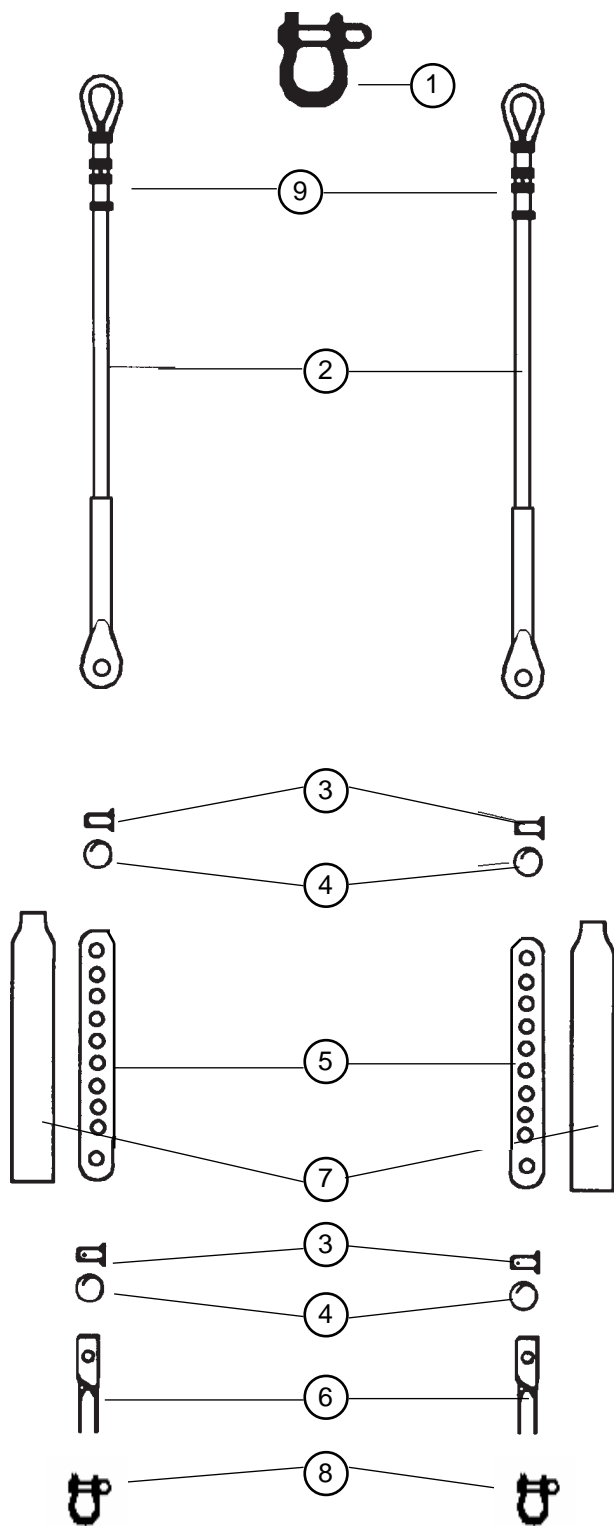

- | | |
|----------------------|--|
| 1- 99220210 (x10): | Manille Lyre 8 mm
Bow shackle
Mastschäkel |
| 2- 20560510: | Hauban
Shroud
Want |
| 3- 99056230 (x10): | Axe percé latte ridoir
Clevis pin
Bolzen für Wanteisen |
| 4- 99220230 (x10) | Anneau brisé
Split ring
Ringsplint |
| 5- 99220650 (x5): | Latte ridoir universelle
Stay adjuster
Wantenspanner |
| 6- 16060313 (x10): | Chape de hauban
Toggle
Wanten Wirbel |
| 7- 99500369 (x10): | Protège latte ridoire
Shroud adjuster cover
Wantenschutz |
| 8 - 99220665 (x10) : | Manille lyre 6 mm
Bow shackle 6 mm
Schäkel 6 mm |
| 9 - 99056249 (x10): | Manchon D4
Sleeve
Hülse |

Hobie FOX

Traverse avant/Front crossbar/Vorderholm
20562500 (avant/prior/vor 2003)
20562510 (2003)

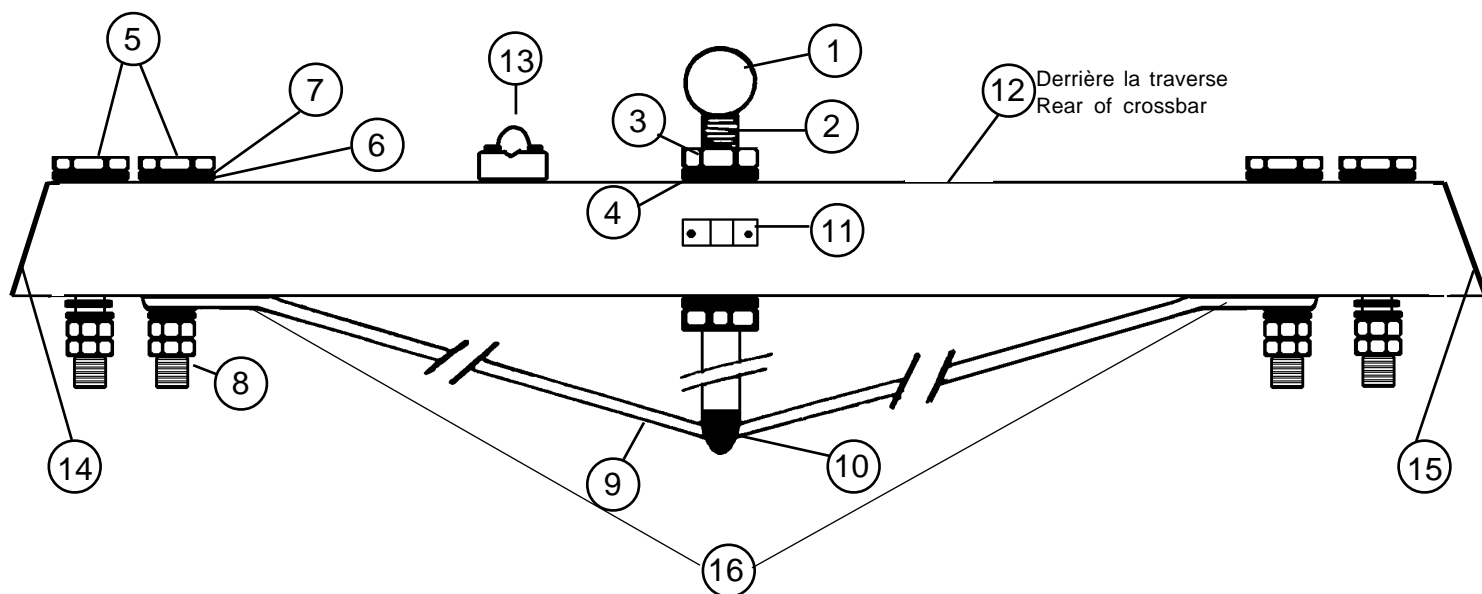

1 - 21062673 :	Emplanture de mât Mast step ball Mastfußkugel
2 - 18062680 :	Etau de martingale Dolphin striker post Unterzug gebohrt
3 - 99220104 :	Ecrou HU D16 Nut HU D16 Mutter HU D16
4 - 99220735 :	Rondelle D16 (x10) Washer D16 Unterlegscheibe D16
5 - 99220337 :	Vis TH 10 x 160 x 50 Screw TH Schraube TH
6 - 99220730 :	Rondelle D10 (x10) Washer D10 Unterlegscheibe D10
7 - 99220710 :	Rondelle D10.2 nylon (x10) Nylon washer D10.2 Nylon Unterlegscheibe D10.2
8 - 99220607 :	Ecrou HU D10 (x10) Nut HU D10 Mutter HU D10
9 - 20562700 :	Martingale Fox Dolphinstriker Fox Unterzug Fox

10 - 21000010 :	Support étau de martingale striker bar fastening Unterzug Fuß
11 - 16056025 :	Articulation inox tangon Spi pole articulation inox Verbindung Spibaum inox
12 - 99500415 :	Taquet enrouleur (derrière la traverse) Furler cleat (on rear of beam) Wicklerklemme (hinten)
13 - 99500350 :	Tourelle Taquet Swivel Camcleat Drehklemme
18580060 :	Glissière de foc droite Jib swivel cleat slider right Fockdrehklemmegleit rechts
18580055 :	Glissière de foc gauche Jib swivel cleat slider left Fockdrehklemmegleit links
14 - 18062742 :	Bouchon traverse AV droit Beam cap front right Vorderholmendstück vorne rechts
15 - 18062741 :	Bouchon traverse AV gauche Beam cap front left Vorderholmendstück vorne links
16 - 99220057 :	Pontet forgé D5 Eye Strap Guseisenbeschlag

Hobie FOX
 Traverse arrière/Rear crossbar
 Achterholm
 20562600 (avant/prior/vor 2003)
 20562610 (2003)

- | | |
|----------------------|---|
| 1 - 99220337 : | Vis TH 10 x 160 x 50
Crossbar bolt
Holmbolzen |
| 2 - 99220730 (x10) : | Rondelle D10
Washer D10
Unterlegscheibe D10 |
| 3 - 99220710 (x10) : | Rondelle D10.2 nylon
Nylon washer D10.2
Nylon Unterlegscheibe D10.2 |
| 4 - 99220607 (x10) : | Ecrou HU D10
Nut HU D10
Mutter HU D10 |
| 5 - 18062744 : | Bouchon traverse AR droit
Beam end cap rear right
Achterholmendstück hint. rechts |
| 6 - 18062743 : | Bouchon traverse AR gauche
Beam end cap rear left
Achterholmendstück hint. links |

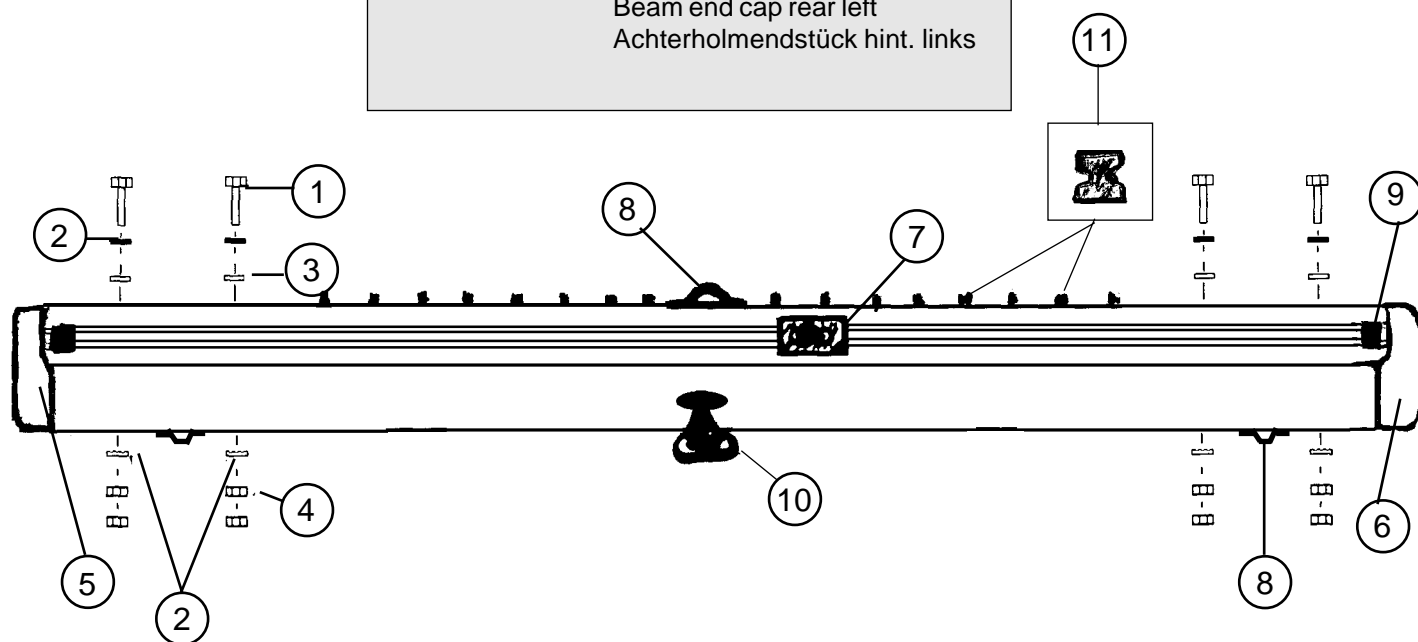

- | | |
|----------------|---|
| 7 - 99500255 : | Chariot de grand-voile
Traveller car
Großtraveller |
| 8 - 99220057 : | Pontet forgé D5
Eye strap
Guseisenbeschlag |
| 9 - 21062521 : | Embout rail d'écoute grand voile
Traveller track end stop
Travellerschiene Endstück |

- | | |
|-----------------------|--|
| 10 - 99500467 : | Tourelle taquet carbo |
| 99500350 (old) | Swivel camcleat
Drehklemme |
| 11 - 99500700 (x16) : | Boutons de laçage trampoline
Trampoline lacing post
Trampolineleinenlenkstop |
| 99216040 : | Rivet
Rivet
Popniete |

20512800 BOME Fox COMPLETE
COMPLETE BOOM Fox
BAUMKOMPLETT Fox

Hobie Fox Bôme/Boom/Baum 2002

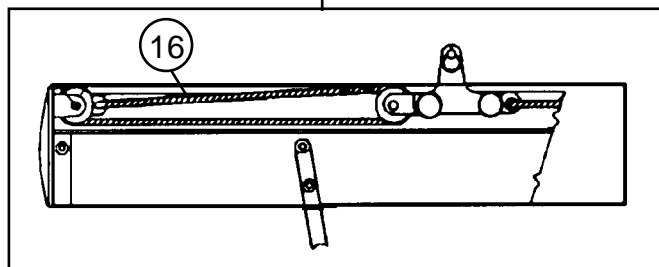
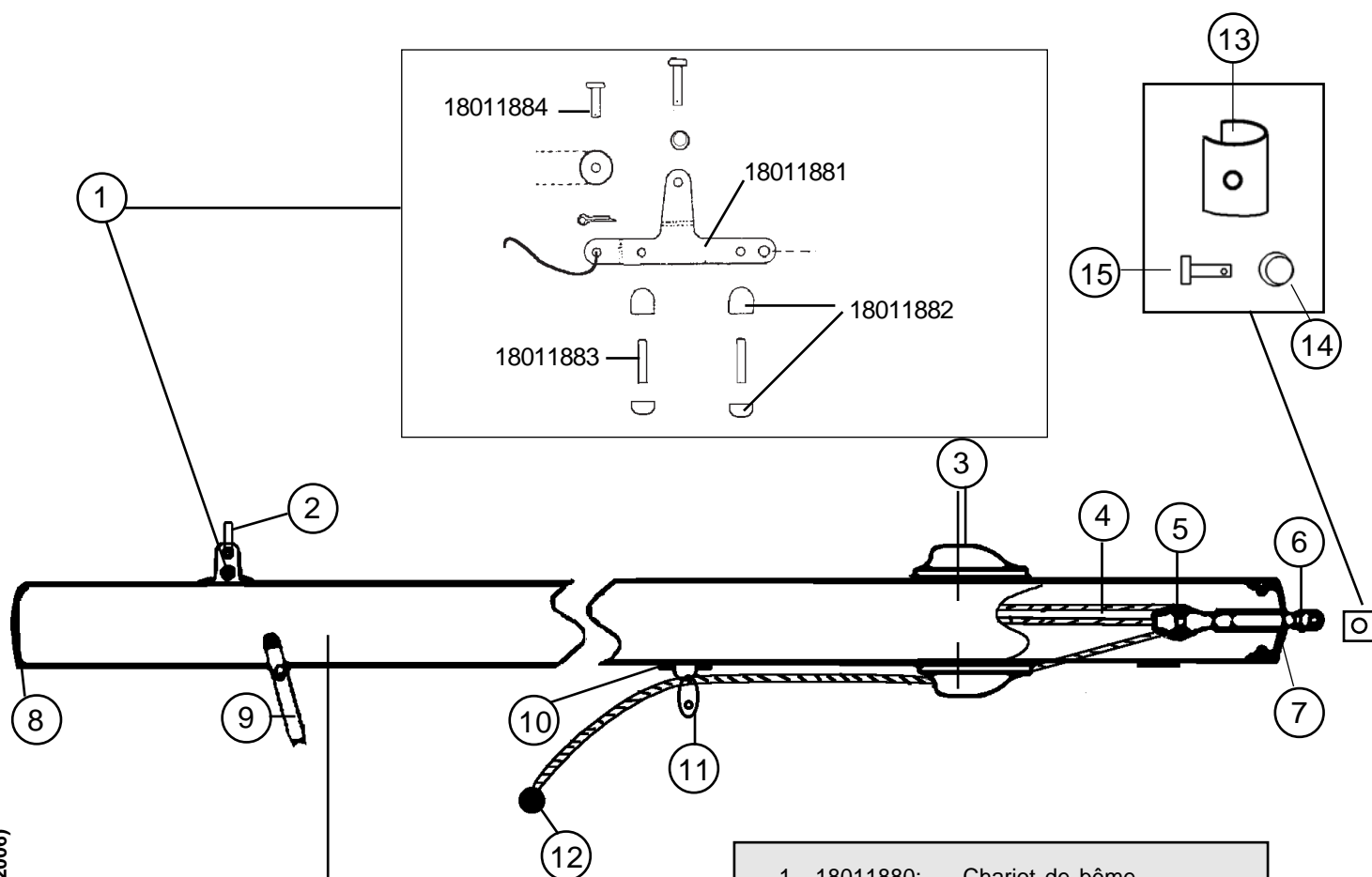

- 11- 99500105: Poulie simple ringot
Simple block
Block Einfach
- 12- 99500290 (x5): Boule d'arrêt
Stop ball
Kugelstopper
- 13- 14070351: Charnière vit mulot
Hinge vertex assembly.
Lümmelbeschlag-Verbindungskit
- 14- 99220230 (x10) : Anneau brisé
Split ring
Ringsplint
- 15- 99056230 (x10) : Axe percé latte ridoir
Clevis pin
Bolzen f. Locheisen gebohrt
- 16- 18060411: Sandow
Sandow
Gummi

- 1 - 18011880: Chariot de bôme
Outhall car assembly
Baumtraveller
- 2 - 99220665 (x10): Manille lyre 6 mm
Shackle 6 mm
Schäkel 6 mm
- 3 - 99500540: Taquet alu
Cam cleat aluminium
Klemme aluminium
- 4 - 18060412: Cordage D5
D5 rope
Leine D5
- 5 - 17070150: Poulie étarquage simple
Simple block
Block einfach
- 6 - 14011820: Ancrage vit mulot
Gooseneck fastening
Bauteil f. Lümmelbeschlag
- 7 - 18000090: Embout de bôme av.
Front boom end cap
Baumendkappe vorne
- 8 - 18000095: Embout de bôme arrière.
Boom rear end cap
Baumendkappe hinten
- 9 - 14011830: Collier de bôme
Block hanger
Baumblock Beschlag
- 10- 99220057: Pontet D5
Pad-eye
Bügel

Hobie Fox
Bôme/Boom/Baum 2003
20512810

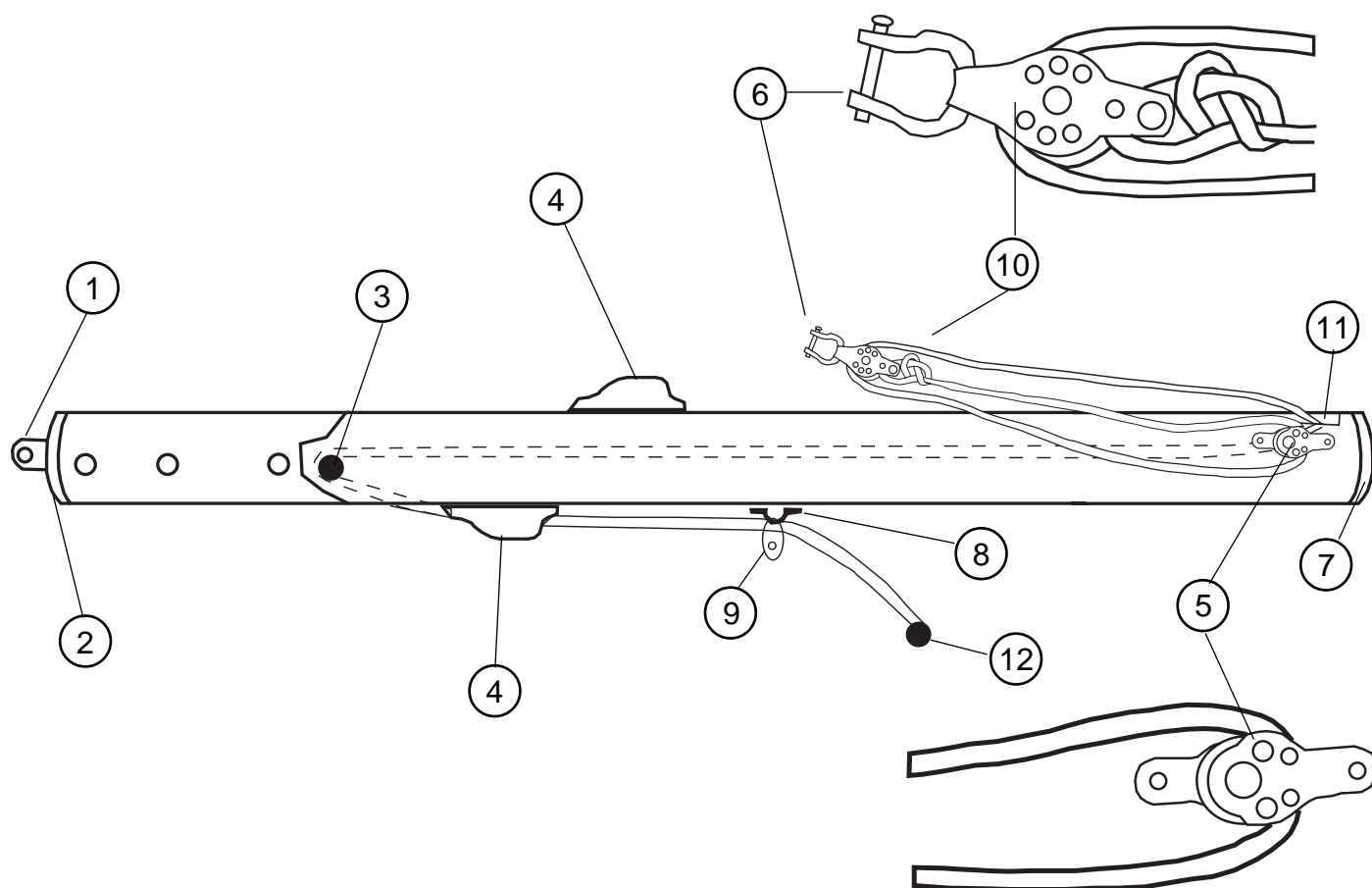

- | | |
|---------------------|--|
| 1 - 14011820: | Ancrage vit mulet
Gooseneck fastening
Bauteil f. Lümmelbeschlag |
| 2 - 17569000: | Embout de bôme FX1 D40 percé
Boom end cap drilled
Baumendkappe gebohrt |
| 3 - 99500126: | Poulie de mât 21
Block mast 21
Block Mast 21 |
| 4 - 99500540: | Taquet coinçeur
Cam cleat
Schotklemme |
| 5 - 99500490: | Poulie à plat pont
Cheek block
Liegeblock |
| 6 - 99220665 (x10): | Manille lyre 6 mm
Shackle 6 mm
Schäkel 6 mm |

- | | |
|----------------------|--|
| 7 - 99220208 (x5) : | Bouchon à ailette D40
End cap
Endstück |
| 8 - 99220057: | Pontet forgé D5
Pad-eye
Guseisenbeschlag |
| 9 - 99500478 : | Poulie simple H404
Block single
Block einzig |
| 10 - 99500105: | Poulie simple ringot
Block single with becket
Block einzig mit Hundsfoth |
| 11 - 99500545: | Poulie barber fock
Block jib barber
Block Fock Barber |
| 12 - 99500290 (x5) : | Boule d'arrêt
Stop ball
Kugelstopper |

Hobie Fox
 Barre d'accouplement & stick
 Tiller crossbar & stick
 Anlenkstange & Pinne

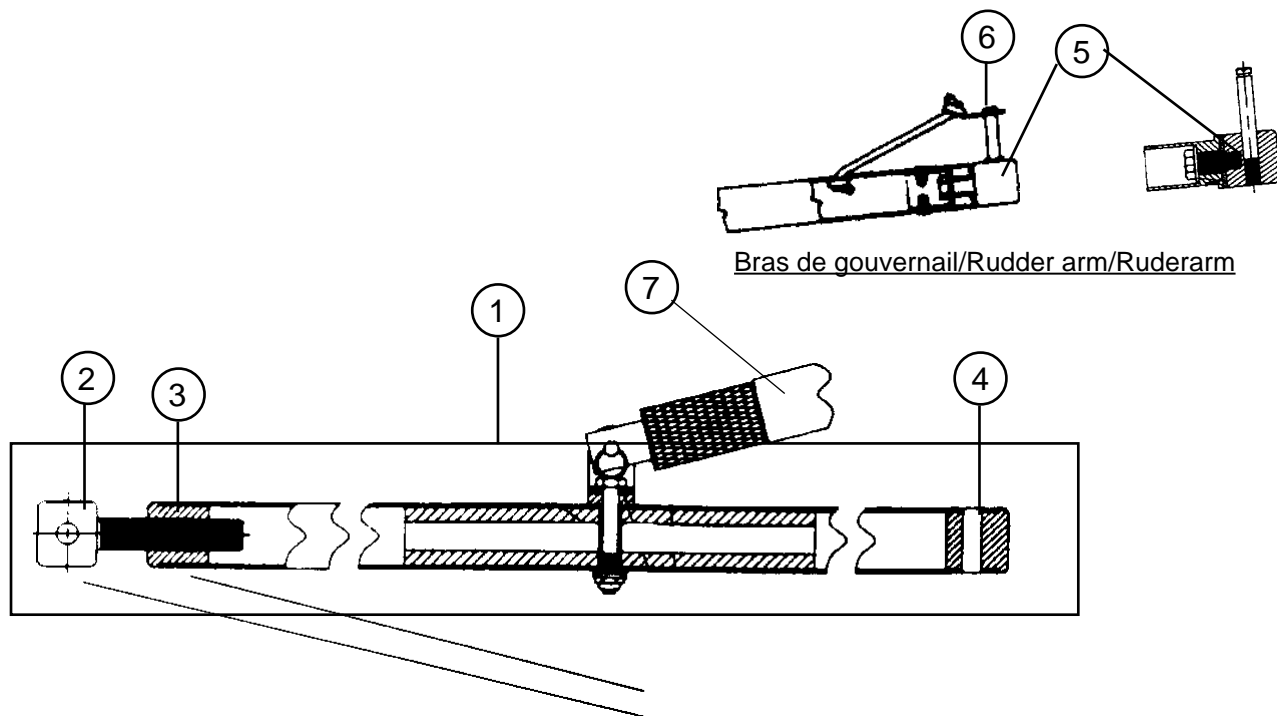

- | | |
|------------------------|--|
| 1 - 20562200 : | Barre d'accouplement Race complète
Race tiller crossbar complete
Anlenkstange kompl. Race |
| 2 - 99220810 :
(x2) | Vis de réglage
Adjustment arm
Anlenkstange-Einstellschraube |
| 3 - 99220119 : | Embout fileté
Threaded end cap
Enstück mit Gewinde |
| 4 - 99220121 | Embout de barre accouplement percé
Tiller crossbar drilled end cap
Anlenkstange-Endstück gebohrt |
| 5 - 99220163 : | Embout de gouvernail Race
Race tiller end cap
Ruderarmenstück Race |
| 6 - 99220169 :
(x2) | Clip rapide
Retainer clip
Sicherungsclip |
| 7 - 99502310 : | Stick FX6
FX6 Tiller extension
FX6 Pinne |

99600020 : Kit articulation Race complet
 Race tiller connector kit complete
 Verbindungsgelenk kompl. Race

**Mât avant 2003/
Mast before 2003**

Hobie FOX

**Barre de flèche et cables
Spreaders and diamond wires
Saling und Diamondwant**

18060331 : KITBARREDEFLECHE
SPREADERASSEMBLY
SALINGBAUSATZ

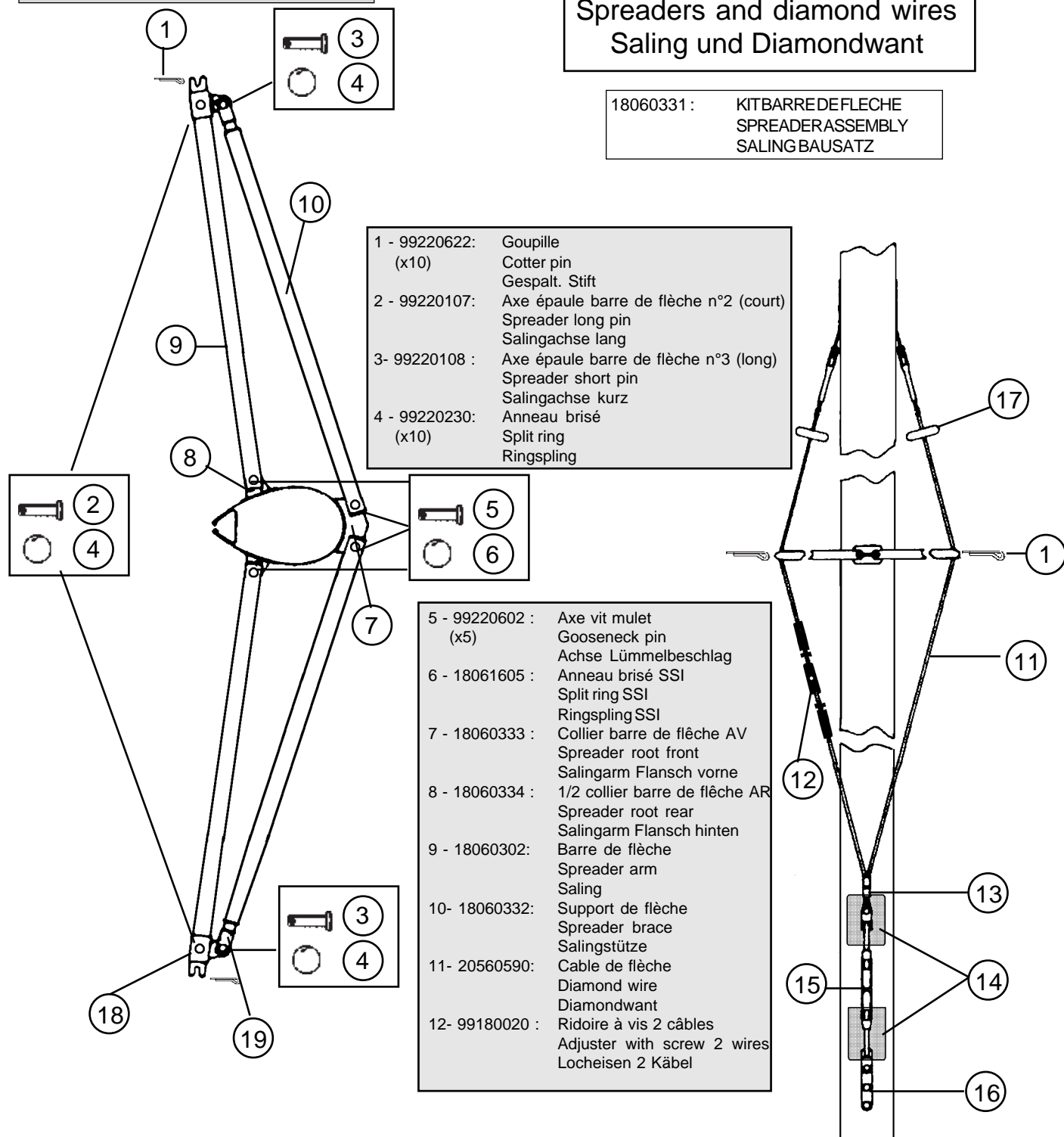

- 1 - 99220622: Goupille
(x10) Cotter pin
Gespalt. Stift
- 2 - 99220107: Axe épaule barre de flèche n°2 (court)
Spreader long pin
Salingachse lang
- 3- 99220108 : Axe épaule barre de flèche n°3 (long)
Spreader short pin
Salingachse kurz
- 4 - 99220230: Anneau brisé
(x10) Split ring
Ringspling

- 5 - 99220602 : Axe vit mulet
(x5) Gooseneck pin
Achse Lümmelbeschlag
- 6 - 18061605 : Anneau brisé SSI
Split ring SSI
Ringspling SSI
- 7 - 18060333 : Collier barre de flèche AV
Spreader root front
Salingarm Flansch vorne
- 8 - 18060334 : 1/2 collier barre de flèche AR
Spreader root rear
Salingarm Flansch hinten
- 9 - 18060302: Barre de flèche
Spreader arm
Saling
- 10- 18060332: Support de flèche
Spreader brace
Salingstütze
- 11- 20560590: Cable de flèche
Diamond wire
Diamondwant
- 12- 99180020 : Ridoire à vis 2 câbles
Adjuster with screw 2 wires
Locheisen 2 Käbel

- 13- 99180015 : Tole + axe ridoir câble de flèche
Diamond anchor plate + pin
- 14- 99180010 : Tole réglage câble de flèche
Shield plate
Einstellplatte
- 15- 99180005 : Ridoire à vis câble de flèche
Turnbuckle
Salingspanner
- 16- 18080501 : Barette ridoir
Turnbuckle anchor plate
Salingspanner-Verankerung

- 17- 18060563: Kit protège foc
Plastic roller-diamond wire
Kit Fockschutz
- 18- 18011801: Tube de réglage barre de flèche
Spreader slide
Salingeinstellrohr
- 19- 99220815: Vis de réglage barre de flèche
(x2) spreader tip adjuster
Salingendstück-Einstellschraube

**Mât depuis 2003/
Mast since 2003**

Hobie Fox

Barre de flèche et câbles
Spreaders and diamond wires
Saling und Diamondwant

99064050 : KIT BARRE DE FLECHE cpl
SPREADER ASSEMBLY
SALINGBAUSATZ

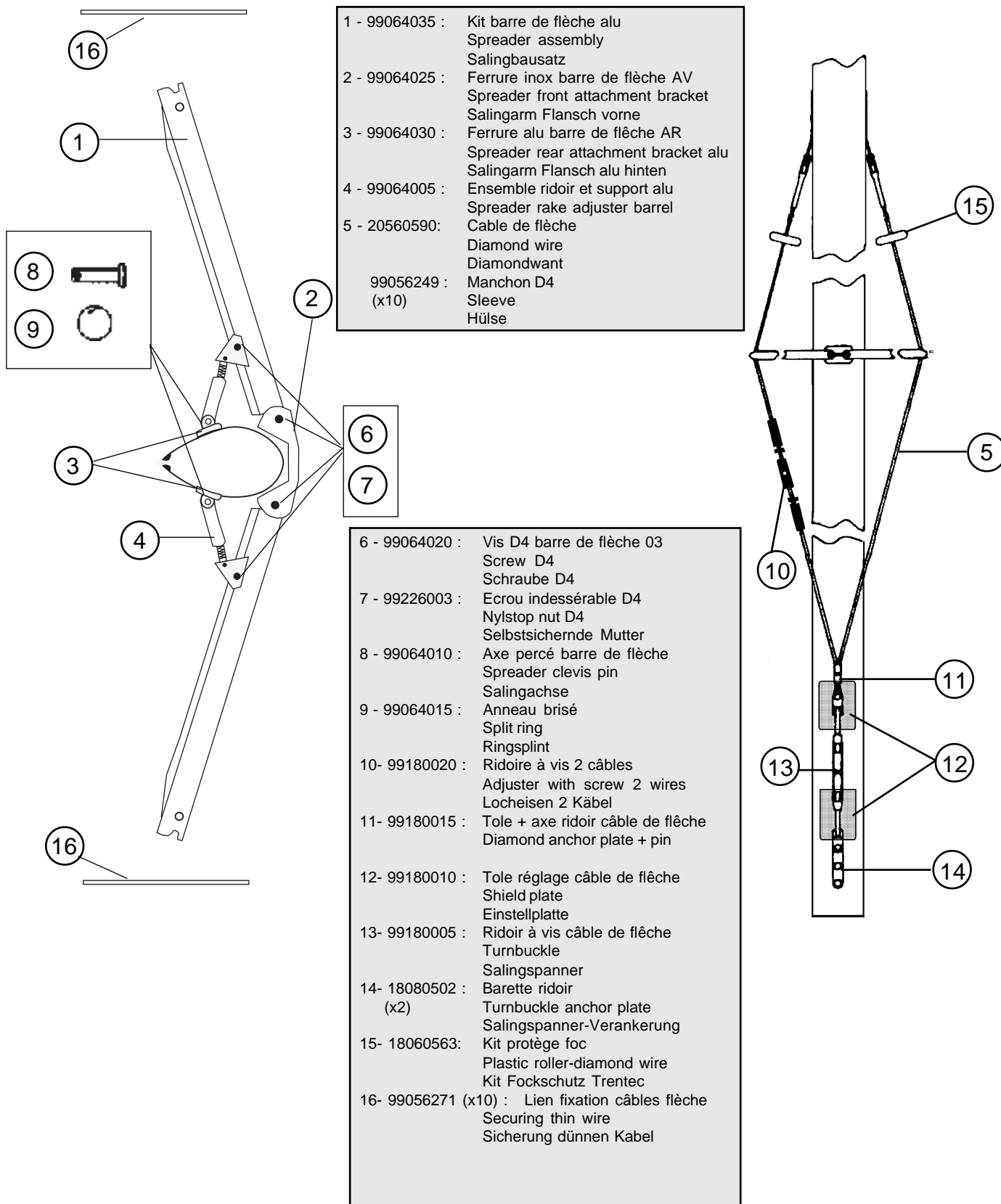

- 1 - 99064035 : Kit barre de flèche alu
Spreader assembly
Salingbausatz
- 2 - 99064025 : Ferrure inox barre de flèche AV
Spreader front attachment bracket
Salingarm Flansch vorne
- 3 - 99064030 : Ferrure alu barre de flèche AR
Spreader rear attachment bracket alu
Salingarm Flansch alu hinten
- 4 - 99064005 : Ensemble ridoir et support alu
Spreader rake adjuster barrel
- 5 - 20560590 : Cable de flèche
Diamond wire
Diamondwant
- 99056249 : Manchon D4
(x10) Sleeve
Hülse

- 6 - 99064020 : Vis D4 barre de flèche 03
Screw D4
Schraube D4
- 7 - 99226003 : Ecrou indesserrable D4
Nylstop nut D4
Selbstsichernde Mutter
- 8 - 99064010 : Axe percé barre de flèche
Spreader clevis pin
Salingachse
- 9 - 99064015 : Anneau brisé
Split ring
Ringsplint
- 10 - 99180020 : Ridoire à vis 2 câbles
Adjuster with screw 2 wires
Locheisen 2 Kabel
- 11 - 99180015 : Tole + axe ridoir câble de flèche
Diamond anchor plate + pin
- 12 - 99180010 : Tole réglage câble de flèche
Shield plate
Einstellplatte
- 13 - 99180005 : Ridoir à vis câble de flèche
Turnbuckle
Salingspanner
- 14 - 18080502 : Barette ridoir
(x2) Turnbuckle anchor plate
Salingspanner-Verankerung
- 15 - 18060563 : Kit protège foc
Plastic roller-diamond wire
Kit Fockschutz Trentec
- 16 - 99056271 (x10) : Lien fixation câbles flèche
Securing thin wire
Sicherung dünnen Kabel

Hobie FOX

Grand-voile/Main sail/Großsegel

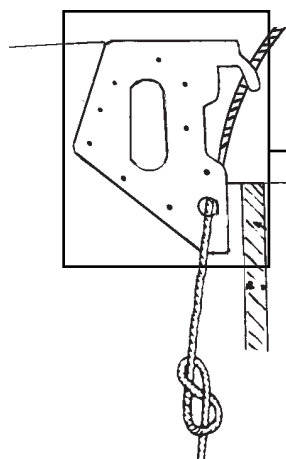

20041750 :
Hook de grand-voile
Main hook
Großhaken

Grand-voile Hobie FOX Hobie FOXmain sail Hobie FOXGroßsegel

20530100 : Jaune/Yellow/Gelb
20530120 : blanc/white/weiss
20530130 : noir/black/schwarz

Lattes de grand-voile Hobie FOX Hobie FOX main battens Hobie FOX Großsegel-Latten

20534000 : Jeu de lattes de grand-voile complet
Main Batten set complete
Großsegel-Lattensatz kompl.

#1 : 20534001	soft #1 20534008
#2 : 20534002	soft #2 20534009
#3 : 20534003	
#4 : 20534004	
#5 : 20534005	
#6 : 20534006	
#7 : 20534007	

CUNNINGHAMSYSTEM/VORLIELSTRECKER

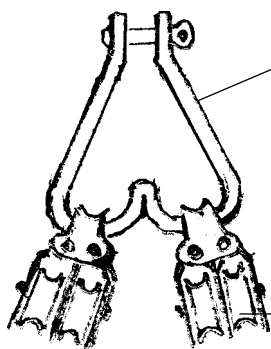

99220132 :
Manille coeur
Heart shackle

17070160 :
Poulie double
Double block
Block zweifach

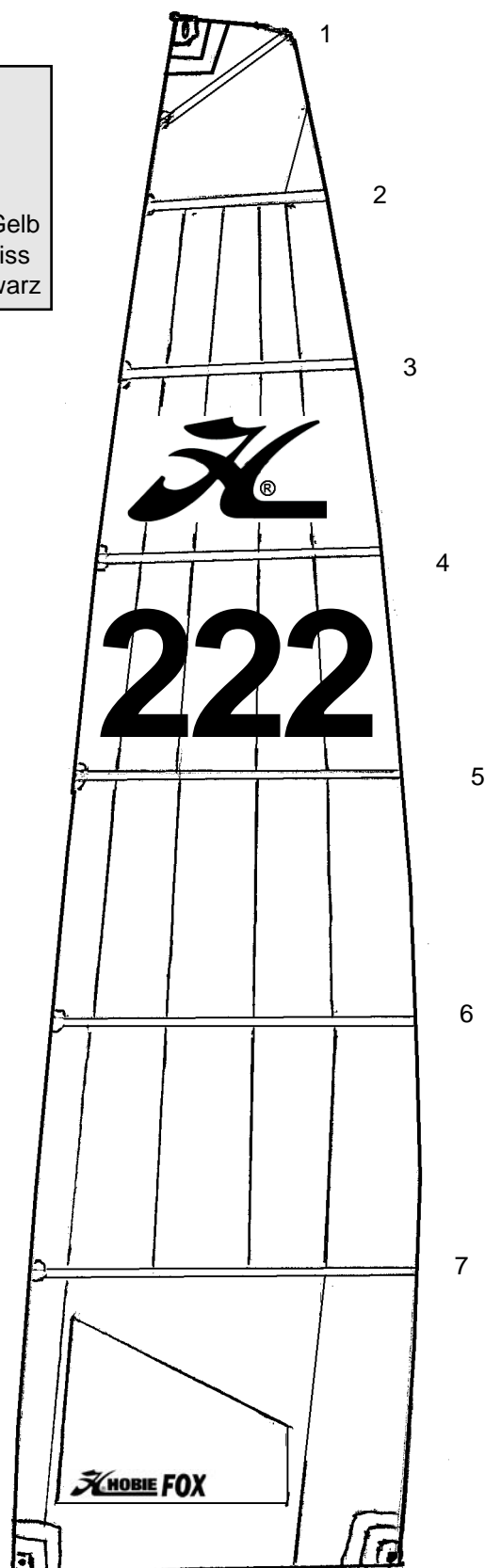

Hobie FOX
Foc/Jib/Fock

20530205 (jaune/yellow/Gelb)
20530225 (blanc/white/weiss)

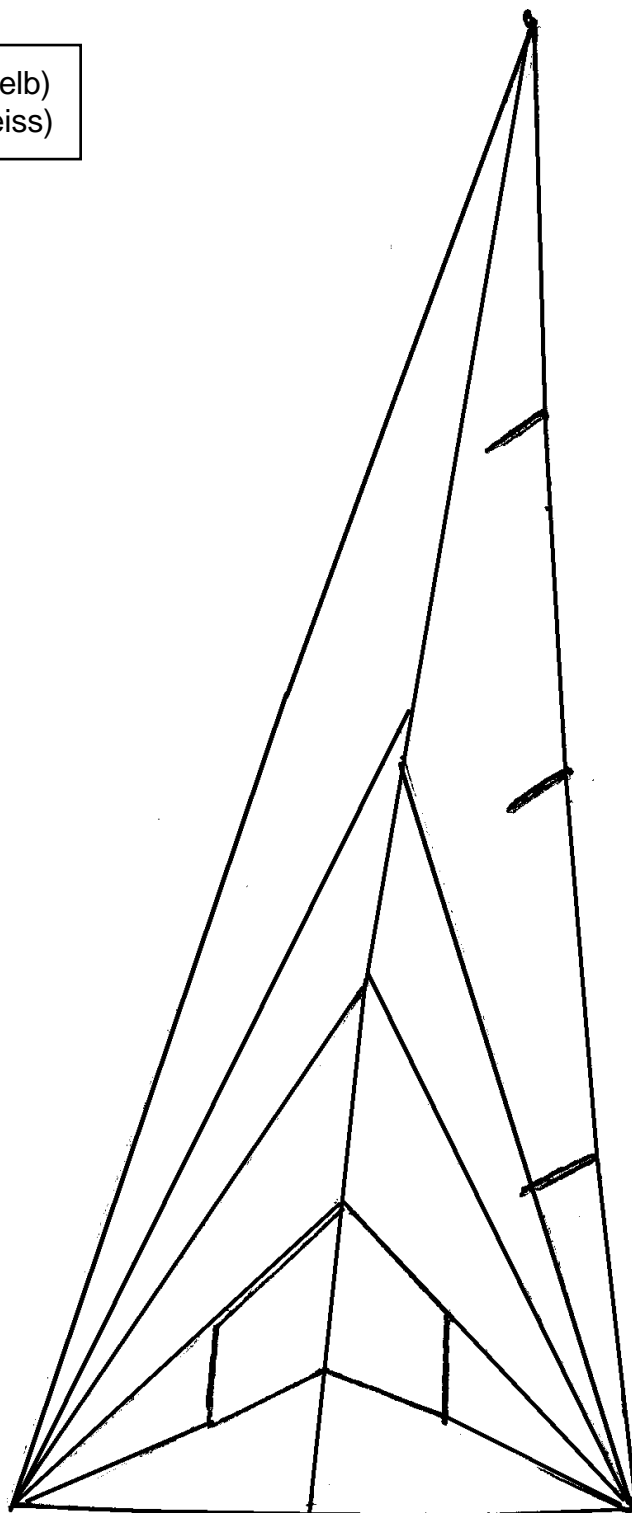

KIT DE BASE / BASIC KIT
18080330

- 1 - 99000200 : Base support inox
Track support bracket
Fußschienenstutze
- 2 - 99000210 : Support aluminium (court)
Track support alu (short)
Schienenstutze (kurz)
- 3 - 99000211 : Support aluminium long
Track support alu (long)
Schienenstutze (lang)
- 4 - 99500830 : Rail de foc incurvé
Curved track
Fockschiene (gebogen)
- 5 - 99500810 : Chariot de foc
Jib car
Focktraveller
- 6 - 99500820 : Kit embout de rail
End stop kit
Fockwagenstopper
- 7 - 17070150 : Poulie Etarquage simple
Micro block
Microumlenkrolle
- 8 - 99500850 : Poulie simple (29 mm)
29 mm carbo block
Holepunktumlenkrolle
- 9 - 99500478 : Poulie simple
Single block
Einzelblock

Hobie Fox

Foc autovireur / Self Tacking jib
Selbstwende Fock

- 10- 99220660 (x10) : Manille 4 mm
99220096 (x20) Shackle 4 mm
Schäkel 4 mm
- 11- 99300545 : Cordage Spectra blanc
Spectra line
Spectra-Leine
- 12- 99220602 (x5) : Axe percé 5x20
Clevis pin 5x20
Bolzen gebohrt 5x20
- 13- 99220230 (x10) : Anneau brisé
Ring clip
Ringsplint
- 14- 99056237 (x10) : Ecrou nylstop 5mm
Nylstop nut 5mm
Selbstsichernde Mutter 5
- 15- 99056263 (x10) : Vis TFBF 5x30
Screw TFBF 5x30
Schraube TFBF 5x30
- 16- 99220900 (x10) : Vis TH 5x25
Screw TH 5x25
Schraube TH 5 x25
- 17- 99500415 : Taquet coinreur
Cam cleat
Klemme
- 99220065 : Vis TTFF 3,5x19
Screw
Schraube

- 18- 60010950 : Pontet
Eye strap
Bügel
- 19- 99220320 : Vis TFF 5x60
Screw
Schraube

**Pour le kit Deluxe/ For Deluxe kit /
Für Deluxe kit**
(18080335) ajouter/add :

- 20- 99500467 : Tourelle taquet
Swivel cam
Drehklemme
- 21- 99220205 : Pontet bas
Eye strap
Bügel
- 22- 99300555 : Ecoute de foc
Jib sheet
Fockshot
- 23- 99500478 : Poulie simple
Air block
Einzelblock
- 24- 99300460 : Cordage fin blanc D4
Fine line white D4
Leine weiss D4

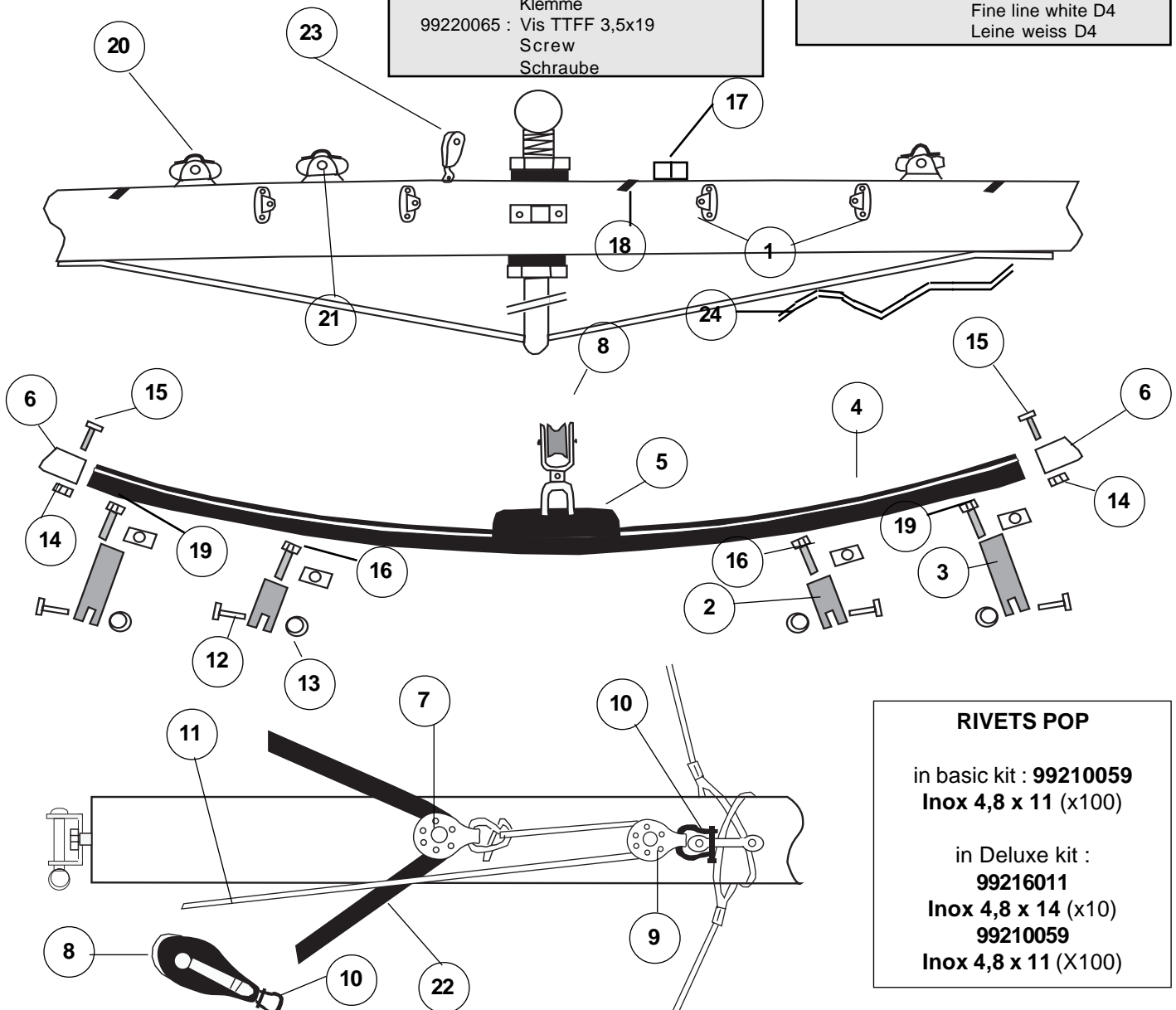

RIVETS POP

in basic kit : **99210059**
Inox 4,8 x 11 (x100)

in Deluxe kit :
99216011
Inox 4,8 x 14 (x10)
99210059
Inox 4,8 x 11 (X100)

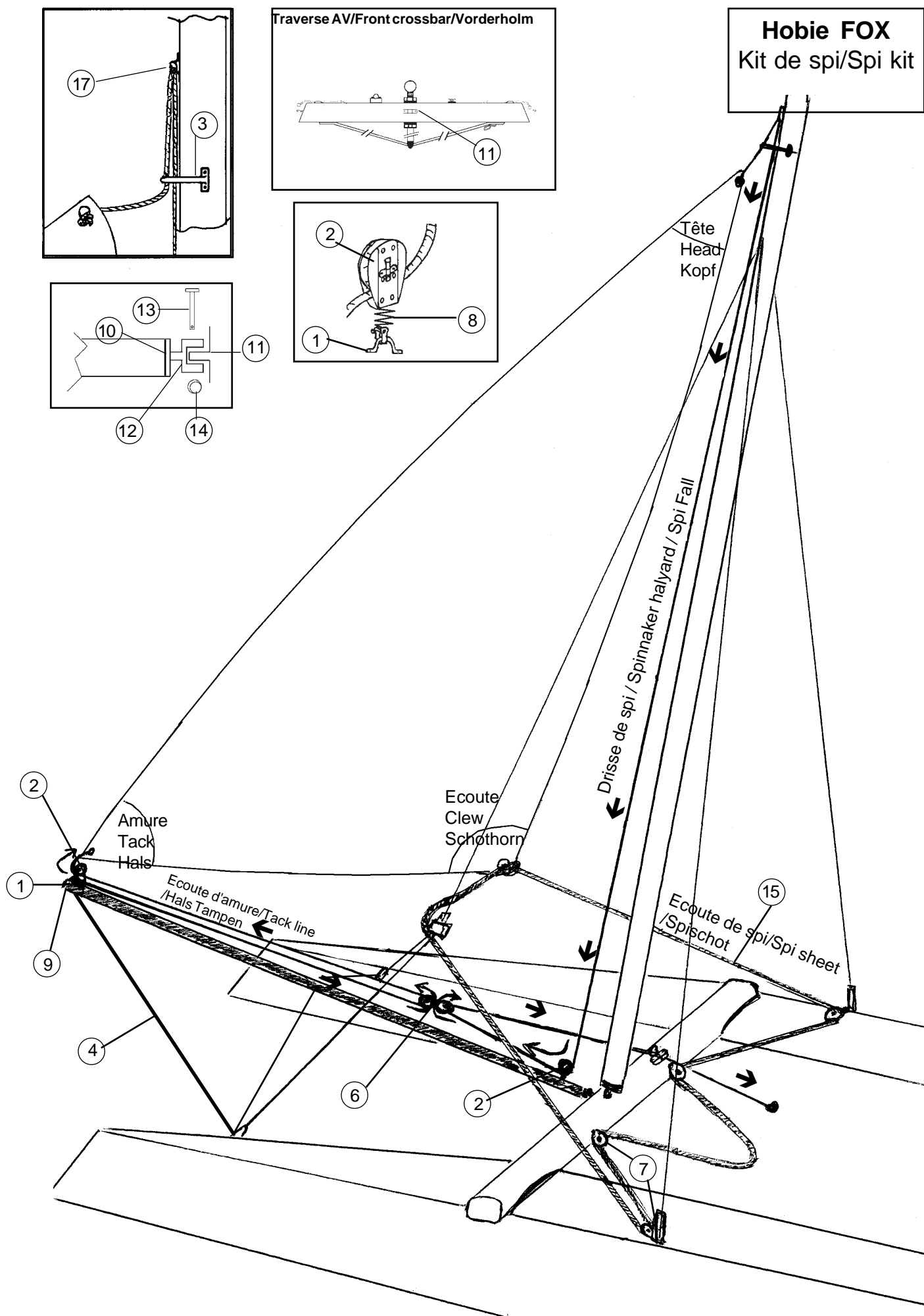

20570320 : Accastillage Spinnaker ss spi
Complete Spinnaker kit w/o spi
Spi-Rig kompl.ohne Spi

99267465 : Sac spinnaker
Spinnaker bag
Spitasche

20570420 : Sac cordages Spinnaker Fox
Spi rope bag Fox
Spileinetasche Fox

Hobie FOX
Kit de spi/Spi kit
Ref. : K SPIFOX

1 - 99220057 :	Pontet forgé D5 Eye strap Guseisenbeschlag	8 - 18060142 :	Ressort poulie écoute foc/spi Spi sheet block spring Spischottblock-Feder
2 - 17070150 :	Poulie simple Single block Block einfach	9 - 99220208 : (x5)	Embout tangon plast. Spi pole end cap Endstück Spibaum
3 - 18041721 :	Collier de spi Spi head mast fitting Mastbeschlag für Spi	10- 17569000 :	Embout tangon Spi pole end cap Endstück Spibaum
4 - 20580550 :	Bride tangon Pole bridle Spibaum-Hanepot	11- 16056025 :	Articulation tangon Spi pole connection Verbindung Spibaum
5 - 20562635 :	Tangon de spi Spi pole Spibaum	12- 18061320 :	Chape d'articulation tangon Spi pole connection toggle Verbindungswirbel Spibaum
6 - 21060060 :	Poulie tête-à-tête spi Sister block Block spi	13- 14061245 :	Axe barre Connection pin Bolzen
7 - 99501000 :	Poulie winch simple Ratchet block single Knarr-Block einzig	14 - 99220230 : (x10)	Anneau brisé Split ring Offener ring
		15 - 18060486 :	Ecoute de spi Spi sheet Spischot

Les Poulies se montent sur les chapes d'articulation de Haubans et sur la traverse avant.

The sheet blocks are mounted at the base of the shroud adjusters and on the front crossbar.

Blöcke müssen auf den Wanten-Toggle und den Vorderholm eingestellt werden

Hobie Fox

Kit de spi trompette/Spi kit trumpet

20570330 : Accastillage spi trompette + cordages
Trumpet spi kit + lines
Trumpet Spi-Kit + Leine

- | | |
|----------------|--|
| 1 - 20562640 : | Tangon de spi trompette
Spi pole trumpet
Spibaum Trumpet |
| 2 - 99267750 : | Trompette FX/TI/FOX
Trumpet FX/TI/FOX
Spikanone FX/TI/FOX |
| 99267526 : | Sac de spi trompette Fox
Trumpet spinnaker bag
Sack für kurzer Spikanone |
| 3 - 18570385 : | Accastillage trampolin spi trompette
Trampoline rig for trumpet spi
Trumpet Spi klein Teile für Trampoline |

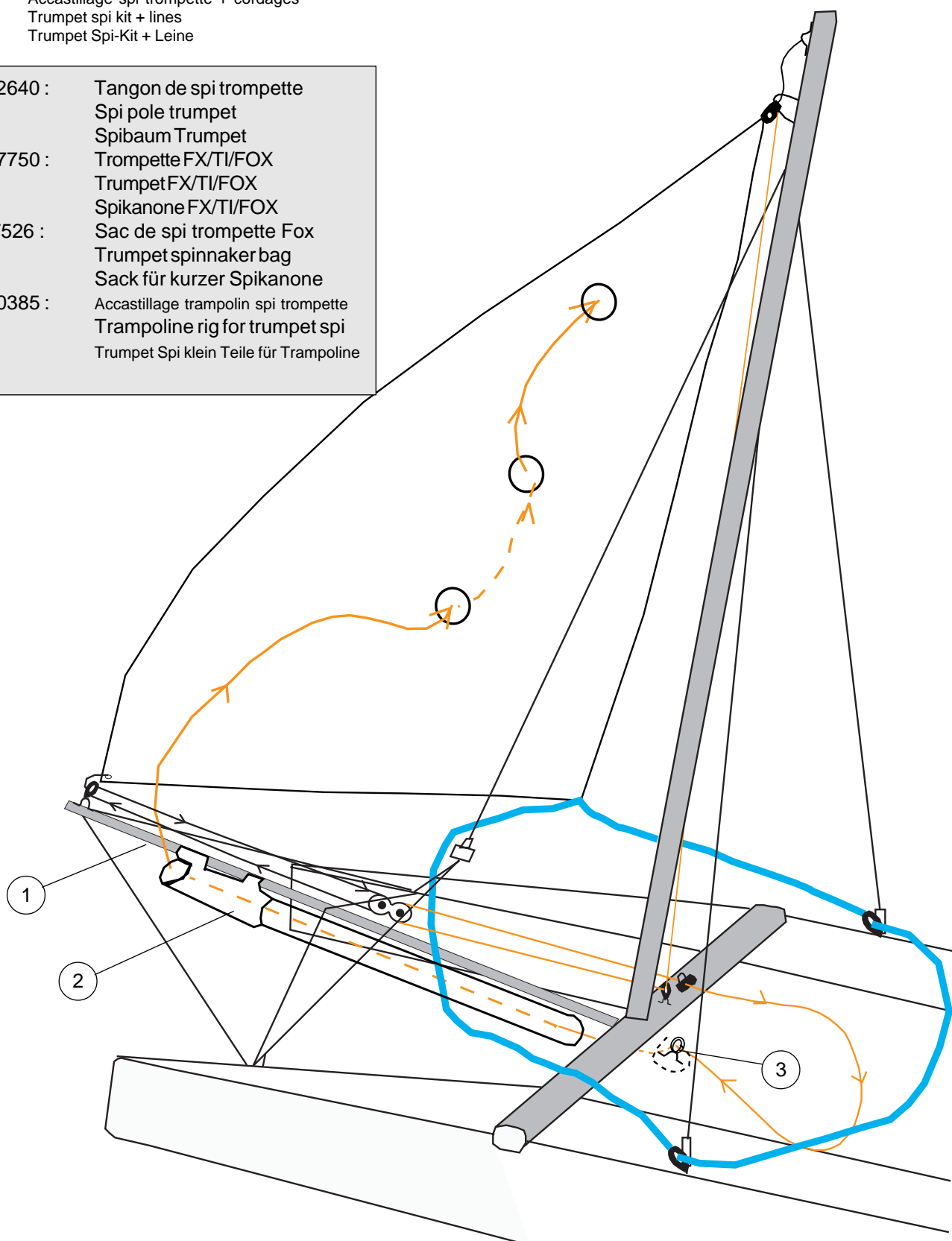

Hobie FOX

Tangon de spi/ Spinnaker pole/Spibaum

20562635 : Système classique / Classical system / Classisches System

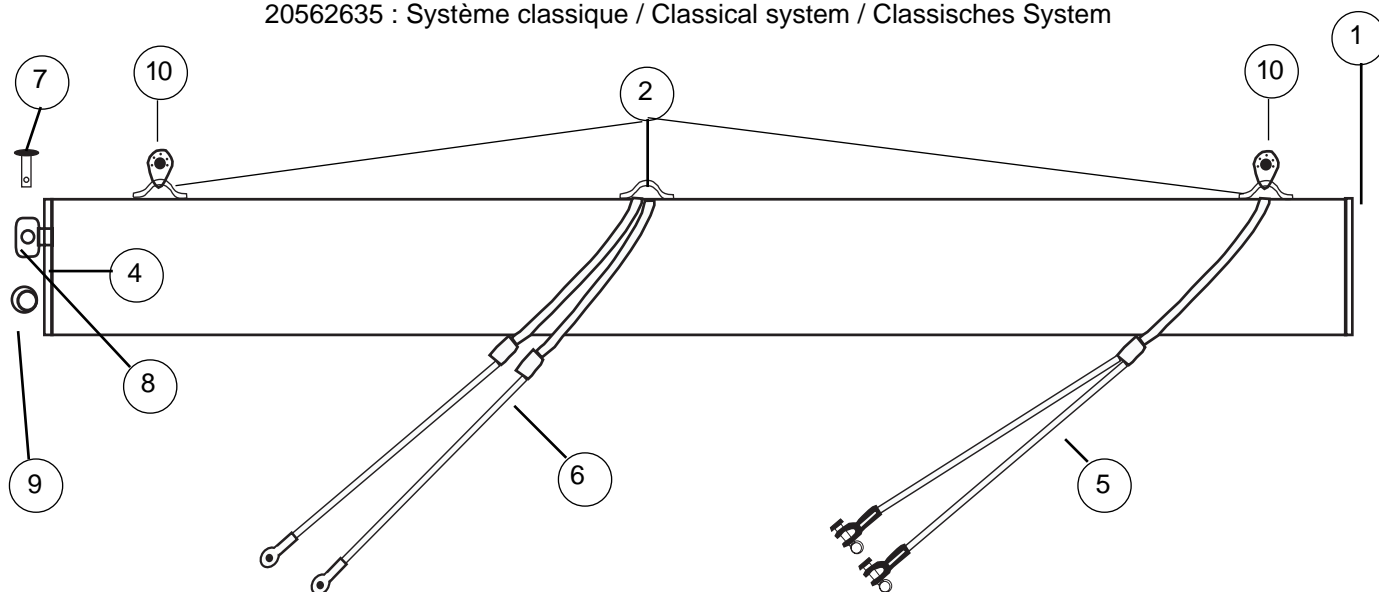

20562640 : Système trompette/Trumpet system

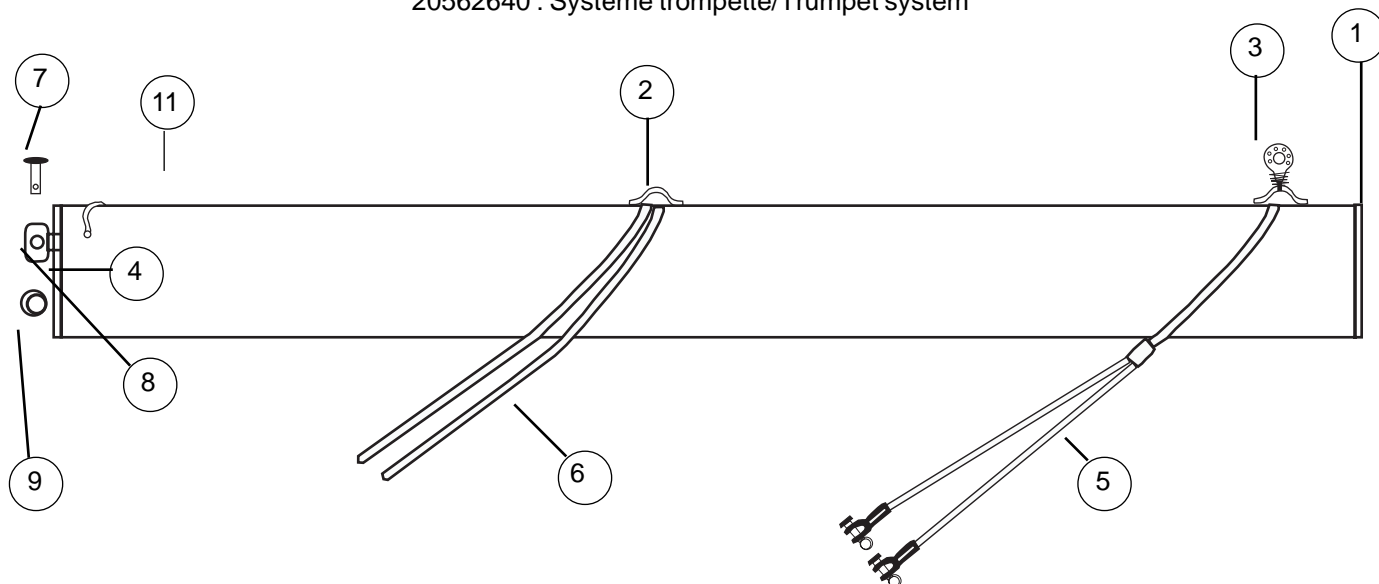

Hobie Fox : Eclaté de pièces détachées / Illustrated part guide/Explosionszeichnung (2006)

1 - 99220208 (x5) :	Bouchon à ailette End cap Endstück
2 - 99220057 :	Pontet forgé D5 Pad-eye Guseisenbeschlag
3 - 99500735 :	Poulie avec ressort et pontet Block with spring and eye strap Block mit Splint und Guseisenbeschlag
4 - 17569000 :	Embout bôme percé Boom end cap drilled Baumendstück gebohrt
5 - 20580550 :	Bride tangon Bridle classical Spibaum-Hanepot
6 - 20580560 :	Bride cunningham tangon (classique) Pole support wire Spibaum-Gurtel

99300545 :	Cordage spectra D4 blanc (trompette) Spectra line D4 (trumpet) Spectraleine D4 (Trumpet)
7 - 14061245 :	Axe barre Connection pin Bolzen
8 - 18061320 :	Chape d'articulation tangon Spi pole connection toggle Verbindungswirbel Spibaum
9 - 99220230 (x10) :	Anneau brisé Split ring Offener Ring
10-17070150 :	Poulie étarquage simple Single block Block einzig
11-60010950 :	Pontet nylon kayak Nylon pad-eye Guseisenbeschlag Nylon

Hobie FOX SPINNAKER



Spi classique/Classical spi

20530300 "Hobie Cat" jaune/yellow/Gelb

20530310 Jaune/Yellow/gelb

20530320 "Hobie Cat" blanc/white/weiss

20530325 blanc/white/weiss

Spi pour avaloir trompette/Trumpet Spi

20530340 Blanc/White/Weiss

20530345 Jaune/Yellow/Gelb

20530350 Rouge/Red/Rot

RETRIEVER PATCHES SPINAKER TRUMPET

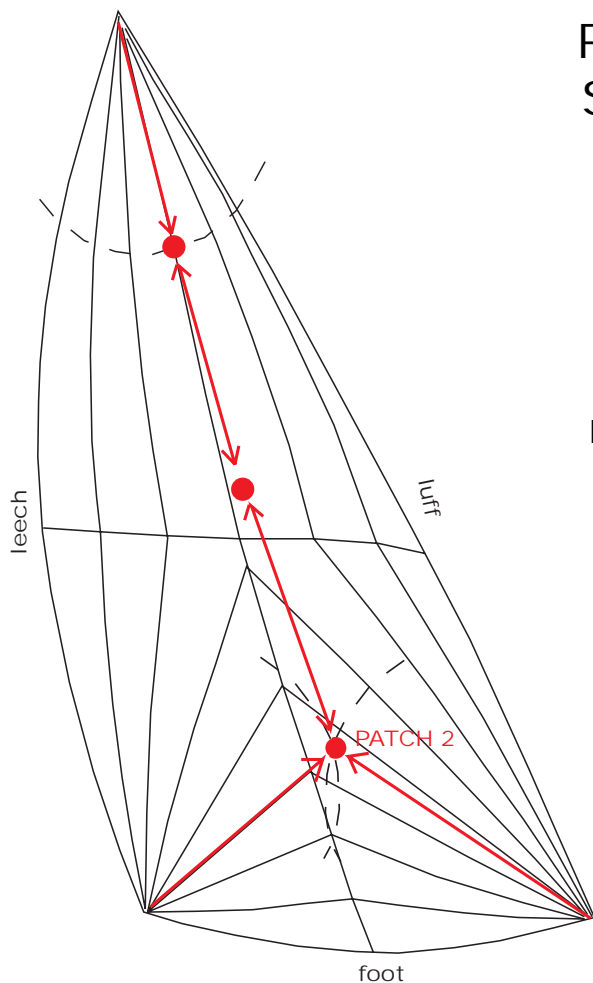

	Patch 2	Intermediate	Patch 1
Fox	2,5 m	A=B	2,45 m

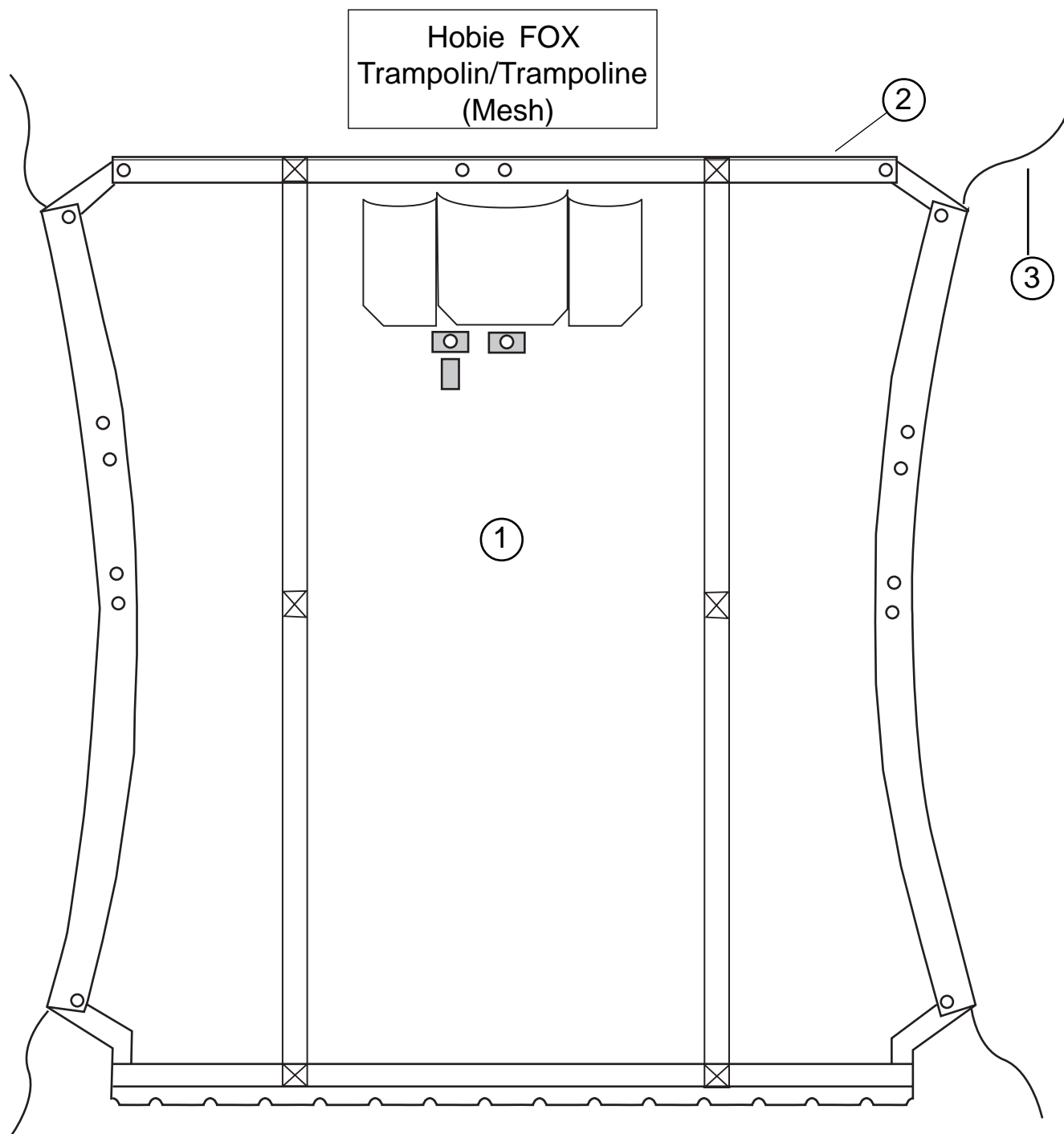

- | | |
|----------------|---|
| 1 - 20525810 : | Trampolin Fox 2005
Trampoline Fox 2005 |
| 2 - 20525000 : | Jonc Trampolin Fox
Fibreglass lacing rod |
| 3 - 18070480 : | Bout de trampolin Vectran
Trampoline lacing Vectran
Trampolineleine Vectran |

Hobie FOX
Barber de foc/Jib barber hauler
(avant/prior/vor 2003)

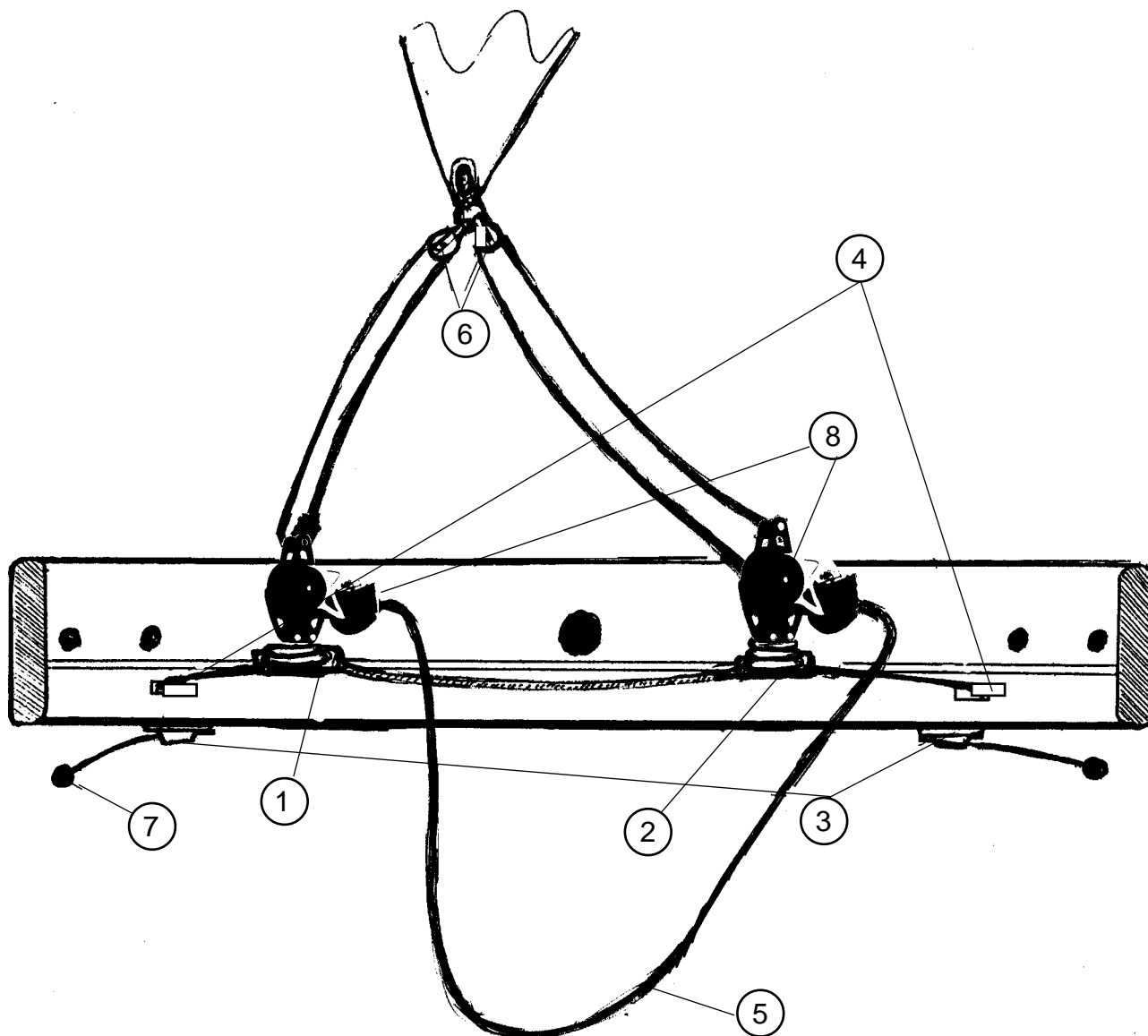

- | | |
|----------------|---|
| 1 - 18580055 : | Glissiere chariot de foc G
Jib slide left
Fockschotschlitten links |
| 2 - 18580060 : | Glissière Chariot de foc D
Jib car assembly starboard
Fockschotschlitten rechts |
| 3 - 99500540 : | Taquet
Clamcleat
Klemme |
| 4 - 99500545 : | Poulie Barber Foc
Exit block
Umlenkrolle |

- | | |
|----------------|--|
| 5 - 20560415 : | Ecoute de foc
Jib Sheet
Fockschot |
| 6 - 99500114 : | Poulie point d'écoute de foc
Jib clew block
Fockschotblock |
| 7 - 99500290 : | Boule d'arrêt
(x5)
Stop ball
Plastikkugel |
| 8 - 99500800 : | Poulie de foc + ressort
Jib block assembly
Fockblock mit Feder |

Hobie FOX
Palan de grand-voile/Mainsheet system
Großschot-System

20560410 :
Ecoute de GV
Mainsheet
Großschott



①

②

- 1 - 99501005 : Poulie quadri carbo 57 mm
Carbo block fourfold 57 mm
Carbo 4-fach Block 57 mm
- 2 - 99500136 : Poulie winch triple
Threefold ratchet block
Dreifacher Knarrblock

20562950
gauche
left
links

Hobie FOX
Sport Wing Assembly
Ailes Sport
Sport-Wing

20562955
droit
right
rechts

Assise aile sport
Wing tube sport

20562960 = Gauche/left/links
20562965 = Droite/right/rechts

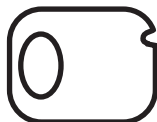

18062741
Bouchon de trav. AV gauche
Beam cap front left
Vorderholmendstück links

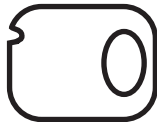

18062742
Bouchon de traverse AV droit
Beam cap front right
Vorderholmendstück rechts

99100001
Tube plymouth
Plymouth tube

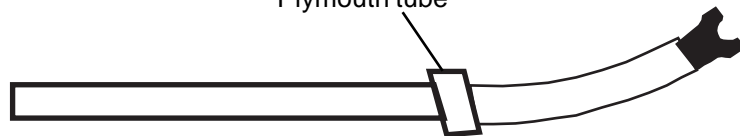

18062930
Bras d'aile sport complet
Wing arm sport complete
Wingarm Sport Komplett

18041733
Casting embout wing
End casting wing

99220142
Vis 6 x 60
Bolt 6 x 60
Bolzen 6 x 60

99216014 (x10)
Rivet 4.8x19
Pop rivet 4.8x19
Popniete 4.8x19

99220201
Embout plast. 45 mm
End cap plast. 45 mm
Endstück 45 mm

99220745 (x10)
Rondelle inox 6 mm
Washer stainless 6 mm
Unt.Scheibe inox 6 mm

99216021 (x10)
Rivet 4,8 x 14
Rivet 4,8 x 14
Popniete 4,8 x 14

99056238 (x10)
Ecrou indessérable 6 mm
Nylstop nut 6 mm
Selbstsichernde Mutter 6 mm



18062743
Bouchon de trav. AR gauche
Boom cap rear left
Achterholmendstück links



18062744
Bouchon de traverse AR droit
Boom cap rear right
Achterholmendstück rechts

17025810
Embout plast. 48 mm
End cap plast. 48 mm
Endstück 48 mm

20506055 (x4)
Neoprene
Neoprene
Antirutsch-belag

20562910 : Aile gauche s/s trampoline
Left wing w/o trampoline
Wing links o. Trampoline

20562900 : Aile droite s/s trampoline
Right wing w/o trampoline
Wing rechts o. Trampoline

Depuis Sept 99
Since Sept 99
Ab Sept 99

Hobie FOX
Kit d'ailes classiques/
Classic wings kit
K L FOX

ss tramp./wo tramp./o. Tramp.

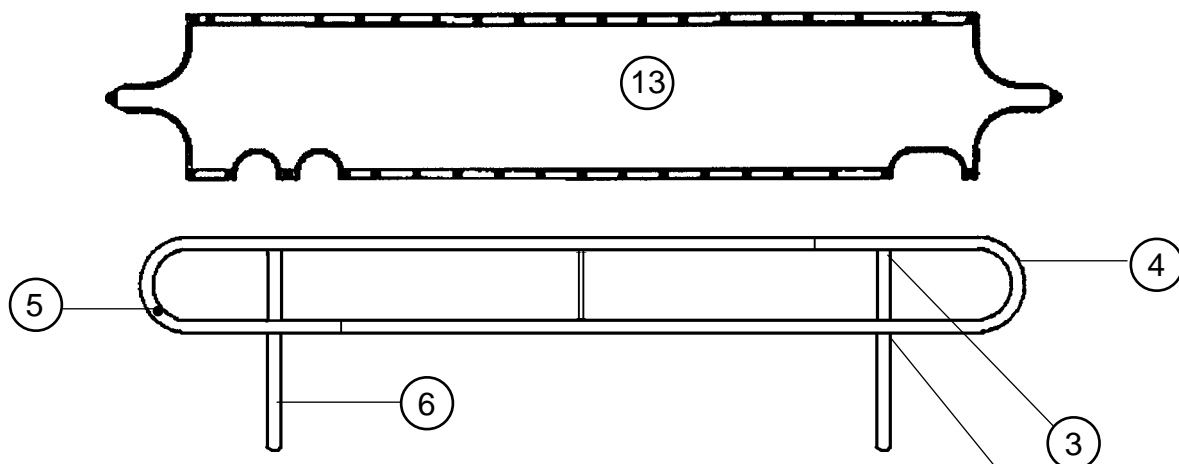

1 - 20562920 (G/L): Assise aile complète s/s tramp.
20562925 (D/R) Complete wing sitting area w/o tramp.
Wing-Sitzfläche kompl. o. tramp.

2 - 21041732 : Casting croix wing
Cross casting wing
Kreuz-Gussecke Wing

3 - 21041733 : Casting embout wing
Wing end casting
Gußeckendstück Wing

4 - 21062930 : Assise aile nue noire
Wing sitting area bare black
Wing-Sitzfläche roh schwarz

5 - 99210048 : Bouchon d'assise
End cap wing sitting area
Endstück Wing-Sitzfläche

99210075 : Rivet bouchon étanche
(x10) Rivet cap watertight

99216014 : Pop inox TB 4,8 x 19
(x10) Pop rivet ss 4,8 x 19
Popniete 4,8 x 19

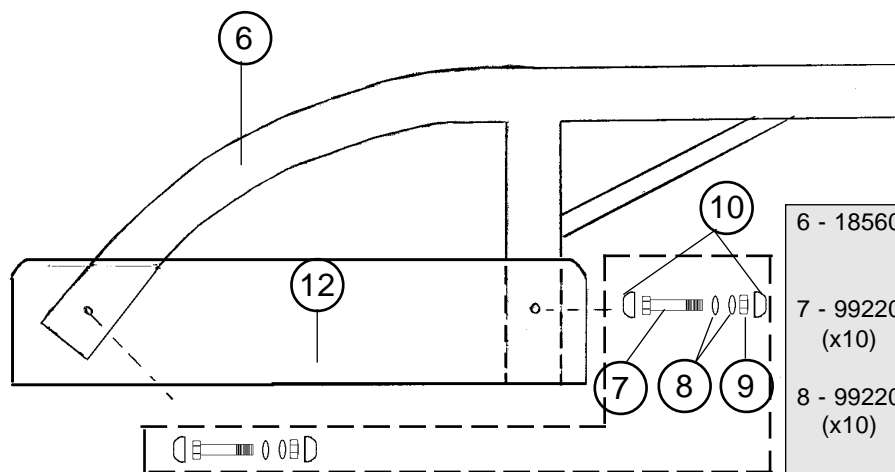

12- 18560360 : Fixation bras d'aile avant
Mounting front wing arm
Wingarm-Befestigung vorne

18560365 : Fixation bras d'aile arrière
Mounting rear wing arm
Windarm-Befestigung hinten

13- 18025895 : Trampoline d'aile mesh x 2
Wing mesh trampoline x 2
Netztrampoline f. Wing x 2

6 - 18560340 : Bras d'aile complet
Wing arm complete
Wingarm komplett

7 - 99220945 : Vis TH 8x75
(x10) Screw TH 8x75
Schraube 8x75

8 - 99220750 : Rondelle D8
(x10) Washer D8
Unterlegscheibe D8

9 - 99056239 : Ecrou indessûrable D8
(x10) Nylstop nut D8
Selbstsichernde Mutter D8

10- 99056233 : Capuchon de vis TH8
(x10) Screw cap
Schraube-Endstück

11- 20062970 : Kit montage 2 ailes
(=#7+#8+#9+#10) Mounting kit 2 wings
Aufbausatz für 2 Wings

20562970
Gauche/Left/Links

Hobie FOX

Ailes confort + Trampoline

Comfort wings + Trampoline

20562975
Droite/Right/Rechts

