

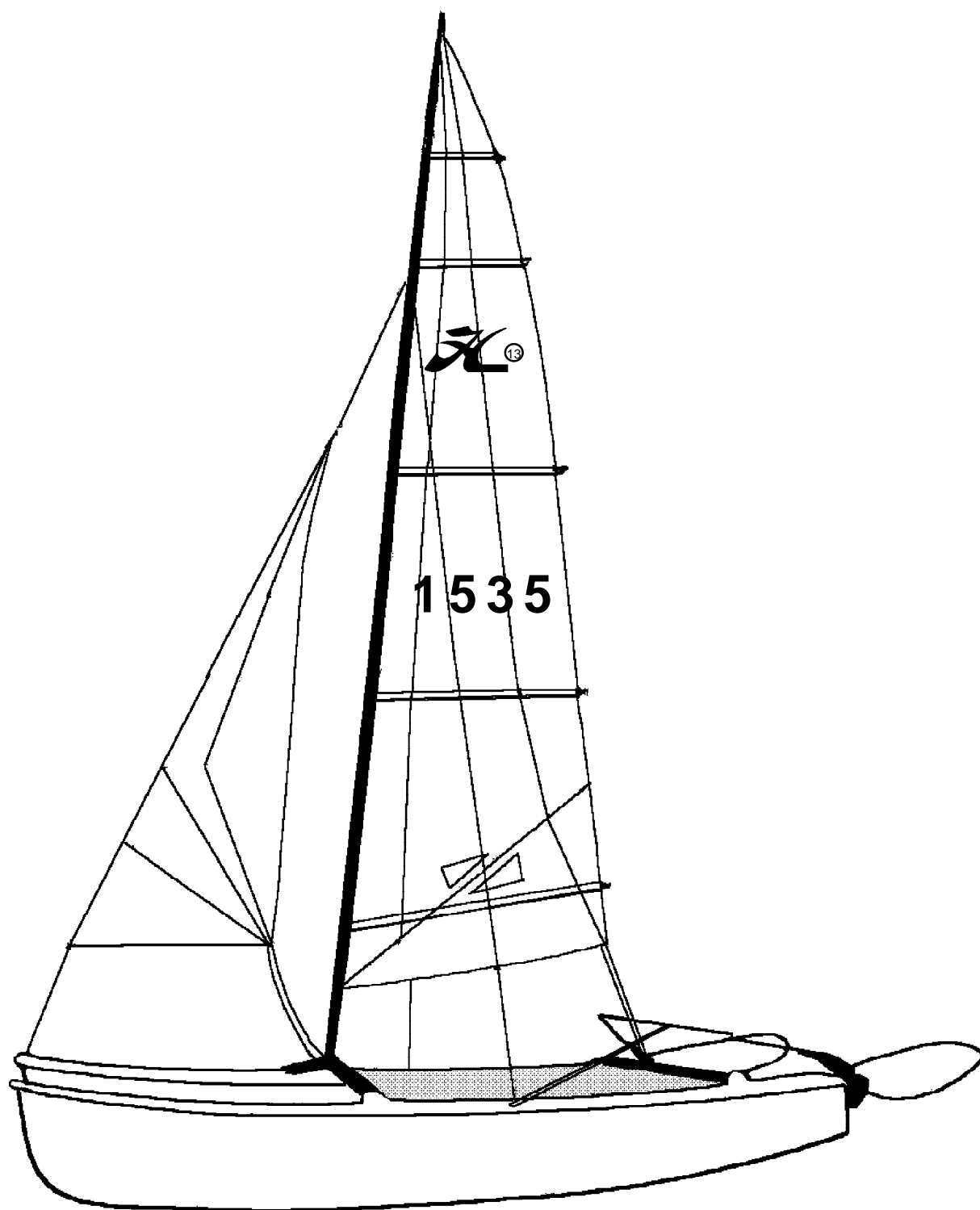

Eclaté des pièces détachées

Illustrated Part Guide - Explosionszeichnung



Sommaire / Table of Content / Inhalt

HC 13 3

Coque/Hull/Rumpf	3
Safran/Rudder/Ruderblatt	5
Traverse avant/Front crossbar/Vorderholm	6
Barre d'accouplement/Tiller crossbar/Alenkstange	7
Mât/Mast/Mast	8
Haubans/Shrouds/Wanten	9
Trapèze/Trapeze/Trapez	10
Trampoline/Trampoline/Trampolin	11
Grand-voile/Main sail/Gross-Segel	12
Foc/Jib/Fock	13
Poulies/Main blocks/Blocke	14

HC 13 Turbo 15

Etai, drisse de foc, bride/Forestay, jib halyard, bridle	
Vorstag, Fockfallumlenk, Hannepot	15

Coque HC 13 std/HC 13 hull std/HC 13 Rumpf Std :

13056140 : Gauche/Left/Links

13056150 : Droite/Right/Rechts

Coque HC 13 Turbo/HC 13 Turbo hull/HC 13 Rumpf Turbo :

13056120 : Gauche/Left/Links

13056130 : Droite/Right/Rechts

HC 13

Coque/Hull/Rumpf

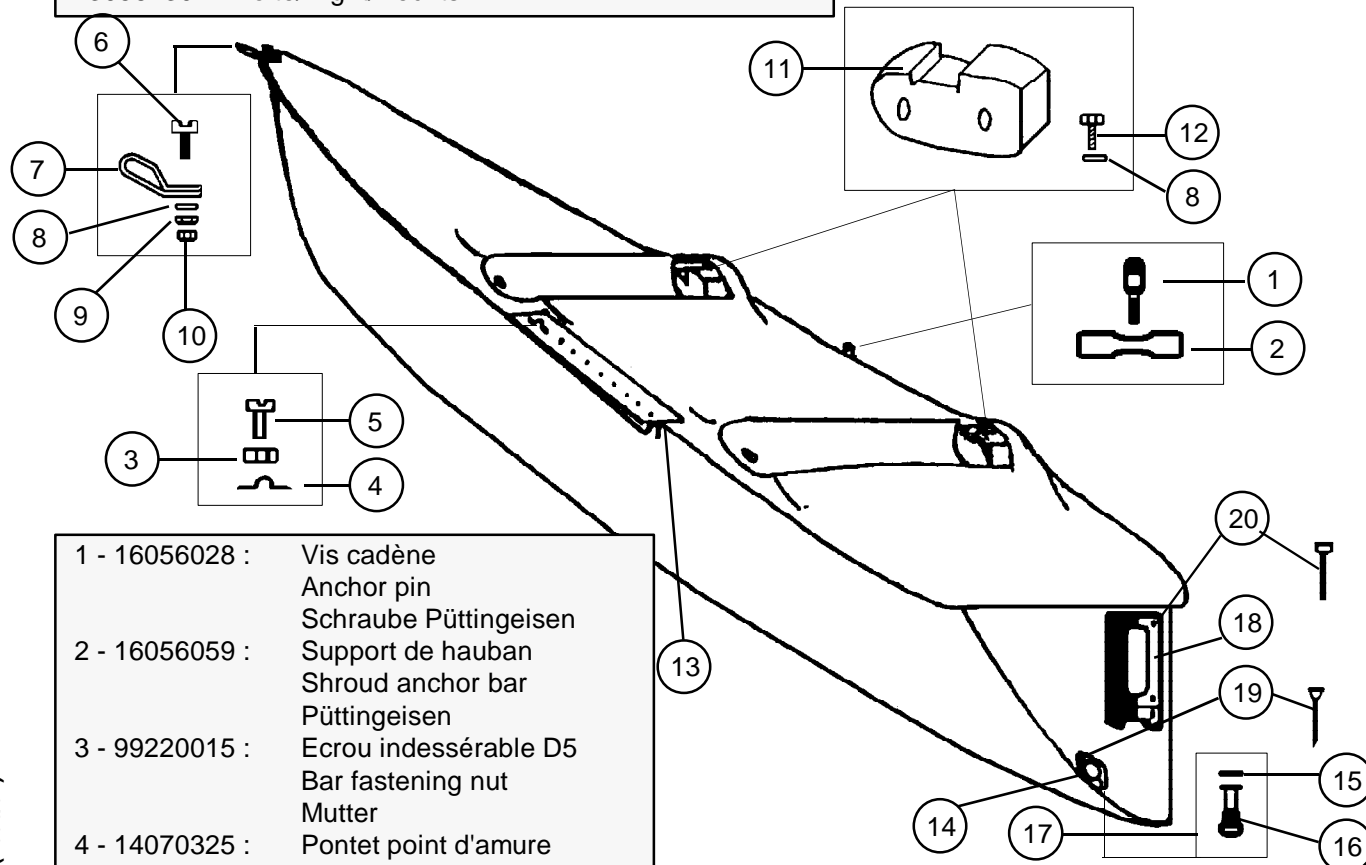

- 1 - 16056028 : Vis cadène
Anchor pin
Schraube Püttingeisen
- 2 - 16056059 : Support de hauban
Shroud anchor bar
Püttingeisen
- 3 - 99220015 : Ecrou indessérable D5
Bar fastening nut
Mutter
- 4 - 14070325 : Pontet point d'amure
Padeye for ratchet block
Bügel für Knarrblock
- 5 - 99220082 : Vis TC 5x25
TC screw 5x25
Schraube TC 5x25
- 6 - 99226002 : Vis TC 8x40
TC screw 8x40
Schraube 8x40
- 7 - 16056022 : Ferrure d'étau
Bow tang
Bugbeschlag
- 8 - 99061110 : Rondelle D8
Washer D8
Unterlegcheibe D8
- 9 - 99220002 : Ecrou nylon HU D8
99220062 (x50) : Nylon nut 08
Mutter nylon HU 08 Anlenkst.
- 10 - 99220012 : Ecrou indessérable D8
99220079 (x20) : Nut D8
99220080 (x50) : D8 Mutter
- 11 - 13056060 : Casting fixation traverse
Crossbar casting
Gusstück Holm
- 12 - 99220025 : Vis TH 8x50
Casting bolt
Schraube Gusst.

- 13- 13056030 : Rail de trampolin
Trampoline track
Trampolinschiene
- 14- 99056012 : Platine bouchon de vidange
Drain housing
Platte für Ablass-Schraube
- 15- 99220041 : Joint de vidange
Drain gasket
Dichtung für Ablass-Schraube
- 16- 99220040 : Bouchon de vidange
Drain plug
Ablass-Schraube
- 17- 99220043 : Joint + bouchon
(x10) : Drain plug + gasket
Ablass-Schraube + Dichtung
- 18- 14000030 : Femelot alu noir
Gudgeon
Heckbeschlag
- 19- 99220074 : Vis bouchon de vidange
Plug screw
Dichtung Schraube
- 20- 99226001 : Vis TC femelot
Gudgeon screw
Schraube Heckbeschlag

HC13 Coque/Hull/Rumpf

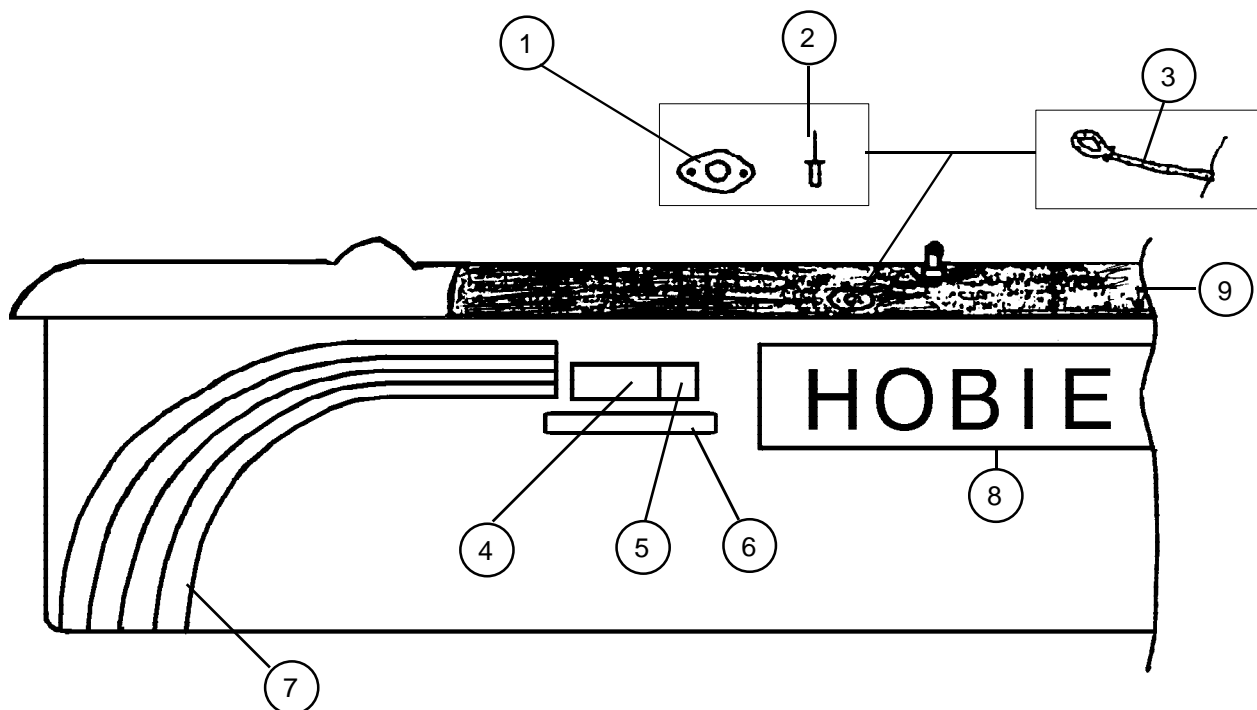

- | | |
|----------------|--|
| 1 - 18041740 : | Guide trapèze
Fairlead for trap. shock cord
Trapezführung |
| 2 - 99216002 : | Rivet 4 x 15,5
Rivet 4 x 15,5
Popniete |
| 3 - 18056036 : | Sandow trapèze
Trap. shock cord
Gummistrop Trapez |
| 4 - 99056002 : | Autocollant coque "Hobie"
Hull sticker "Hobie"
Aufkleber "Hobie" |
| 5 - 99056020 : | Autocollant coque "13"
Hull sticker "13"
Aufkleber "13" |

- | | |
|---|--|
| 6 - 99056023 : | Autocollant "made in.."
Sticker "made in .."
Aufkleber "made in .." |
| 7 - 99056071 : | Embout de bande Boomer (jeu)
Boomer hull stripe end
Endstück Dekorstreifen |
| 8 - 99056038 : | Autocollant Hobie Cat 150 mm
Hobie Cat sticker 150 mm
Aufkleber Hobie Cat 150 mm |
| 9 - Néoprène anti-dérapant:/Anti-skid neoprene/
Neopren-Antirutsch-Belag | 99506050
99506090 (x50)
99506091 (x100)
99506092 (x4) +colle/+glue/+Klebstoff |

HC 13 Safran/Rudder/Ruderblatt

GOVERNAIL COMPLET/RUDDER ASSEMBLY RUDER KOMPLETT

13062120 : Gauche ABS/Left ABS/Links ABS
13062125 : Droit ABS/Right ABS/Rechts ABS

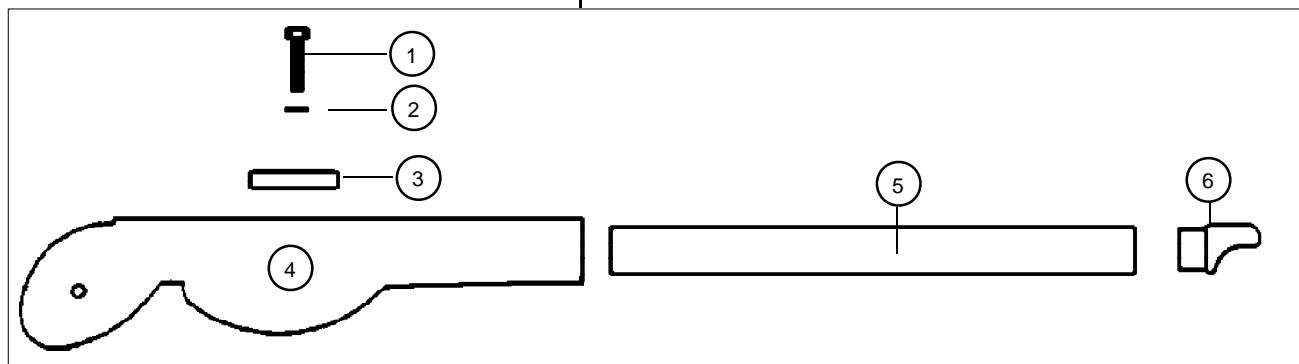

1 -99221123 : Vis casting Casting Bolt Schraube Gusteil	5 -13062160 : Tube gouvernail nu noir Black tiller tube Ruderrohr schwarz roh	99220066 (x50)
2 -99061110 : Rondelle Washer Unterlegscheibe	6 -Embout à rotule/Tillerend cap/ Pinnenendstück	8 -99220012 : Ecrou nylstop Nylon nut
3 -14061122 : Platine dural Can stop plate Platin Rudergusteil	99000005 (jusqu'à/till/bis 09/96) 99061105(à partir de/as from/ab 09/96)	99220079 (x20) Nylon Mutter 99220080 (x50) Nylon Mutter
4 -14000045 : Casting supérieur Upper rudder casting Oberes Rudergusteil	7 -Vis de safran/Rudder bolt/Schraube Ruderblatt ABS = TH 8x55 99220150 WK = TH 8x60 :99220003	9 - 16062110 (LEXAN):Lame safran 99502140 (WK) Rudder blade Ruderblatt
		10 - 99502160(ABS): Insert lame de safran 99502130 (WK)) Rudder blade sheave pin Bolzen Ruderblatt
		11 -Came safran/Plastic Cam/Rudernock 14061180 14061170 (x3)

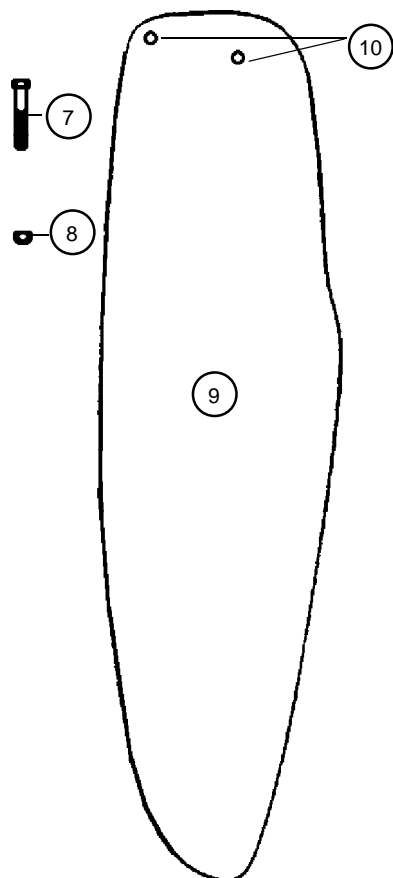

14061181 (x20)	14061182 (x50)
12 - 99220008 : Goupille élastique Rudder cutter pin Sprengbolzen	
13 - 14000050 : Casting inférieur nu Bare lower rudder casting Ruderkopf	
14 - 14061105 : Pene safran Plunger Nylon Buchse	
15 - 99220004 : Ressort de Gouv. Rudder spring Ruder-Feder	
16 - 99220006 : Vis safran delrin Delrin screw Delrinschraube	
17 - 14062120 : Casting inférieur monté Lower casting assembly Ruderkopf montiert	
18 - 13062130 : Bras gouv. D complet Compl. rudder arm right Ruderarme rechts kompl.	
13062135 : Bras gouv. G complet Compl. rudder arm left Ruderarme links kompl.	
19- 16080340 : Aiguillot + goupille 16080345 (X10) : Rudder pin + cotter pin Rudderbolzen + Splint	

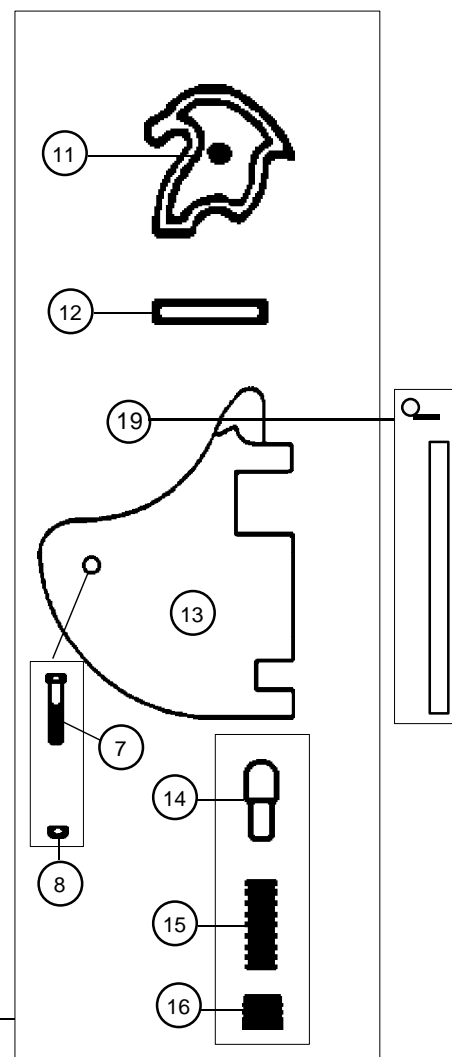

HC13

Traverse avant/Front crossbar Vorderholm /13062680

- 1 - 14000025 : Emplanture de mât
Maststep
Mastfuss
- 2 - 99216005 : Rivet inox 4,8 x 17,5
Inox rivet 4,8 x 17,5
Popniete 4,8 x 17,5

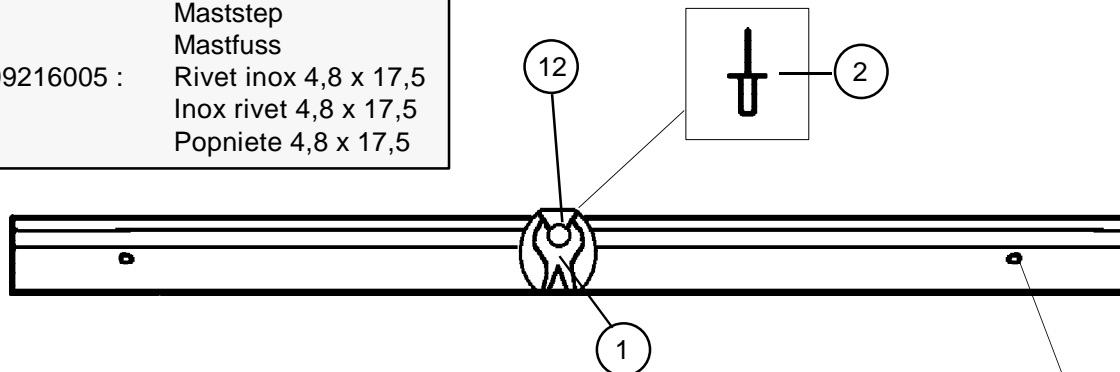

HC13

Traverse arrière/Rear crossbar Achterholm /13062690

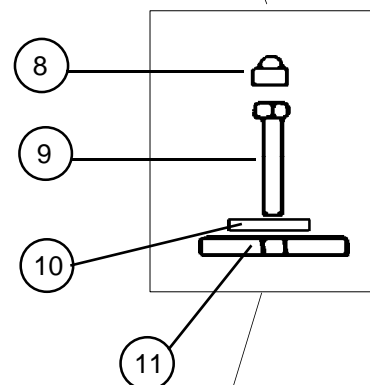
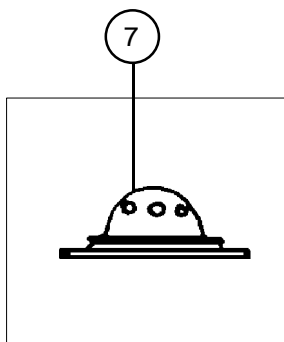
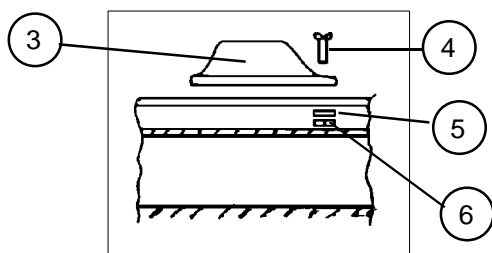

- 3 - 18062815 : Taquet de bôme
Boom clam cleat
Baum Klemme
- 4 - 99220018 : Vis TC 4x12
Screw TC 4x12
Schraube TC 4x12
- 5 - 99220032 : Rondelle
Washer
Unterlegscheibe
- 6 - 99220052 : Ecrou carré
Square nut
Viereckmutter
- 7 - 13062515 : Chariot de grand voile
Main sail traveller
Gross-Segel Traveller

- 8 - 99210045 : Capuchon de vis
Screw cap
Schraube Endstück
- 9 - 99220170 : Vis TH 8x1110
Screw TH 8x110
Schraube TH 8x110
- 10 - 99061110 : Rondelle
Washer
Unterlegscheibe
- 11 - 16056059 : Support de hauban
Shroud anchor bar
Püttingeisen
- 12-14041707 (x1) Coussinet teflon
14041708 (x5) Mast pivot bearing
Teflonkugel

HC 13
Barre d'accouplement
Tiller crossbar
Anlenkstange
13062200

(jusqu'à/till/bis Sept 1996)

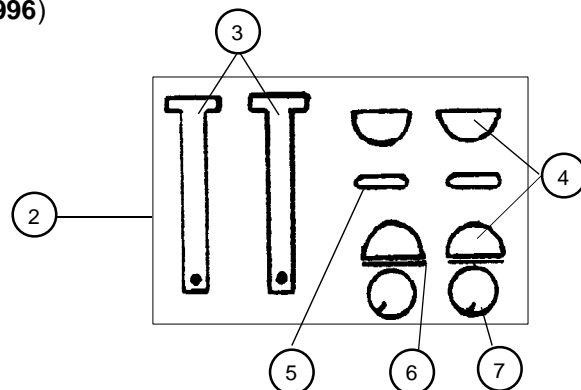
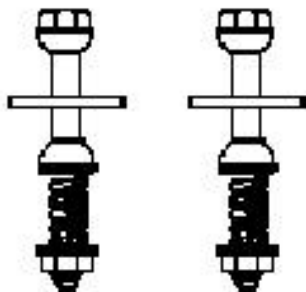

4 - 99220029:	Demi-bille nylon Half ball nylon Nylon Kugel halb
5 - 99220030:	Rondelle néoprène Rubber washer Neoprene Unterlegscheibe
6 - 99220032:	Rondelle inox Stainless washer Scheibe f. Anlenkstangengelenk
7 - 99220031:	Anneau brisé Split ring Offener Ring

8 - 13062305:	Stick aluminium Aluminium Tiller extension Pinnenausleger alu
9 - 14061315:	Embout stick fibre Fibreglass extension cap Pinnenendstück Fiberglass
10- 99000005:	Embout à rotule Extension tip Pinnenendstück
11- 14061320:	Chape articulation stick Yoke connection Pinnenausleger-Gelenk

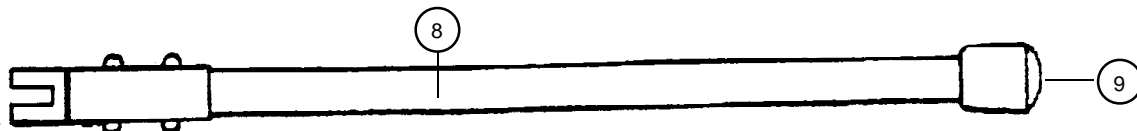

12- 14061240:	Axe percé art. stick Clevis pin Bolzen f. Pinnenausleger-Gelenk
13- 99220010:	Vis manillon barre d'accoupl. 99220069 (x20) Rudder adjuster screw Schraube f. Schäkel Anlenkst
14- 99220011:	Ecrou HU M8 99220073 (x20) Nut 08 Mutter HU M8

15- 99220012:	Ecrou indesserrable 99220079 (x20) Nylstop nut 99220080 (x50) Mutter Nylstop Inox
16- 99000010:	Coulisseau réglable Adjustable tiller end Gleiter
17 - 13062230 :	Barre accoupl. nue Bare tiller crossbar Anlenkstangenrohr

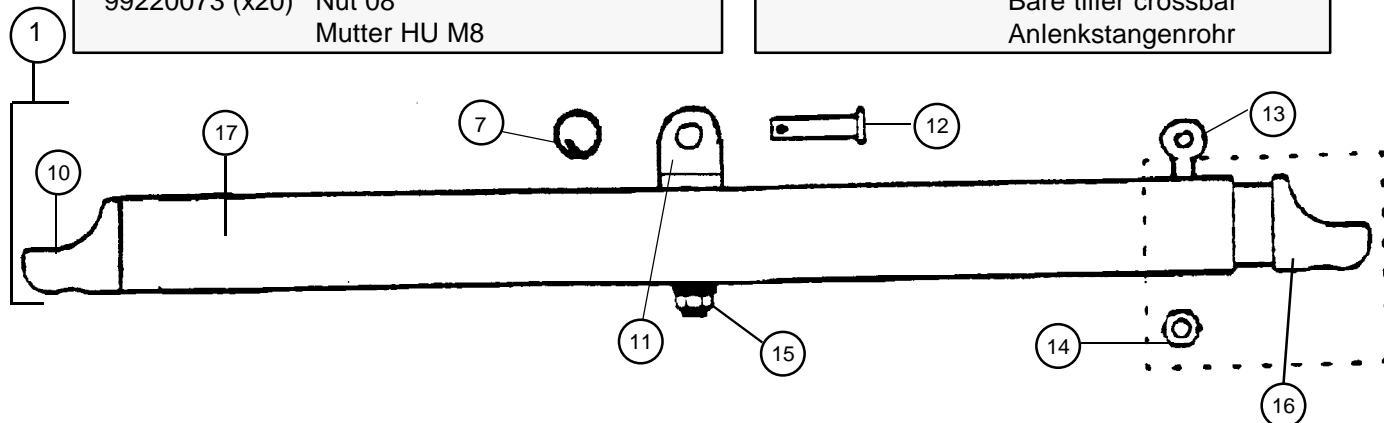

Nouveau/New/Neu

HC 13 **Barre d'accouplement** **Tiller crossbar** **Anlenkstange** **18062275**

A partir de/as from/ab Sept. 1996

1 - 14070320:	Kit articulation std Tiller connector kit Verbindungsgelenk
2 - 14061245:	Axe barre Tiller connector pin Anlenkstange Bolzen
3 - 99220029:	Demi-bille nylon Half ball nylon Nylon Kugel halb

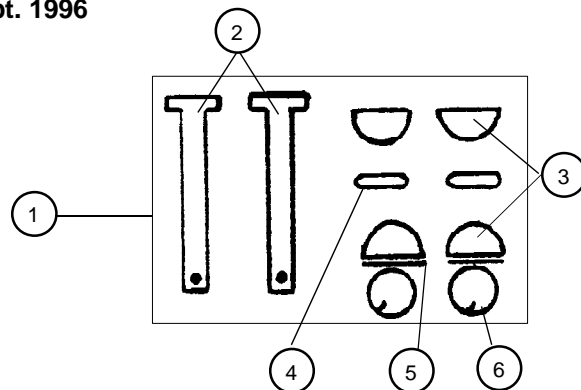

4 - 99220030:	Rondelle néoprène Rubber washer Neoprene Unterlegscheibe
5 - 99220032:	Rondelle inox Stainless washer Scheibe f. Anlenkstangengelenk
6-99220230 (x10):	Anneau brisé Split ring
99220131 (x50)	Ringsplint
7 - 13062305:	Stick aluminium Aluminium Tiller extension Pinne alu

8 - 14061315:	Embout stick fibre Stick end cap fibreglas Pinnenendstück Fiberglass
9 - 99061703:	Kit coulisseau (x1) Adjustable tiller end (x1) Gleiter (x1)
10- 14061320:	Chape articulation stick Yoke connection Pinnengelenk
11- 14061240:	Axe percé art. stick Clevis pin Bolzen f. Pinnengelenk

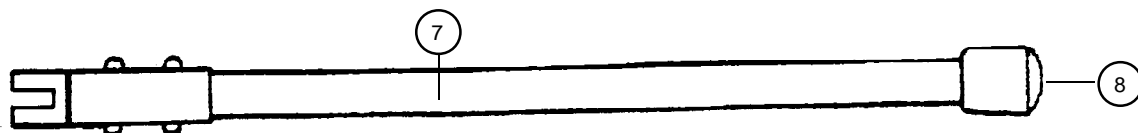

12- 99220012:	Ecrou indesserrable Nylstop nut
99220079 (x20)	
99220080 (x50)	Mutter Nylstop Inox

13 - 13062290 :	Barre accoupl. nue Bare tiller crossbar Anlenkstangenrohr
-----------------	---

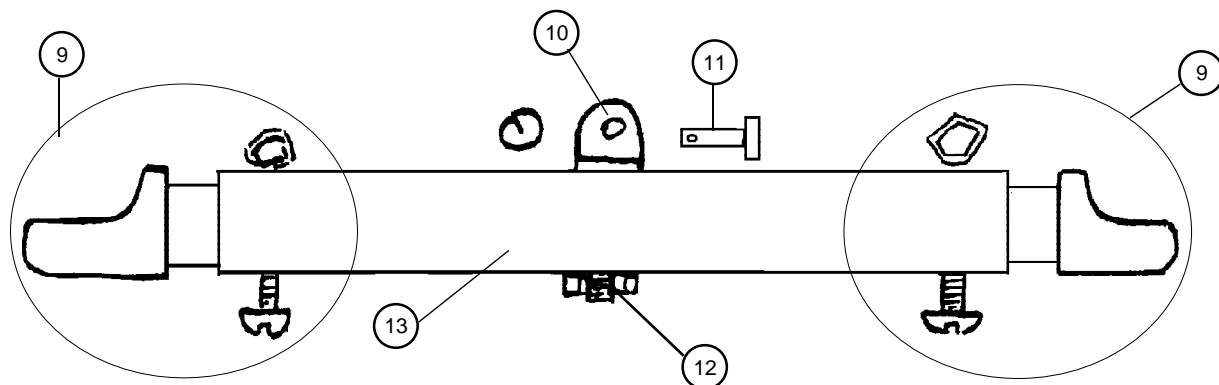

13042745 : Mât HC 13 2 pièces
2-piece mast HC 13
Mast HC13 komplett 2teilig

HC 13

Mât/Mast/Mast

13042720

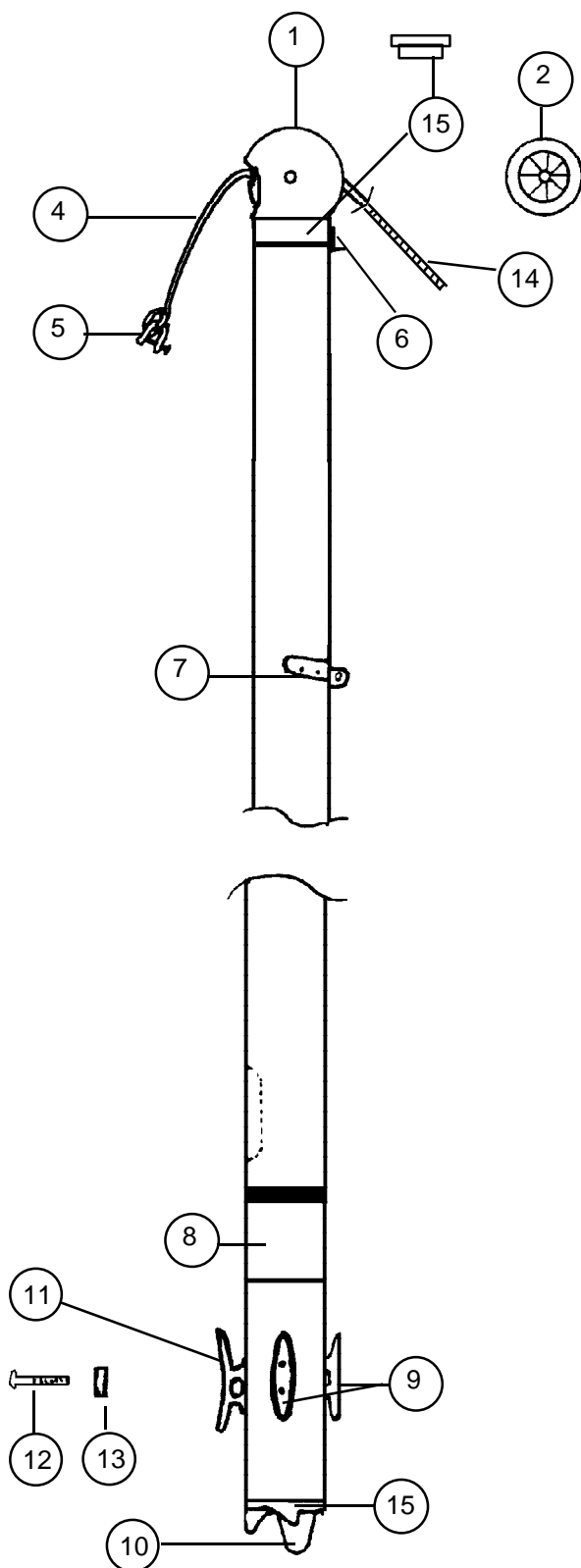

- | | |
|----------------|---|
| 1 - 14000015 : | Tête de mât
Mast head
Mastkopf |
| 2 - 14041712 : | Réa 100 mm
Nylon sheave D 100 mm
Rolle D 100 mm |
| 3 - 14041711 : | Axe tête de mât
Mast head sheave pin
Bolzen Mastkopf |
| 4 - 13041750 : | Drisse cable grand voile
Main halyard wire
Grossfall Kabel |
| 5 - 99220035 : | Manille lyre 6 mm |
| 99220092 (x20) | Shackle 6 mm |
| 99220093 (x50) | Schäkel 6 mm |
| 6 - 14041721 : | Hook de drisse
Halyard hook
Fallhaken |
| 7 - 14041722 : | Ferrure de capelage
Mast tang
Mastbeschlag |
| 8 - 14041723 : | Autocollant de sécurité
Mast caution label
Sicherheitsaufkleber |
| 9 - 99220050 : | Taquet de drisse
Halyard Cleat
Niederholer Mastklemme |
| 10-14000020 : | Base de mât
Mast base
Mastfuss |
| 11- 14041715 : | Taquet étarq. amure
Downhall cleat
Klampe |
| 12- 99220051 : | Vis taquet amure
Tack cleat screw
Schraube Heckbeschlag |
| 13- 99220052 : | Ecrou carré amure
Tack square nut
Viereckmutter |
| 14- 13060510 : | Drisse cordage grand voile
Main halyard rope
Grossfall Leine |
| 15- 14042720 : | Sceau de mât PVC
Mast plug
Mast Abdichtung |

HC 13

Haubans/Shrouds/Wanten

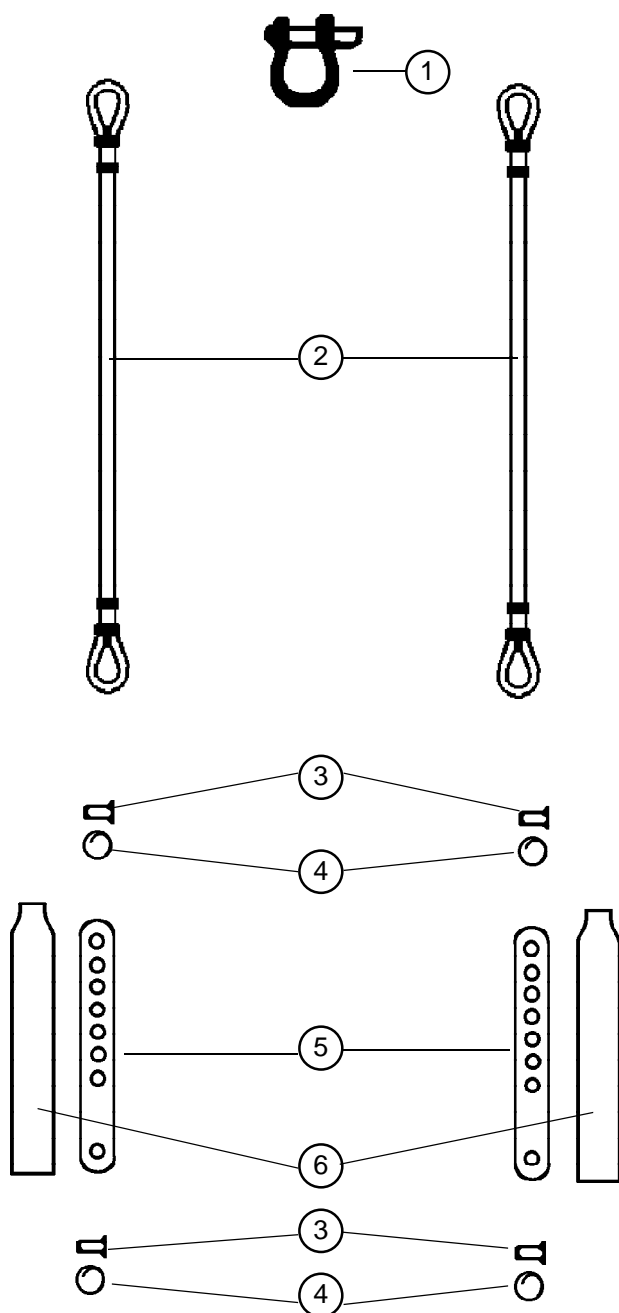

- | | | |
|----|---|--|
| 1- | 99220035:
99220092 (x20)
99220093(x50) | Manille Lyre 6 mm
Bow shackle 6 mm
Mast Schäkel 6 mm |
| 2- | 13080540: | Hauban
Shroud
Want |
| 3- | 99220034:
99220081 (x50) | Axe percé lat.ridoir
Clevis pin
Bolzen für Wanteisen |
| 4- | 99220031:
99220131 (x50)
99220230 (x10) | Anneau brisé
Split ring
Offener Ring |
| 5- | 99220033: | Latte universelle
Stay adjuster
Wanteisen |
| 6- | 99500360:
99500363 (x2)
99500364 (x20) | Protège lattes ridoires
Shroud adjuster cover
Wantenschutz |

HC 13

Trapèze/Trapeze/Trapez

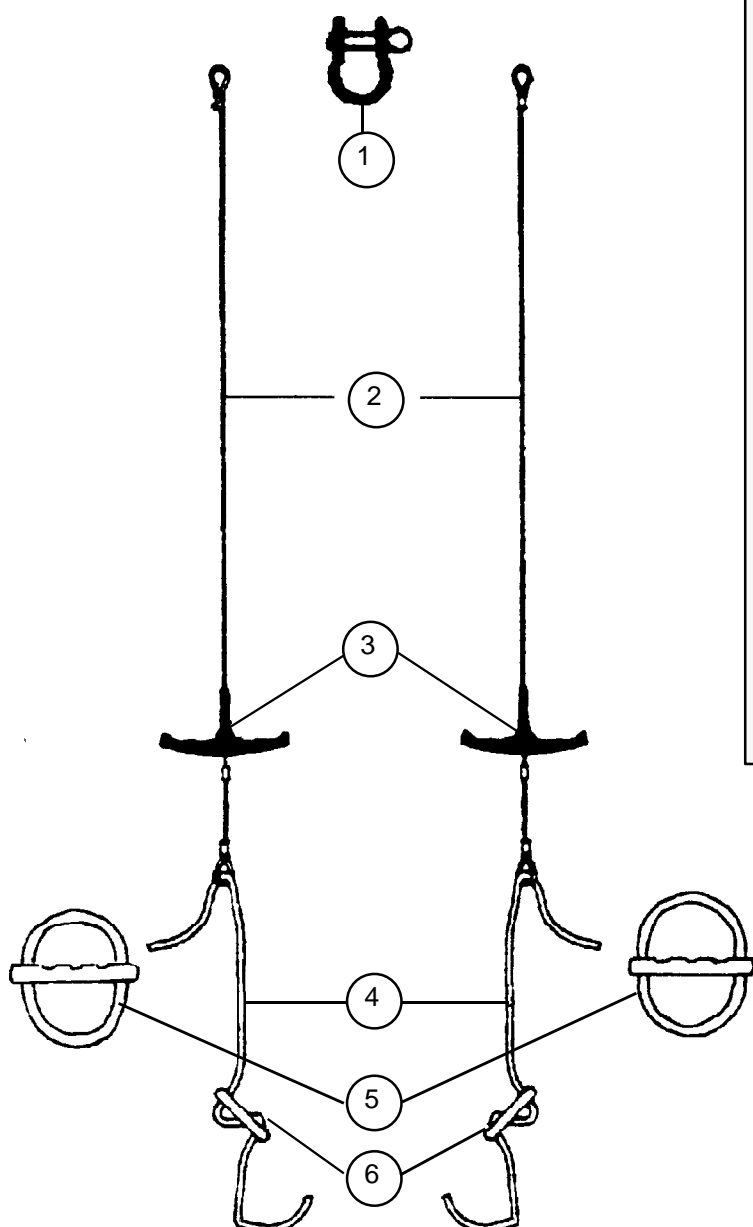

- | | |
|------------------|--------------------|
| 1- 99220035: | Manille Lyre 6mm |
| 99220210 (x10) | Shroud shackle 6mm |
| | Mast Schäkel 6mm |
| 2- 13080530: | Cable trapeze |
| | Trapez wire |
| | Trapezkabel |
| 3- 16080552: | Poignée Trapèze |
| | Trapeze handle |
| | Trapezgriff |
| 4- 16080554: | Cordage trapèze |
| | Trapeze line |
| | Trapezleine |
| 5- 99500040 (x2) | Poignée J&H |
| 99500032 (x20) | Handle J&H |
| | Griff J&H |
| 6- 18060301: | Double anneau |
| 18060312 (x20) | Rope lock |
| 18060313 (x40) | Trapezstopper |

TRAPEZE KIT :
13070570

HC 13

Trampolin/Trampoline/Trampolin

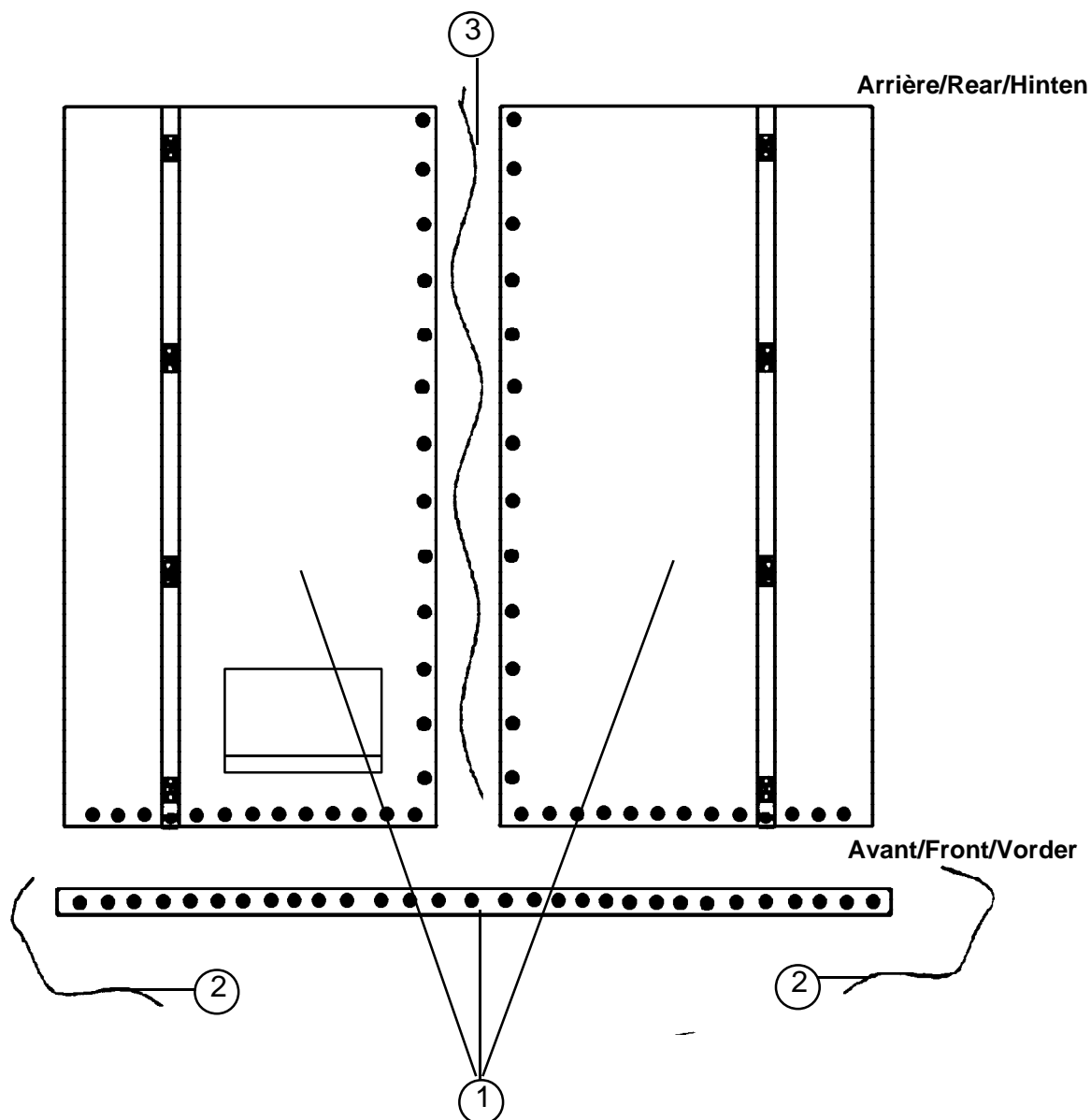

- | | |
|---|---|
| 1 - TRAMPOLIN 3 PIECES/3 PIECE TRAMPOLINE/3TEILIGER TRAMPOLIN | |
| 13025285 | blanc/white/weiss |
| 13025245 | Bleu/blue/blau |
| 2 - 14040410: | Lacet arrière/Rear trampoline line/Trampolinleine hinten |
| 3 - 14070440: | Lacet central/Center trampoline line/Mitte Trampolinleine |

HC 13
Grand-voile/Main sail/Gross-Segel

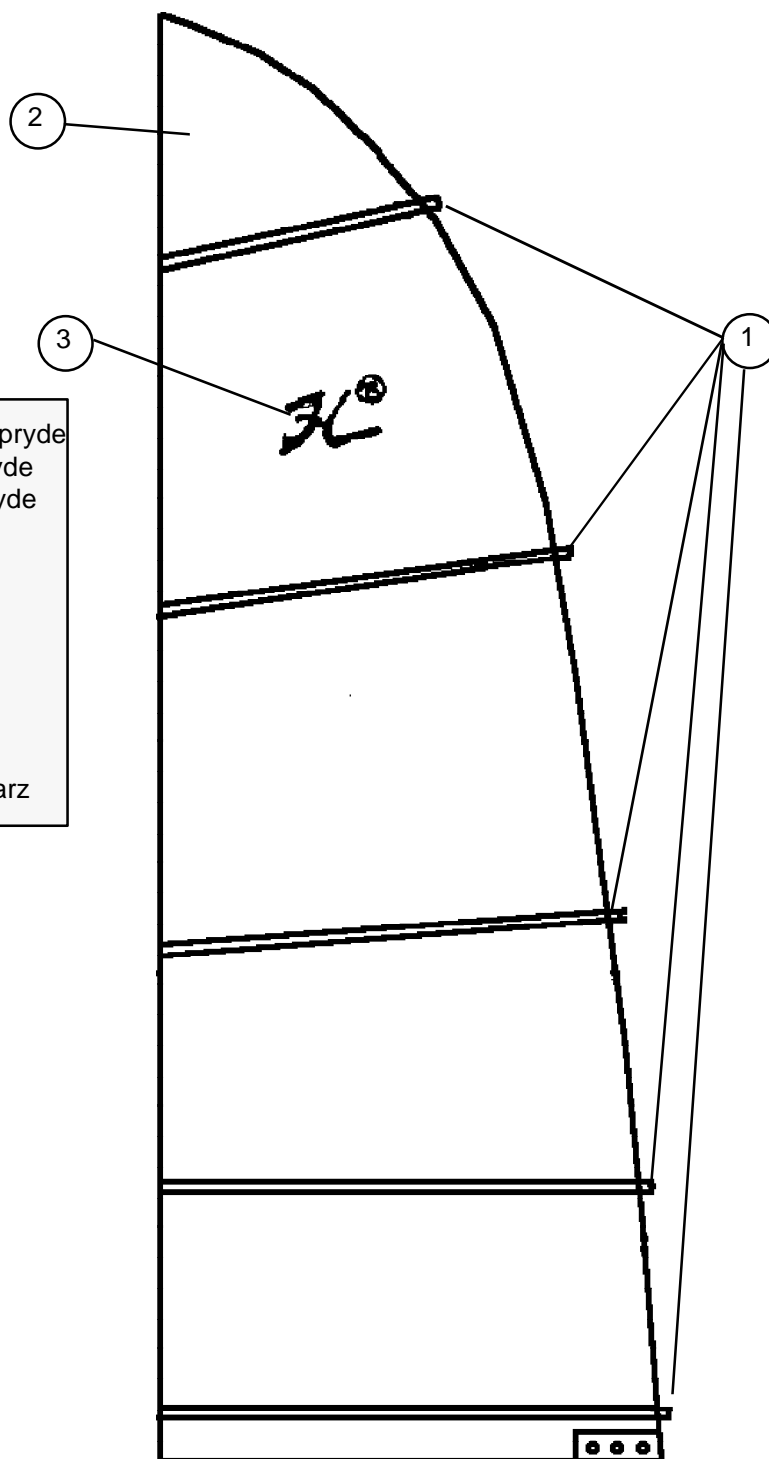

1 - 13034005 : Jeu de lattes T Neilpryde
Batten set T Neilpryde
Lattensatz T Neilpryde

2 - Grand voile /Main sail/Gross-Segel
Pour les couleurs voir tarif
For colors see price list
Farben siehe Preisliste

3 - 99267286 : Autocollant "H" noir
Black "H" sticker
Aufkleber "H" schwarz

HC13
Foc/Jib/Fock

Pour les couleurs voir tarif
For colors see price list
Farben siehe Preisliste

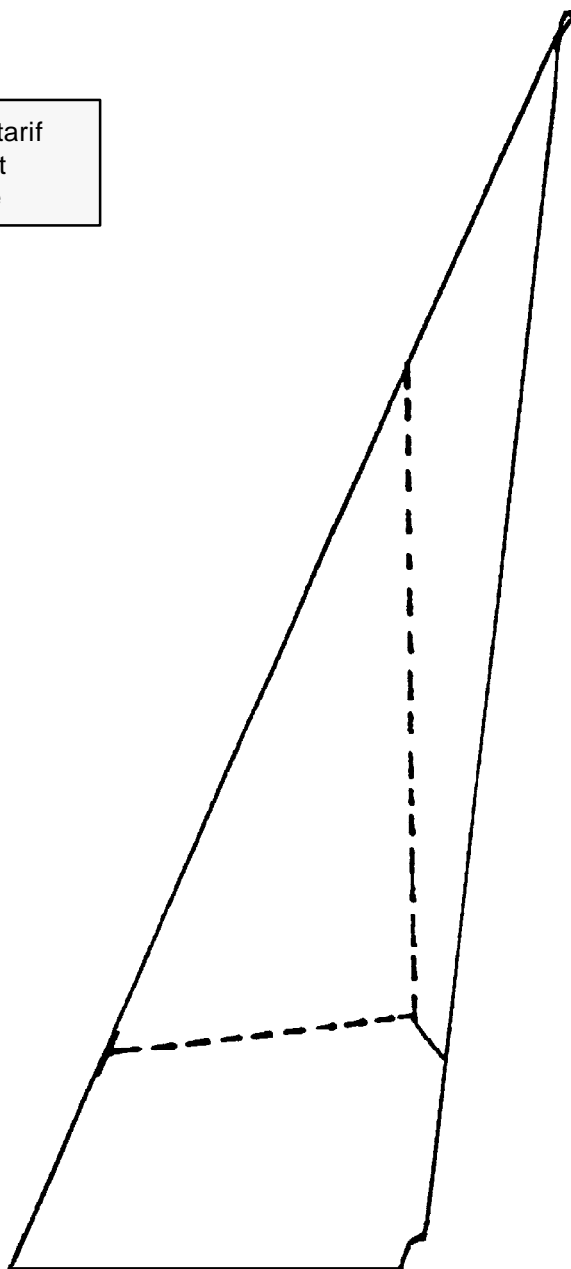

HC 13

Poulies/Main blocks/Blöcke

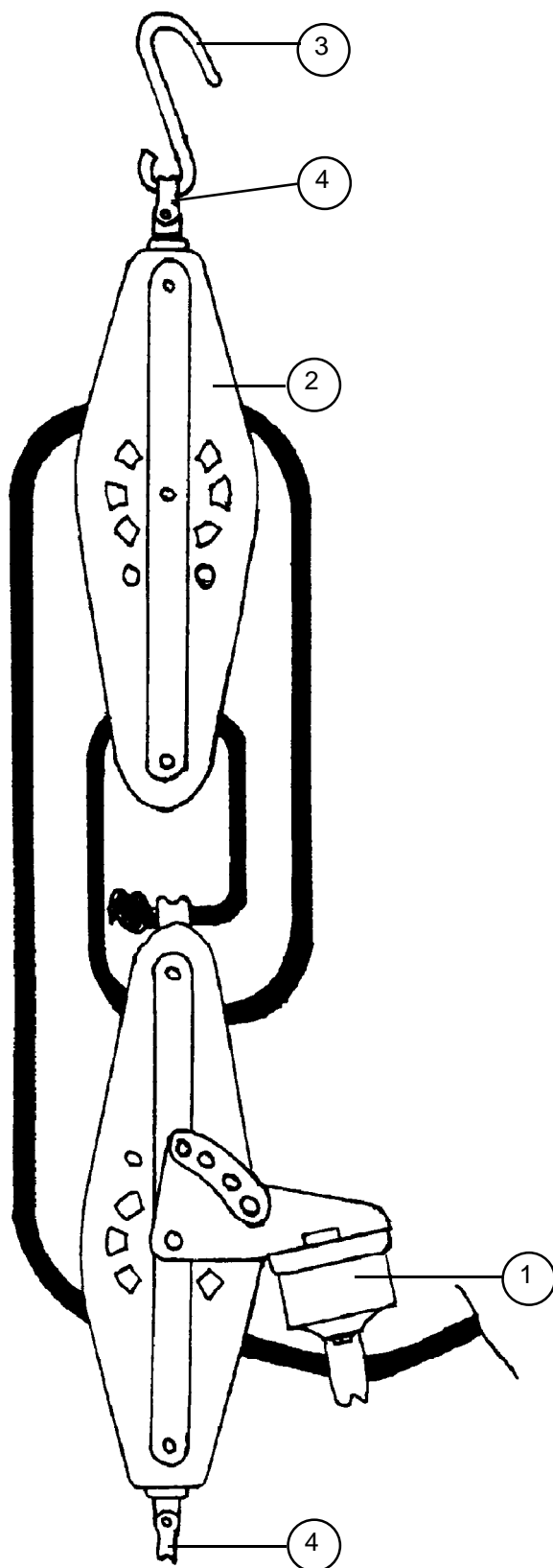

1 - 13080320 :	Poulie grand voile avec taquet Main block with cam cleat Block Gross-Segel mit Klemme
2 - 13080330 :	Poulie grand voile avec émerillon Main block with swivel Block Gross-Segel mit Wirbel
3 - 99500210 :	Crochet grand voile Main hook Großsegel Haken
4 - 18060007 :	Manille de poulie Block shackle Blockschäkel

Etai, drisse de foc, bride
Forestay, jib halyard, bridle
Vorstag, Fockfall, Hahnepot

- | | |
|---|--|
| 1- 13062635: | Etai cable + estrope
Forestay + pig tail
Vorstag Kabel + Pigtail |
| 2- 99300051: | Manchon
Nicopress sleeve
Hülse |
| 3- 99300053: | Cosse std
Thimble
Kausch std |
| 4- 99220036: | Manille de poulie
Block shackle
Block Schäkel |
| 5- 16080515: | Poulie drisse foc (grande)
Jib Halyard block (large)
Fockfallumlenkblock gross |
| 6- 13060520: | Cordage drisse de foc
Rope jib halyard
Fockfall-Leine |
| 7- 16080516: | Poulie drisse foc (petite)
Jib halyard block (small)
Fockfallumlenkblock klein |
| 8- 99220031:
99220131 (x50)
99220230 (x10) | Anneau brisé
Split ring
Offener Ring |
| 9- 99220034:
99220081 (x50) | Axe percé
Clevis pin
Bolzen für Locheisen |
| 10- 99220033: | Latte universelle
Stay adjuster
Locheisen |
| 11- 99220035:
99220092 (x20)
99220093 (x50) | Manille lyre 6mm
Shackle 6 mm
Schäkel 6 mm |
| 12- 13070540: | Bride
Bridle
Hahnepot |
| 13- 13080340: | Poulie de foc
Jib sheet block
Fockblock Turbo |

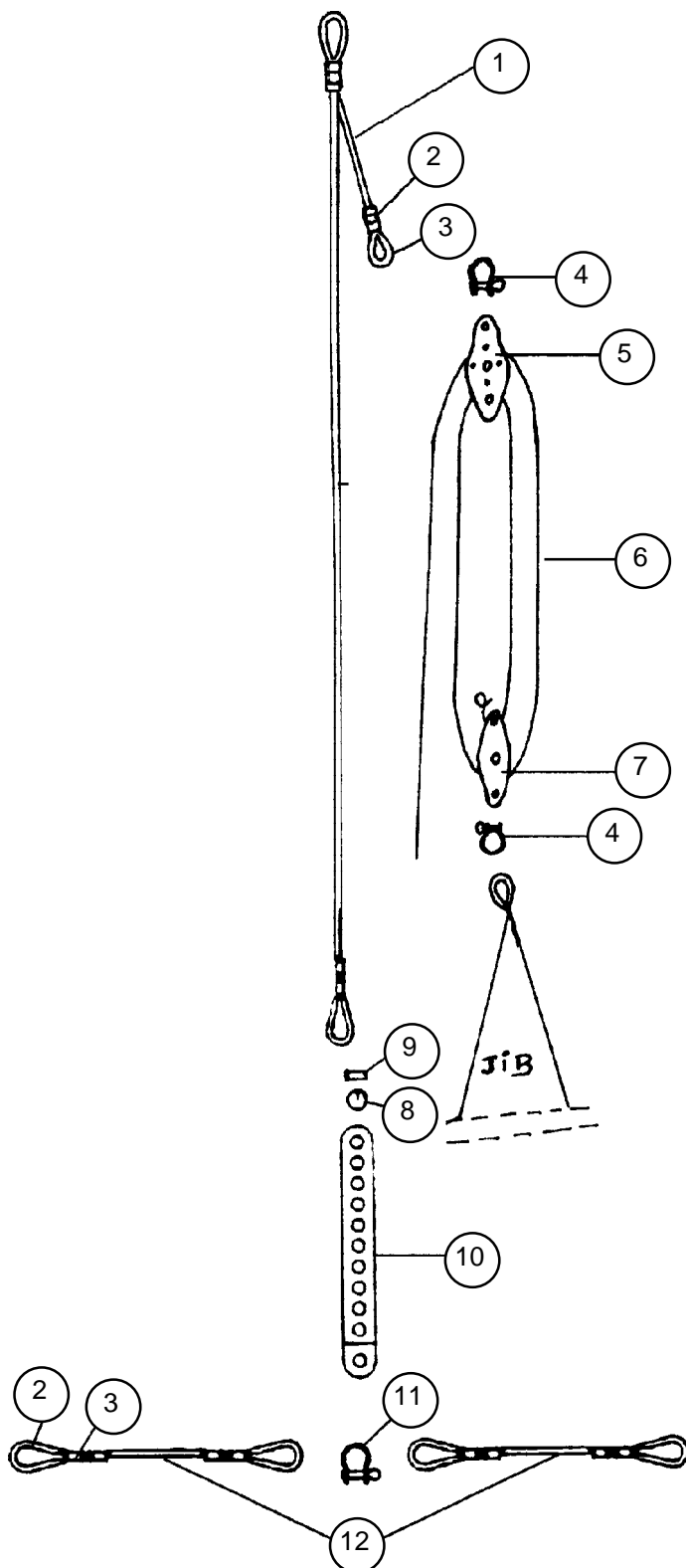
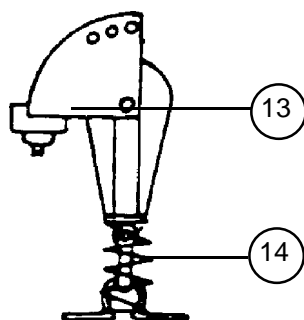

- | | |
|---------------|---|
| 14- 18060142: | Ressort poulie ecoute foc
Jib sheet block spring
Feder für Fockschotblock |
|---------------|---|