



15

Eclaté des pièces détachées

Illustrated Part Guide - Explosionszeichnung

HOBIE CAT 15 CLUB



HOBIE 15 CLUB Coque/Hull/Rump

Droite/right/rechtsGauche/left/links
15556065 15556060

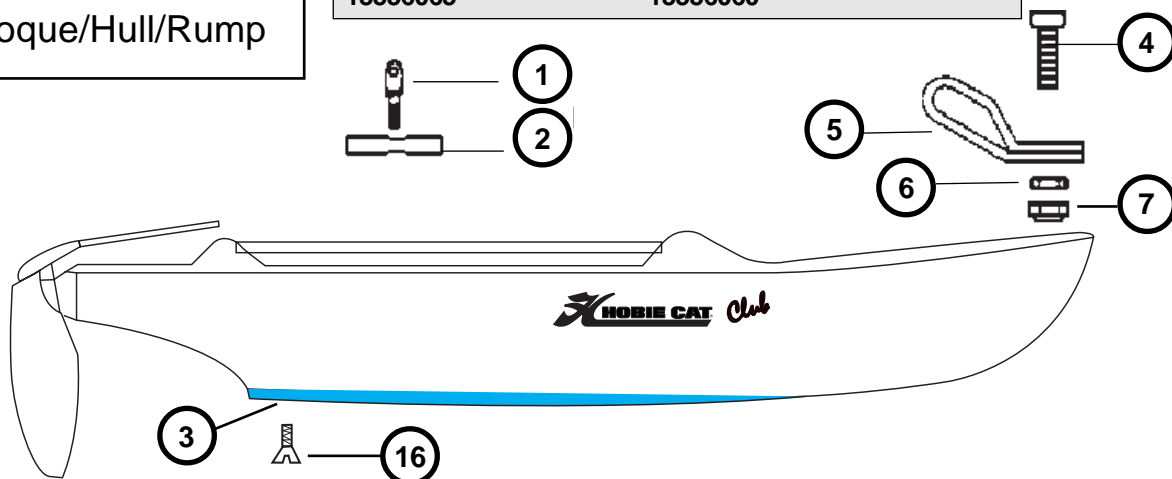

- 1- 16056029 (x4): Vis Cadène hauban
Anchor pin
Schraube Püttingeisen
- 2- 16056059: Support de hauban
Shroud anchor bar
Puttingeisen
- 3- 15556150 : Kit quille + vis
Kit keel + bolts
Kielsystem + Schraube
- 4- 99220950 (x10): Vis TC
Screw TC
Schraube
- 5- 16056022: Ferrure étai
Bow tang
Bugbeschlag
- 6- 99056235 (x10) : Ecrou nylon safran
Rudder nylon nut
Nylon Mutter Ruderblatt
- 7- 99056239 (x10) : Ecrou indessérable
Nylstop nut
Selbstsichernde Mutter
- 8 - 99220855 (x10) : Vis TC fémelot
Screw TC gudgeon
Schraube Heckbeschlag

- 9 - 18056005 : Fémelot + entretoises
Gudgeon + bushings
Ruderbeschlag
- 10- 99220845 (x10) : Vis bouch.vidange
Screw drain plug
Schraube Ablassschraube
- 11- 99056012 : Platine bouch.vidange
Drain plate
Platte Ablassschraube
- 12- 99220048 (x10) : Joint bouchon de vidange
Drain gasket
Dichtung Ablassschraube
- 13- 99056232 (x10) : Bouchon de vidange
Drain Plug
Ablassschraube
- 14- 99220043 : Joint + bouchon
(x10)
Drain plug + gasket
Ablassschraube + Dichtung
- 15- 99220128 (x10) : Entretoise fémelot
Bushing, gudgeon
Buchse Ruderbeschlag
- 16- 99220785 (x10) : Vis quille TF 6 x 60
Keel bolts TF 6 x 60
Kielschraube TF 6 x 60

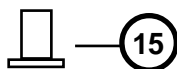
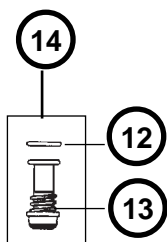
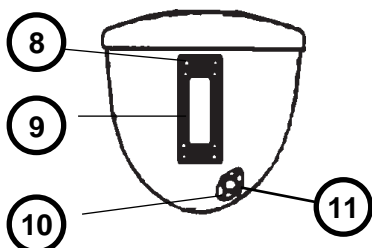

- 15570700 : Sac de cordages/Rope bag/Leinesack
- 15570600 : Sac accastillage/Rig bag/Takelagesack
- 15570800 : Jeu de câbles/cable set/Käbelsatz (2003)
- 15570510 : Jeu de câbles/cable set/Käbelsatz (2004)

HOBIE CAT 15 CLUB

Barre latérale + néoprène

Sidebar + neoprene

Seitenholm + Neopren

15562400 Gauche/Left/Links

15562405 Droite/Right/Rechts

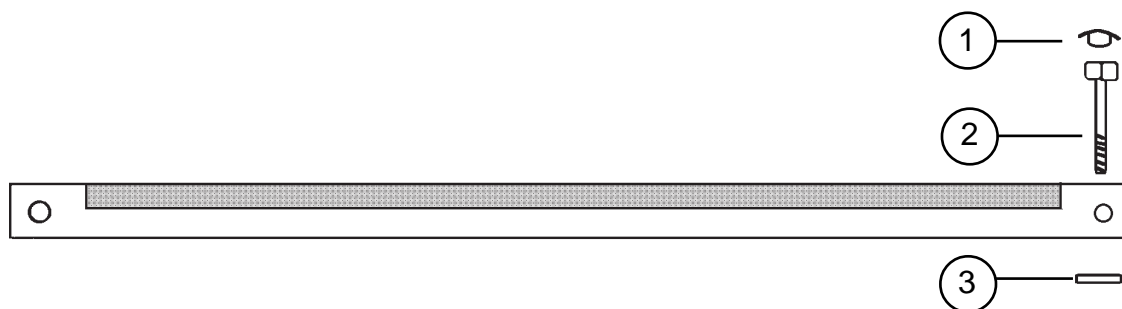

1 - 99210036 (x10) : Bouchon barre latérale
Sidebar end cap
Endstück Seitenholm

2 - 99220935 (x10) : Vis TH 8 x 50
Screw TH 8 x 50
Schraube TH 8 x 50

3 - 99220750 (x10) : Rondelles 08
Washer 08
Unterlegscheibe 08

Gouvernail droit complet/Rudder assy right complet
Ruderblatt komplett rechts : 15562105

HOBIE CAT 15 CLUB

Safran/Rudder/Ruderblatt

Gouvernail gauche complet/Rudder assy compl. left
Ruderblatt komplett links : 15562100

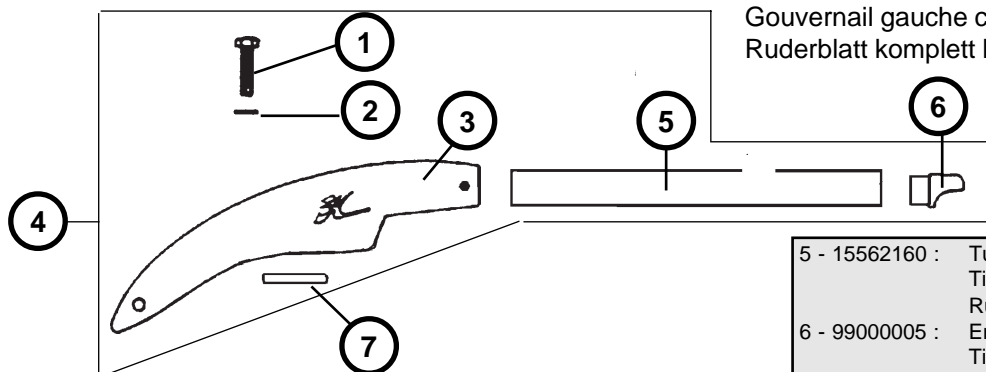

- | | | |
|----------------|--|------------------------------------|
| 1 - 99220930 : | Vis TH 8x30 casting
(x10) | Bolt rudder arm
Bolzen Ruderarm |
| 2 - 99220750: | Rondelle plate
(x10) | Washer
Unterlegscheibe |
| 3 - 17000010: | Casting supérieur gouv.
Upper rudder casting
Oberes Rudergehäuse | |
| 4 - 15562155: | Bras gouv.droit complet
Tiller arm right complete
Ruderarm rechts komplett | |
| 15562150: | Bras gouv.gauche complet
Tiller arm left complete
Ruderarm links komplett | |

- | | | |
|----------------|---|------------------------------------|
| 5 - 15562160 : | Tube de gouvernail
Tiller tube
Ruderrohr | |
| 6 - 99000005 : | Embout à rotule
Tiller extension tip
Pinnenendstück | |
| 7 - 14061122: | Platine dural
Cam stop plate
Platine f. oberes Rudergehäuse | |
| 8 - 14061183: | Came safran
(x10) | Plastic cam
Rudernock |
| 9 - 16041756: | Goupille élastique
(x10) | Pin
Sprengbolzen |
| 10 - 18062180 | Lame safran Lexan
Ruder blade Lexan
Ruderblatt Lexan | |
| 11- 99220940 : | Vis safran 8x55
(x10) | Rudder bolt
Schraube Ruderblatt |

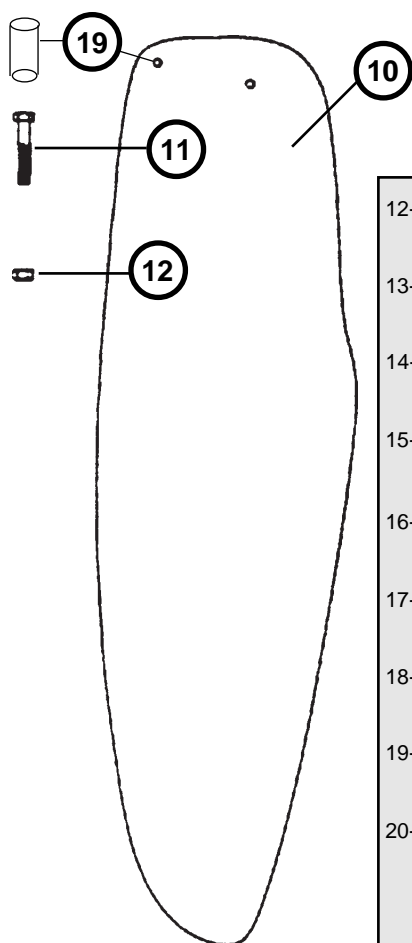

- | | | |
|----------------|--|---|
| 12- 99056239: | Ecrou indesserrable D8
(x10) | Nylstop nut
Selbstsichernde Mutter |
| 13- 18000155: | Casting inf. gouv
Lower rudder casting
Unteres Rudergehäuse | |
| 14- 15570355 : | Aiguillet+goupille
(x10) | Rudder pin + cotter pin
Rudernocken + Splitpin |
| 15- 99220622: | Goupille 2.5x20
(x10) | Cotter pin 2.5x20
Splitpin |
| 16- 14061106: | Pene safran
(x10) | Plunger
Gegenstück Rudernock |
| 17- 99220685: | Ressort inox
(x10) | Spring
Feder |
| 18- 99220825: | Vis safran delrin
(x10) | Delrin screw
Delrinschraube |
| 19- 99502160 : | Insert lame de safran
Rudder blade bushing
Buchse Ruderblatt | |
| 20- 17062680 : | Casting inf. gouv. monté
Lower rudder cast. assembly
Unteres Rudergehäuse montiert | |

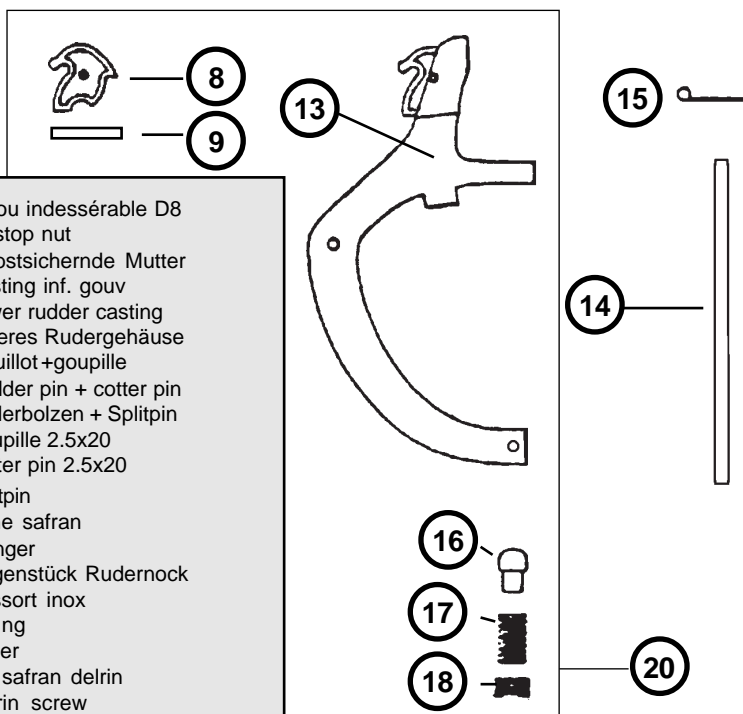

HOBIE 15 CLUB **Mât/Mast/Mast** **AVANT 2004 / PRIOR 2004 / VOR 2004**

MAT COMPLET/MAST ASSEMBLY/MAST KOMPLETT

15042700 = 1 pièce/1-piece/1-teilig
15042750 = 2 pièces/2-piece/2-teilig

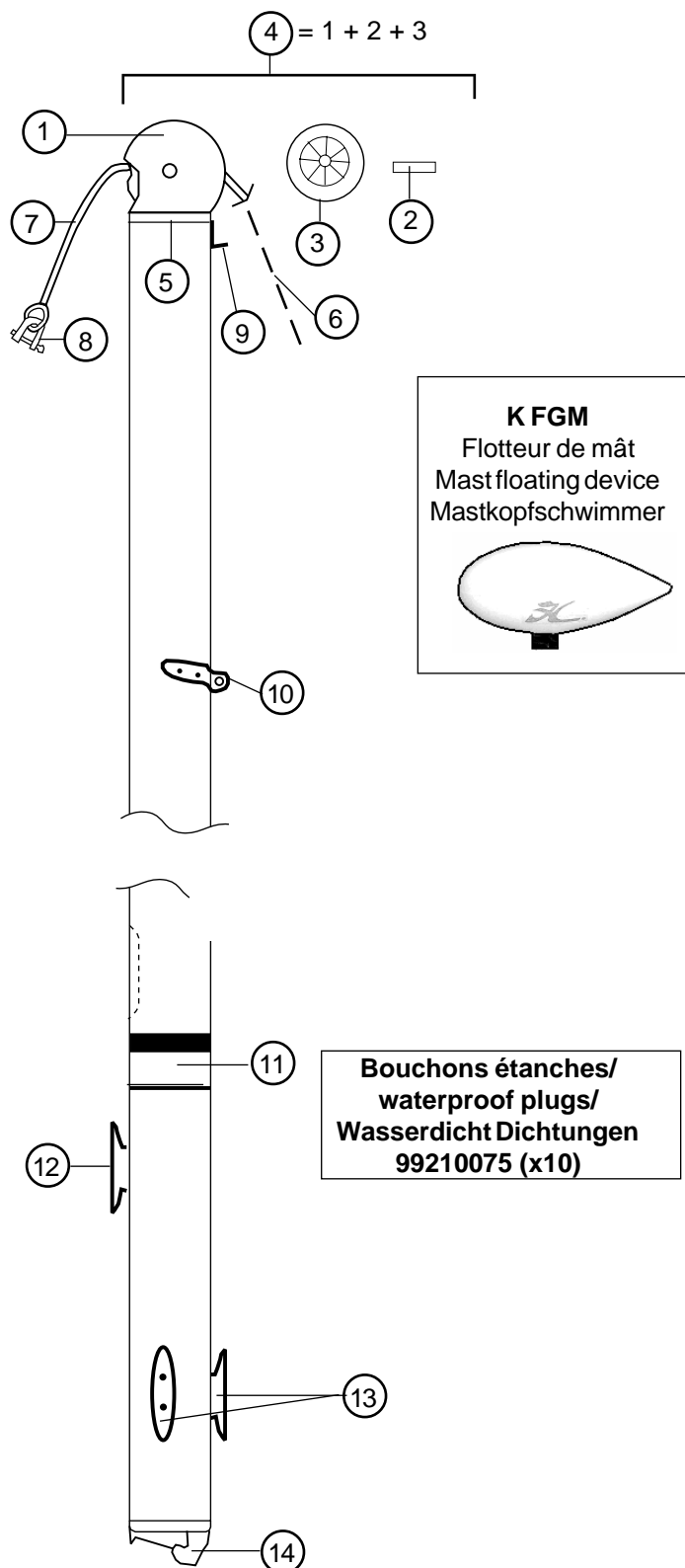

- 1- 16000005: Tête de mât noire
Black mast head
Mastkopf schwarz
- 2- 14041711: Axe tête de mât
Sheave pin mast head
Bolzen Mastkopf
- 3- 16041711: Rea tête de mat
Mast head nylon sheave
Mastkopfrolle
- 4- 16042710: Tête de mât complète
Mast head complete
Mastkopfkomplett
- 5- 16041753: Sceau Mât plastic
Mast plug nylon
Mast Abdichtung Nylon
- 6- 15041750: Drisse câble GV
Main halyard wire
Grossfall Kabel
- 7- 14070460: Drisse cordage
Main halyard rope
Großfall
- 8- 99220665 : Manille lyre D6
(x10)
Shackle D6
Schäkel D6
- 9- 14041721 : Hook de drisse
Halyard hook
Fallhaken
- 10- 16041721: Ferrure capelage
Mast tang
Mastbeschlag
- 11- 14041723: Autocollant de sécurité
Mast caution label
Sicherheitsaufkleber
- 12- 14041720: Taquet étarq amure
(x10)
Downhall cleat
Klampe
- 13- 99220760: Taquet de drisse
(x10)
Halyard cleat
Niederholer Mastklemme
- 14- 16000010: Base mât noire avant 2004
Black mast base prior 2004
Mastfuss schwarz vor 2004

HOBIE 15 CLUB **Mât/Mast/Mast** **2004**

MAT 15/15CLUB COMPLET/MAST ASSEMBLY/MAST KOMPLETT

15542700 = 1 pièce/1-piece/1-teilig

15542715 = 2 pièces/2-piece/2-teilig

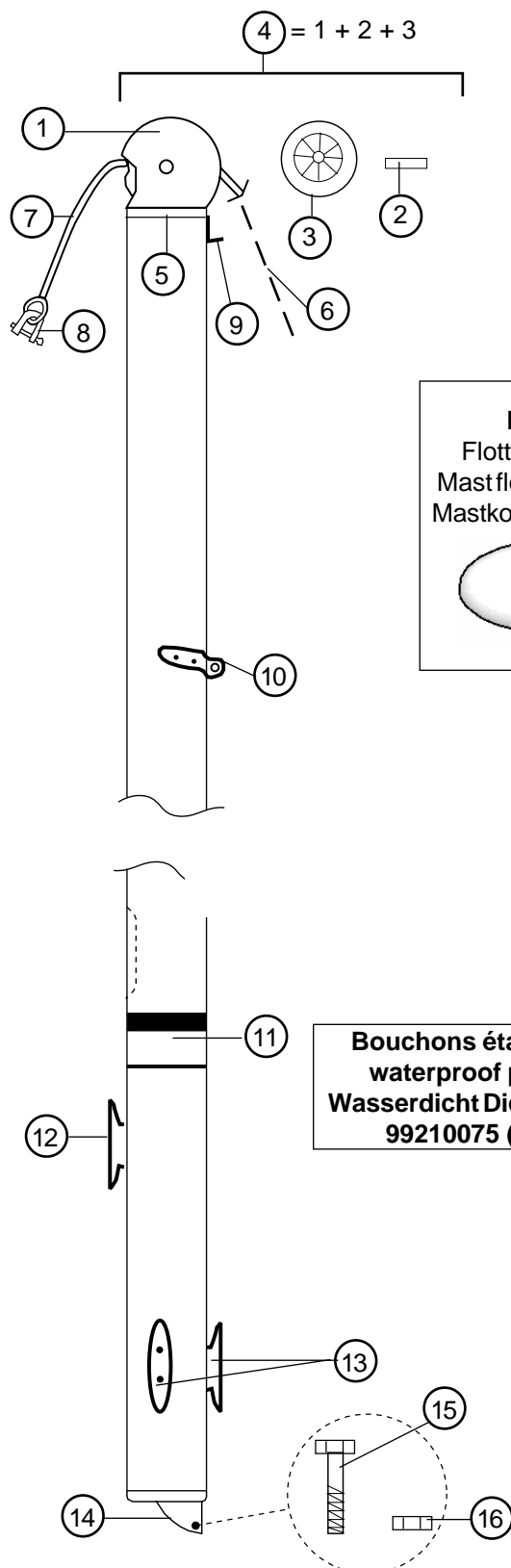

- | | |
|----------------|---|
| 1- 16000005: | Tête de mât noire
Black mast head
Mastkopf schwarz |
| 2- 14041711: | Axe tête de mât
Sheave pin mast head
Bolzen Mastkopf |
| 3- 16041711: | Rea tête de mat
Mast head nylon sheave
Mastkopffrolle |
| 4- 16042710 | Tête de mât complète
Mast head complete
Mastkopfkomplett |
| 5- 16041753: | Sceau Mât plastic
Mast plug nylon
Mast Abdichtung Nylon |
| 6- 15041750: | Drisse câble GV
Main halyard wire
Grossfall Kabel |
| 7- 14070460: | Drisse cordage
Main halyard rope
Großfall |
| 8- 99220665 : | Manille lyre D6
(x10)
Shackle D6
Schäkel D6 |
| 9- 14041721 : | Hook de drisse
Halyard hook
Fallhaken |
| 10- 16041721: | Ferrure capelage
Mast tang
Mastbeschlag |
| 11- 14041723: | Autocollant de sécurité
Mast caution label
Sicherheitsaufkleber |
| 12- 14041720: | Taquet étarq amure
(x10)
Downhall cleat
Klampe |
| 13- 99220760: | Taquet de drisse
(x10)
Halyard cleat
Niederholer Mastklemme |
| 14- 14500010: | Base mât noire 2004
Black mast base 2004
Mastfuss schwarz 2004 |
| 15- 99220116: | Vis TH 6x55
(x10)
Schraube TH 6x55 |
| 16- 99056238 : | Ecrou indessérable D6
(x10)
Nylstop Nut
Selbstsichernde Mutter |

HOBIE CAT 15 CLUB

Barre d'accouplement/Tiller crossbar/Anlenkstange
15562200

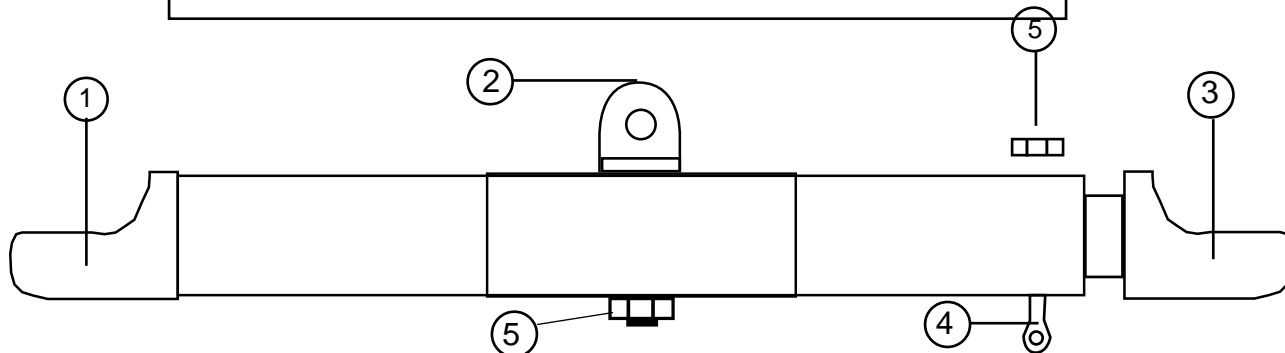

- 1 - 99000005: Embout à rotule
Tiller end cap
Pinnenendstück
- 2 - 99220955 (x4): Vis violon
Violon screw
Schraube für Pinnengelenk
- 3 - 99000010: Coulisseau réglable
Adjustable tiller end cap
Gleiter
- 4 - 99056269 (x10): Vis manillon
Tiller adjusting screw
Schraube

- 5 - 99056239 (x10): Ecrou indessérable D8
Nylstop nut D8
Selbstsichernde Mutter D8
- 6 - 14061241 (x10) : Axe percé
Clevis pin
Bolzen für Pinnenausleger
- 7 - 99220230 (x10) : Anneau brisé
Split ring
Ringsplit
- 8 - 14061321 : Chape articulation stick
(x10)
Stick articulation
Pinnengelenk

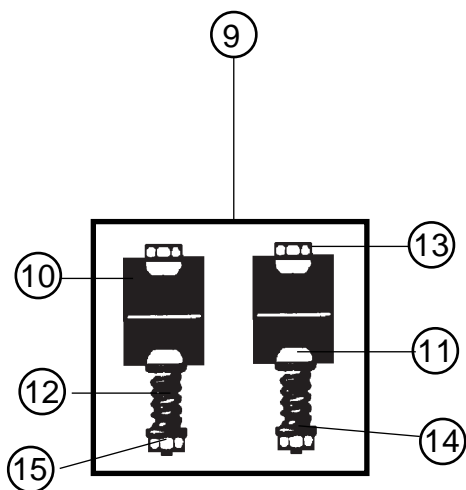

- 9 - 99500380: Kit d'articulation TCM
Tiller connector kit TCM
Verbindungsgelenk TCM
- 10 - 99500331: Demi-pallier
Rubberspacer
Distanzhülse
- 11 - 99220965 (x20): Demi-bille nylon
Half ball nylon
Nylon Halbkugel
- 12 - 99500336 (x10): Ressort TCM
TCM spring
TCM-Feder
- 13 - 99220875 (x10): Vis TH 6 x 50
TH screw
TH Schraube
- 14 - 99220745 (x10): Rondelle inox
Stainless washer
Unterlegscheibe
- 15 - 99056238 (x10): Ecrou indessérable D6
Nylstop nut D6
Selbstsichernde Mutter D6
- 16 - 14061316: Embout stick alu
(x10)
Aluminium extension cap
Pinnenendstück Aluminium

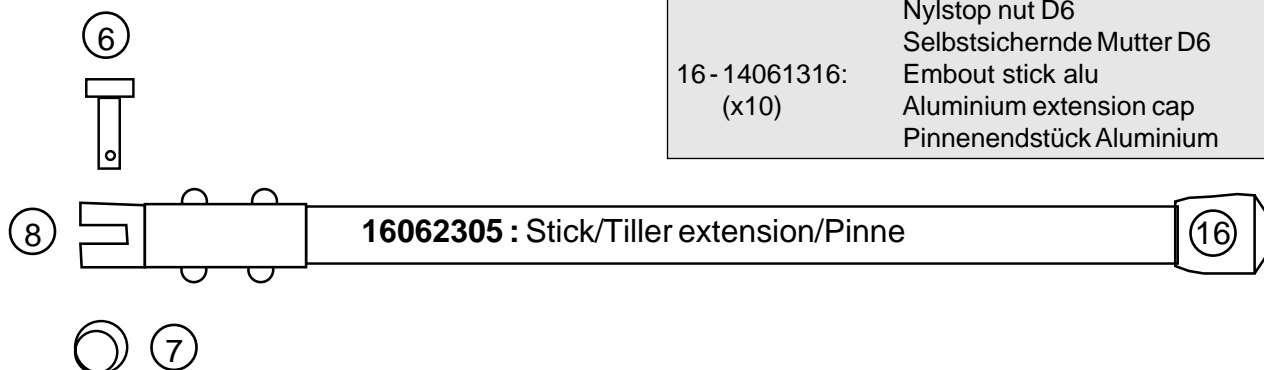

HOBIE 15 CLUB

Traverse avant
Front crossbar
Vorderholm
15562600

**AVANT 2004
PRIOR 2004
VOR 2004**

1 - 13080340 : Poulie foc turbo
Jib block turbo
Fockblock Turbo

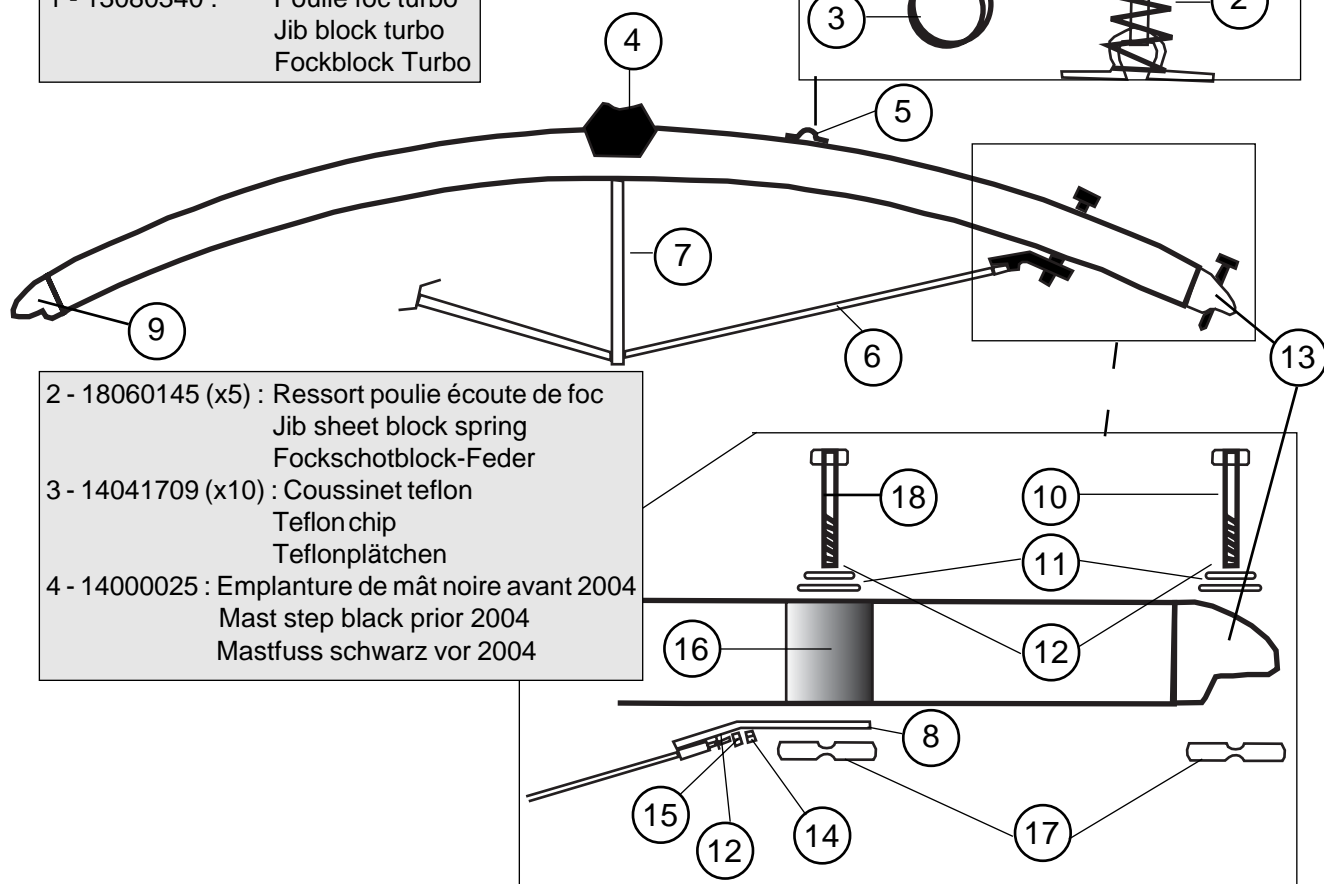

2 - 18060145 (x5) : Ressort poulie écoute de foc
Jib sheet block spring
Fockschotblock-Feder
3 - 14041709 (x10) : Coussinet teflon
Teflon chip
Teflonplättchen
4 - 14000025 : Emplanture de mât noire avant 2004
Mast step black prior 2004
Mastfuss schwarz vor 2004

5 - 14056002 : Ferrure étai 14
Bow tang 14
Bugbeschlag 14
6 - 15561600 : Martingale
Striker rod
Unterzug
7 - 16061650 : Etai de martingale percé avant 2004
Dolphin striker post prior 2004
Dolphin-Striker gebohrt vor 2004
8 - 15063000 : Fixation martingale
Tensioner rod fastening
Unterzug-Verbindung
9 - 13500010 : Casting avant droit
Casting front right
Gusteil vorne rechts
10 - 99226201 : Vis 10 x 125 TH
Screw 10 x 125 TH
Schraube 10 x 125 TH
11 - 99220710 : Rondelle nylon
(x10) Nylon washer
Unterlegscheibe

12 - 99220730 : Rondelle D10
(x10) Washer D10
Unterlegscheibe D10
13 - 13500020 : Casting avant gauche
Casting front left
Gusteil vorne links
14 - 99056236 : Ecou indessérable 10
(x10) Nylstop nut 10
Selbstsichernde Mutter 10
15 - 99056234 : Ecou HU M8
(x10) Nut
Mutter
16 - 99301710 : Renfort de traverse
Crossbar reinforcement
Holm-Verstärkung innen
17 - 15056060 : Support fixation
Anchor bar
Püttingeisen
18 - 99226200 : Vis 10 x 210 TH
Bolt 10 x 210 TH
Schraube 10 x 210 TH

HOBIE 15 CLUB

Traverse avant
Front crossbar
Vorderholm
15562610

2004

1 - 13080340 : Poulie foc turbo
Jib block turbo
Fockblock Turbo

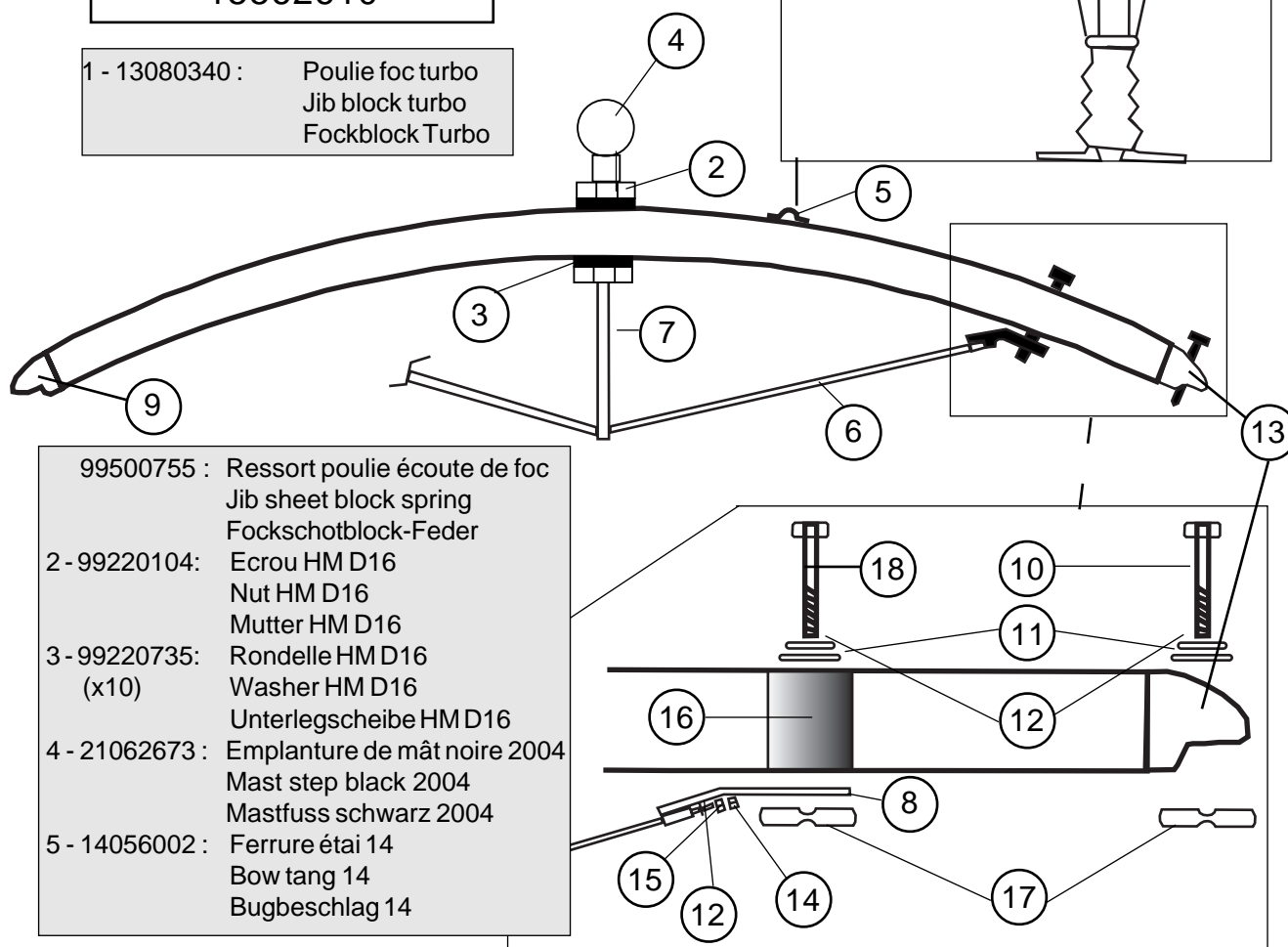

99500755 : Ressort poulie écoute de foc
Jib sheet block spring
Fockschotblock-Feder
2 - 99220104 : Ecrou HMD16
Nut HMD16
Mutter HMD16
3 - 99220735 : Rondelle HMD16
(x10)
Washer HMD16
Unterlegscheibe HMD16
4 - 21062673 : Emplanture de mât noire 2004
Mast step black 2004
Mastfuss schwarz 2004
5 - 14056002 : Ferrure étai 14
Bow tang 14
Bugbeschlag 14

6 - 15561600 : Martingale
Striker rod
Unterzug
7 - 14562680 : Etai de martingale percé 2004
Dolphin striker post 2004
Dolphin-Striker gebohrt 2004
8 - 15063000 : Fixation martingale
Tensioner rod fastening
Unterzug-Verbindung
9 - 13500010 : Casting avant droit
Casting front right
Gusteil vorne rechts
10 - 99226201 : Vis 10 x 125 TH
Screw 10 x 125 TH
Schraube 10 x 125 TH
11 - 99220710 : Rondelle nylon
(x10)
Nylon washer
Unterlegscheibe
12 - 99220730 : Rondelle D10
(x10)
Washer D10
Unterlegscheibe D10

13 - 13500020 : Casting avant gauche
Casting front left
Gusteil vorne links
14 - 99056236 : Ecrou indesserrable 10
(x10)
Nylstop nut 10
Selbstsichernde Mutter 10
15 - 99056234 : Ecrou HU M8
(x10)
Nut
Mutter
16 - 99301710 : Renfort de traverse
Crossbar reinforcement
Holm-Verstärkung innen
17 - 15056060 : Support fixation
Anchor bar
Püttingeisen
18 - 99226200 : Vis 10 x 210 TH
Bolt 10 x 210 TH
Schraube 10 x 210 TH

HOBIE 15 CLUB

Traverse arrière

Rear crossbar

Achterholm

15562500

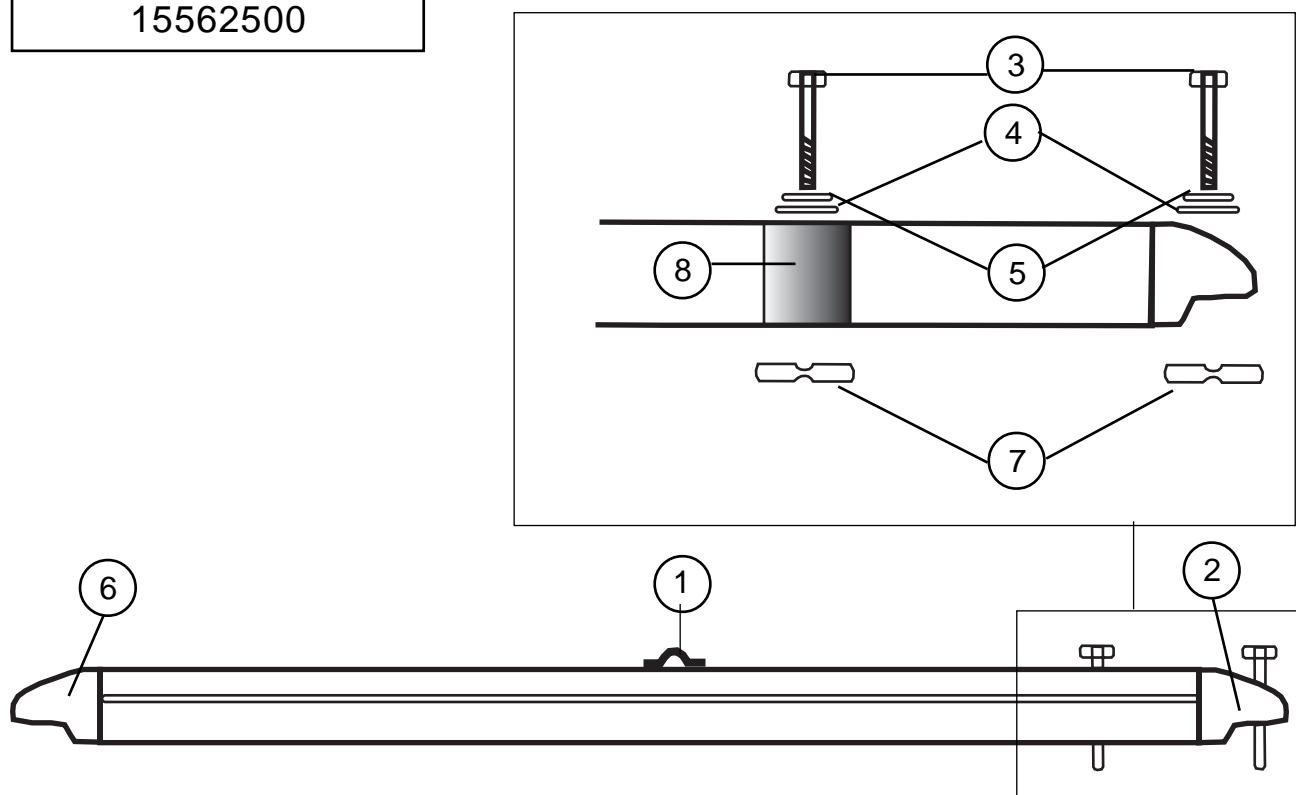

- | | |
|----------------------|--|
| 1 - 14070325 (x10) : | Pontet CCT
Pad-eye
Bügel |
| 2 - 13500010 : | Casting avant droit
Casting front right
Gusteil vorne rechts |
| 3 - 99226202 : | Vis 10 x 150 TH
Screw 10 x 150 TH
Schraube 10 x 150 TH |
| 4 - 99220710 (x10) : | Rondelle nylon
Nylon washer
Unterlegscheibe |

- | | |
|----------------------|---|
| 5 - 99220730 (x10) : | Rondelle 10
Washer 10
Unterlegscheibe 10 |
| 6 - 13500020 : | Casting avant gauche
Casting front left
Gusteil vorne links |
| 7 - 15056060 : | Support fixation
Anchor bar
Püttingeisen |
| 8 - 13062520 : | Renfort de traverse
Crossbar reinforcement
Holm-Verstärkung innen |

HOBIE CAT 15 CLUB

Haubans/Shrouds/Wanten

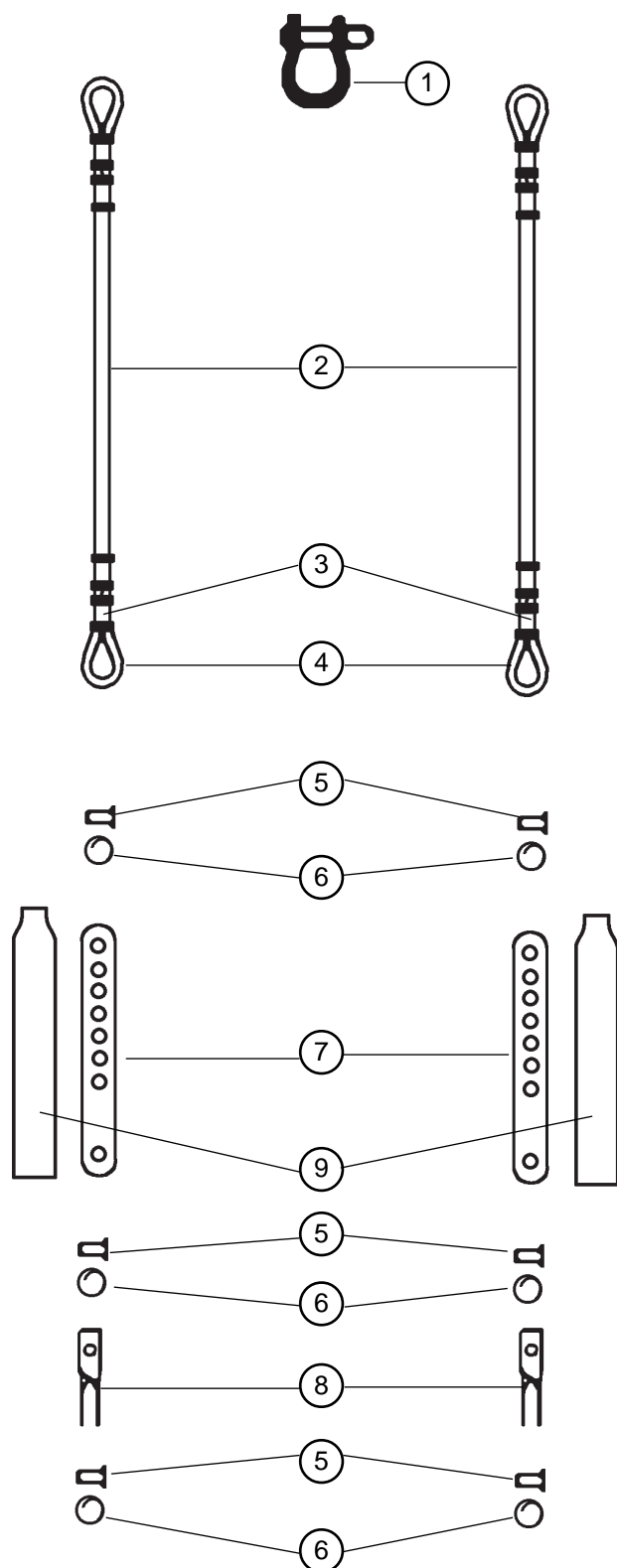

- | | |
|------------------------|---|
| 1- 99220210 (x10): | Manille lyre 8mm
Shackle 8mm
Mastschäkel 8mm |
| 2- 15580522: | Hauban 15 club 2004
Shroud 15 club 2004
Wanten 15 club 2004 |
| 15580520 : | Hauban avant 2004
Shroud prior 2004
Wanten vor 2004 |
| 3- 99056249 :
(x10) | Manchon D4
Sleeve
Hülse |
| 4- 99300058 (x10): | Cosse std
Thimble
Kausch Std |
| 5- 99056230 (x10): | Axe percé latte ridoir
Clevis pin
Bolzen für Wanteisen |
| 6- 99220230 (x10): | Anneau brisé
Split ring
Ringsplint |
| 7- 99220650 (x5): | Latte universelle
Stay adjuster
Locheisen |
| 8- 16060313 (x10): | Chape de hauban
Toggle
Wanten Toggle |
| 9- 99500369 (x10): | Protège lattes ridoir
Shroud adjuster cover
Wantenschutz |

15580540: Kit trapèze 2 câbles
Trapeze kit 2 cables
Trapezsatz 2 Käbel

HOBIE CAT 15 CLUB

Trapèze/Trapeze/Trapez

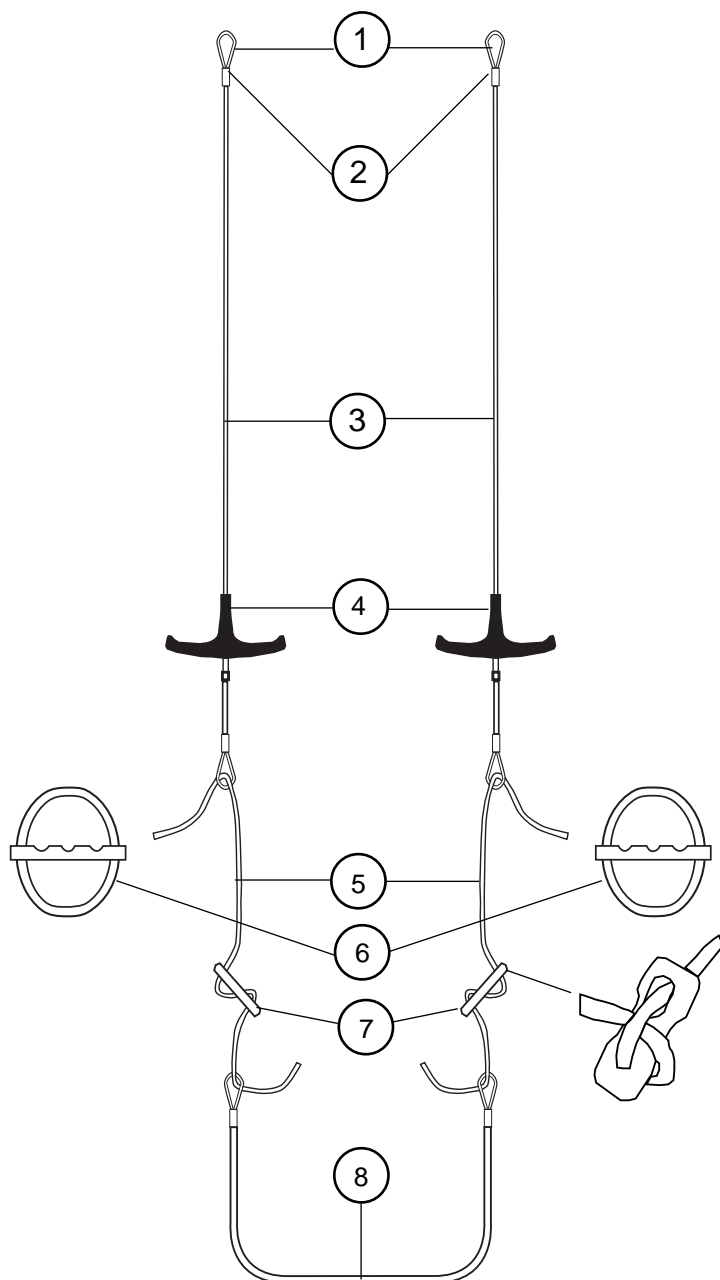

- | | |
|---------------------|--|
| 1 - 99300058 (x10): | Cosse
Thimble
Kausch |
| 2 - 99300126 (x10): | Manchon D2,5
Sleeve
Hülse |
| 3- 15580515: | Cable trapeze
Trapez wire
Trapezkabel |
| 4- 16080552: | Poignée Trapèze
Trapeze handle
Trapezgriff |
| 5- 16080554: | Cordage trapèze
Trapeze line
Trapezleine |
| 6- 99500031 (x10) | Poignée J&H
Handle J&H
Griff J&H |
| 7- 180603014 (x10): | Double anneau
Rope lock
Trapezstopper |
| 8 - 99056260 (x10): | Sandow de trapèze
Trapeze shock cord
Gummistrop Trapez |

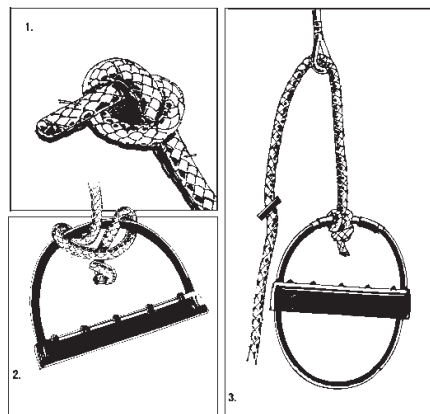

Montage des poignées de trapèze Instruction for connecting your trapeze handle Wie man die Trapezgriffe knotet

1. Faire un noeud à la fin du cordage 6 mm
Tie knot firmly at end of 6 mm
Fester Knoten am Ende der Leine
2. Fixer fermement la corde nouée à la poignée comme indiqué sur le dessin en s'assurant que la corde ne puisse pas glisser du milieu de la poignée.
Fix knotted rope firmly to handle as illustrated, ensuring that rope cannot move from top centre of handle.
Webleinensteck wie gezeigt fest anziehen
3. Attacher normalement la corde au câble de trapèze.
Attach rope and handle to trapeze wire as normal.
Leine durch Trapezkausch und wie üblich befestigen

HC 15 Club

Etai, drisse de foc, bride
Forestay, jib halyard, bridle
Vorstag, Fockfall, Hahnepot

- | | |
|------------------------|--|
| 1- 15080510: | Etai cable + estrope
Forestay + pigtail
Vorstag Kabel + Pigtail |
| 2- 99056249 (x10): | Manchon D4
Sleeve
Hülse |
| 3- 99300058 (x10): | Cosse std
Thimble
Kausch Std |
| 4- 99220660 (x10): | Manille lyre 4 mm
Shackle 4 mm
Schäkel 4 mm |
| 5- 16080515: | Poulie drisse foc (grande)
Jib Halyard block (large)
Fockfallumlenkblock gross |
| 6- 16080540: | Cordage drisse de foc
Jib halyard rope
Fockfall-Leine |
| 7- 16080516: | Poulie drisse foc (petite)
Jib halyard block (small)
Fockfallumlenkblock klein |
| 8- 99220230 (x10): | Anneau brisé
Split ring
Ringsplint |
| 9- 99056230 (x10): | Axe percé
Clevis pin
Bolzen für Locheisen |
| 10- 99220650 (x5): | Latte universelle
Stay adjuster
Locheisen |
| 11- 99220665:
(x10) | Manille lyre D6
Shackle D6
Schäkel D6 |
| 12- 15580530: | Bride 15 club
Bridle
Hahnepot |

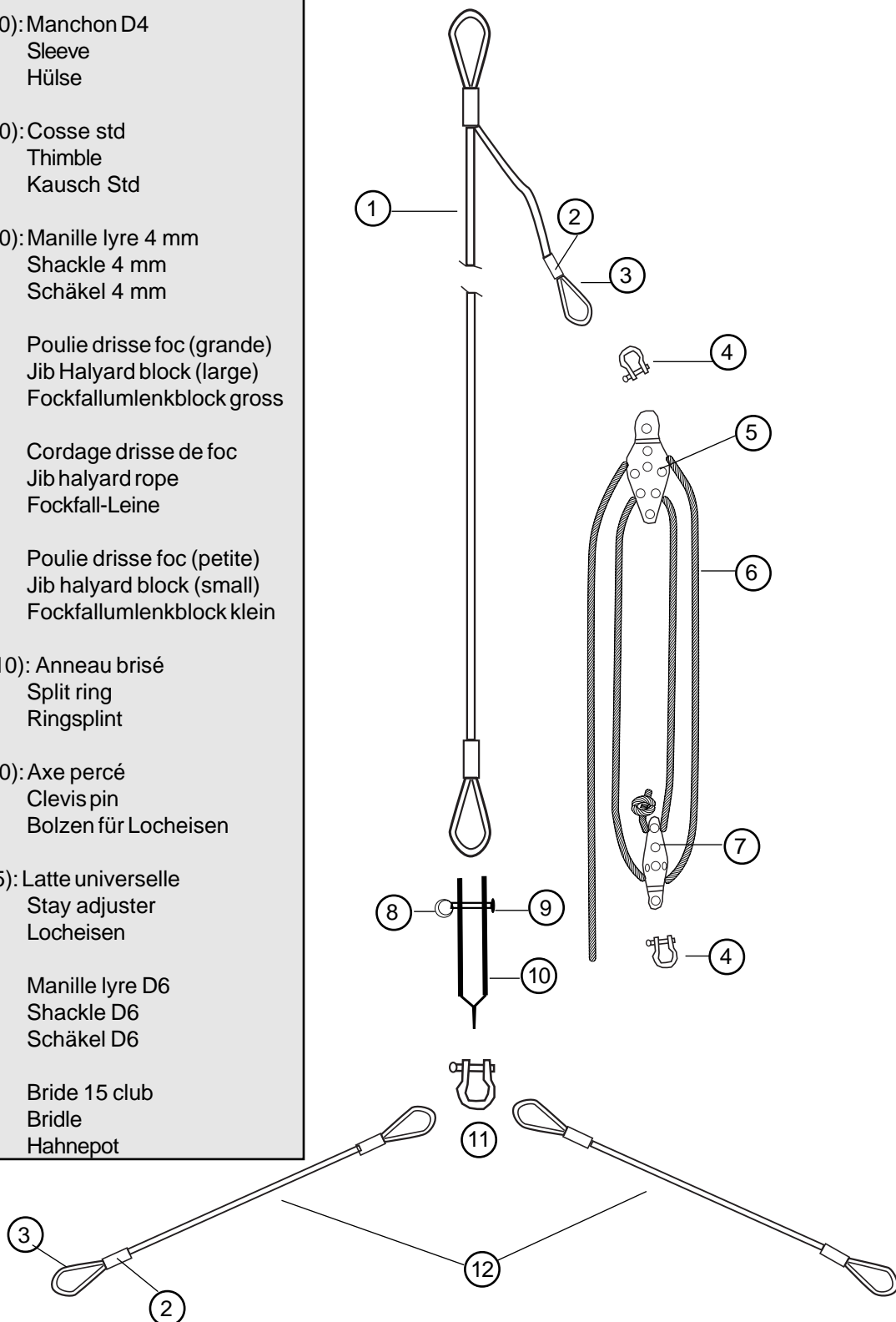

HOBIE CAT 15 CLUB
Grand-voile & lattes/Main sail & battens
Gross-Segel & Latten
15030040

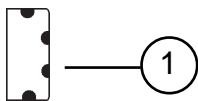

Batten lengths :

- 15034001 #1 = 2055 mm
- 15034002 #2 = 2035 mm
- 15034003 #3 = 2015 mm
- 15034004 #4 = 1995 mm
- 15034005 #5 = 1820 mm
- 15034006 #6 = 1548 mm
- 15034007 #7 = 1233 mm
- 15034008 #8 = 740 mm

- | | |
|---------------|--|
| 1 - 99504010: | Demi-butée latte GV
Batten pocket protector
Halb Anschlag GS-Latte |
| 2 - 99267286: | Autocollant "H" noir
Black "H" sticker
Aufkleber "H"schwarz |

- | | |
|------------------|---|
| 99056243 (x10) : | Embout latte GV Easy
Batten cap Easy
Lattenkappe Easy |
| 15034010 : | Jeu de lattes
Batten set
Lattensatz |

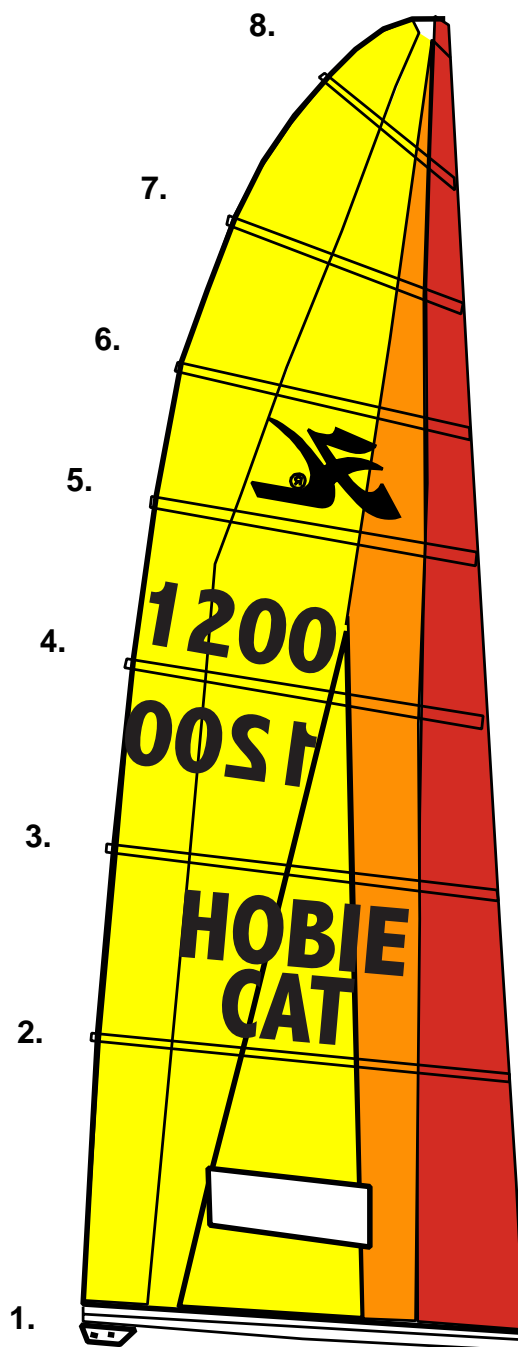

HOBIE CAT 15 CLUB

Foc /Jib /Fock

15030045

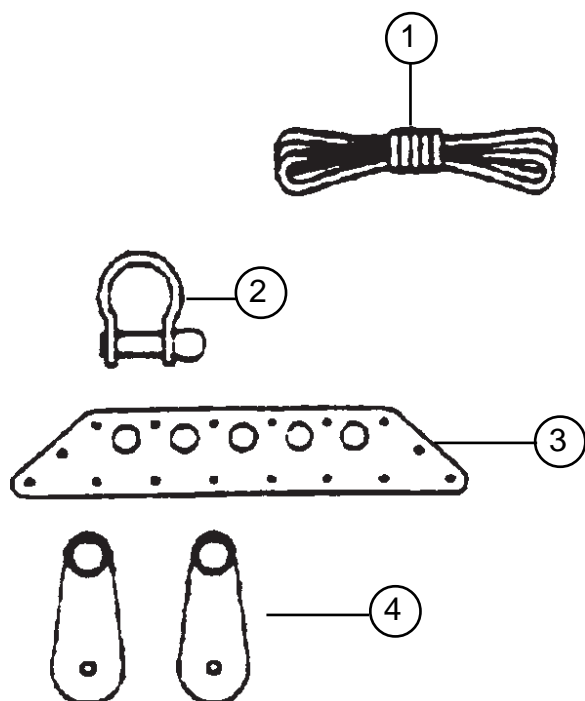

- | | |
|---------------------|--|
| 1 - 16070470: | Ecoute de foc
Jib sheet
Fockschot |
| 2 - 99220660 (x10): | Manille lyre 4 mm
Shackle 4 mm
Mastschäkel 4mm |
| 3 - 16080005: | Kit platine alu de foc
Jib clew plate
Fock Trimm Kit |
| 4 - 16080351: | Poulie pt d'écoute de foc
Jib clew block
Fockumlenkblock |
| 5 - 99300058 (x10): | Cosse std
Close end thimble
Kausch std |
| 6 - 99300126 (x10): | Manchon
Sleeve
Hülse |

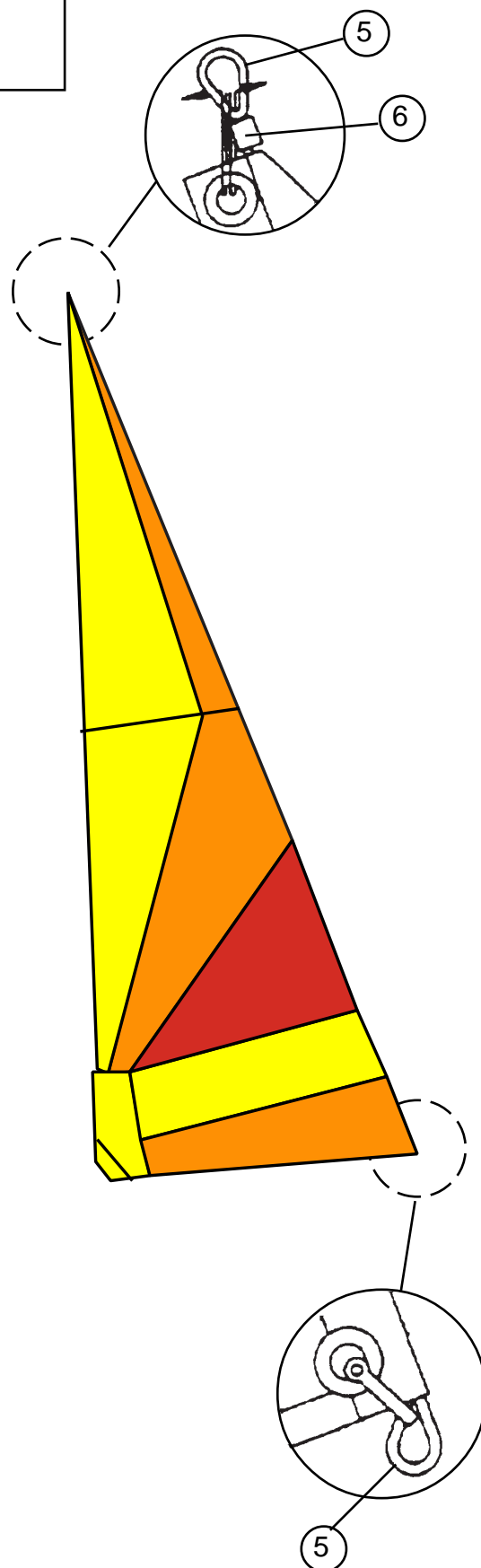

HOBIE CAT 15 CLUB

Enrouleur de foc
Jib furling assembly
Fockroller

15570340
Kit enrouleur de foc
Jib furling assembly
Fockroller Kit

- | | |
|---------------------|--|
| 1 - 15080530 : | Estrope + émerillon
Pigtail + swivel
Pigtail komplett |
| 2 - 18060590 : | Pivot étai de foc
Forestay swivel
Fockvorstagwirbel |
| 3 - 99220665 : | Manille lyre D6
(x10) Shackle D6
Schäkel D6 |
| 4 - 99056230 (x10): | Axe percé
Clevis pin drilled
Bolzen gebohrt |
| 5 - 99220230 (x10): | Anneau brisé
Split ring
Ringsplint |
| 6 - 21060150 : | Enrouleur
Jib furling assy
Fockroller |
| 7 - 15580525 : | Bride enrouleur
Bridle
Hahnepot |
| 8 - 99500415 : | Taquet coinçeur trav.AV
Jam cleat front crossbar
Klemme Vorderholm |
| 9 - 99056249 : | Manchon D4
(x10) Sleeve
Hülse |

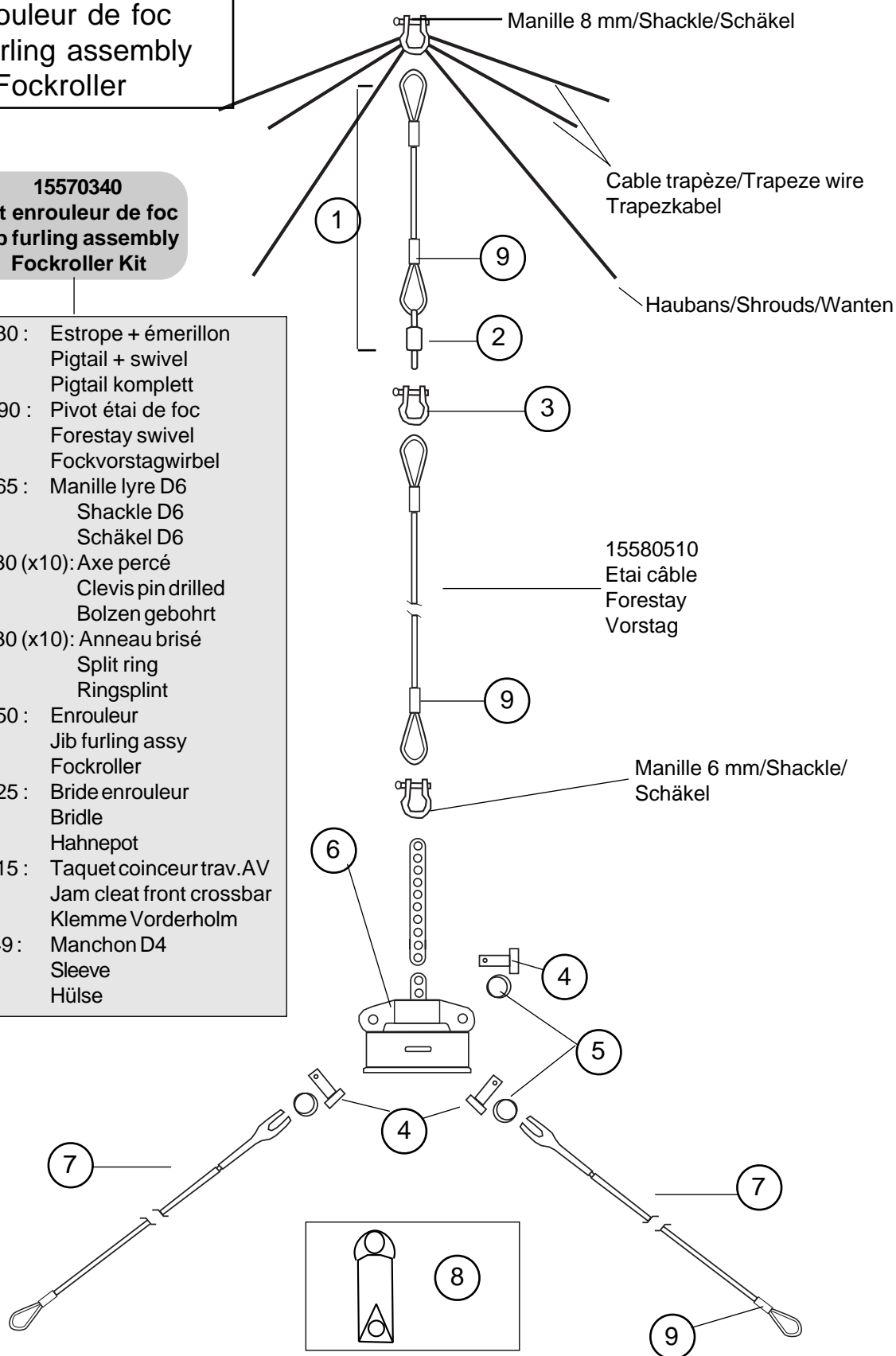

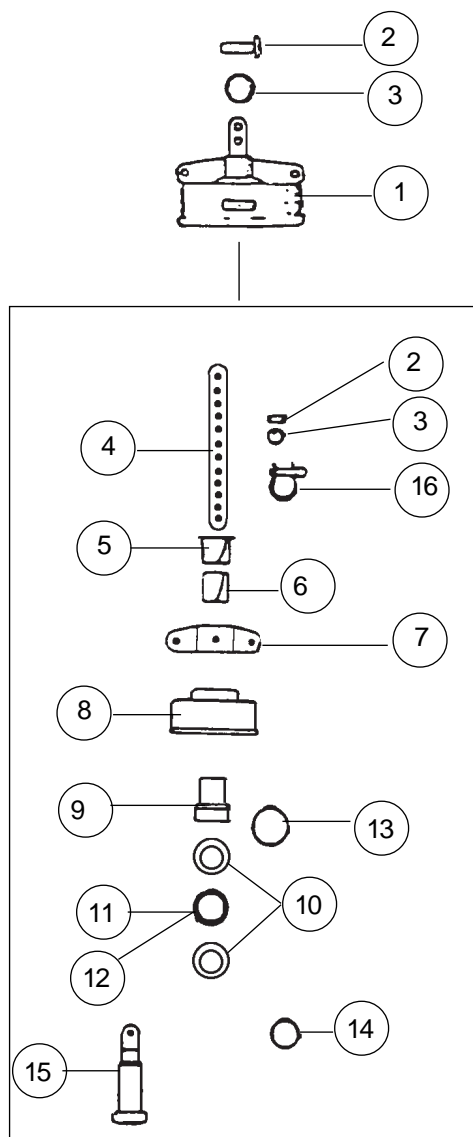

HC 15 Club

Enrouleur

Jib furling assembly

Fockroller - 21060150

- | | |
|--------------------------|--|
| 1 - 21060150 : | Enrouleur
Jib furling assembly
Fockroller |
| 2 - 99056230 (x10): | Axe percé latte ridoir
Clevis pin |
| 3 - 99220230 (x10): | Bolzen für Locheisen
Split ring
Ringsplint |
| 4 - 99220350 : | Latte ridoire enrouleur
Furling stay adjuster
Fockroller-Stagspanner |
| 5 - 21060151 : | Entretoise nylon supérieure
Upper nylon bushing
Obere Nylon Hülse |
| 6 - 21060152 : | Entretoise nylon inférieure
Lower nylon bushing
Untere Nylon Hülse |
| 7 - 21060590 : | Coupleur à brides
Yoke
Hahnepotverkappung |
| 8 - 21060153 : | Carter plastic + bobine
Housing + spool
Plastikgehäuse + Trommel |
| 9 - 21060157 : | Entretoise métal
Sleeve
Metallhülse |
| 10 - 21060158 : | Flasque roulement
Bearing race
Kugellagerseitenwand |
| 11 - 21060154 : | Cage de roulement
Bearing cage
Kugellager Gehäuse |
| 12 - 21060156 : | Bille de roulement
Bearings
Kugellager |
| 13 - 21060305 : | Circlips grand modèle
Darby ring large
Offener Ring groß |
| 14 - 21060306 : | Circlips petit modèle
Darby ring small
Offener Ring klein |
| 15 - 21060313 : | Axe principal
Tube
Hauptachse |
| 16 - 99220665 :
(x10) | Manille lyre D6
Shackle D6
Schäkel D6 |

HOBIE CAT 15 CLUB CCT Standard & LE

15080310 : CCT STD

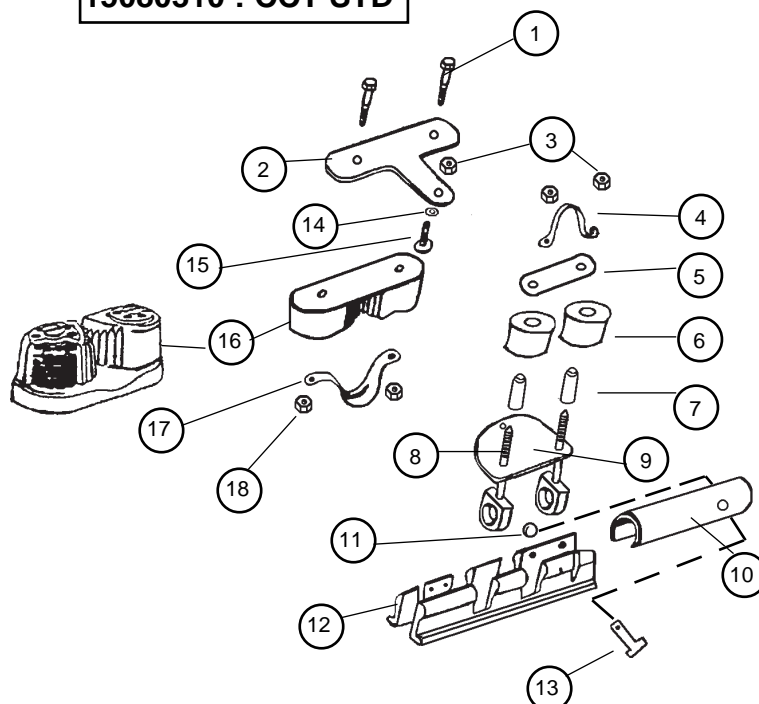

- | | | |
|---------------------|--|------------------------------------|
| 1 - 99220905: | Vis taq.coinc.
(x10) | Screw stainless
Schraube Klemme |
| 2 - 14070316: | Platine articulée
Deck plate
Bewegliche Platte | |
| 3 - 99056238 (x10): | Ecrou ind. 6
Nut nylstop 6 stainless
Mutter 6 | |
| 4 - 14070325: | Pontet CCT
(x10) | Pad-eye
Bügel |
| 5 - 14070322: | Platine support réa
Sheave plate
Platte Hinten CCT rolle | |
| 6 - 14070111: | Réa nylon
Nylon sheave
Rolle nylon | |
| 7 - 99220615 (x2): | Entretoise CCT
Stainless bushing
Querriegel CCT | |
| 8 - 99220024: | Vis violon
Violon screw
Bügelschraube CCT | |
| 9 - 14070321: | Platine fixe
Car sub plate
Platte CCT | |

- | | | |
|----------------------|---|--|
| 10 - 14070358 (x5): | Axe Tube CCT
Axe tube CCT
Röhre f. Bolzen CCT | |
| 11 - 99220230 (x10): | Anneau brisé
Split ring
Ringsplint | |
| 12 - 14070367 (x10): | Demi-glissière
half slide
Halbleiter | |
| 13 - 99220602 (x5): | Axe percé vit mulet
Clevis pin
Lümmelbeschlag Bolzen | |
| 14 - 99220755 (x10): | Rondelle Teflon
Teflon washer
Unterlegscheibe Teflon | |
| 15 - 99220017: | Vis Trl poelier art.
Swing arm pivot screw
Gelenkschraube CCT | |
| 16 - 99500362: | Taquet à bille
Cam cleat
Kugelklemme | |
| 17 - 14070325 (x10): | Pontet CCT
Eye strap CCT
Bügel CCT | |
| 18 - 99226003: | Ecrou indessérable
Nylstop nut
Selbstsichernde Mutter | |

HOBIE CAT 15 CLUB

Trampoline/Trampoline

Blanc/White/Weiss

15525005

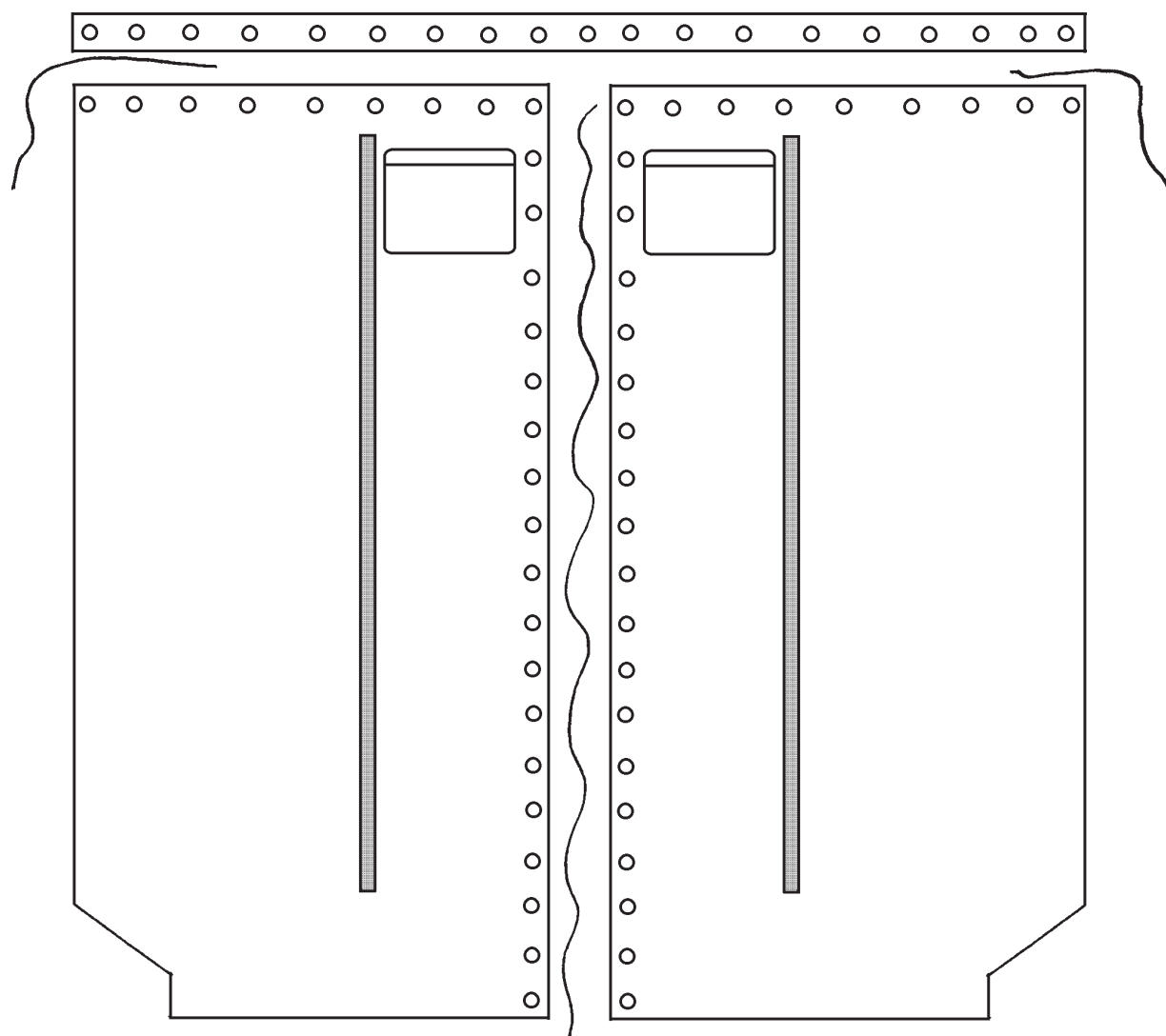

15525800 : Mesh /Netz

16070430 : Lacet arrière/Rear line/Trampolineleine hinten

16070440 : Lacet central/Middle trampoline line/Trampolineleine Mitte

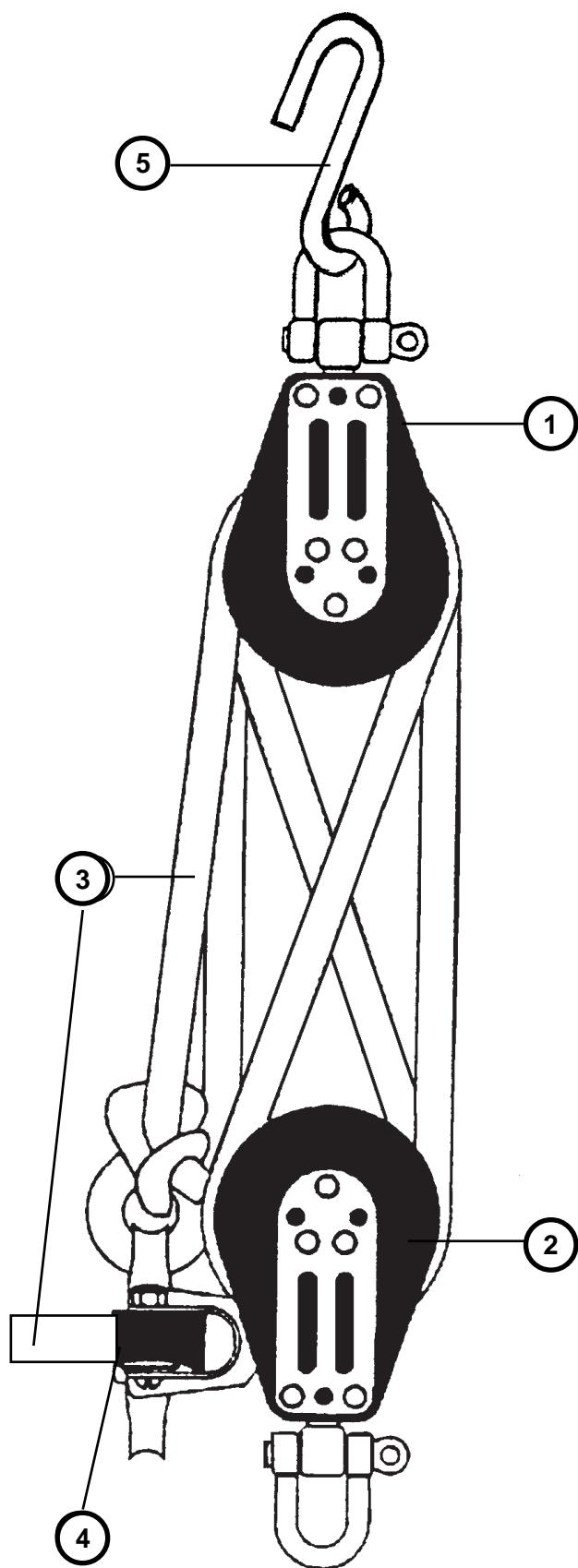

HOBIE CAT 15 CLUB
Palan de Grand-voile
Mainsheet system
Großschotssystem

- | | |
|--------------------|--|
| 1 - 16080353: | Poulie triple Sailspeed
Sailspeed upper block
Dreifacher Block Sailspeed |
| 2 - 16080370: | Poulie winch triple Sailspeed
Sailspeed triple block
Dreifacher Knarrblock Sailspeed |
| 3 - 16070420: | Cordage grand voile
Mainsheet
Großschot |
| 4 - 99500910 (x5): | Taquet Sailspeed
Sailspeed cleat
Klemme Sailspeed |
| 5 - 99500261 (x2): | Crochet de grand-voile
Hook mainsheet
Großsegel-Haken |

- 16070320 : Accastillage spi + cordage
Complete spinnaker rig + ropes
Spitakelage mit Leinen
- 16070040 : Sac cordages Spinnaker
Spi rope bag
Spileinetasche
- 16032020 : Spinnaker blanc
White Spinnaker
Spinnaker

Hobie Cat 15 Club Kit de spi Classique/ Classical spi kit

16032050 : Spinnaker yellow red star

- 1 - 15062630 : Tangon de spi
Spi pole
Spibaum
- 2 - 15080555 : Bride tangon HC15/16
Spi pole bridle HC15/16
Hahnepot Spibaum
- 3 - 15080570 : Bride cunningham tangon
Pole support bridle
Spibaum-Unterstützung

15060400 : Drisse cordage spi
Spi halyard rope
Spifall Leine

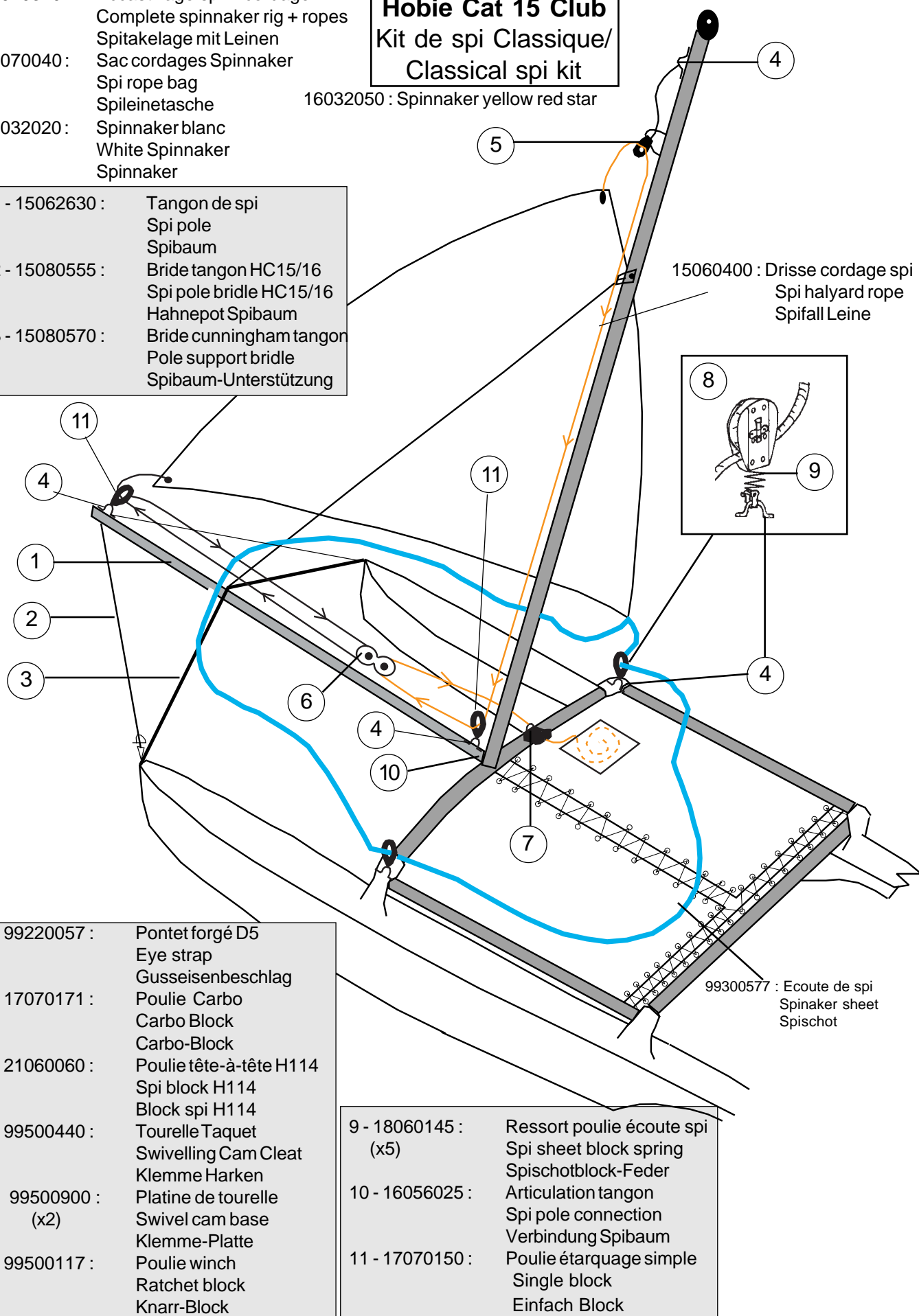

- 4 - 99220057 : Pontet forgé D5
Eye strap
Gusseisenbeschlag
- 5 - 17070171 : Poulie Carbo
Carbo Block
Carbo-Block
- 6 - 21060060 : Poulie tête-à-tête H114
Spi block H114
Block spi H114
- 7 - 99500440 : Tourelle Taquet
Swivelling Cam Cleat
Klemme Harken
- + 99500900 : Platine de tourelle
Swivel cam base
Klemme-Platte
- 8 - 99500117 : Poulie winch
Ratchet block
Knarr-Block

- 9 - 18060145 : Ressort poulie écoute spi
Spi sheet block spring
Spischotblock-Feder
- 10 - 16056025 : Articulation tangon
Spi pole connection
Verbindung Spibaum
- 11 - 17070150 : Poulie étarquage simple
Single block
Einfach Block

99300577 : Ecoute de spi
Spinnaker sheet
Spischot

- 15570325: Accastillage spi trompette + cordages
 Trumpet spi kit + lines
 Trumpet-Spikit + Leine
- 16032070: Spi trompette blanc
 Trumpet spi white
 Trumpet Spi weiss
- 16032075: Spi trompette jaune
 Trumpet spi yellow
 Trumpet spi gelb

Hobie Cat 15 Club
 Kit de spi trompette
 Trumpet Spi kit

- 1 - 15562645 : Tangon de spi
 Spi pole
 Spibaum
- 2 - 99267459 : Trompette soft
 Trumpet soft
- 3 - 99267521 : Sac de spi
 Spi bag
 Spisack

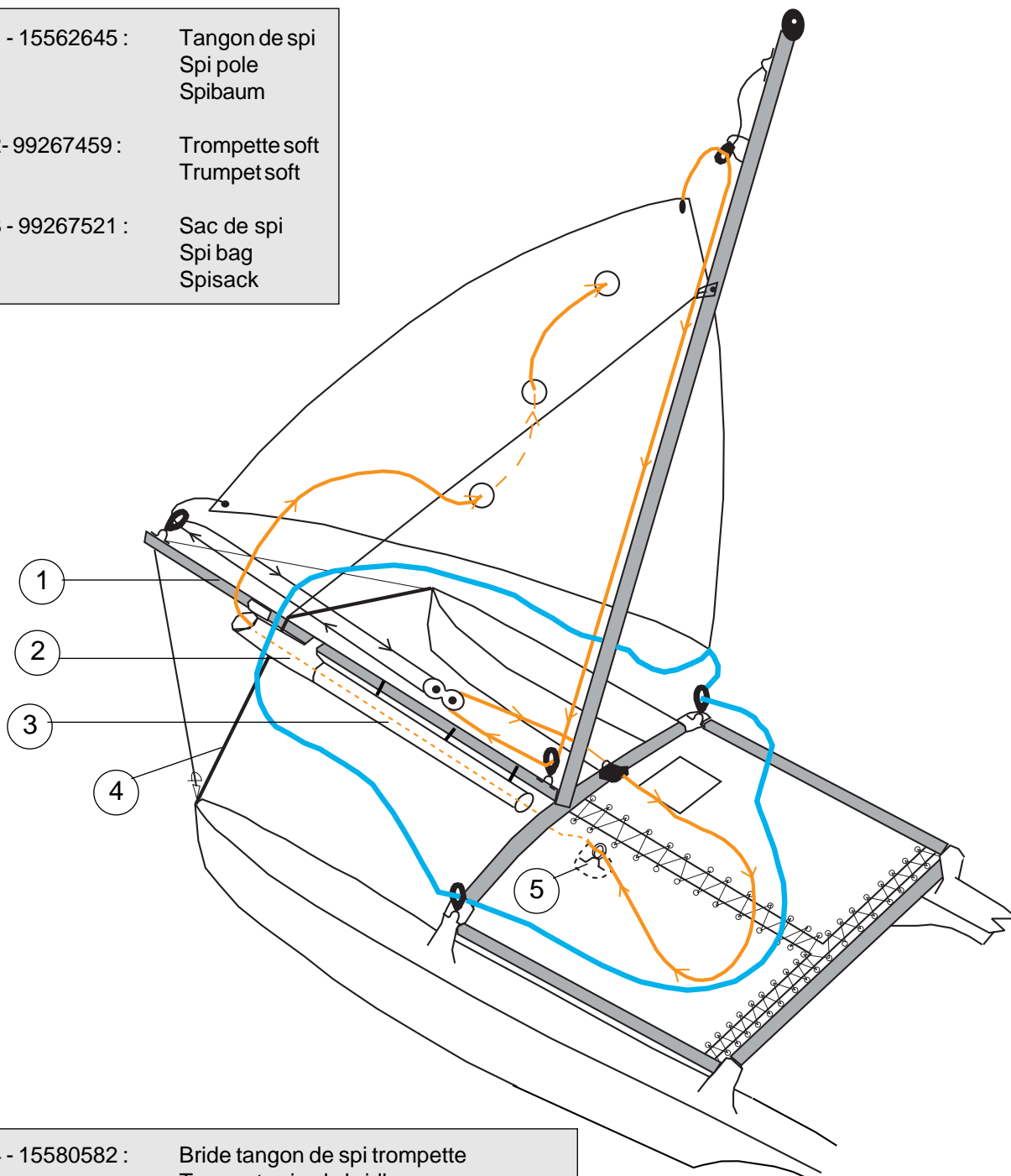

- 4 - 15580582 : Bride tangon de spi trompette
 Trumpet spi pole bridge
 Spibaum-Unterstützung
- 5 - 99500735 : Poulie avec ressort et pontet
 Block with spring and eye strap
 Block mit Splint und Guseisenbeschlag

KIT DE REDRESSEMENT / RIGHTING KIT AUFRICHTUNGSSYSTEM

16070200 (HC14/15/16) - 17570200 (FX1/Pacific) 17070200 (HC17) - 15570200 (15Club/Teddy/Dragoon)

