

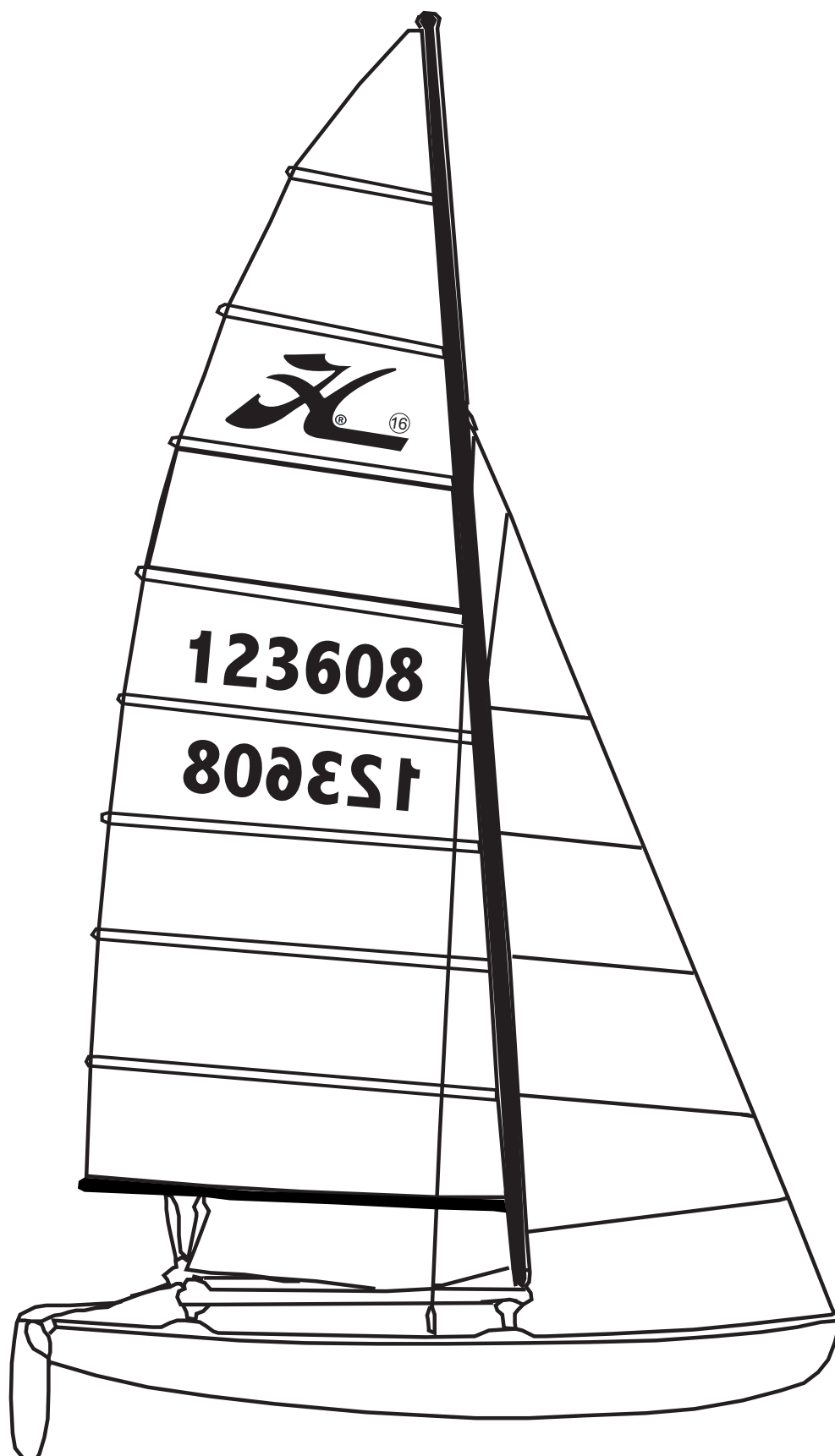

16

Eclaté des pièces détachées

Illustrated Part Guide - Explosionszeichnung



Last up-date : July 2007

# **HC 16** Coque/Hull/Rumpf

	8 - droite/right/rechts	9 - gauche/left/links
Std	16056102	16056101
Easy/Club reinforced)	16056130	16056120 (renforcé/

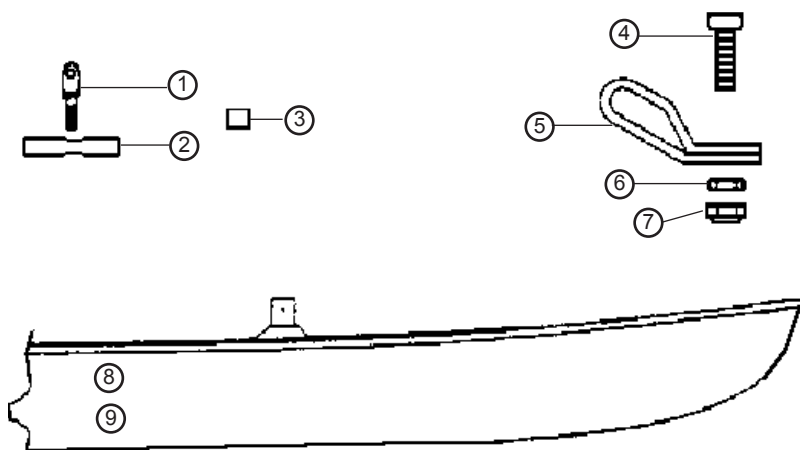

- 1- 16056029 : Vis cadène hauban (x4)  
Anchor pin  
Schraube Püttingeisen
- 2- 16056059: Support de hauban  
Anchor bar  
Püttingeisen
- 3- 14056008: Sceau PVC  
Foam plug  
Mastabdichtung PVC
- 4- 99220950 : Vis TCL 8x40 (x10)  
Screw TC  
Schraube
- 5- 16056022: Ferrure étai  
Bow tang  
Bugbeschlag
- 6- 99056235 : Ecrou nylon safran (x10)  
Rudder nylon nut  
Nylon Mutter Ruderblatt
- 7- 99056239 : Ecrou indessérable (x10)  
Nylstop nut  
Selbstsichernde Mutter
- 10- 16080345 : Aiguillot .+ anneau brisé (x10)  
Rudder pin + split ring  
Ruderbolzen + ring Splint

- 11- 99220855 : Vis TC fémelot (x10)  
Screw TC stainless  
Schraube Heckbeschlag
- 12- 16056005 : Fémelot + entretoises  
Gudgeon + bushings  
Ruderbeschlag
- 13- 99220845 : Vis bouch.vidange (x10)  
Screw drain plug  
Schraube Ablassschraube
- 14- 99056012 : Platine bouch.vidange  
Drain plate  
Platte Ablassschraube
- 15- 99220048 : Joint de vidange (x10)  
Drain gasket  
Dichtung Ablassschraube
- 16- 99056232 : Bouchon de vidange (x10)  
Drain Plug  
Ablassschraube
- 17- 99220043 : Joint + bouchon (x10)  
Drain plug + gasket  
Ablassschraube + Dichtung

Sac Accastillage/Rig bag/Takelagesach  
 HC16 Easy = 16080290  
 HC16 classic = 16080300  
 HC16 Club = 16080301  
 HC16 Race = 16080302  
 Jeu de câbles/Cable set/Käbelsatz  
 HC16 classic = 16080500  
 HC16 race = 16080503  
 Sac de cordages/Rope bag/Leinensack  
 HC16 Classic/Easy = 16070000  
 HC16 ace = 16070020



18 - Embout noir/Black stripe end cap/Dekorstreifen schwarz :

99056051 : arrière droit ou avant gauche/rear right or front left/hinten rechts oder vorne links  
 99056099 : arrière gauche ou avant droit/rear left or front right/hinten links oder vorne rechts

19 - 17056081: Bande Molokai coque/Molokai hull strip/Klebeband Molokai für Rumpf (cm)

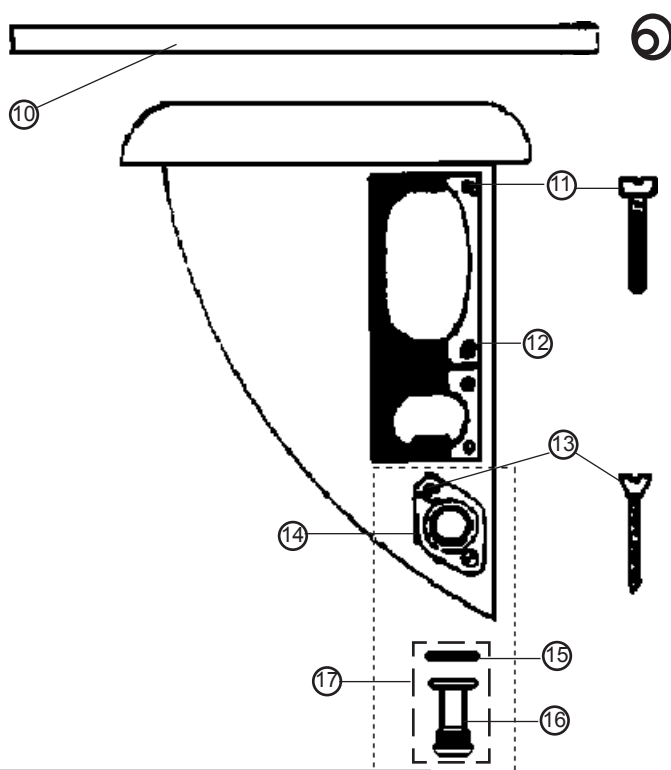

## HC 16

Barre latérale & néoprène

Sidebar & neoprene

Seitenholm & Neopren

16062401 (LE) (+ neoprene)

16062400 (STD) (sans néoprène - w/o neoprene)

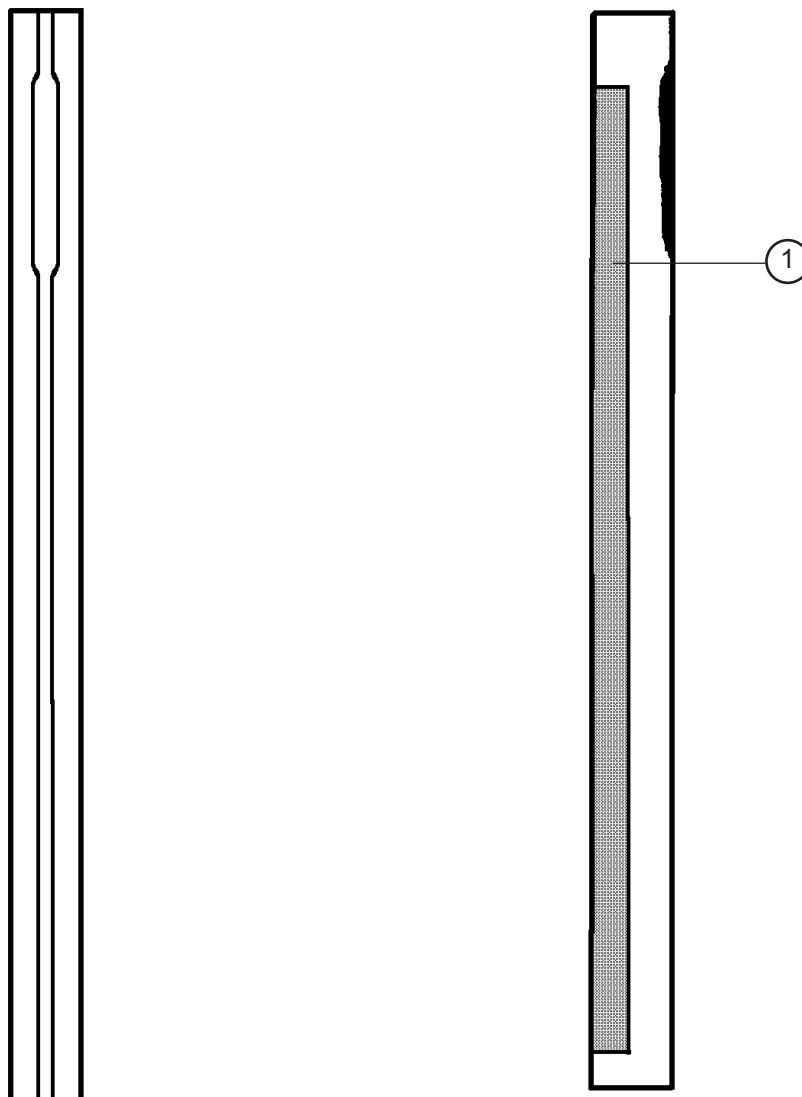

### 1 - Néoprène anti-dérapant / Anti skid neoprene / Neopren-Antirutsch-Belag

99506151 (x10)

99506030 (x20)

99506090 (x50)

99506091 (x100)

99506092 (x4 +colle/glue/Klebstoff)

## HC 16

### Trapèze/Trapeze/Trapez

TRAPEZE KIT : 16080551 LE

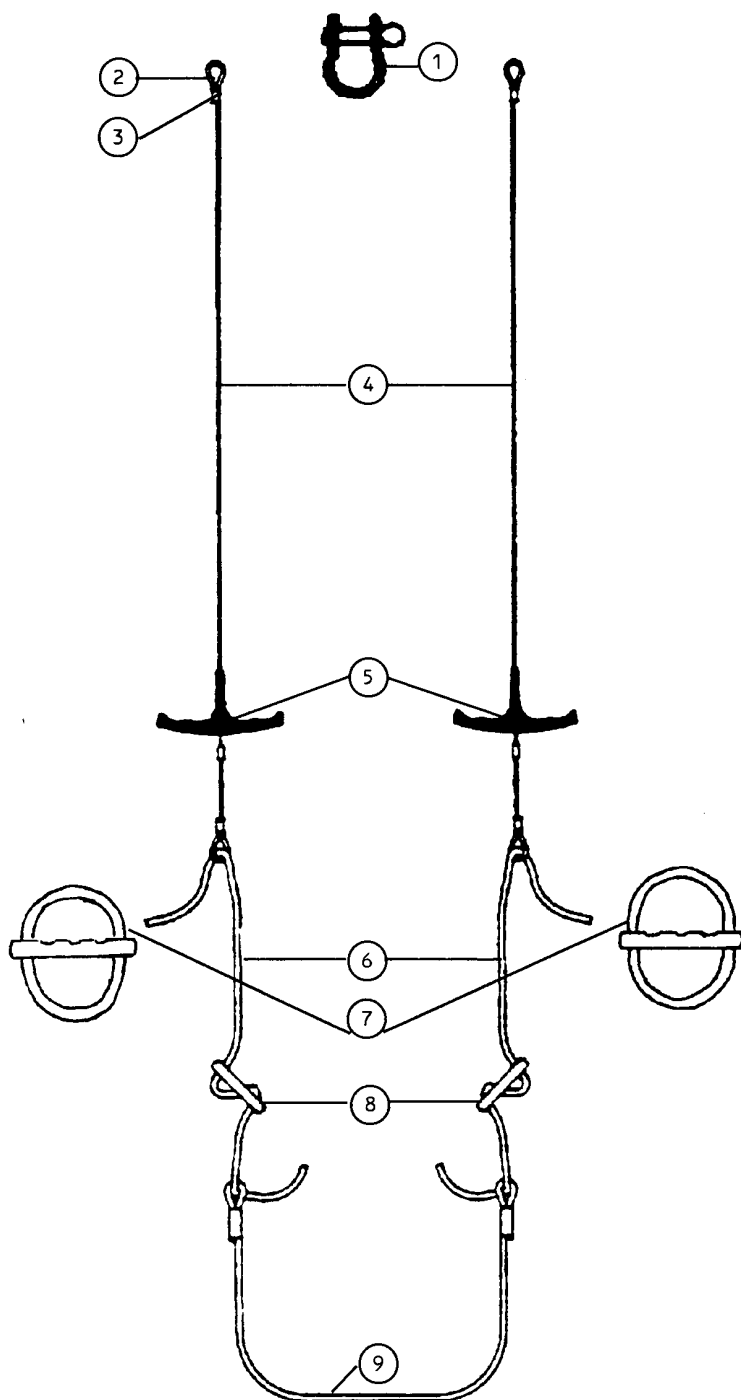

- 1- 99220210 (x10) Manille lyre 8 mm  
Shackle 8 mm  
Mastschäkel 8 mm
- 2- 99300058 (x10): Cosse  
Thimble  
Kausch
- 3- 99300126 (x10): Manchon D2,5  
Sleeve  
Hülse
- 4- 16080557: Cable trapeze  
Trapez wire  
Trapezkabel
- 5- 16080552: Poignée trapèze  
Trapeze handle  
Trapezgriff
- 6- 16080554: Cordage de réglage  
Trapeze line  
Trapezleine
- 7- 99500031 (x10) Poignée J&H  
Handle J&H  
Griff J&H
- 8- 18060314 (x10): Double anneau  
Rope lock  
Trapezstopper
- 9- 99056260 (x10): Sandow de trapèze  
Trapeze shock cord  
Gummistrop Trapez

## HC 16

### Haubans/Shrouds/Wanten

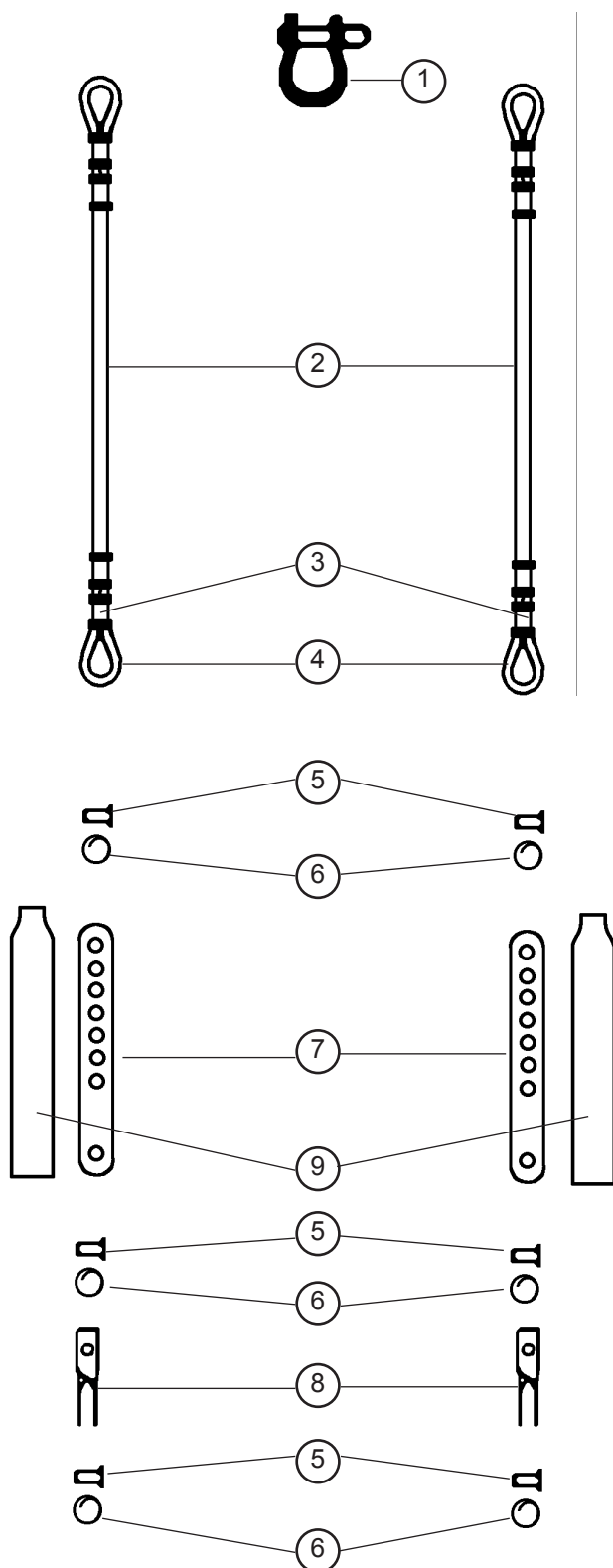

1-99220210 (x10): Manille Lyre 8mm  
Shackle 8 mm  
Mastschäkel 8 mm

2- 16080560: Hauban  
Shroud  
Want

3-99056249 (x10): Manchon D4  
Sleeve  
Hülse

4- 99300058 (x10): Cosse std  
Thimble  
Kausch Std

5- 99056230(x10): Axe percé lat.ridoir  
Clevis pin  
Bolzen für Wanteisen

6- 99220230 (x10): Anneau brisé  
Split ring  
Ringsplint

7- 99220650 (x5): Latte universelle ridoir  
Stay adjuster  
Wanteisen

8- 16060313 (x10): Chape de hauban  
Toggle  
Wanten Toggle

9- 99500369 (x10): Protège lattes ridoires  
Shroud adjuster cover  
Wantenschutz

# HC 16 Etai, drisse de foc, bride Forestay, jib halyard, bridle Vorstag, Fockfall, Hahnepot

1- 16060525:	Etai cable + estrope Forestay + pigtail Vorstag Kabel + Pigtail
2- 99056249: (x10)	Manchon D4 Sleeve Hülse
3- 99300058 (x10):	Cosse std Thimble Kausch std
4- 99220660 (x10):	Manille lyre 4mm Shackle 4 mm Schäkel 4 mm
5- 16080515:	Poulie drisse foc (grande) Jib Halyard block (large) Fockfallumlenkblock gross
6- 16080540:	Cordage drisse de foc Jib halyard rope Fockfall-Leine
7- 16080516:	Poulie drisse foc (petite) Jib halyard block (small) Fockfallumlenkblock klein
8- 99220230 (x10):	Anneau brisé Split ring Ringsplint
9 - 99056230 (x10):	Axe percé Clevis pin Bolzen für Locheisen
10- 99220650 (x5):	Latte ridoir universelle Stay adjuster Locheisen
11- 99220665 (x10):	Manille lyre 6mm Shackle 6 mm Schäkel 6 mm
12- 16080570:	Bride Bridle Hahnepot

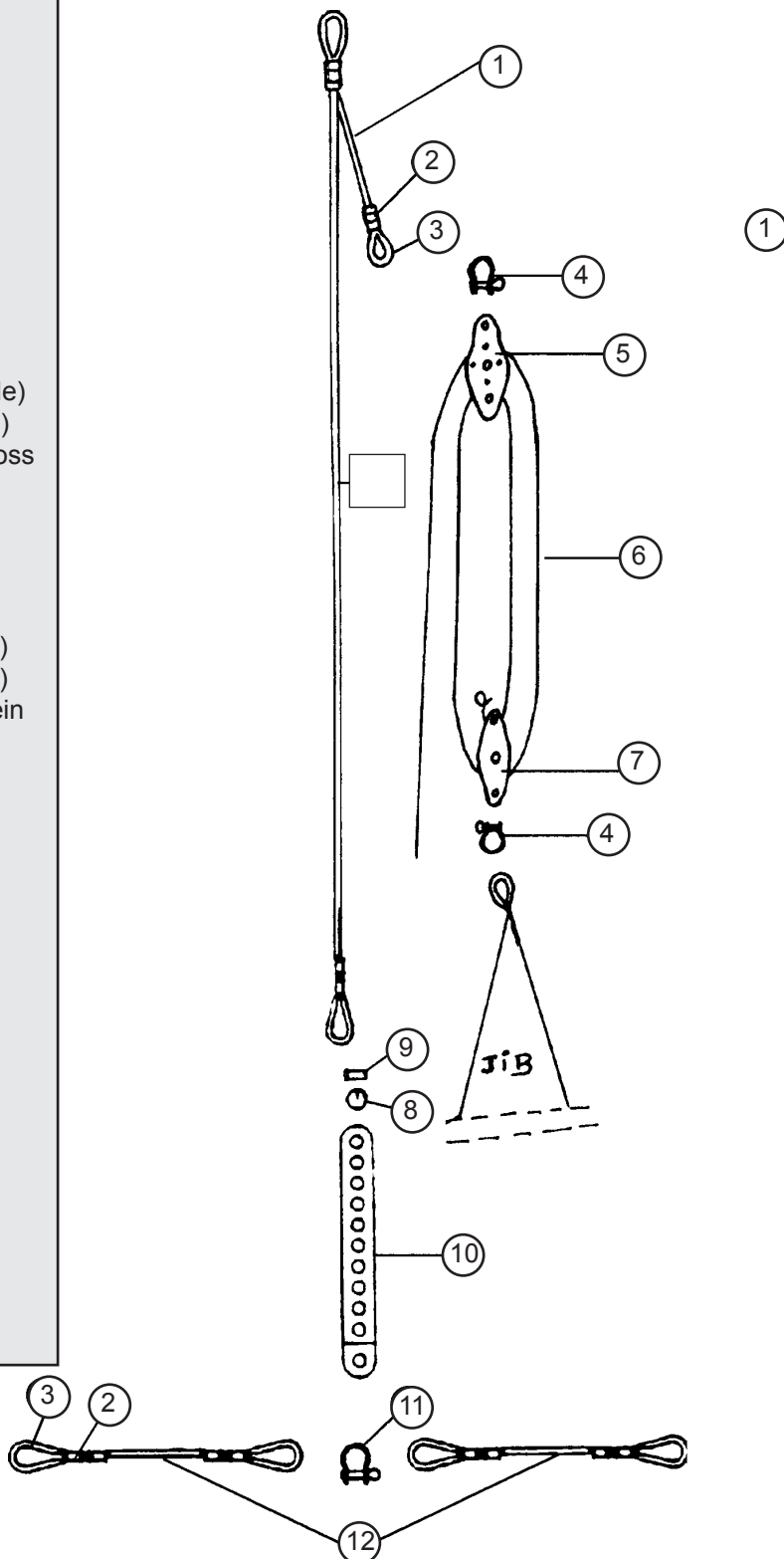

## OPTION

HC 16  
Câbles + enrouleur  
Cables + jib furler  
Käbel + Rollerfocksystm

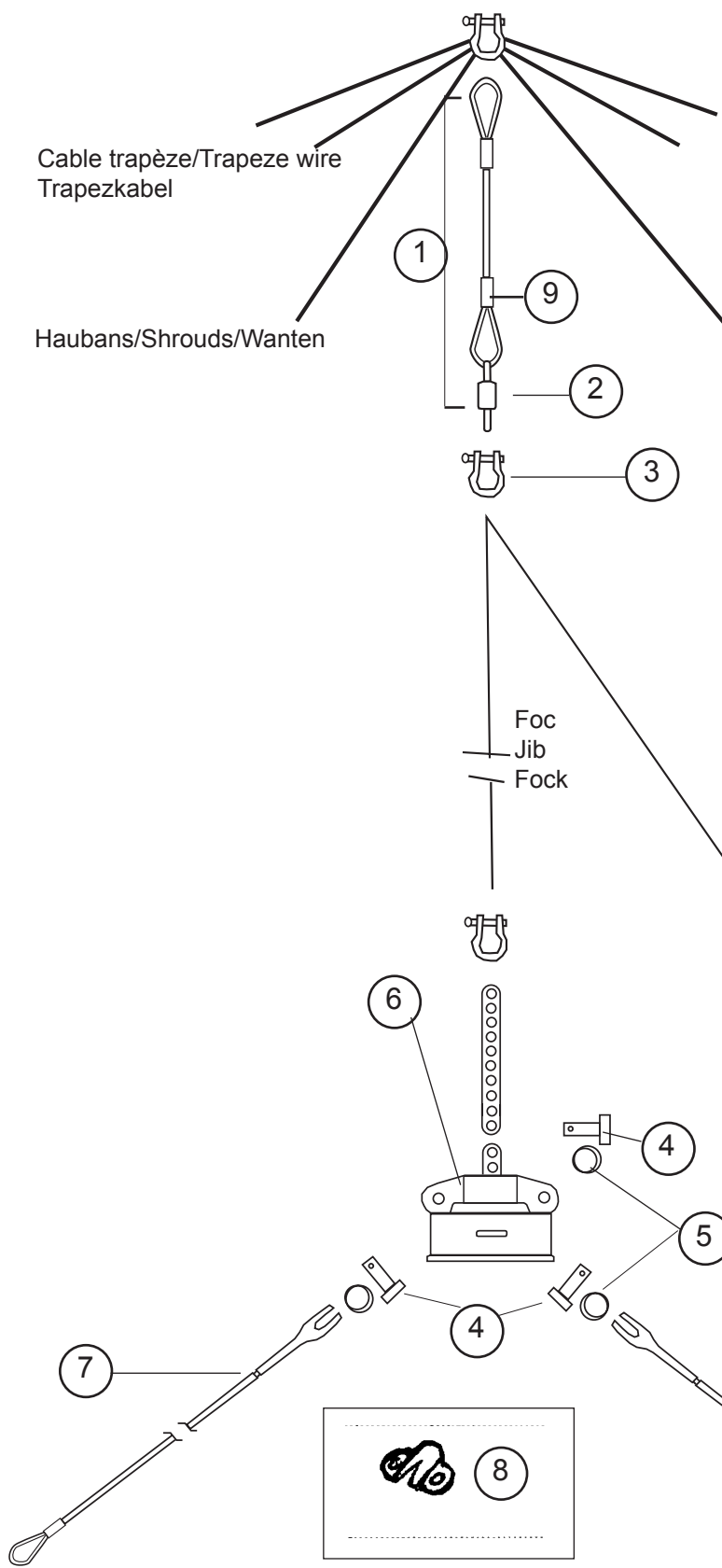

**16070340**  
**Kit enrouleur de foc**  
**Jib furling assembly**  
**Fockroller Kit**

- |                |  |
|----------------|--|
| 1 - 16080514 : | Estrope + émerillon<br>Pigtail + swivel<br>Pigtail komplett              |
| 2 - 18060590 : | Pivot étai de foc<br>Forestay swivel<br>Fockvorstagwirbel                |
| 3 - 99220665 : | Manille lyre D6<br>(x10)<br>Shackle D6<br>Schäkel D6                     |
| 4 - 99056230 : | Axe percé<br>(x10)<br>Clevis pin drilled<br>Bolzen gebohrt               |
| 5 - 99220230 : | Anneau brisé<br>(x10)<br>Split ring<br>Ringsplint                        |
| 6 - 21060150 : | Enrouleur<br>Jib furling assy<br>Fockroller                              |
| 7 - 16080571 : | Bride enrouleur<br>Bridle<br>Hahnepot                                    |
| 8 - 99500415 : | Taquet coinçeur trav.AV<br>Jam cleat front crossbar<br>Klemme Vorderholm |
| 9 - 99056249 : | Manchon D4<br>(x10)<br>Sleeve<br>Hülse                                   |

# **HC 16** Safran/Rudder/Ruderblatt

## **GOUVERNAIL STD / RUDDER ASSEMBLY STD** **RUDER KOMPLETT STD**

**16062101 (STD/Easy) : Droit/Right/Rechts**  
**16062102 (STD/Easy) : Gauche/Left/Links**

**16062142 (carbone) : Droit/Right/Rechts**  
**16062141 (carbone) : Gauche/Left/Links**

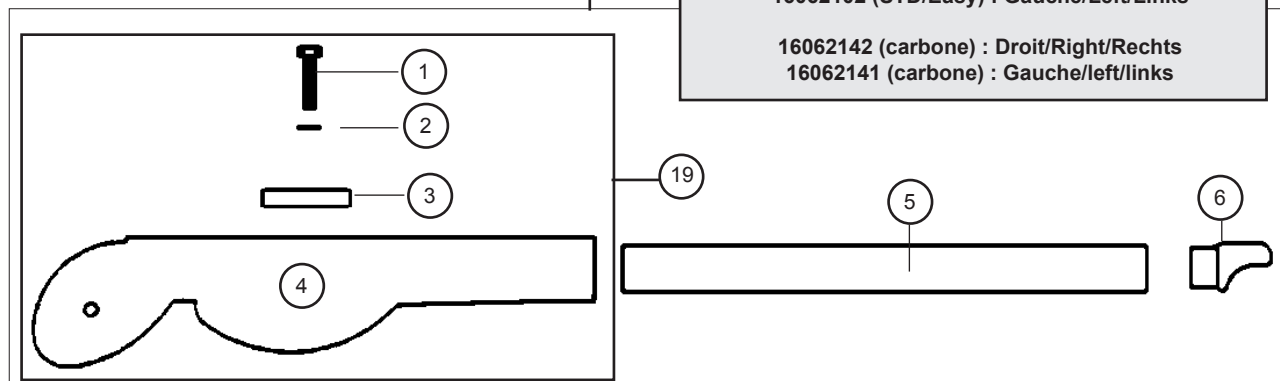

- |   |  |   |
|---|--|---|
| 1 -99220930 (x10) :Vis casting<br>Casting Bolt<br>Schraube Gußteil      | 5 -16062150 : Tube gouvernail nu noir<br>Tiller tube black<br>Ruderrohr schwarz roh  | 8 - 99056239 (x10) :Ecrou indessérable<br>Nylstop nut<br>Selbstsichernde Mutter           |
| 2 -99220750 (x10) : Rondelle<br>Washer<br>Unterlegscheibe               | 6 -99000005 : Embout à rotule<br>Tillerend cap<br>Pinnenendstück   | 9 - 16062110 (Plastic): Lame safran<br>99502140 (White Knight)Rudder blade<br>Ruderblatt  |
| 3 -14061122 : Platine dural<br>Cam stop plate<br>Platin Rudergußteil    | 7 -Vis de safran/Rudder bolt/Schraube Ru-<br>derblatt<br>ABS = TH 8x55 : 99220940 (x10)<br>White Knight = TH 8x60 : 99220880 (x10) | 10 - 99502130(Easy):Insert lame de safran<br>Sheave pin rudder blade<br>Bolzen Ruderblatt |
| 4 -14000045 : Casting supérieur<br>Upper casting<br>Oberes Rudergußteil |  | 11 -14061183 (x10) : Came safran<br>Plastic Cam<br>Rudernock                              |

99220725 (x10) Rondelle  
nylon/Nylon washer D20  
99220181 (x10) Rondelle  
Nylon/Nylon washer D60

- 12 - 99220620 (x10) : Goupille élastique  
Rudder cutter pin  
Sprengbolzen
- 13 - 14000155 : Casting inférieur nu  
Lower casting  
Ruderkopf
- 14- Aiguillot + anneau brisé/Rudder pin + split  
ring/Rudربولzen + Ringsplint :  
Alu : 16080345 (x10)  
Inox : 16070370 (x10)
- 15 -14061106 (x10) : Pene safran  
Plunger  
Gegenstück Ruderknock
- 16 - 99220685 (x10) : Ressort de Gouv.  
Rudder spring  
Ruder-Feder
- 17 -99220825 (x10) : Vis safran delrin  
Delrin screw  
Delrinschraube
- 18 -14062120 : Casting inférieur monté  
Lower casting assembly  
Ruderkopf montiert unten
- 19 - 14062130 : Casting supérieur monté  
Upper casting assembly  
Ruderkopf montiert oben
- 20 -16062131 : Bras gouv. D complet  
Rudder arm right compl.  
Ruderarm rechts kompl.
- 16062132 : Bras gouv. G complet  
Rudder arm left compl.  
Ruderarm links kompl.

 99220128(x10) Entretoise  
plastique/Plastic bushing/  
Distanzhülse Plastic

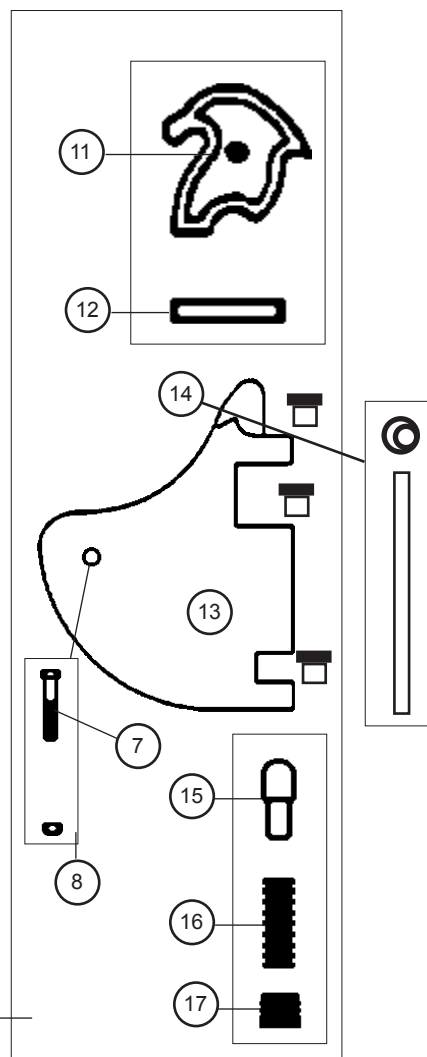



## HC 16

Barre d'accouplement Tiller crossbar / Anlenkstange

16062200 : Std

16062220 : Renforcée/Reinforced/Verstärkt

16062210 : nue/bare/rohr

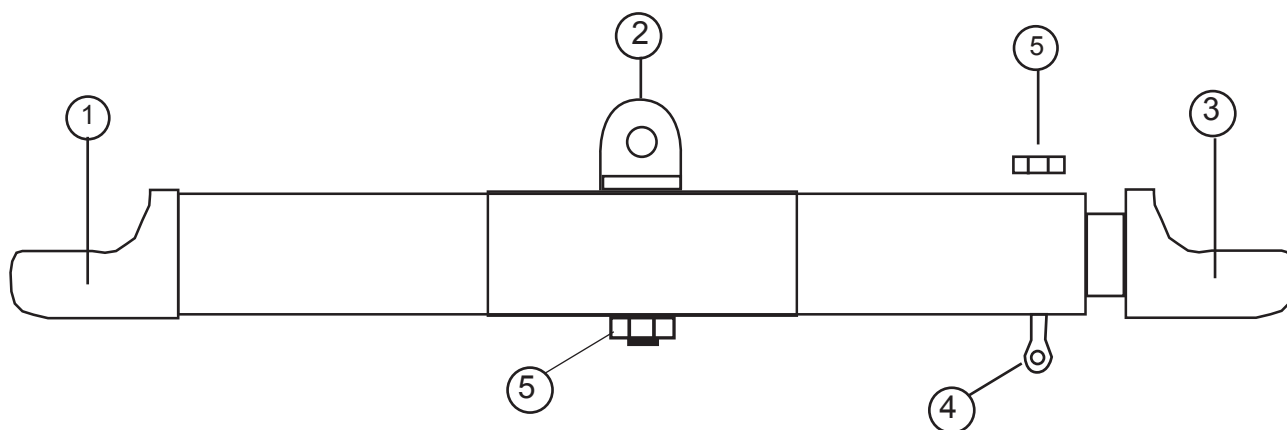

- 1- 99000005: Embout à rotule  
Tiller end cap  
Pinnenendstück
- 2 - 99220955 (x4): Vis violon  
Violon screw  
Schraube für Pinnengelenk

- 3 - 99000010: Coulisseau réglable  
Adjustable tiller end cap  
Gleiter
- 4 - 99056269 (x10): Vis manillon  
Tiller adjusting screw  
Schraube
- 5 - 99056239 (x10): Ecrou indessérable D8  
Nylstop nut D8  
Selbstsichernde Mutter D8

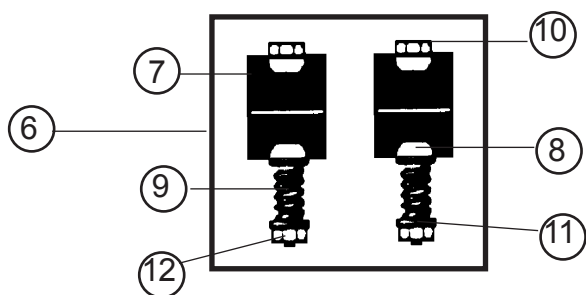

- 6 - 99500380: Kit d'articulation TCM  
Tiller connector kit TCM  
Verbindungsgelenk TCM
- 7 - 99500331: Demi-pallier  
Rubberspacer  
Distanzhülse
- 8 - 99220965 (x20): Demi-bille nylon  
Half ball nylon  
Nylon Halbkugel
- 9 - 99500336 (x10): Ressort TCM  
TCM spring  
TCM-Feder
- 10 - 99220875 (x10): Vis TH 6 x 50  
TH screw  
TH Schraube
- 11 - 99220745 (x10): Rondelle inox  
Stainless washer  
Unterlegscheibe
- 12 - 99056238 (x10): Ecrou indessérable D6  
Nylstop nut D6  
Selbstsichernde Mutter D6

## Hobie Cat 16

### Gouvernail & Barre d'accouplement Race Rudder assembly & Tiller crossbar Race Ruderanlage & Anlenkstange Race

**Barre d'accouplement Race/Tiller crossbar Race/Anlenkstange Race:**  
**16062261 (complete/Komplett) - 16062290 : (nue/bare/rohr)**

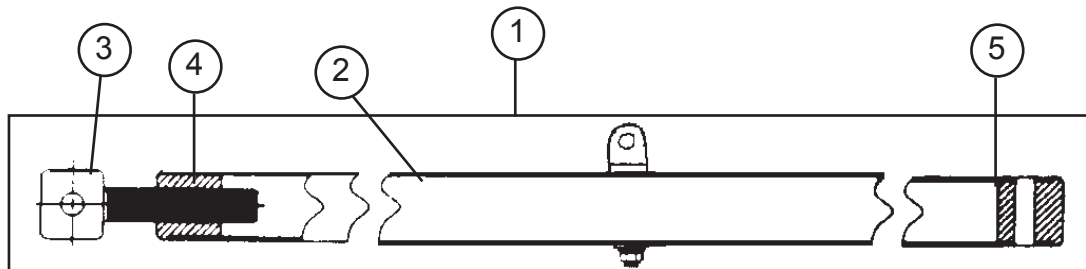

**Gouvernail/Rudder assembly/Ruderanlage :**  
**White knight = 16062145 (G/L/L) - 16062146 (D/R/R)**  
**Carbon = 16062134 (G/L/L) - 16062136 (D/R/R)**  
**Fleur/Flower/Blumen = 16062138 (G/L/L) - 16062140 (D/R/R)**

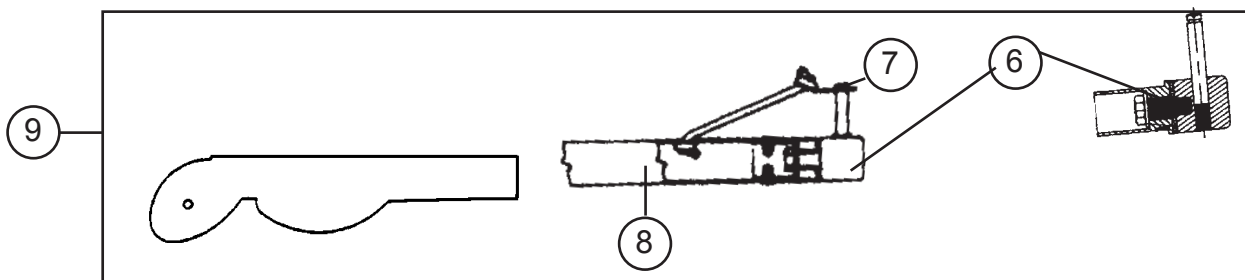

- |                     |  |
|---------------------|--|
| 1 - 16062261 :      | Barre d'accouplement Race complète<br>Race tiller crossbar complete<br>Anlenkstange kompl. Race        |
| 2- 18062291 :       | Tube de gouvernail nu<br>Tiller tube bare<br>Ruderrohr roh   |
| 3- 99220810 (x2) :  | Vis de réglage<br>Adjustment arm<br>Anlenkstange-Einstellschraube                                      |
| 4- 99220119 :       | Embout fileté<br>Threaded end cap<br>Enstück mit Gewinde   |
| 5- 99220121         | Embout de barre accouplement percé<br>Tiller crossbar drilled end cap<br>Anlenkstange-Endstück gebohrt |
| 6 - 99220164 :      | Embout de gouvernail pivotant<br>Tiller end cap pivoting<br>Ruderarmenstück                            |
| 7 - 99220169 (x2) : | Clip rapide<br>Retainer clip<br>Sicherungsclip   |
| 99220603 (x2) :     | Axe vertical/Vertical pin  |
| 8 - 16062150 :      | Tube de gouvernail Race<br>Tiller tube Race<br>Ruderrohr Race  |
| 9 - 16062148        | Bras de gouv. droit complet<br>Rudder arm right complete<br>Ruderarm rechts kompl.                     |
| 16062147            | Bras de gouv. gauche complet<br>Rudder arm left complete<br>Ruderarm links kompl.                      |

③+④+⑤+2X ⑥+ 2X ⑦= 99600025 :

Kit articulation Race complet  
Race tiller connector kit complete

## HC 16

### Stick/Extension/Pinne

16061301 : Stick fibre de verre/Fiberglass tiller extension

16062305 : Stick aluminium/Aluminium tiller extension/Aluminium Pinnenausleger

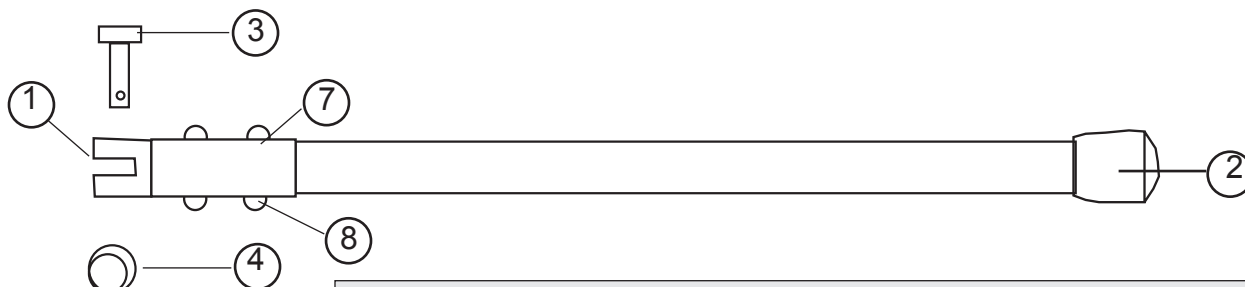

- 1 - 14061321 (x2): Chape d'articulation stick  
Hinge
- 2 - 99056244 (x10): Embout stick fibre  
Fiberglass extension tip  
Pinnenendstück Fiberglas
- 14061316 (x10): Embout stick alu  
Aluminium extension tip  
Pinnenendstück Aluminium
- 3 - 14061241 (x10): Axe percé art. stick  
Clevis pin  
Bolzen Pinnengelenk
- 4 - 99220230 (x10): Anneau brisé  
Split ring  
Ringsplint
- 5 - 99501310: Kit d'articulation stick télescopique  
Tiller connector kit telescopic tiller extension  
Pinnengelenk telescopic Pinne
- 6 - 99502330: Stick télescopique FX4 petit modèle (Kit art. inclus)  
FX4 telescopic extension small (incl. connector kit)  
Teleskop Pinnenausleger FX4 klein (inkl. Pinnengelenk)
- 7 - 99220900 (x10): Vis TH 5 x 25  
Screw TH 5 x 25  
Schraube TH 5 x 25
- 8 - 99056237 (x10): Ecrou indesserrable 5  
Nylstop nut 5  
Selbstsichernde Mutter 5

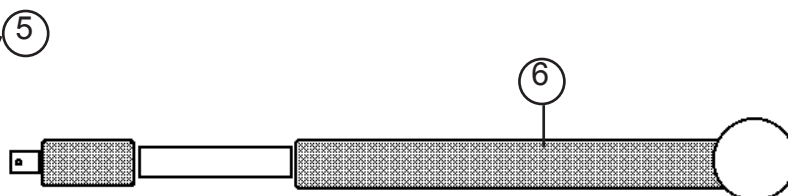
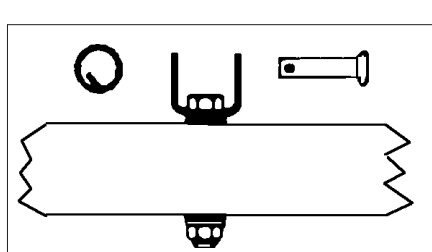

# MAT COMPLET/MAST ASSEMBLY/MAST KOMPLETT

## Classic/Easy/Club

1 pièce/one piece/1-teilig = 16042701

2 pièces/Two piece/2-teilig =16042792

## Race :

1 pièce/one piece/1-teilig = 16042715

2 pièces/Two piece/2-teilig =16042794

## 16041770 :

Kit mât 2 pièces/Kit 2-piece mast/Kit 2-teiliger Mast

## HC 16

## Mât/Mast/Mast

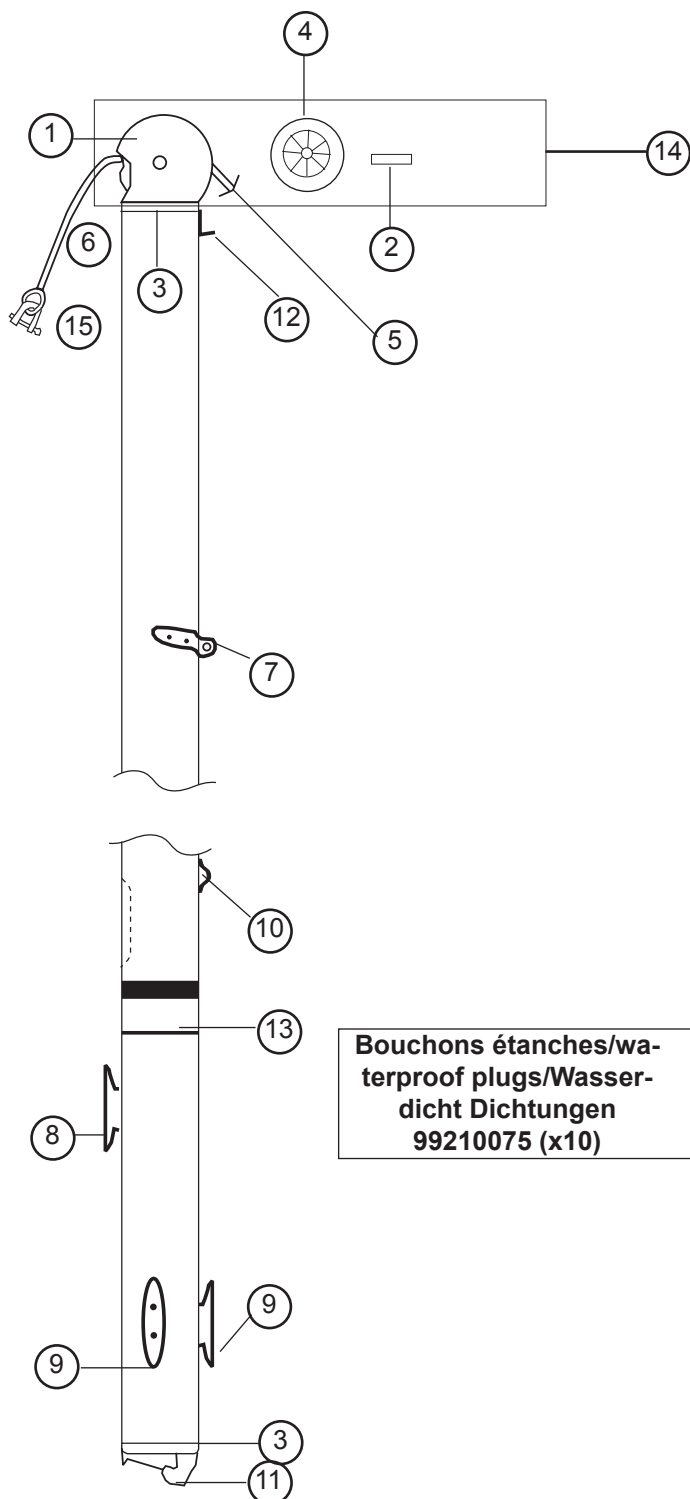

**Bouchons étanches/wa-  
terproof plugs/Wasser-  
dicht Dichtungen  
99210075 (x10)**

- |                      |  |
|----------------------|--|
| 1- 16000005:         | Tête de mât noire<br>Black mast head<br>Mastkopf schwarz   |
| 2- 14041711:         | Axe tête de mât<br>Sheave pin mast head<br>Bolzen Mastkopf   |
| 3- 16041753:         | Sceau mât<br>Mast plug<br>Mast Abdichtung  |
| 4- 16041711:         | Réa<br>Nylon sheave<br>Rolle   |
| 5- 16041750:         | Drisse câble GV<br>Main halyard wire<br>Grossfall Kabel  |
| 6- 14070460:         | Drisse cordage<br>Halyard rope<br>Fall   |
| 7- 16041721:         | Ferrure capelage<br>Mast tang<br>Mastbeschlag  |
| 8- 14041720 (x10):   | Taquet étarq amure<br>Downhall cleat<br>Klampe   |
| 9- 99220760 (x10):   | Taquet de drisse<br>Halyard Cleat<br>Niederholer Mastklemme  |
| 10- 99220216 (x5):   | Pontet coque traverse<br>Pad-eye<br>Bügel  |
| 11- 16000010 :       | Base mât noire<br>Black mast base<br>Mastfuss schwarz  |
| 12- 18541720 :       | Hook de drisse<br>Halyard hook<br>Fallhaken  |
| 13- 14041723 :       | Autocollant de sécurité<br>Mast caution label<br>Sicherheitsaufkleber  |
| 14- 16042710 :       | Tête de mât complète (avec réa et drisse)<br>Mast head complete (w/ sheave & halyard)<br>Mastkopf komplett (mit Rolle u. Großfall) |
| 15- 99220665 (x10) : | Manille 6 mm<br>Shackle 5 mm<br>Schäkel 6 mm   |

**HC 16**  
Cunningham de foc/Jib cunningham  
16080220

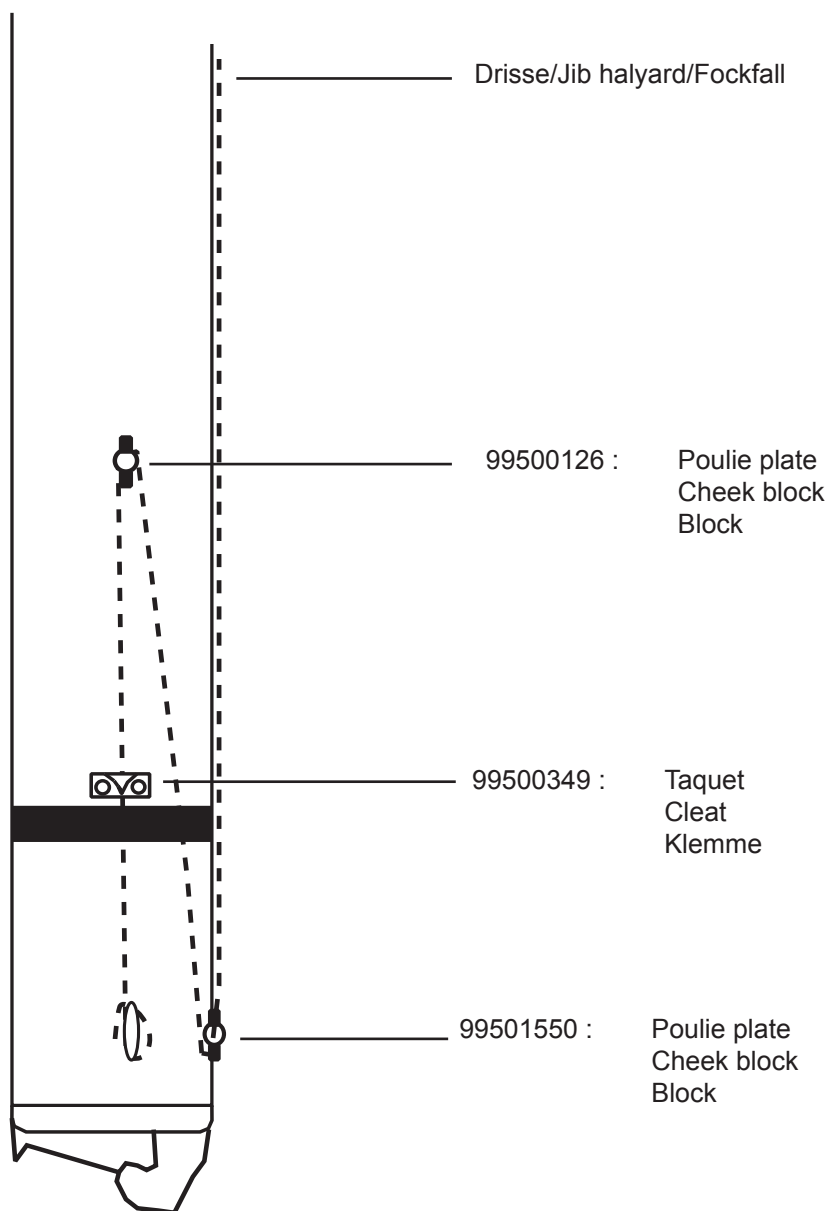

Traverse avant LE complète rail intégré (pour pièces)  
 Front crossbar LE integrated rail complete (only spare)  
 Vorderholm LE integrierte Trav. Schiene komplett (nur Ersatzteile)

**HC 16**  
 Traverse avant LE (RI)  
 Front crossbar LE (RI)  
 Vorderholm LE (RI)

**(Models < 1999)**

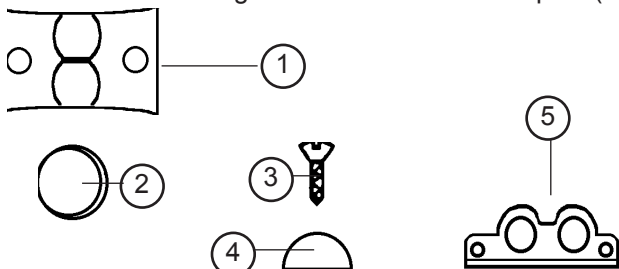

- 1 - 99220063: Taquet renvoi foc (vert)  
 Jib cleat + screw (green)  
 Fockumlenk-Klemme (grün)  
 (99220064: Rouge/red/rot)  
 2 - 14041709 (x10): Coussinet teflon  
 Teflon chip  
 Teflonplättchen  
 3 - 99220840 (x10): Vis rail de foc  
 Screw stainless  
 Schraube Fockschiene

- 4 - 99220965 (x20): Demi-bille nylon  
 Half nylon ball  
 Nylon Halbkugel  
 5 - 99500670 (x10): Chariot de foc Trentec  
 Trentec traveller car  
 Focktraveller Trentec  
 6 - 16062620: Traverse avant RI galbée nue noire  
 Black bare front bar bent RI  
 Vorderholm roh  
 7 - 14000025: Emplanture de mât noire  
 Mast step black  
 Mastfusspfanne schwarz  
 8 - 16041756 (x10): Goupille élast.  
 Mast step pin  
 Achse f.Nock/Ruderanlage

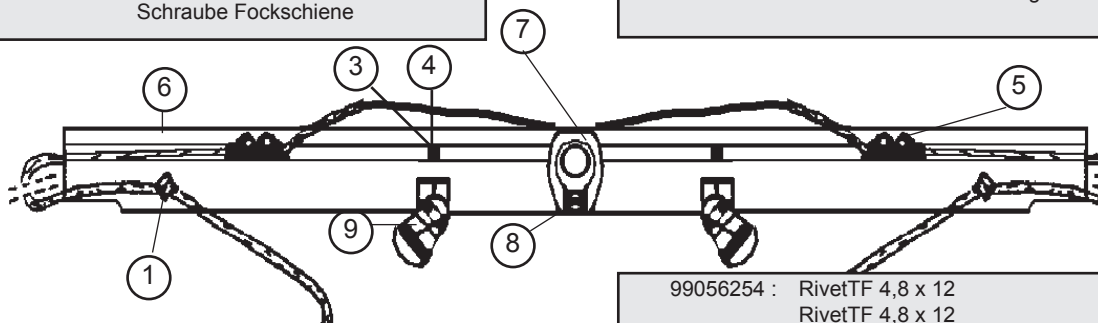

- 9 - 16080535: Tourelle monte-carlo + base  
 Swivel cam cleat + base  
 Drehklemme Fockschot  
 99500915: Taquet tourelle  
 (x5)  
 Cleat  
 Klemme

- 99056254: RivetTF 4,8 x 12  
 RivetTF 4,8 x 12  
 Popniete TF4,8 x 12  
 10 - 16061650: Etai martingale percé  
 Striker bar  
 Dolphinstriker  
 11 - 16061661: Martingale  
 Striker rod  
 Unterzug

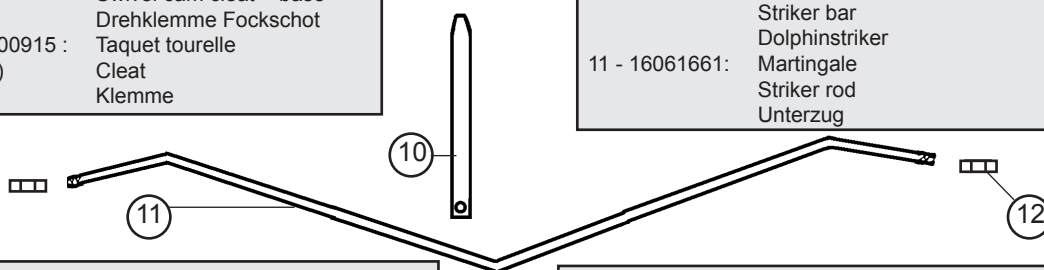

- 12 - 99056236 (x10): Ecrou martingale  
 Striker rod nut  
 Mutter Unterzug  
 13 - 16000020: Casting av G + bossage  
 Lt frt corner cast/garage  
 Vordereckgusst.links + garage  
 14 - 16000025: Casting av D + bossage  
 Rt frt corner cast/garage  
 Vordereckgusst.rechts + garage  
 15 - 99220845 (x10): Vis TF 3,9 x 31,7  
 Screw 3,9 x 31,7  
 Schraube 3,9 x 31,7.

- 16 - 16061690: Axe rea renvoi char. foc  
 Jib traveller sheave pin  
 Buchse Focktraveller  
 17 - 18041765: Réa tête de mât  
 Mast head sheave  
 Mastkopfrillenrolle  
 18 - 99220870 (x10): Vis pylône  
 Pylon bolt  
 Schraube  
 19 - 99220610 (x10): Ecrou nylon pylône  
 Pylon nut  
 Mutter Nylon Pylon

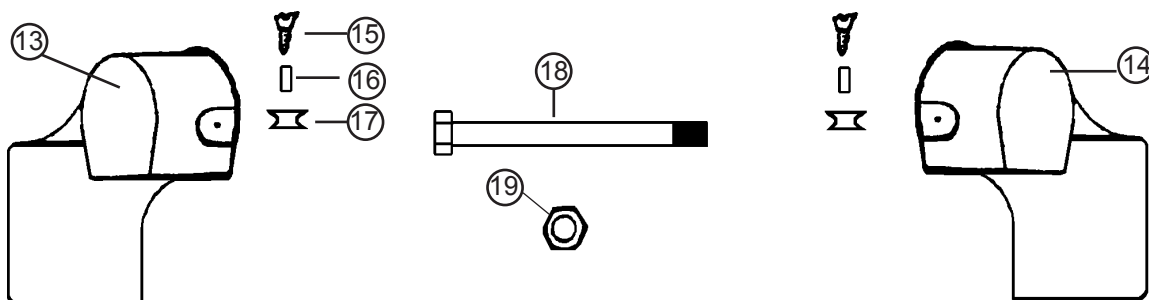

Traverse avant LE complète rail intégré (pour pièces)  
 Front crossbar LE integrated rail complete (only spare)  
 Vorderholm LE integrierte Trav. Schiene komplett (nur Ersatzteile)

**HC 16**  
 Traverse avant LE (RI)  
 Front crossbar LE (RI)  
 Vorderholm LE (RI)

(models 2000-2002)

1- 14041709 (x10): Coussinet teflon  
 Teflon chip

2 - 99220840 (x10): Vis rail de foc  
 Screw stainless  
 Schraube Fockschiene

3 - 99220965 (x20): Demi-bille nylon  
 Half nylon ball  
 Nylon Halbkugel

4 - 99300525: Sandow noir D5  
 Black shock cord  
 Schwarze Gummileine

5 - 16062620: Traverse avant galbée nue noire  
 Black bare front bar bent  
 Vorderholm roh

6 - 14000025: Emplanture de mât noire  
 Mast step black  
 Mastfusspfanne schwarz

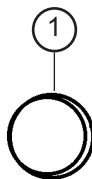

7 - 16041756 (x10): Goupille élast.  
 Mast step pin

8 - 99500440: Taquet Harken H315  
 Harken cleat H315

9 - 99500126: Poulie H233  
 H233 Block  
 Block H 233

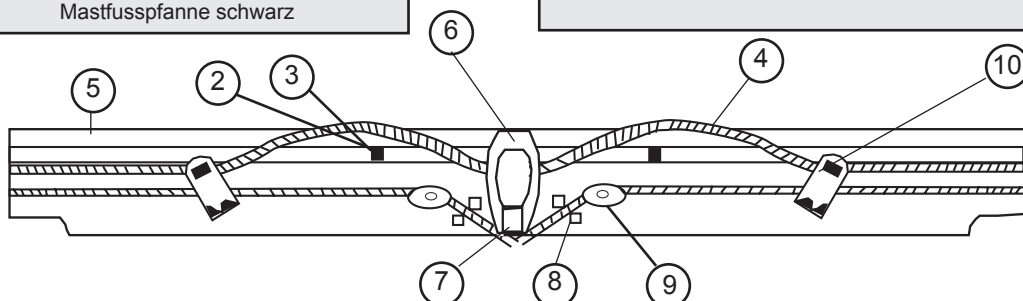

10 - 16080010 (G/L): Tourelle  
 16080015 (D/R): Swivel cam cleat  
 Drehklemme  
 18580050: Platine tourelle  
 swivel plate  
 Drehklemmeplatte

11 - 16061650: Etai martingale percé  
 Striker bar  
 Dolphinstriker  
 12 - 16061661: Martingale  
 Striker rod  
 Unterzug

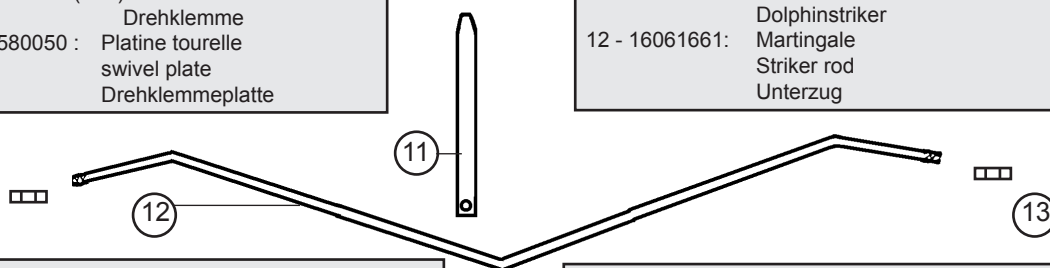

13 - 99056236 (x10): Ecrou martingale  
 Striker rod nut  
 Mutter Unterzug  
 14 - 16000020: Casting av G + bossage  
 Lt frt corner cast/garage  
 Vordereckgusst.links + garage  
 16000025: Casting av D + bossage  
 Rt frt corner cast/garage  
 Vordereckgusst.rechts + garage  
 15 - 99220845 (x10): Vis TF 3,9 x 31,7  
 Screw 3,9 x 31,7  
 Schraube 3,9 x 31,7.

16 - 16061690: Axe rea renvoi char. foc  
 Jib traveller sheave pin  
 Buchse Focktraveller  
 17 - 18041764: Réa tête de mât  
 Mast head sheave  
 Mastkopfrillenrolle  
 18 - 99220870 (x10): Vis pylône  
 Pylon bolt  
 Schraube  
 19 - 99220610 (x10): Ecrou nylon pylône  
 Pylon nut  
 Mutter Nylon Pylon

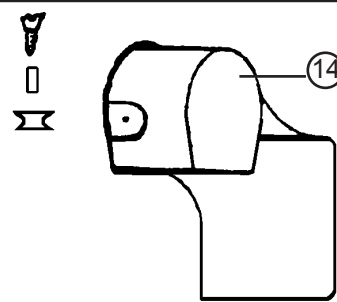
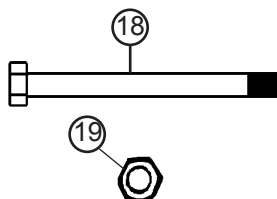
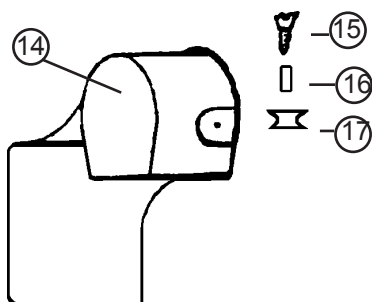

16062590 : Traverse avant Club complète rail intégré  
Front crossbar club integrated rail complete  
Vorderholm club integrierte Trav. Schiene komplett

**HC 16**  
Traverse avant Club (RI)  
Front crossbar Club (RI)  
Vorderholm Club (RI)

(Model > 2003)

- 1 - 14041709 (x10): Coussinet teflon  
Teflon chip  
Teflonplättchen
- 2 - 99220840 (x10): Vis rail de foc  
Screw stainless  
Schraube Fockschiene
- 3 - 99220965 (x20): Demi-bille nylon  
Half nylon ball  
Nylon Halbkugel
- 4 - 99500670 (x10) : Chariot de foc Trentec  
Trentec traveller car  
Focktraveller Trentec
- 5 - 16062620: Traverse avant RI galbée nue noire  
Black bare front bar bent RI  
Vorderholm roh
- 6 - 14000025: Emplanture de mât noire  
Mast step black  
Mastfusspfanne schwarz

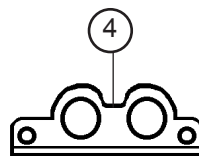
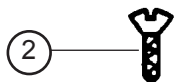

- 7 - 16041756 (x10): Goupille élast.  
Mast step pin  
Achse f.Nock/Ruderanlage
- 8 - 99500354: Tourelle taquet carbo  
Swivel cam cleat  
Drehklemme
- 9 - 99500900 : Support tourelle  
(x2)  
Swivel cam cleat plate  
Drehklemme-Platte

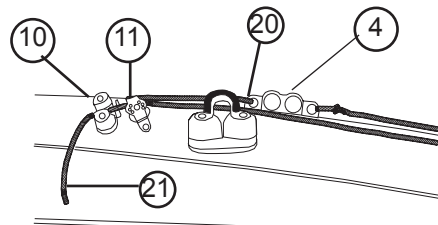
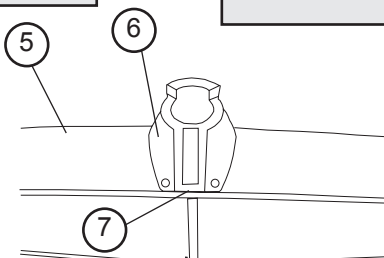
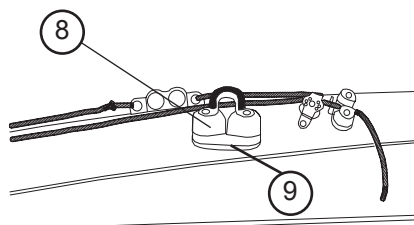

- 10 - 99500440: Taquet Harken H315  
Harken cleat H315  
Klemme Harken H315
- 11 - 99500126: Poulie H233  
H233 Block  
Block H 233

- 12 - 16061650: Etai martingale percé  
Striker bar  
Dolphinstriker
- 13 - 16061661: Martingale  
Striker rod  
Unterzug
- 14 - 99056236 (x10): Ecrou martingale  
Striker rod nut  
Mutter Unterzug

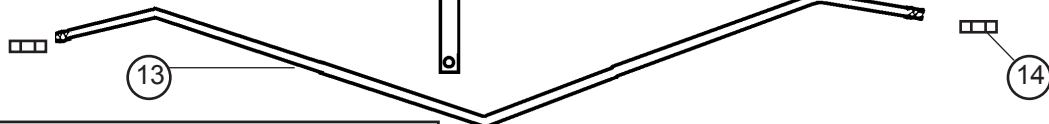

- 15 - 16000020: Casting av G + bossage  
Lt frt corner cast/garage  
Vordereckgusst.links + garage
- 16000025: Casting av D + bossage  
Rt frt corner cast/garage  
Vordereckgusst.rechts + garage
- 16 - 99210013 (x10): Rivet alu 4,8 x 32  
Rivet alu 4,8 x 32  
Popniete alu 4,8 x 32
- 17 - 18041764: Réa tête de mât alu  
Mast head sheave alu  
Mastkopfrillenrolle Alu

- 18 - 99220870 (x10): Vis pylône  
Pylon bolt  
Schraube
- 19 - 99220610 (x10): Ecrou nylon pylône  
Pylon nut  
Mutter Nylon Pylon
- 20 - 99300525 : Sandow noir D5  
Shock cord black D5  
Gummistrop schwarz D5
- 21 - 99300520 : Cordage D5 noir  
Black rope D5  
Leine schwarz D5

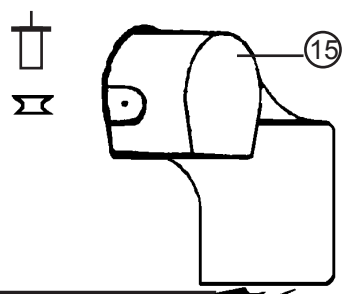
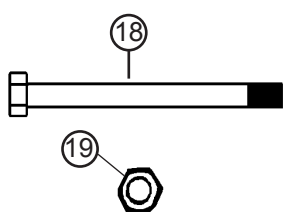
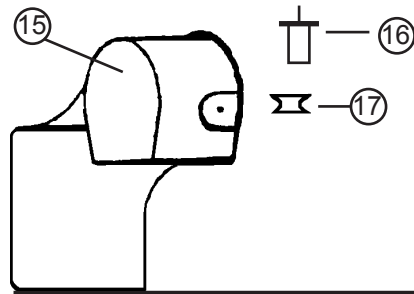



## HC 16

Traverse avant Race RI pre-équipée Spi / Front crossbar Race RI w/spi rig  
Vorderholm Race RI mit Spi Rig (MODEL >2003) - 16062592

### Equipement spi/Spi equipment

17070150 : Poulie étarquage simple Single block  
Einfach Block  
99220057 : Pontet forgé D5 Pad Eye  
Bügel  
16056025 : Articulation tangon Spi pole connection  
Verbindung Spibaum

- 1 - 14041709 (x10): Coussinet teflon  
Teflon chip  
Teflonplättchen
- 2 - 99220840 (x10): Vis rail de foc  
Screw stainless  
Schraube Fockschiene
- 3 - 99220965 (x20): Demi-bille nylon  
Half nylon ball  
Nylon Halbkugel
- 4 - 99500670 (x10) : Chariot de foc Trentec  
Trentec traveller car  
Focktraveller Trentec
- 5 - 16062620: Traverse avant RI galbée nue noire  
Black bare front bar bent RI  
Vorderholm roh
- 6 - 14000025: Emplanture de mât noire  
Mast step black  
Mastfusspfanne schwarz

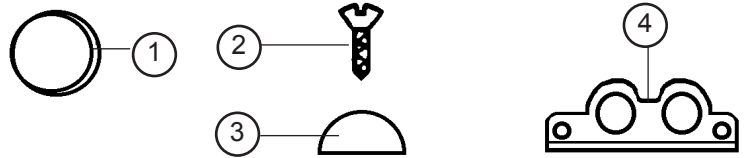

- 7 - 16041756 (x10): Goupille élast.  
Mast step pin  
Achse f.Nock/Ruderanlage
- 8 - 99500354: Tourelle taquet carbo  
Swivel cam cleat  
Drehklemme
- 9 - 99500900 : Support tourelle  
(x2) Swivel cam cleat plate  
Drehklemme-Platte

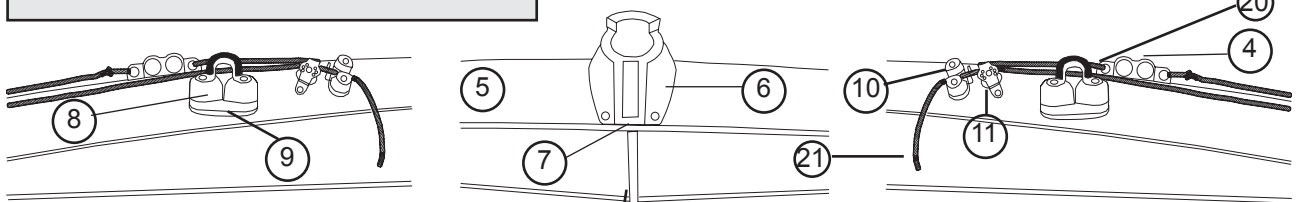

- 10 - 99500440: Taquet Harken H315  
Harken cleat H315  
Klemme Harken H315
- 11 - 99500126: Poulie H233  
H233 Block  
Block H 233

- 12 - 16061650: Etai martingale percé  
Striker bar  
Dolphinstriker
- 13 - 16061661: Martingale  
Striker rod  
Unterzug
- 14 - 99056236 (x10): Ecoux martingale  
Striker rod nut  
Mutter Unterzug

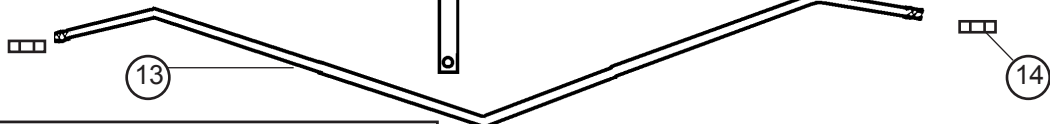

- 15 - 16000020: Casting av G + bossage  
Lt frt corner cast/garage  
Vordereckgusst.links + garage
- 16000025: Casting av D + bossage  
Rt frt corner cast/garage  
Vordereckgusst.rechts + garage
- 16 - 99210013 (x10): Rivet alu 4,8 x 32  
Rivet alu 4,8 x 32  
Popniete alu 4,8 x 32
- 17 - 18041764: Réa tête de mât alu  
Mast head sheave alu  
Mastkopfrillenrolle Alu

- 18 - 99220870 (x10): Vis pylône  
Pylon bolt  
Schraube
- 19 - 99220610 (x10): Ecoux nylon pylône  
Pylon nut  
Mutter Nylon Pylon
- 20 - 99300525 : Sandow noir D5  
Shock cord black D5  
Gummistrop schwarz D5
- 21 - 99300520 : Cordage D5 noir  
Black rope D5  
Leine schwarz D5

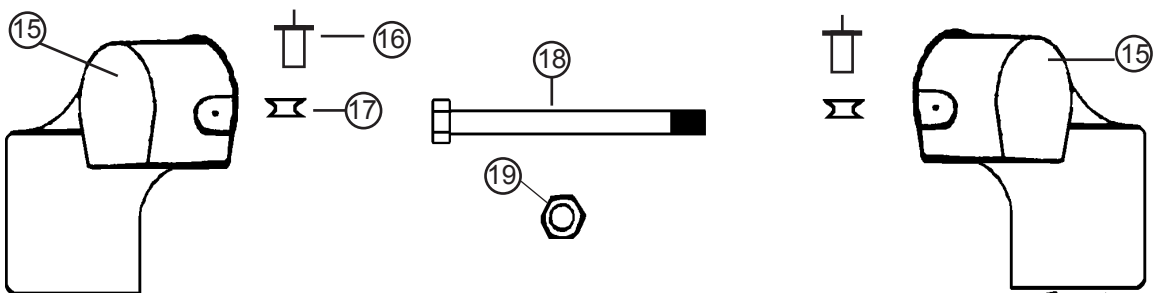

## HC 16

Traverse avant Easy/Front crossbar Easy  
/Vorderholm Easy **16062660**  
(avec Poulie/with block/mit Block)

- 1 - 13080340 : Poulie de foc turbo  
Jib block turbo  
Fockblock turbo
- 13080345 : Taquet de remplacement  
Replacement Cleat
- 2 - 99500755 : Ressort plastique poulie  
Plastic spring jib sheet block  
Plastic Feder für Fockshot-  
block
- 3 - 14041709 (x10) : Coussinet teflon  
Teflon chip  
Teflonplättchen
- 4 - 14056002 : Ferrure étau 14  
Bow tang  
Bugbeschlag
- 5 - 14000025 : Emplanture de mât noire  
Mast step black  
Mastfuss schwarz
- 6 - 16041756 (x10) : Goupille élast.  
Mast step pin

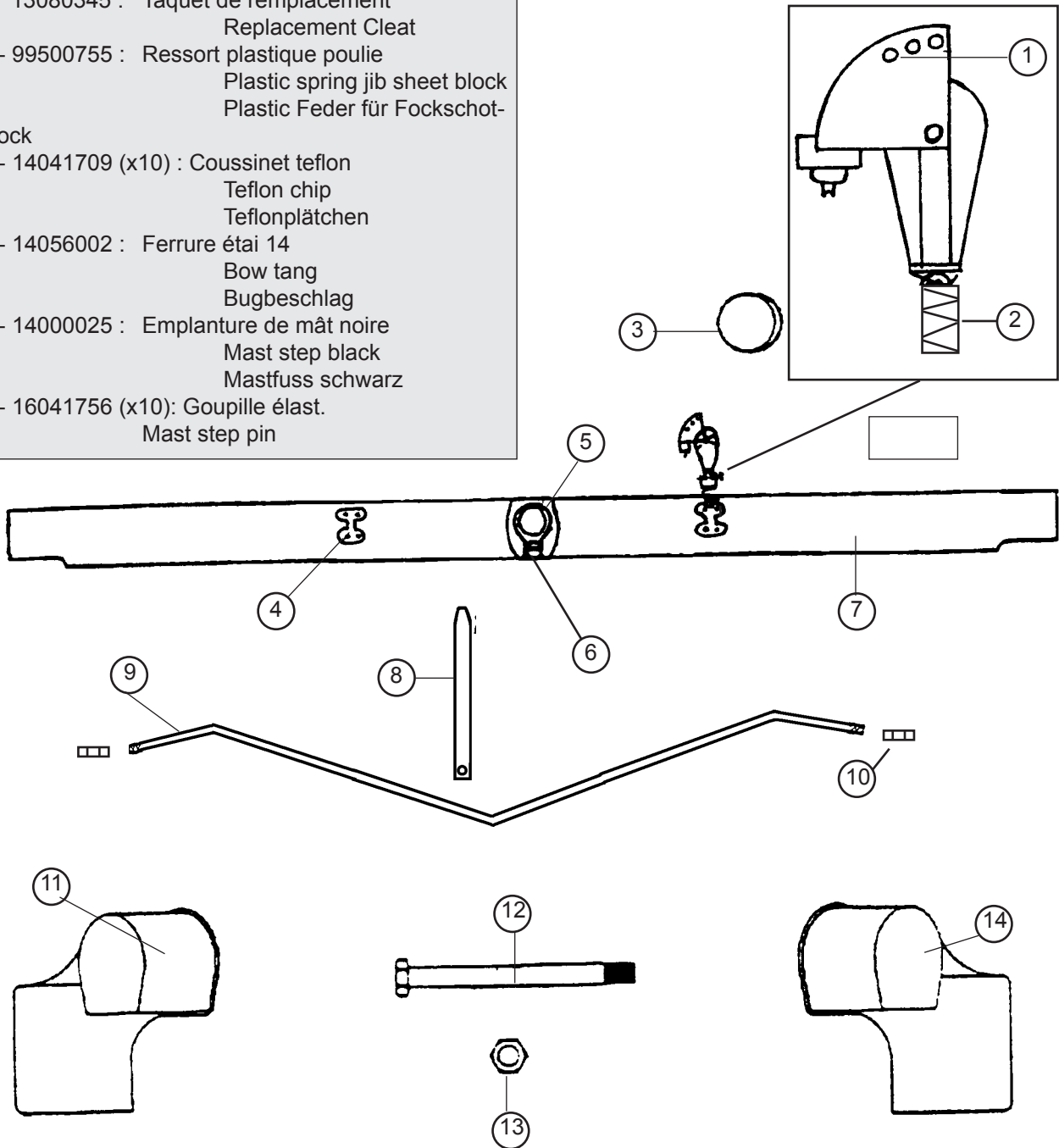

- 7 - 16062610 : Traverse avant galbée nue  
Bare front bar bent  
Vorderholm roh
- 8 - 16061650 : Etai de martingale percé  
Tensioner rod  
Dolphinstriker
- 9 - 16061661 : Martingale  
Striker bar  
Unterzug
- 10 - 99056236 (x10) : Ecrou martingale  
Striker rod nut  
Mutter Unterzug

- 11 - 14000065 : Casting av G noir  
Lt frt corner casting black  
Vordereckgusst.links schwarz
- 12 - 99220870 (x10) : Vis pylône  
Pylon bolt  
Schraube
- 13 - 99220610 (x10) : Ecrou nylon pylône  
Pylon nut  
Mutter Nylon Pylon
- 14 - 14000070 : Casting av D noir  
Rt frt corner cast black  
Vordereckgusst.rechts schwarz

## HC 16

### Traverse AV Std/Front crossbar Std/Vorderholm Std 16062700 (avec poulie/with block/mit Block)

- 1 - 16080354 : Poulie winch foc + chariot  
Jib sheet block with car  
Fockschotknarrblock mit Schlitten
- 2 - 16061640 : Embout rail écoute foc  
Jib traveller end stop  
Endst. f. Fockschotschiene
- 3 - 14041709 (x10) : Coussinet teflon  
Teflon chip  
Teflonplättchen
- 4 - 16061630 : Rail d'écoute de foc  
Jib track  
Fockschotschiene

- 5 - 14000025 : Emplanture de mât noire  
Mast step black  
Mastfuss schwarz
- 6 - 16041756 (x10): Goupille élast.  
Mast step pin  
Achse f.Nock/Ruderanlage

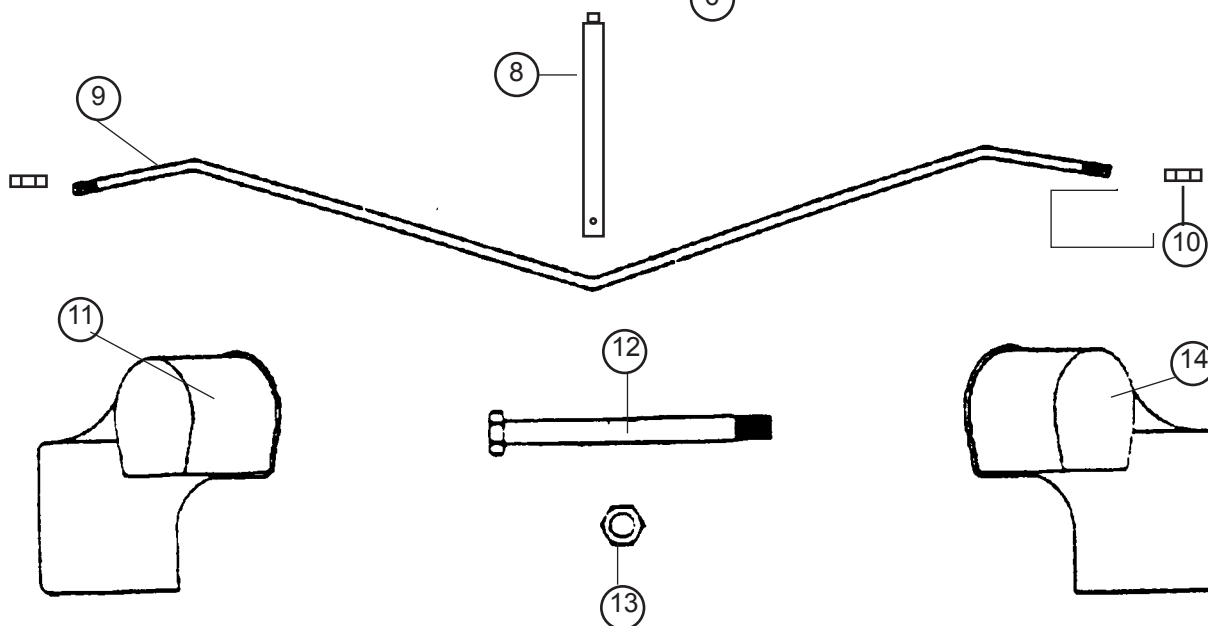
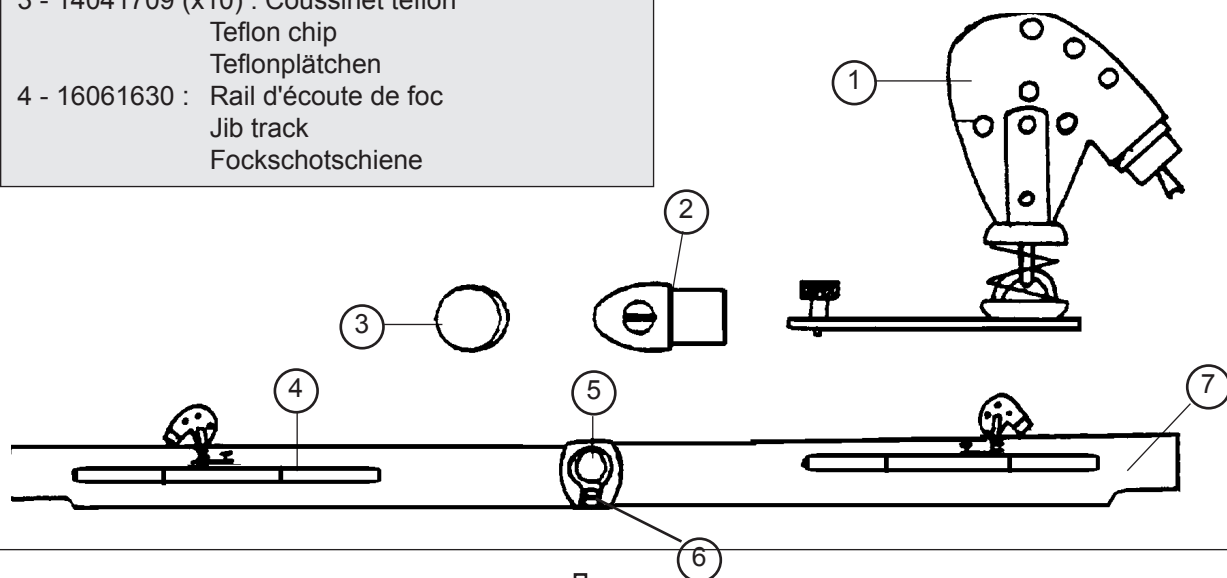

- 7 - 16062610 : Traverse AV galbée nue  
Bare front crossbar bent  
Vorderholm roh
- 8- 16061650: Etai de martingale percé  
Striker bar  
Unterzug gebohrt
- 9- 16061661: Martingale  
Striker rod  
Dolphinstriker
- 10- 99056236 (x10): Ecrou martingale  
Striker rod nut  
Mutter Dolphinstriker

- 11 - 14000065: Casting av G noir  
Lt frt corner casting black  
Vordereckgusst.links schwarz
- 12 - 99220870 (x10): Vis pylône  
Pylon bolt  
Schraube
- 13 - 99220610 (x10): Ecrou nylon pylône  
Pylon nut  
Mutter Nylon Pylon
- 14 - 14000070: Casting av D noir  
Rt frt corner cast black  
Vordereckgusst.rechts schwarz

## HC 16

### Traverse arrière/Rear Crossbar/Achterholm

16062501 : Traverse arrière Easy complète/Rear crossbar Easy complete/Achterholm Easy komplett

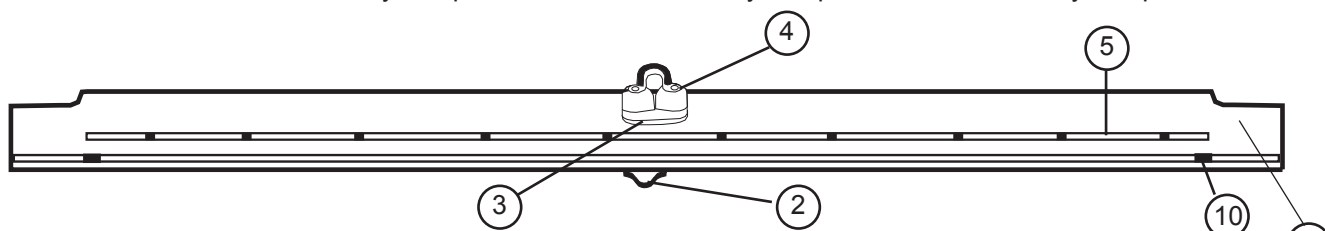

16062505 : Traverse arrière Club complète/Rear crossbar Club complete/Achterholm Klub komplett

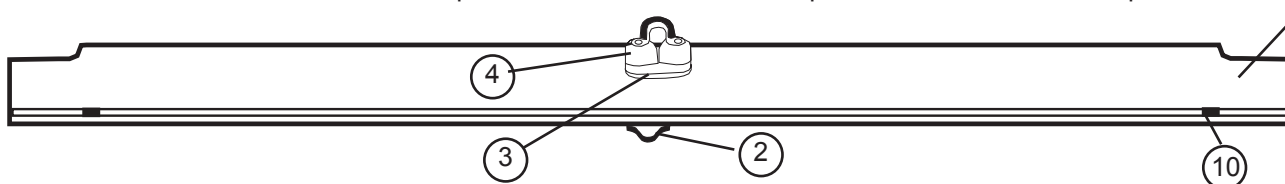

- |                     |  |
|---------------------|--|
| 1 - 16062630 :      | Traverse arrière droite nue rail intégré<br>Bare rear crossbar integrated rail<br>Achterholm roh mit integrierte Trav.-Schiene |
| 2 - 99220216 (x5) : | Pontet coque traverse<br>Pad-eye   |

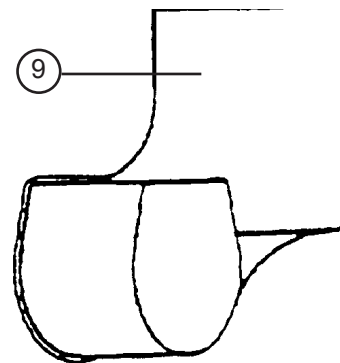
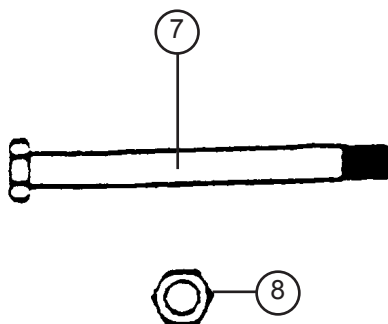
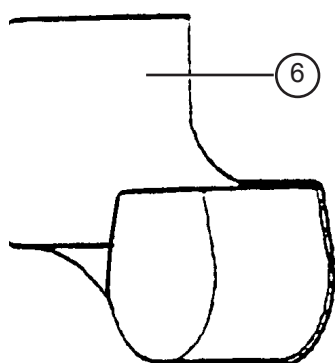

- |                |   |
|----------------|---|
| 3 - 99500900 : | Support tourelle<br>(x2)<br>Swivel cam cleat plate<br>Drehklemme-Platte                           |
| 4 - 99500354 : | Tourelle taquet carbon<br>Swivel cam cleat<br>Drehklemme  |
| 5 - 16062550 : | Rail d'écoute percé<br>Drilled traveller track<br>Travellerschiene gebohrt                        |
| 6 - 14000055 : | Casting arrière gauche percé<br>Left rear corn. casting drilled<br>Gussteil hinten links mit Loch |

- |                     |  |
|---------------------|--|
| 7 - 99220870 (x10): | Vis pylône<br>Pylon bolt<br>Schraube   |
| 8 - 99220610 (x10): | Ecrou nylon pylône<br>Pylon nut<br>Mutter Nylon Pylon  |
| 9 - 14000060 :      | Casting arrière droit percé<br>Right rear corn. casting drilled<br>Gussteil hinten rechts mit Loch |
| 10- 99056242 (x2) : | Embout Caoutchouc<br>Rubber stopper<br>Gummistopper  |

**HC 16**  
 Traverse arrière LE Race  
 Rear Crossbar LE Race  
 Achterholm LE Race  
 16062530

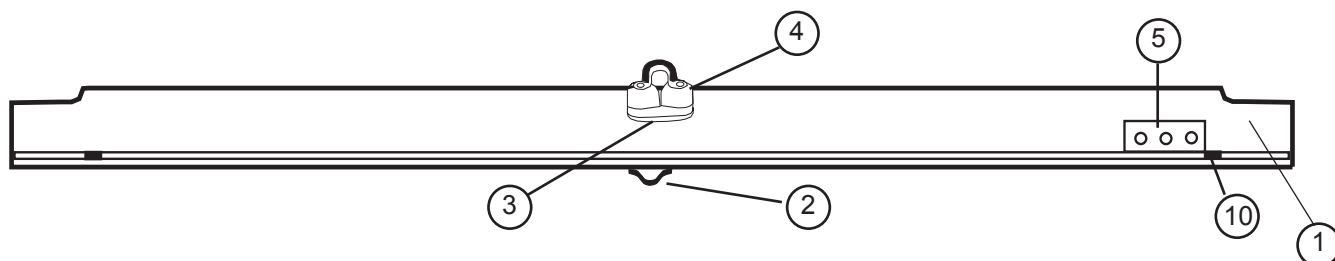

- |                     |   |
|---------------------|---|
| 1 - 16062630 :      | Traverse arrière droite complète rail intégré<br>Complete rear crossbar integrated rail<br>Achterholm Komp. mit integrierte Trav.-Schiene |
| 2 - 99220216 (x5) : | Pontet coque traverse<br>Pad-eye<br>Bügel   |

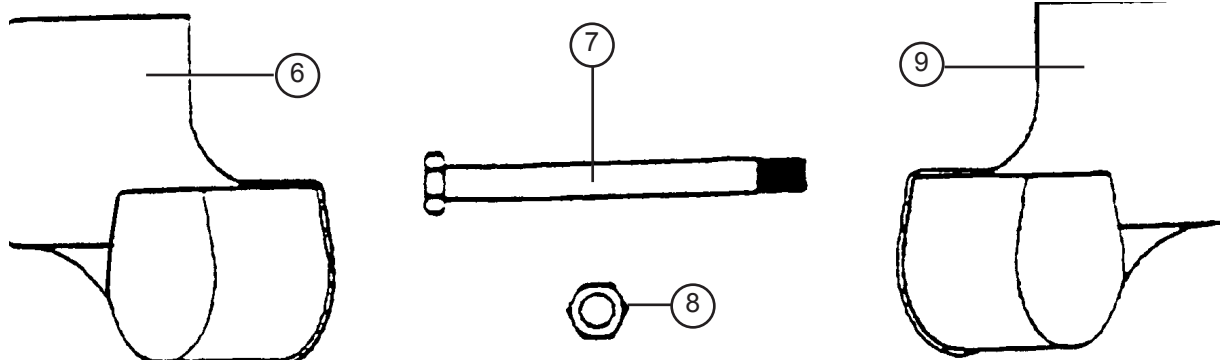

- |                |   |
|----------------|---|
| 3 - 99500900 : | Support tourelle<br>(x2)<br>Swivel cam cleat plate<br>Drehklemme-Platte                           |
| 4 - 99500354 : | Tourelle taquet carbon<br>Swivel cam cleat<br>Drehklemme  |
| 5 - 16062800 : | Plaque traverse pour chariot<br>Plate for traveller car<br>Platte für Traveller                   |
| 6 - 14000055 : | Casting arrière gauche percé<br>Left rear corn. casting drilled<br>Gussteil hinten links mit Loch |

- |                     |  |
|---------------------|--|
| 7 - 99220870 (x10): | Vis pylône<br>Pylon bolt<br>Schraube   |
| 8 - 99220610 (x10): | Ecrou nylon pylône<br>Pylon nut<br>Mutter Nylon Pylon  |
| 9 - 14000060 :      | Casting arrière droit percé<br>Right rear corn. casting drilled<br>Gussteil hinten rechts mit Loch |
| 10- 99056242 (x2) : | Embout Caoutchouc<br>Rubber stopper<br>Gummistopper  |

## HC 16 TRAMPOLIN/TRAMPOLINE/TRAMPOLINE

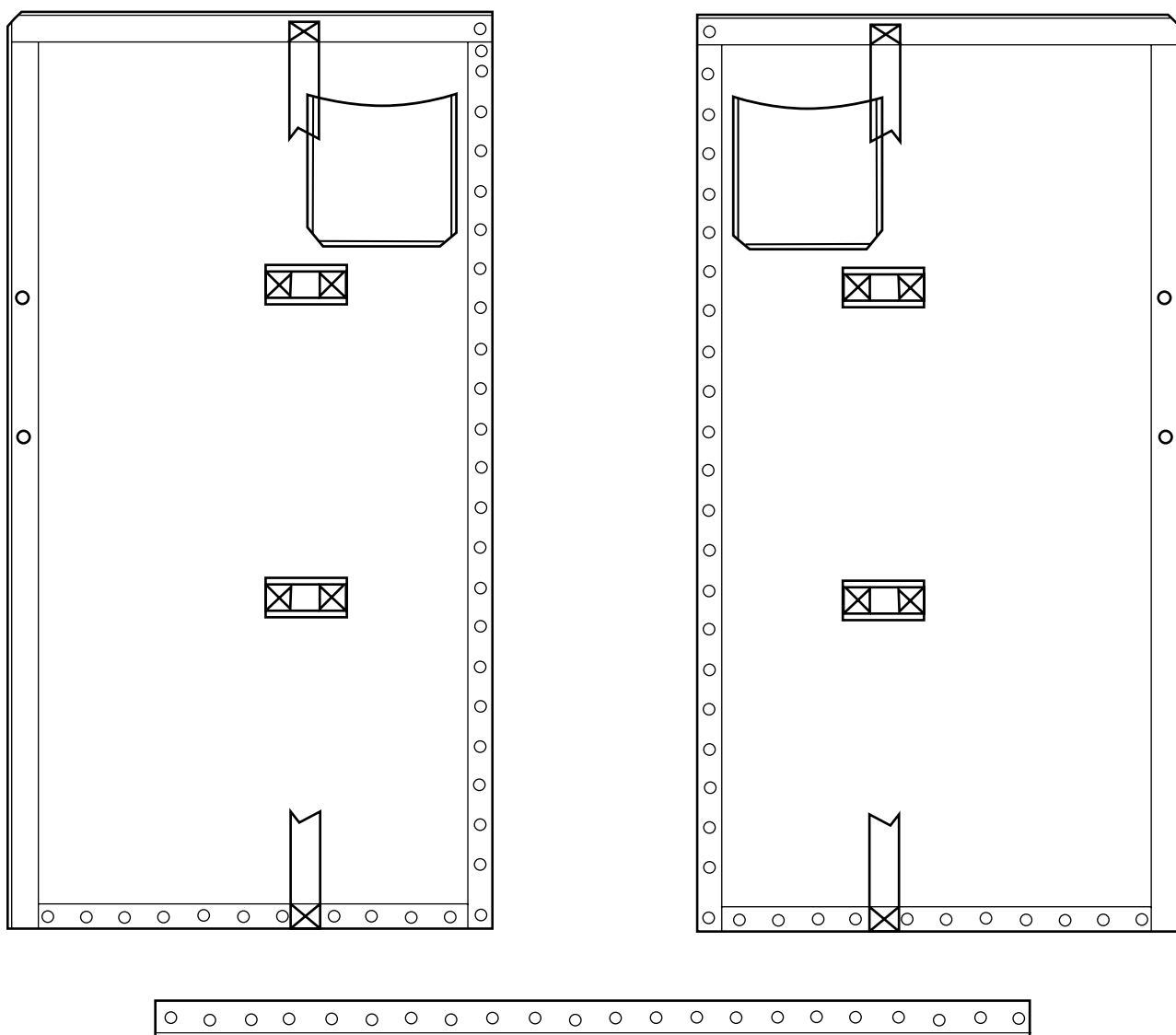

### TRAMPOLIN 3 PIECES/3 PIECE TRAMPOLINE/TRAMPOLIN 3TEILIG

16025005	blanc/white/weiss
16025205	Bleu/blue/blau
16025800	Mesh/Netz

2 - 16070430 : Lacet arrière/Rear trampoline line/Trampolinleine hinten

3 - 16070440 : Lacet central/Center trampoline line/Trampolinleine mitte

# **HC 16** Bôme/Boom/Baum Classic/Club

16012812 : BOME COMPLETE CLASSIC/CLUB  
BLACK BOOM ASSEMBLY CLASSIC/CLUB  
BAUM KOMPLETT SCHWARZ CLASSIC/

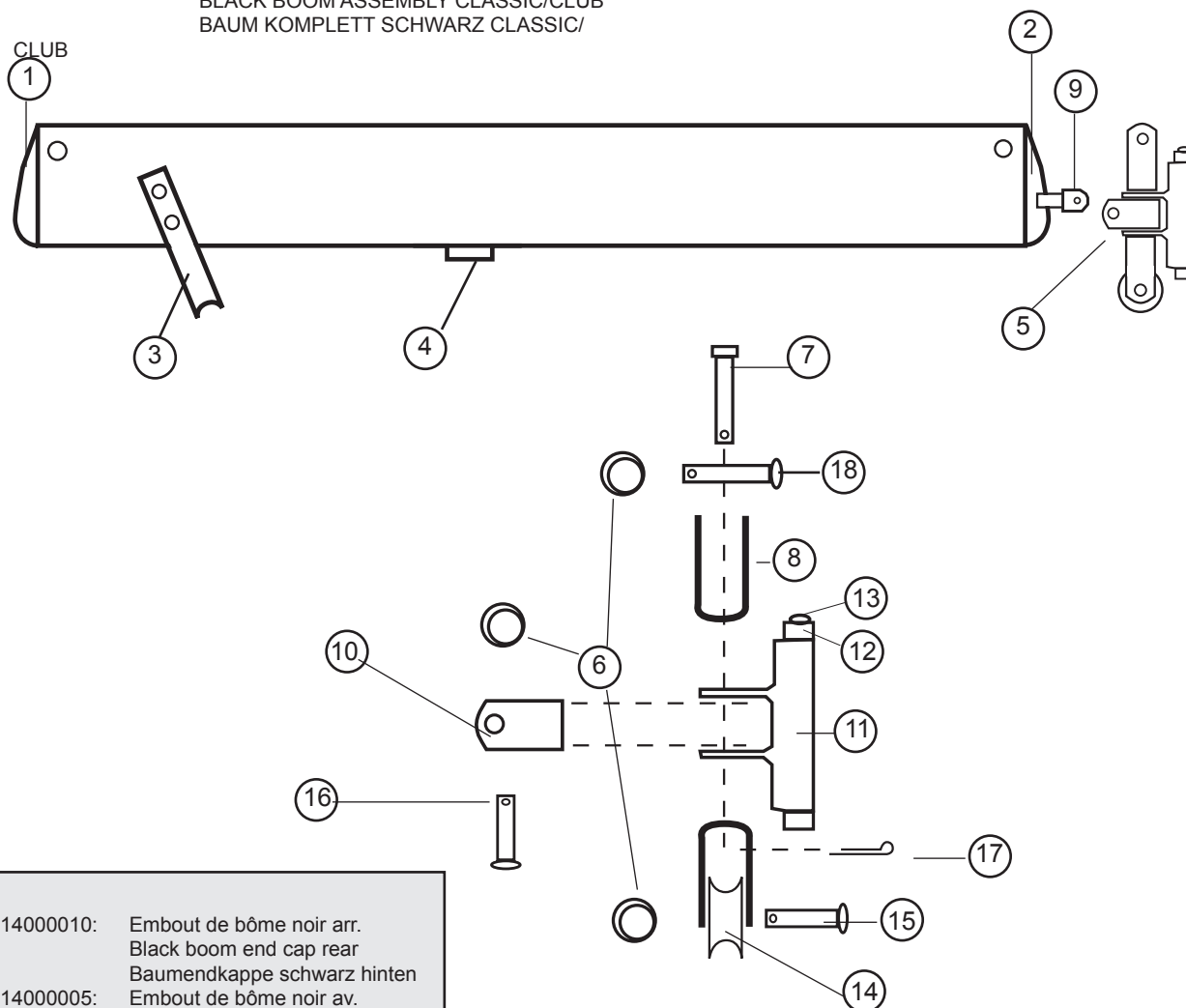

- |                      |  |
|----------------------|--|
| 1 - 14000010:        | Embout de bôme noir arr.<br>Black boom end cap rear<br>Baumendkappe schwarz hinten |
| 2 - 14000005:        | Embout de bôme noir av.<br>black boom end cap front<br>Baumendkappe gebohrt vorne  |
| 3 - 14011830:        | Collier de bôme<br>block hanger<br>Baumbeschlag                                    |
| 4 - 14011841:        | Conduit coinqueur bôme<br>Boom jam cleat<br>Klemme Baum                            |
| 5 - 16070355:        | Vit de mulet<br>Gooseneck<br>Lümmelbeschlag  |
| 6 - 99220230 (x10) : | Anneau brisé<br>Split ring<br>Ringsplint   |
| 7 - 14070354:        | Axe vert.vit mulet<br>Clevis pin<br>Bolzen f.Lümmelbeschlag                        |
| 8 - 14070353:        | Cosse vit mulet<br>Gooseneck thimble<br>Bügel f. Lümmelbeschlag                    |
| 9 - 14011820:        | Ancrage vit mulet<br>Gooseneck fastening<br>Baumstück f.Lümmelbeschlag             |
| 10 - 14070351:       | Charnière centrale vit mulet<br>Gooseneck hinge                                    |

- |                      |   |
|----------------------|---|
| 11 - 14070352:       | Mittelstück f.Lümmelbeschlag<br>Glissière vit mulet<br>Gooseneck slider<br>Gleiter Lümmelbeschlag |
| 12 - 16070391:       | Kit embout plastic<br>Endcap plastic bearing<br>Endstück Plastik Rutscher                         |
| 13 - 16070390:       | Vis TBC 4,8 x 80<br>Screw TBC 4,8 x80<br>Schraube TBC 4,8x80                                      |
| 14 - 16041700:       | Rea drisse GV<br>Main halyard sheave<br>Fall Rolle GS   |
| 15 - 99220602 (x5):  | Axe percé vit mulet<br>Clevis pin<br>Lümmelbeschlag Bolzen  |
| 16 - 99056230 (x10): | Axe percé latte ridoir<br>Clevis pin<br>Bolzen f. Locheisen                                       |
| 17 - 99056247 (x10): | Goupille vit mulet<br>Gooseneck cotter pin<br>Stift Lümmelbeschlag                                |
| 18 - 18060316 (x5) : | Axe de flèche<br>Spreader long pin  |

# **HC 16** Bôme/Boom/Baum RACE

16012810 : BOME COMPLETE RACE  
BLACK BOOM ASSEMBLY RACE  
BAUM KOMPLETT SCHWARZ RACE

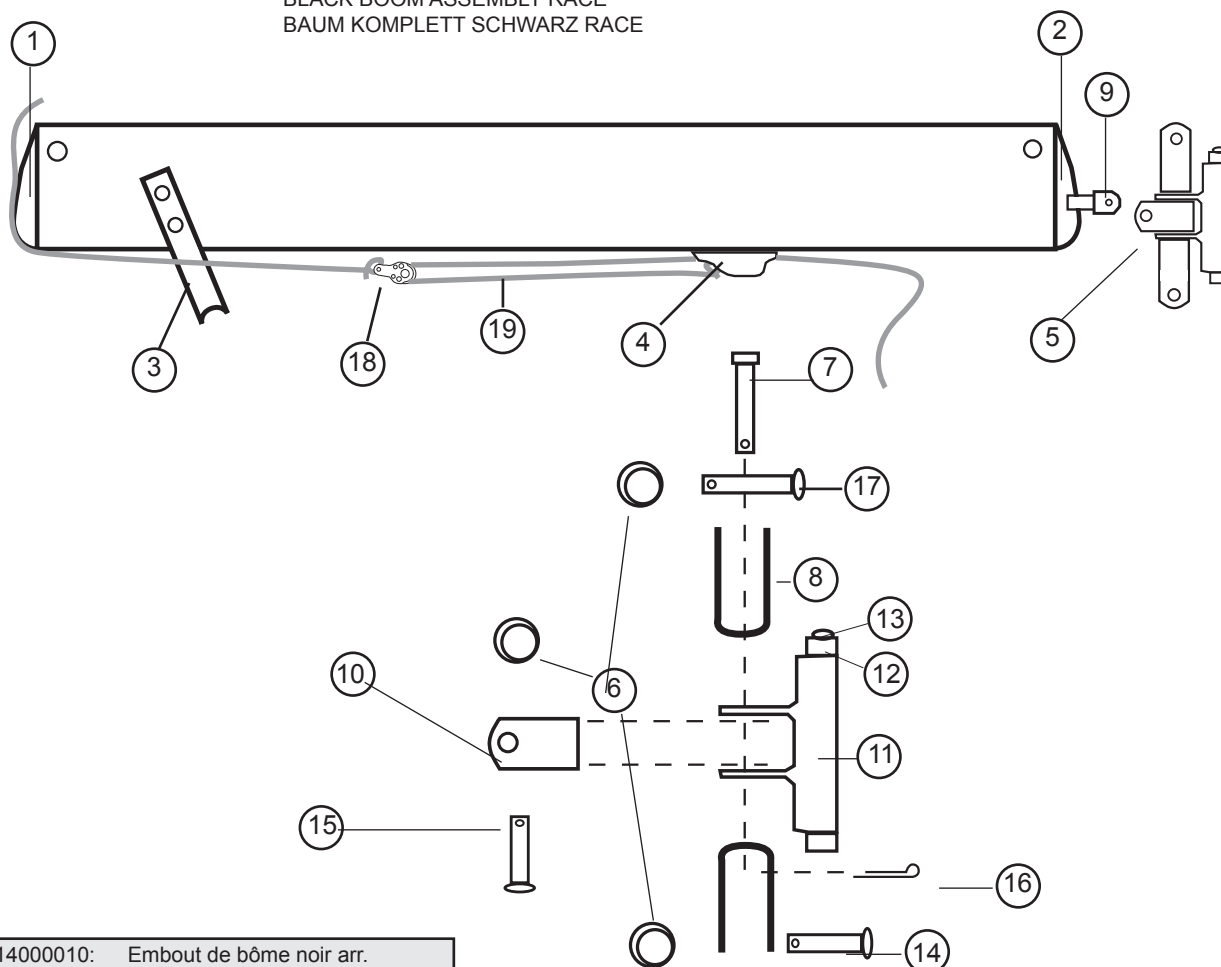

1 - 14000010:	Embout de bôme noir arr. Black boom end cap rear Baumendkappe schwarz hinten
2 - 14000005:	Embout de bôme noir av. black boom end cap front Baumendkappe gebohrt vorne
3 - 14011830:	Collier de bôme block hanger Baumbeschlag
4 - 99500540 :	Taquet coinqueur Boom jam cleat Baumklemme
5 - 16070355:	Vit de mulet Gooseneck Lümmelbeschlag
6 - 99220230 (x10) :	Anneau brisé Split ring Ringsplint
7 - 14070354:	Axe vert.vit mulet Clevis pin Bolzen f.Lümmelbeschlag
8 - 14070353:	Cosse vit mulet Gooseneck thimble Bügel f. Lümmelbeschlag
9 - 14011820:	Ancrage vit mulet Gooseneck fastening Baumstück f.Lümmelbeschlag
10 - 14070351:	Charnière centrale vit mulet Gooseneck hinge Mittelstück f.Lümmelbeschlag

11 - 14070352:	Glissière vit mulet Gooseneck slider Gleiter Lümmelbeschlag
12 - 16070391:	Kit embout plastic Endcap plastic bearing Endstück Plastik Rutscher
13 - 16070390:	Vis TBC 4,8 x 80 Screw TBC 4,8x80 Schraube TBC 4,8x80
14 - 99220602 (x5):	Axe percé vit mulet Clevis pin Lümmelbeschlag Bolzen
15 - 99056230 (x10):	Axe percé latte ridoir Clevis pin Bolzen f. Locheisen
16 - 99056247 (x10):	Goupille vit mulet Gooseneck cotter pin Stift Lümmelbeschlag
17 - 18060316 (x5) :	Axe de flèche Spreader long pin Salingachse lang
18 - 99501540 :	kit poulies halebas block kit Block-Kit
19 - 99300620:	Cordage D6 Line D6 Leine D6



# HC 16

## Grand-voile & lattes/Main sail & battens

## Gross-Segel & Latten

Pour les couleurs, voir tarif  
For colors see price list  
Farben: siehe Preisliste

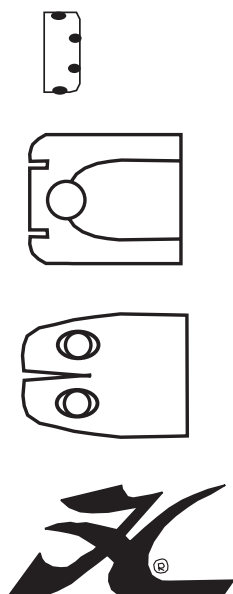

99504010: Demi-butée latte GV  
Batten pocket protector  
Halb Anschlag GS-Latte

99500600 (x10): Embout latter GV std  
Batten tip std  
Lattenkappe std

99500650 (x10): Embout latte GV LE  
Batten tip LE  
Lattenkappe LE

99267286: Autocollant "H" noir  
Black "H" sticker  
Aufkleber "H"schwarz

### Jeu de lattes / Batten set / Lattensatz

16034010 (std):  
16034030 (LE) :  
16034050(Easy)

Latte n°	Std	LE	Easy
9			16034088
8	16034018	16034038	16034087
7	16034017	16034037	16034086
6	16034016	16034036	16034085
5	16034015	16034035	16034084
4	16034014	16034034	16034083
3	16034013	16034033	16034082
2	16034012	16034032	16034081
1	16034011	16034031	16034080

(lattes + embout/Batten + cap/Latte + Endstück)

16080230 : Kit Cunningham de GV / Main cunningham

99501530 : Kit poulies Block kit Block-Kit	18061605 : Anneau Brisé Split ring Ringsplint
18061611 : plaque SSI SSI plate SSI-Platte	99220036 : Manille lyre D4 Shackle D4 Schäkel D4
18061604 : Axe SSI SSI pin Bolzen	

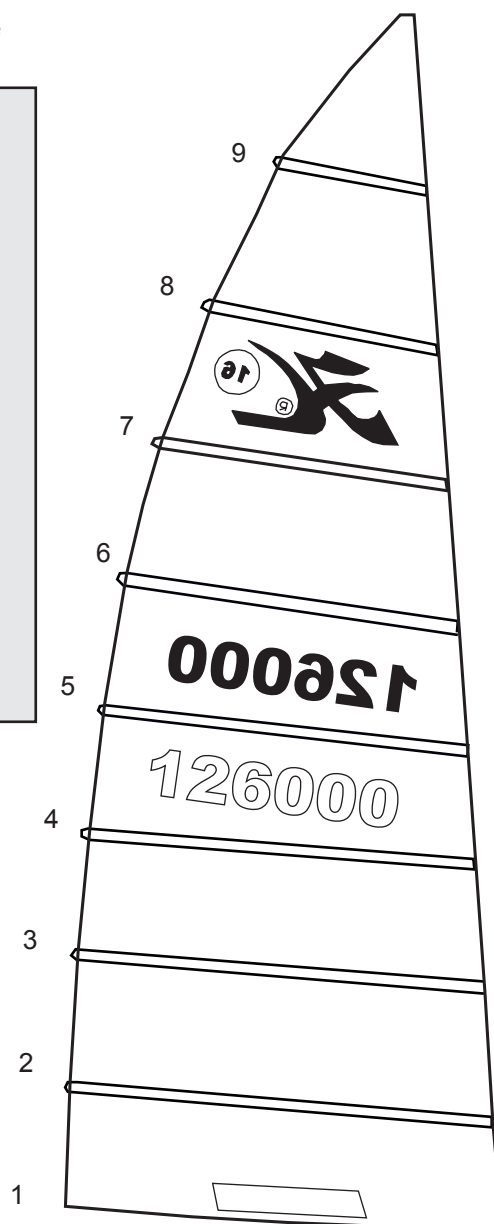

## HC 16

### Foc & lattes/Jib & battens/Fock & Latten

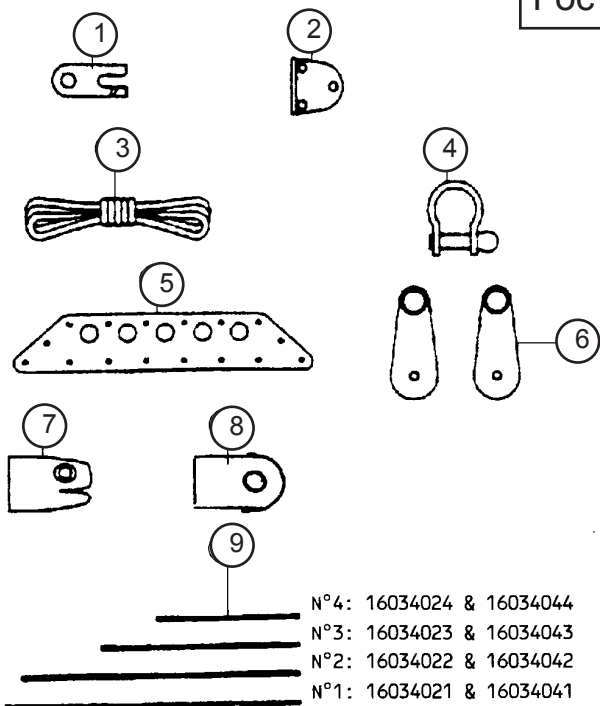

- 1 - 16504120: Crochet bague de foc  
Jib ring hook  
Fock Stagreiter
- 2 - 99504011: Demi-butée latte foc  
batten pocket protector  
Halb Anschlag Focklatte
- 3 - 16070470: Ecoute de foc  
Jib sheet  
Fockschot

- 4 - 99220660 (x10): Manille lyre 4 mm  
Shackle  
Mastschäkel
- 5 - 16080005: Kit platine alu de foc  
Jib clew plate  
Foc Trimm Kit
- 6 - 16080351: Poulie pt d'écoute de foc  
Jib clew block  
Fockumlenkblock
- 7 - 99500660 (x10): Embout latte foc LE  
Jib batten tip LE  
Fock Lattenkappe LE
- 8 - 99500610 (x10): Embout latte foc std  
Jib batten tip std  
Fock Lattenkappe std
- 9 - 16034020 (std): Jeu de lattes de foc  
16034040 (le): Jib batten set  
Lattensatz
- 10- 99300058 (x10): Cosse std  
Thimble  
Kausch std
- 11- 99300126 (x10): Manchon D 2,5  
Sleeve  
Hülse

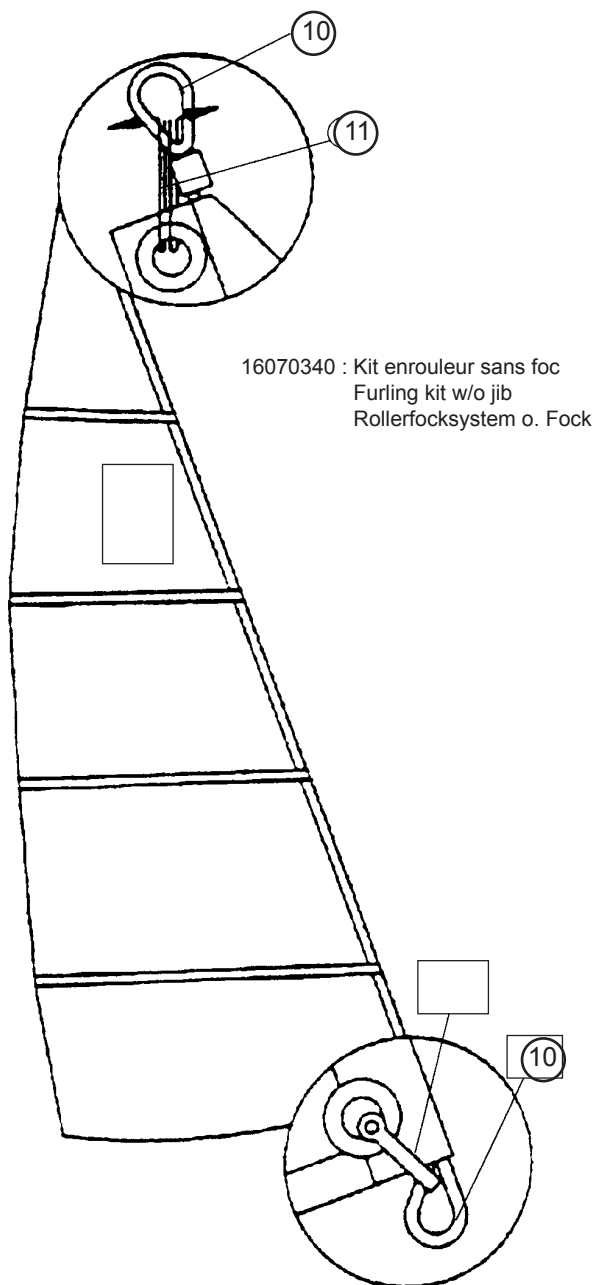

### 16080310 : CCT STD (obsolete)

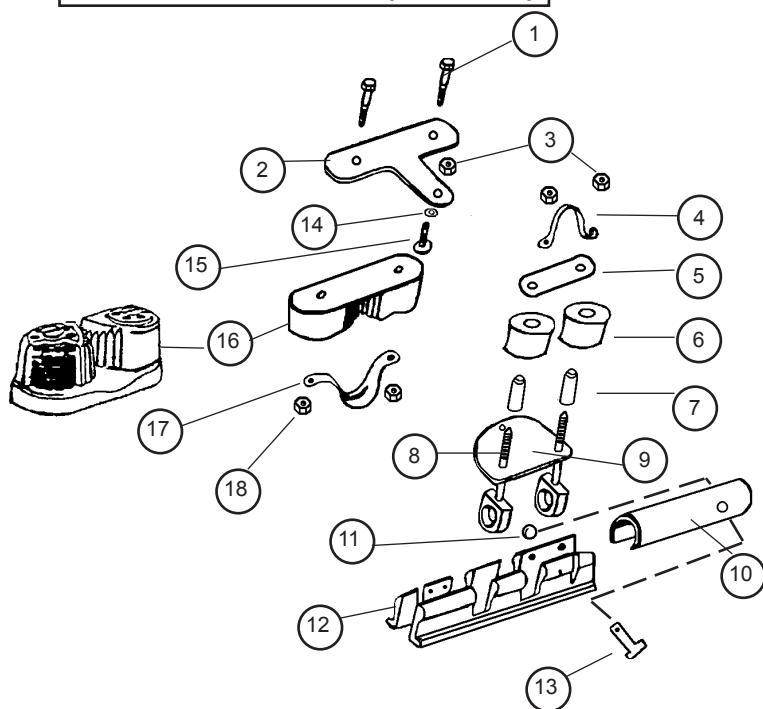

- 7 - 99220615 (x2): Entretoise CCT  
Stainless bushing  
Querriegel CCT
- 8 - 99220024: Vis violon  
Violon screw  
Bügelschraube CCT
- 9 - 14070321: Platine fixe  
Car sub plate  
Platte CCT
- 10 - 14070358 (x5): Axe Tube CCT  
Axe tube CCT  
Röhre f. Bolzen CCT
- 11 - 99220230 (x10): Anneau brisé  
Split ring  
Ringsplint
- 12 - 14070367 (x10): Demi-glissière  
half slide  
Halber Gleiter
- 13 - 99220602 (x5): Axe percé vit mulet  
Clevis pin  
Lümmelbeschlag Bolzen
- 14 - 99220755 (x10): Rondelle Teflon  
Teflon washer  
Unterlegscheibe Teflon
- 15 - 99056264 (x10): Vis Trl poelier art.  
Swing arm pivot screw  
Gelenkschraube CCT
- 16 - 99500905 (x5): Taquet à bille  
Cam cleat  
Kugelklemme
- 17 - 14070325 (x10): Pontet CCT  
Pad-eye CCT  
Bügel CCT
- 18 - 99056237 (x10): Ecou ind. Taquet  
Nylstop Nut  
Selbstsichernde Mutter

### HC16 CCT Standard & LE

- 1 - 99220900(x10): Vis taquet coinqueur  
Screw  
Schraube für Klemme
- 2 - 14070316: Platine articulée  
Deck plate  
Bewegliche Platte
- 3 - 99056238 (x10): Ecou indessérable 6  
Nylstop nut 6  
Selbstsichernde Mutter 6
- 4 - 14070325 (x10): Pontet CCT  
Pad-eye  
Bügel
- 5 - 14070322: Platine support réa  
Sheave plate  
Platte Hinten CCT Rolle
- 6 - 14070111: Réa nylon  
Nylon sheave  
Rolle nylon

### 16080311 : CCT LE

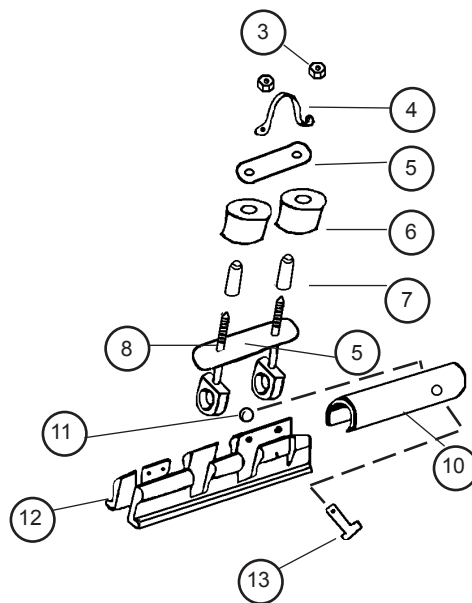

### 99501524 : SSI (HC 16 Race et LE Race)

- 18061604 - axe épaule SSI/Pin SSI/Achse SSI
- 18061605 - anneau brisé SSI/Split ring/Ringsplint

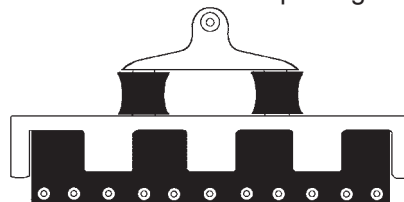

99501529 : Glissière / Slide

## HC16

### Poulies/Blocks/Blöcke

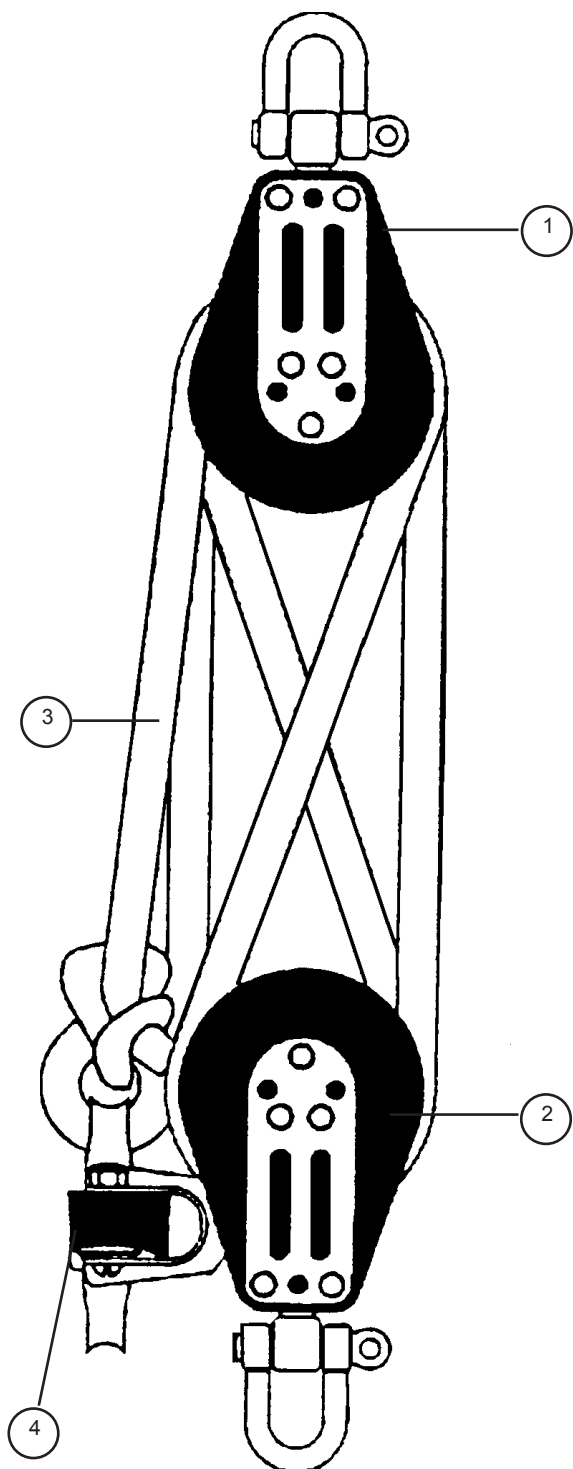

- |                             |   |
|-----------------------------|---|
| 1 - 99500129:<br>(LE/Race)  | Poulie Harken triple<br>Harken triple upper block<br>Dreifacher Block Harken                      |
| - 16080353:<br>(Std, Easy)  | Poulie triple Sailspeed<br>Sailspeed upper block<br>Dreifacher Block Sailspeed                    |
| 2 - 99501010:<br>(LE/Race)  | Poulie Harken triple av. taquet<br>Harken triple block with cleat<br>Dreifacher Knarrblock Harken |
| 14070323 :                  | Taquet/Cleat/Klemme   |
| - 16080370:<br>(std & Easy) | Poulie triple Sailspeed<br>Sailspeed triple block<br>Dreifacher Knarrblock Sailspeed              |
| 3 - 16070420:               | Cordage grand voile<br>Mainsheet<br>Großschot   |
| 4 - 99500910 (x5):          | Taquet Sailspeed<br>Sailspeed cleat<br>Klemme Sailspeed   |
| - 99500349:                 | Taquet Harken H150<br>Harken cleat H 150<br>Klemme Harken H 150                                   |

#### **NB :**

les poulies triples Harken et Sailspeed sont livrées avec manille.  
Harken and Sailspeed threefold blocks are delivered with shackle.  
Harken und Sailspeed dreifacher Block sind mit Schäkel geliefert

<p align="center"><b>Hobie Cat 16</b>  <b>Kit up-grade complet 2005/Complete up-grade kit 2005</b>  <b>16080200</b></p>
---

**Cunningham de foc/Jib cunningham**  
**16080220**

- 99500126 : Poulie plate  
Cheek block  
Block
- 99500349 : Taquet  
Cleat  
Klemme
- 99501550 : Poulie plate  
Cheek block  
Block

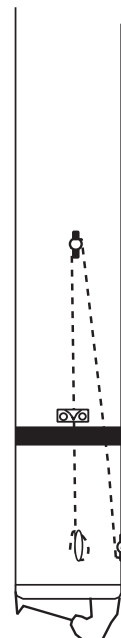

**Kit Bome/Boom Kit/ Baum-Kit**  
**16080210**

- 99500540 : Taquet coinreur  
Boom jam cleat  
Baumklemme
- 99501540 : kit poulies halebas  
block kit  
Block-Kit
- 99300620: Cordage D6  
Line D6  
Leine D6

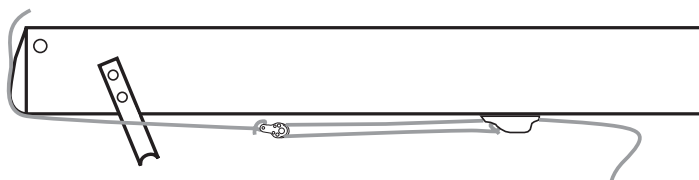

**Kit Cunningham de GV / Main cunningham**  
**16080230**

- 99501530 : Kit poulies  
Block kit  
Block-Kit
- 18061611 : plaque SSI  
SSI plate  
SSI-Platte
- 18061604 : Axe SSI  
SSI pin  
Bolzen



# Hobie Cat 16

## Tangon de spi/spi pole/Spibaum

**16062635 : Système classique / Classical system / Classisches System**

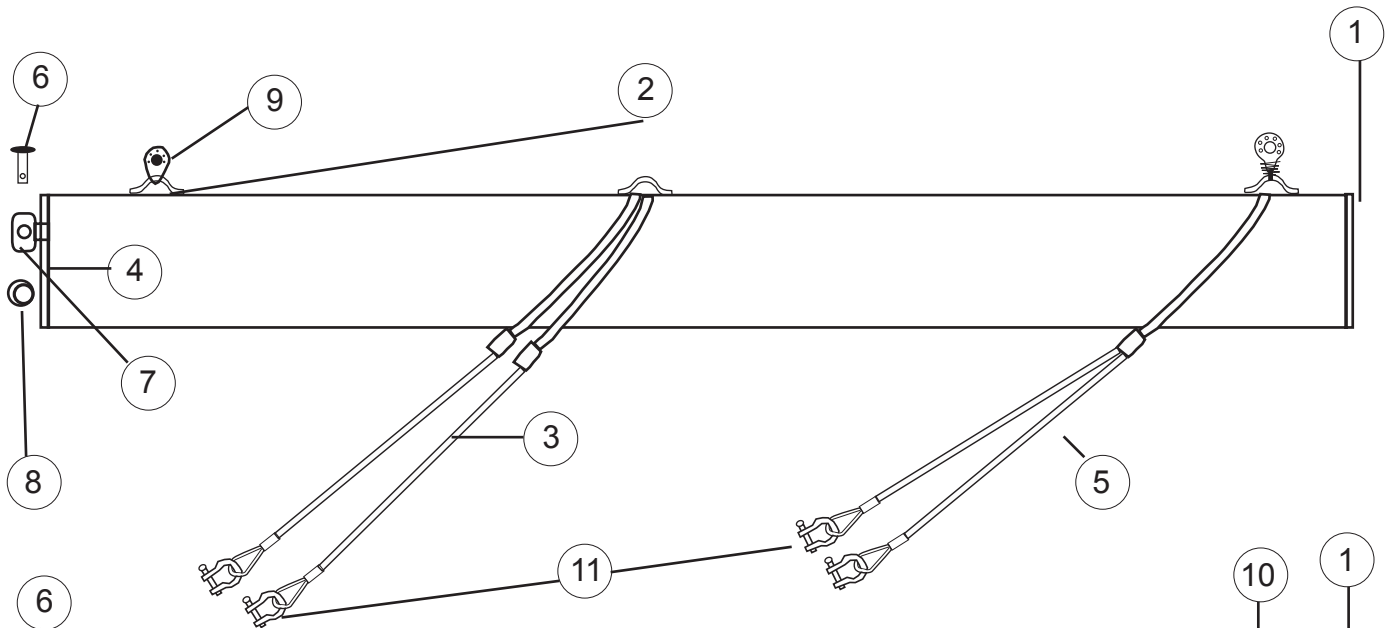

**16062645 : Système trompette/Trumpet system**

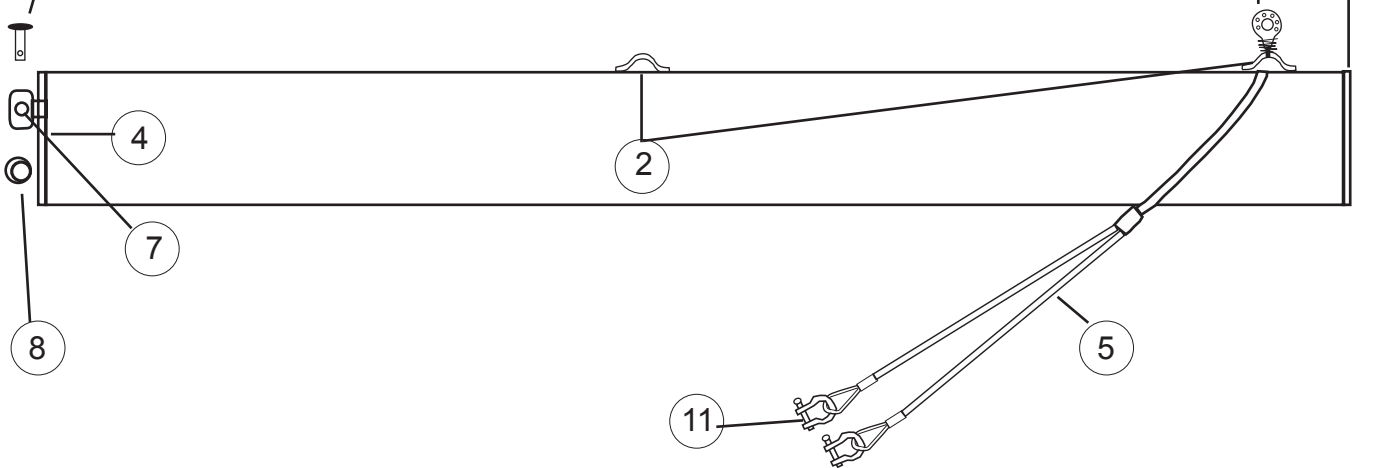

Hobie Cat 16 : Eclaté de pièces détachées / Illustrated part guide/Explosionszeichnung (2007)

1 - 99220208 (x5) :	Bouchon à ailette End cap Endstück
2 - 99220057 :	Pontet forgé D5 Pad-eye Guseisenbeschlag
3 - 16080585 :	Bride cunningham tangon Cunningham tangon Cunningham Spibaum
4 - 17569000 :	Embout bôme percé Boom end cap drilled Baumendstück gebohrt
5 - 15080555 :	Bride tangon classique Bridle classical pole Spibaum-Hanepot classisch
16080580 (av 2000)	
16080582 :	Bride tangon trompette Spi pole bridle trumpet Spibaum-Hanepot Trumpet

6 - 14061245 :	Axe barre Connection pin Bolzen
7 - 18061320 :	Chape d'articulation tangon Spi pole connection toggle Verbindungswirbel Spibaum
8 - 99220230 (x10) :	Anneau brisé Split ring Offener Ring
9 - 17070150 :	Poulie étarquage simple Single block Einfach Block
10 - 99500735 :	Poulie avec ressort et pontet Block w/ spring and pad-eye Block mit Splint und Bügel
11 - 99220660 (x10) :	Manille lyre 4 mm Shackle 4 mm Schäkel 4 mm

- 16070320 : Accastillage spi + cordage  
Complete spinnaker rig + ropes  
Spitakelage mit Leinen
- 16070040 : Sac cordages Spinnaker  
Spi rope bag  
Spileinetasche
- 16032020 : Spinnaker blanc  
White Spinnaker  
Spinnaker weiss
- 16032050 : Spinnaker jaune étoile rouge  
Spinnaker yellow red star

## Hobie Cat 16

### Kit de spi Classique/Classical spi kit

- 1 - 16062635 : Tangon de spi  
Spi pole  
Spibaum
- 2 - 15080555 : Bride tangon HC15/16  
Spi pole bridle HC15/16  
Hahnepot Spibaum

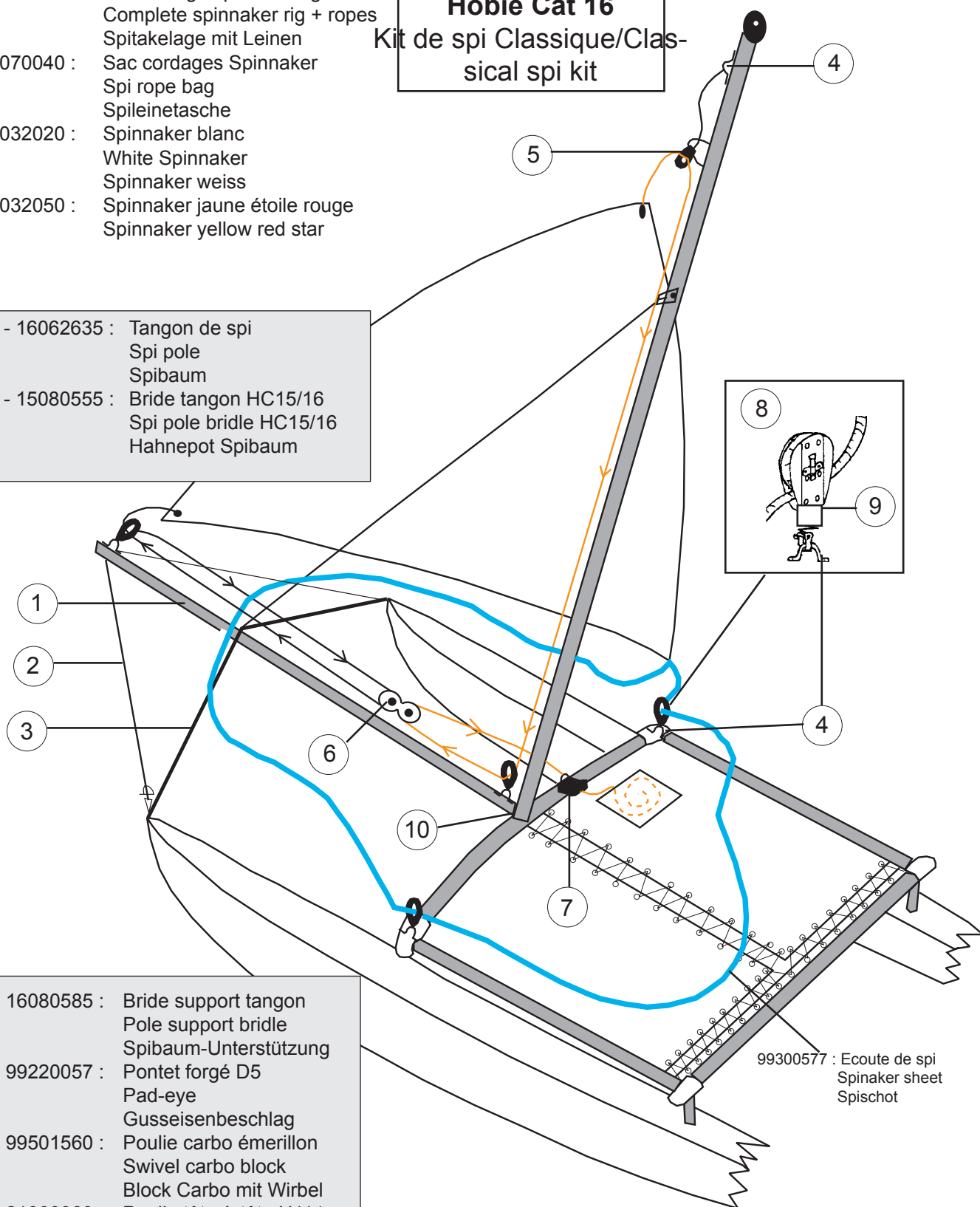

99300577 : Ecoute de spi  
Spinnaker sheet  
Spischot

- 3 - 16080585 : Bride support tangon  
Pole support bridle  
Spibaum-Unterstützung
- 4 - 99220057 : Pontet forgé D5  
Pad-eye  
Gusseisenbeschlag
- 5 - 99501560 : Poulie carbo émerillon  
Swivel carbo block  
Block Carbo mit Wirbel
- 6 - 21060060 : Poulie tête-à-tête H114  
Spi block H114  
Block spi H114
- 7 - 99500349 : Taquet Cam Matic  
Cam Cleat  
Klemme
- 8 - 99500117 : Poulie winch  
Ratchet block  
Knarr-Block

- 9 - 99500755 : Ressort plastique poulie  
Plastic block spring  
Plastik Block-Feder
- 10 - 16056025 : Articulation tangon  
Spi pole connection  
Verbindung Spibaum



# Hobie Cat 16

## Kit de spi trompette soft/Spi kit trumpet soft

### K AVS 16 -(sans spi/without spi/ohne spi)

- 16070330 : Accastillage spi 16 trompette + cordages  
16 Trumpet spi kit + lines  
16 Trumpet Spi-Kit + Leine
- 16032070 : Spi trompette blanc  
Spi trumpet white  
Spi Trumpet weiss
- 16032075 : Spi trompette jaune  
Spi trumpet yellow  
Spi Trumpet Gelb

- 1 - 16062645 : Targon de spi trompette  
Trumpet Spi pole  
Spibaum Trumpet
- 2 - 16080582 : Bride targon HC16 trompette  
Spi pole bridle HC16 trumpet  
Hahnepot Spibaum HC16 Trumpet

Spi Trompette/Trumpet spi  
16032085 = rouge/red/rot  
16032090 = violet/purple  
16032110 = bleu/blue/blau  
16032100 = vert/green/grün  
16032105 = orange

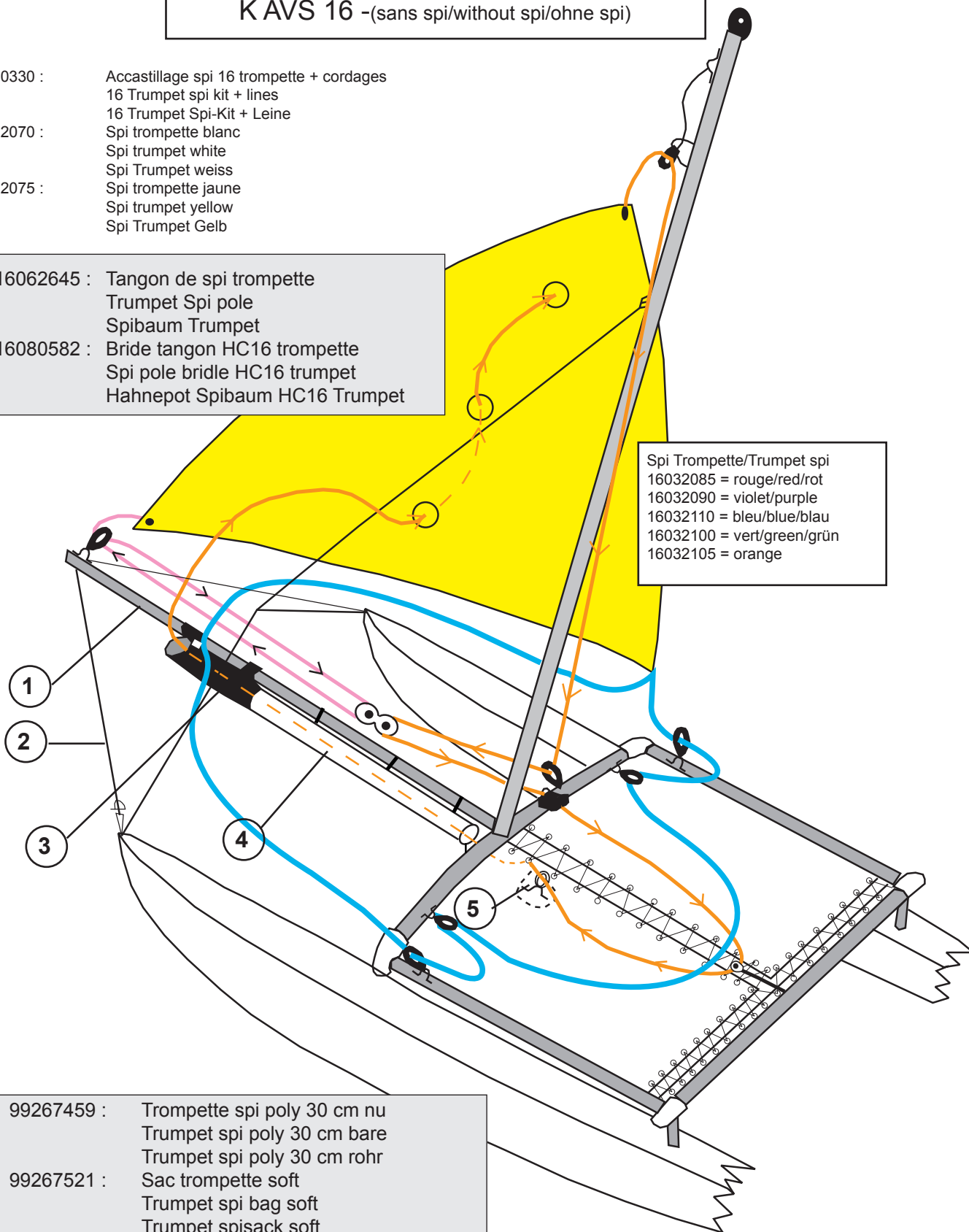

- 3 - 99267459 : Trompette spi poly 30 cm nu  
Trumpet spi poly 30 cm bare  
Trumpet spi poly 30 cm rohr
- 4 - 99267521 : Sac trompette soft  
Trumpet spi bag soft  
Trumpet spisack soft
- 5 - 16070335 : Accastillage trampolin spi trompette  
Trampoline spi rig trumpet  
Trampoline-Kleinteile Trumpet Spi