

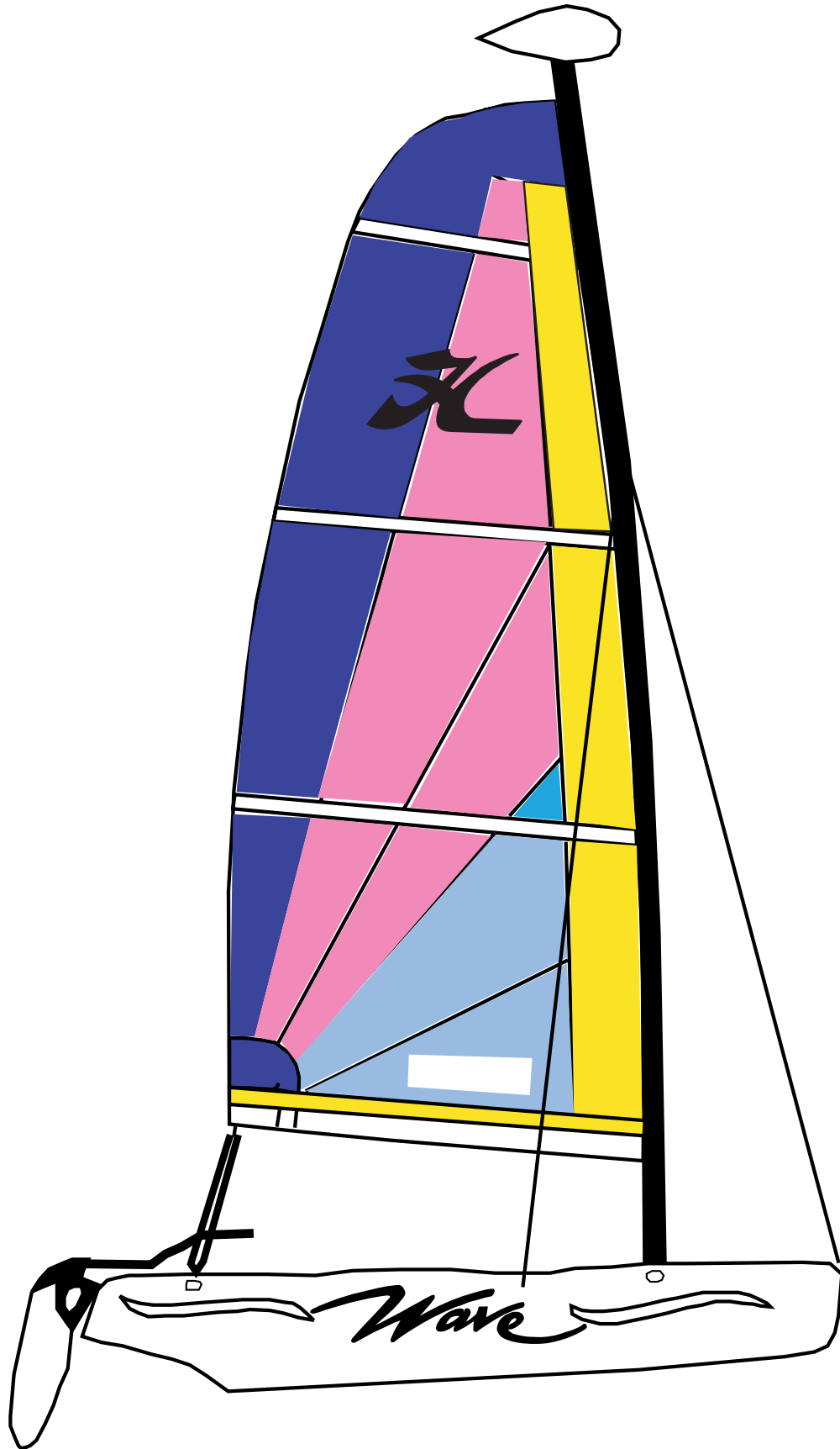

WAVE

Eclaté des pièces détachées

Illustrated Part Guide - Explosionszeichnung



# HC WAVE Club

## Coque/Hull/Rumpf

### Coque complète/Complete hull/Rumpf komplett

99056122 : Gauche/Left/Links

99056121 : Droite/Right/Rechts

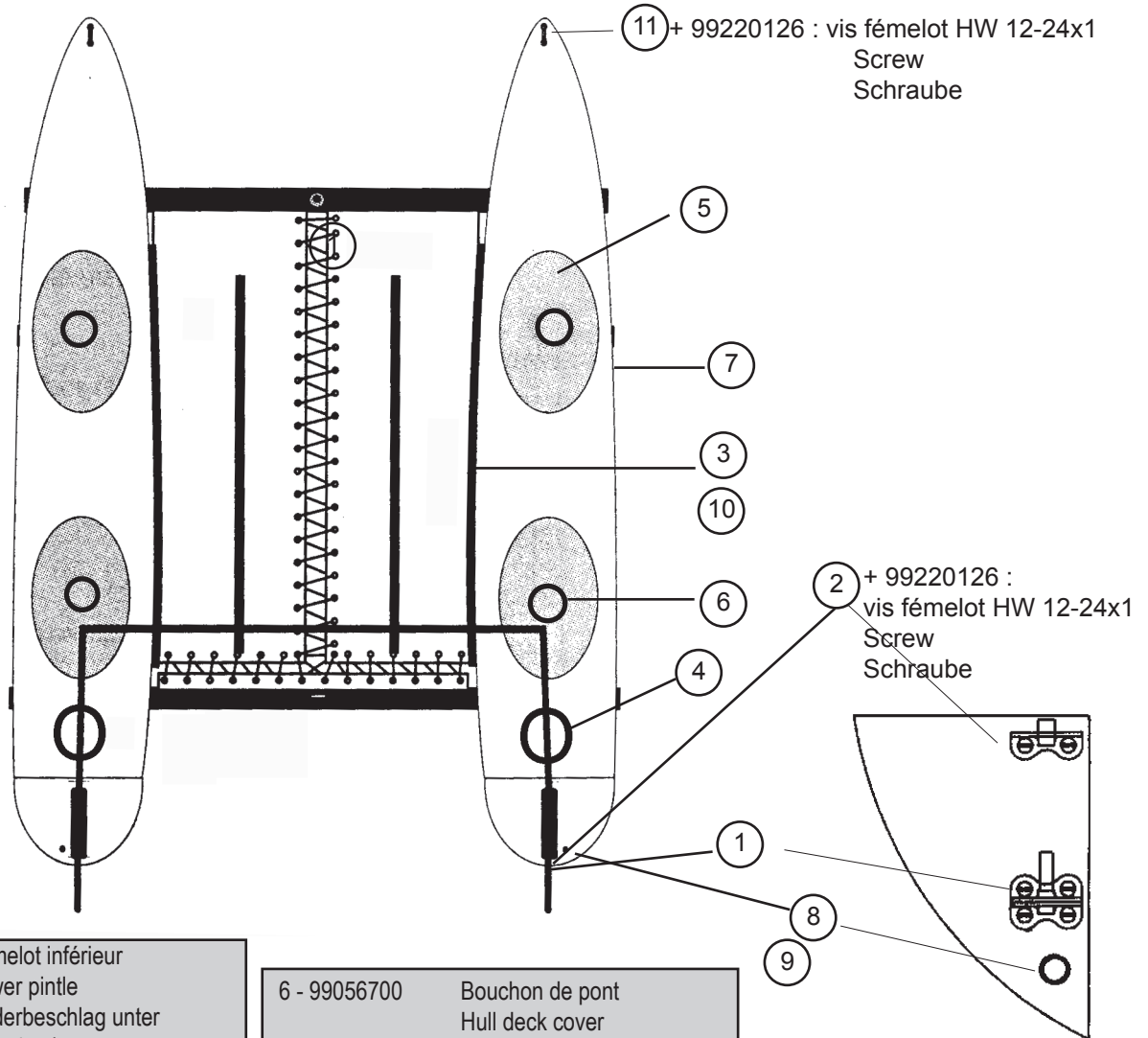

1 - 99056047 (2007)	Fémelot inférieur Lower pintle Ruderbeschlag unter
99061710 (2008)	Fémelot 4 trous Pintle 4 screws Ruderbeschlag 4 Schraube
2 - 99056048 (2007)	Fémelot supérieur Upper pintle Ruderbeschlag ober
99061705 (2008)	Fémelot 2 trous Pintle 2 screws Ruderbeschlag 2 Schraube
3 - 99056049	Rail de trampolin Trampoline track Trampolineschiene
4 - 18056033	Trappe de visite Inspection port cover Luckendeckel
5 - 99056705	Tapis antidérapant Seat pad Sukzbatte

6 - 99056700	Bouchon de pont Hull deck cover
7 - 99061400	Cadène de hauban Chain plate Putting
8 - 99220040 PKG 10	Bouchon de vidange Drain plug Ablafschraube
9 - 99220041 PKG 10	Joint Gasket Dichtung
10 - 99220114	Vis rail de trampolin Screw trampoline track Schraube Trampolineschiene
11 - 14070323 PKG 10	Pontet Eyestraps Bügel

# HC WAVE Club

## Gouvernail/Rudder assembly/Ruderbeschlag

Gouvernail complet/Rudder assembly complete/  
Ruderbeschlag komplett :

Droite/Right/Rechts = 99062115

Gauche/Left/Links = 99062110

2007

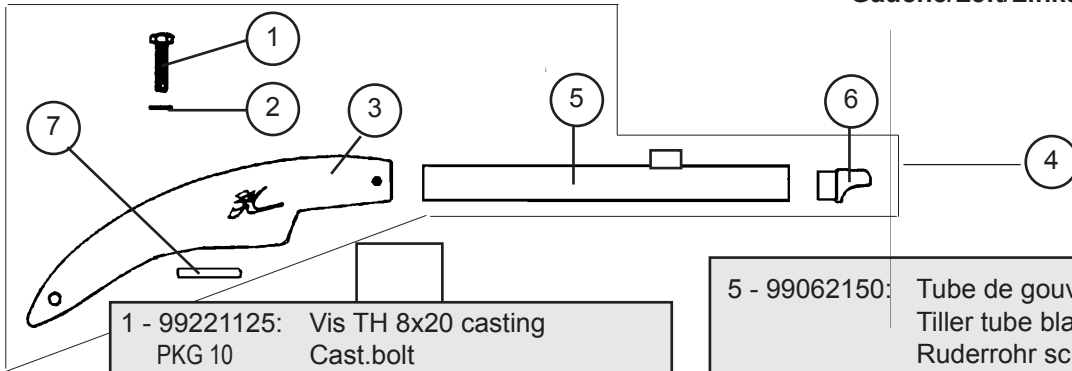

- 1 - 99221125: Vis TH 8x20 casting  
PKG 10  
Cast.bolt  
Schraube Gußteil
- 2 - 99061110: Rondelle plate D8  
PKG 10  
Washer D8  
Unterlegscheibe D8
- 3 - 17000010: Casting supérieur gouv.  
Upper rudder casting  
Oberes Rudergehäuse
- 4 - 99062121: Bras gouv.droit complet  
Tiller arm right complete  
Ruderarm rechts komplett
- 99062120: Bras gouv.gauche complet  
Tiller arm left complete  
Ruderarm links komplett

- 5 - 99062150: Tube de gouvernail nu noir  
Tiller tube black bare  
Ruderrohr schwarz
- 6 - 99000005 : Embout à rotule  
Tiller end cap  
Ruderarmendstück
- 7 - 14061122: Platine dural  
Cam stop plate  
Platine f. oberes Rudergehäuse
- 8 - 14061180 : Came safran  
PKG 10  
Plastic cam  
Rudernock
- 9 - 16041755: Goupille élastique  
PKG 10  
Maststep pin  
Sprengbolzen

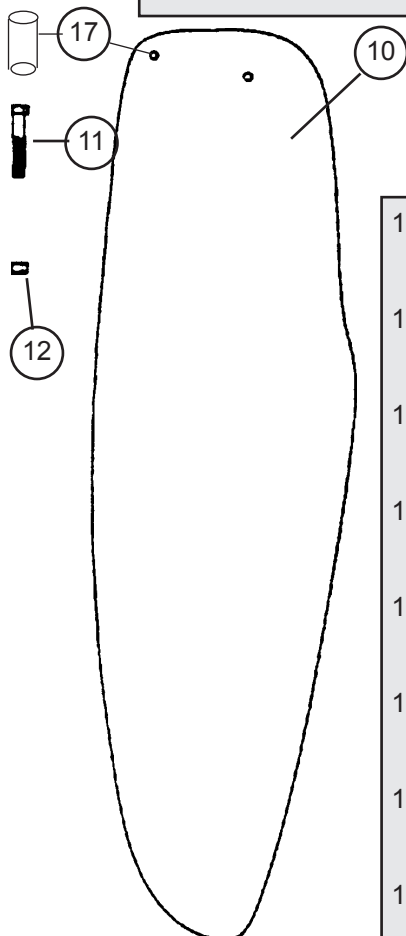

- 10 - 18062180 : Lame safran Lexan  
Ruder blade Lexan  
Ruderblatt Lexan
- 11- 99220150: Vis safran TH 8x55  
PKG 10  
Rudder bolt  
Schraube Ruderblatt
- 12- 99220012: Ecrou indessérable D8  
PKG 10  
Nylstop nut  
Selbstsichernde Mutter
- 13- 18000155: Casting inf. gouv  
Lower rudder casting  
Unteres Rudergehäuse
- 14- 14061105: Pene safran  
PKG 10  
Plunger  
Gegenstück Rudernock
- 15- 99220004: Ressort inox  
PKG 10  
Spring  
Feder
- 16- 99220006: Vis safran delrin  
PKG 10  
Tension screw  
Delrinschraube
- 17- 99502160: Insert lame de safran  
Sheave pin rudder blade  
Bolzen Ruderblatt
- 18- 17062680 : Casting inf. gouv. monté  
Lower rudder cast. assembly  
Unteres Rudergehäuse montiert

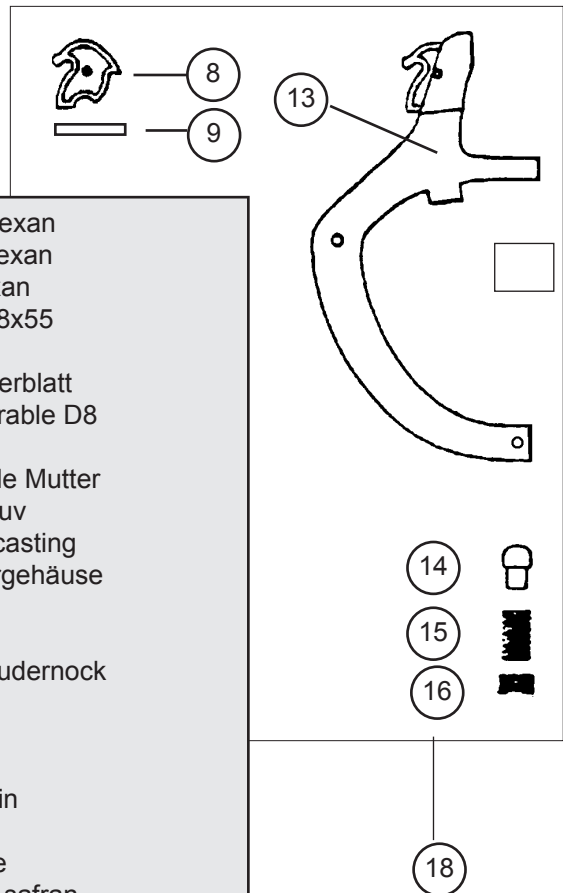

**HC WAVE Club**  
Gouvernail/Rudder assembly/Ruderbeschlag  
**99062112**

**2008**

12501395 :  
Kit embout gouvernail wave 2008 1 bateau  
Kit end cap rudder assy wave 20908 1 boat  
Kit Endstück Ruderanlage wave 2008 1 Boot

99980100 :  
Casting Easy Lock plastique  
Casting Easy Lock plastic

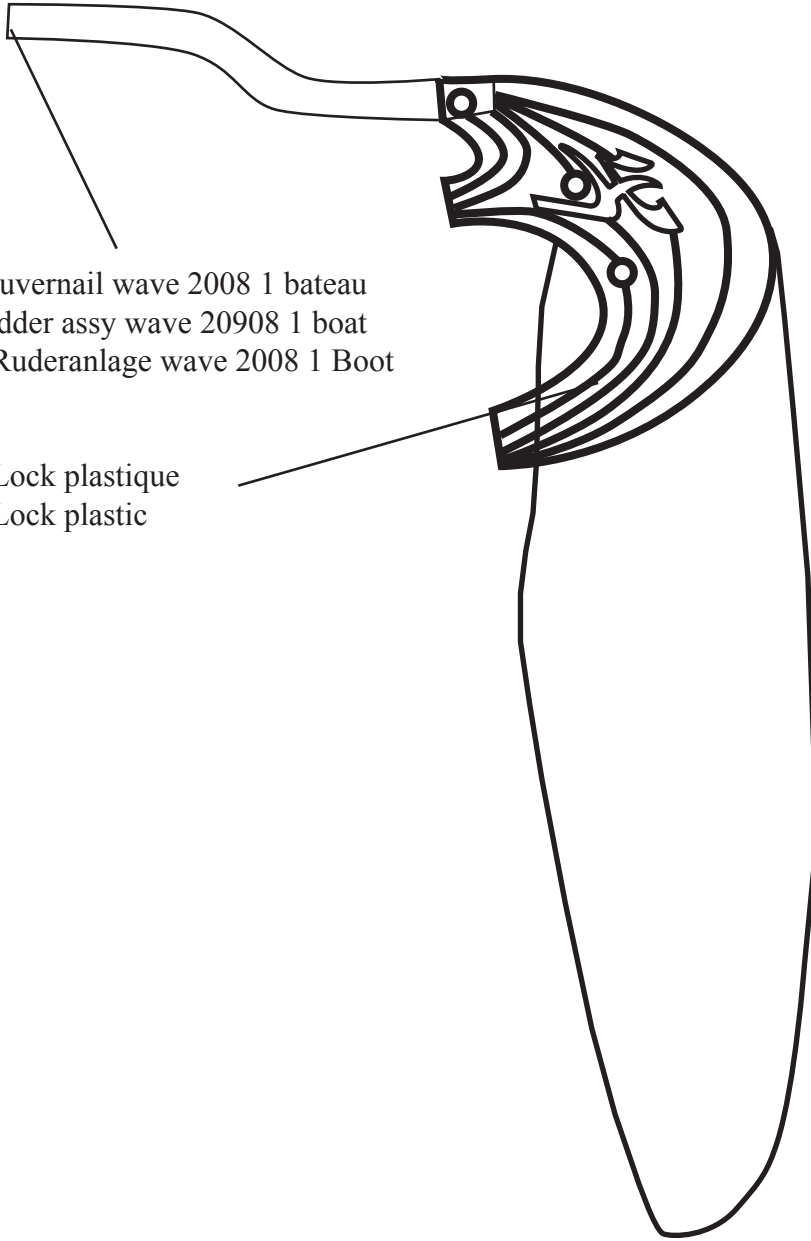

# HC WAVE Club

## Traverses/Crossbars/Holme

### TRAVERSE AVANT/FRONT CROSSBAR/VORDERHOLM

**99062610 (avant/prior/vor 2004)**

<p>1 - 14000025</p> <p>2 - 14041707 PKG 10</p> <p>3 - 16041755 PKG 10</p>	<p>Emplanture de mât Maststep Mastfusspfanne</p> <p>Coussinet Teflon Mast pivot bearing Teflonplättchen</p> <p>Axe + goupille Axe + cotter pin Achse + Sprengbolzen</p>
---	---

### 99062605 (2004)

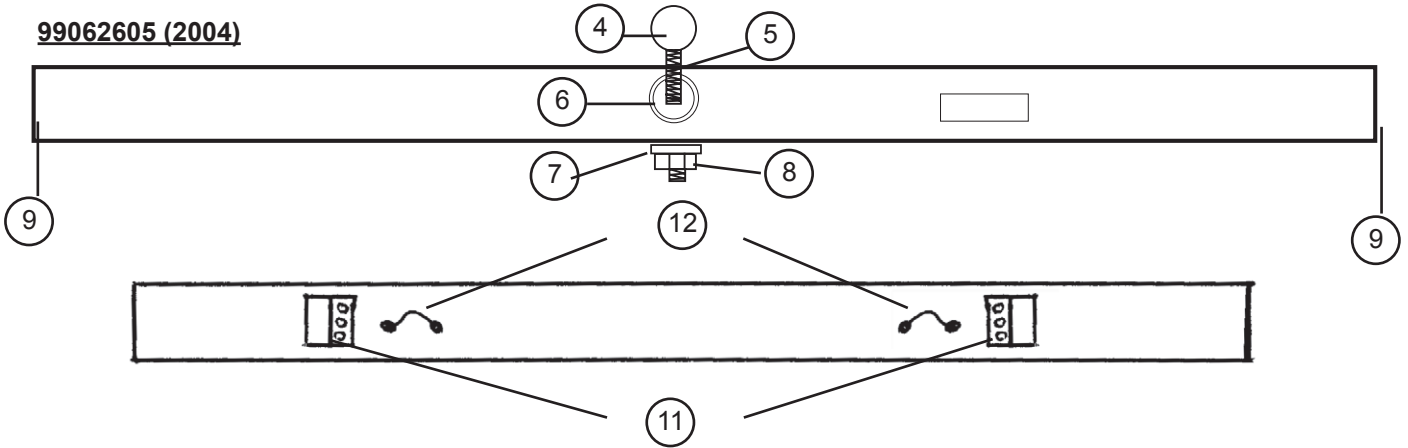

### TRAVERSE ARRIERE/REAR CROSSBAR/ACHTERHOLM : 99062615

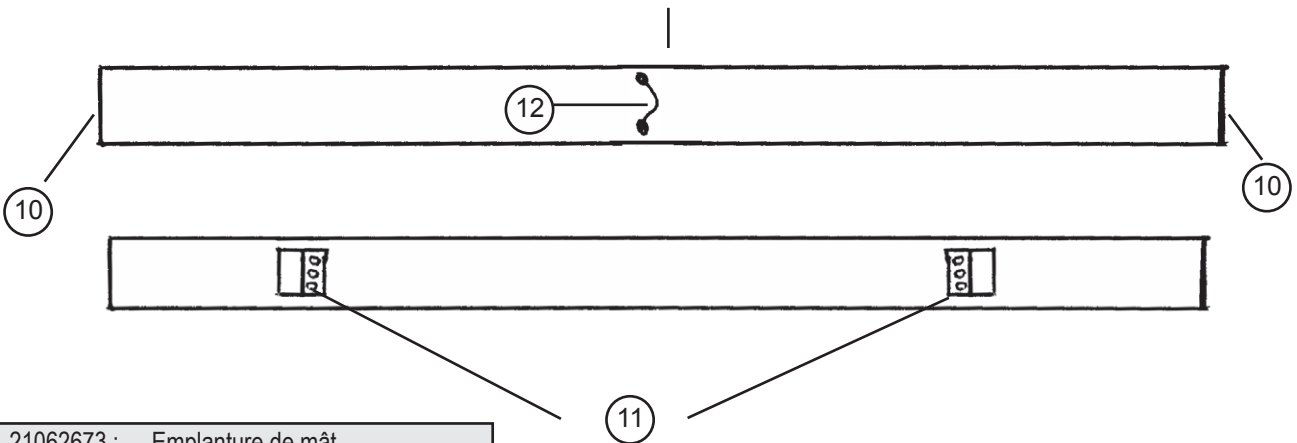

- |   |  |
|---|--|
| <p>4 - 21062673 :</p> <p>5 - 99219000 :</p> <p>6 - 99220104 :</p> <p>7 - 99220100 :</p> <p>8 - 99220110 :</p> | <p>Emplanture de mât<br/>Mast step ball<br/>Mastfussballe</p> <p>Tige filetée M16<br/>(mm)<br/>Mast step post<br/>Mastfuss</p> <p>Ecrou HU 16 mm<br/>Nut HU 16 mm<br/>Mutter HU 16 mm</p> <p>Rondelle inox 16 mm<br/>PKG 10<br/>Washer stainless steel<br/>Inox Scheibe</p> <p>Ecrou indessérable 16 mm<br/>Nylstop nut<br/>Selbstsichernde Mutter</p> |
|---|--|

- |   |   |
|---|---|
| <p>9 - 99056061</p> <p>10 - 99056062</p> <p>11 - 99056530</p> <p>12 - 99220215<br/>PKG 10</p> | <p>Bouchon traverse AV<br/>Front crossbar end cap<br/>Vorderholm-Endstück</p> <p>Bouchon de traverse AR<br/>Rear crossbar end cap<br/>Achterholm-Endstück</p> <p>Equerre d'arrêt traverse<br/>Crossbar stop plate<br/>Vorderholm-Arretierung</p> <p>Pontet<br/>Eyestrup<br/>Bügel</p> |
|---|---|

**2007**

## HC WAVE Club

Barre d'accouplement renforcée & Stick  
Tiller crossbar reinforced & Tiller extension  
Anlenkstange verstärkt & Pinengelenk

**BARRE ACCOUPLEMENT RENFORCEE COMPLETE/TILLER  
CROSSBAR REINFORCED COMPLETE/ANLENKSTANGE  
VERSTÄRKT KOMPLET = 99062260**

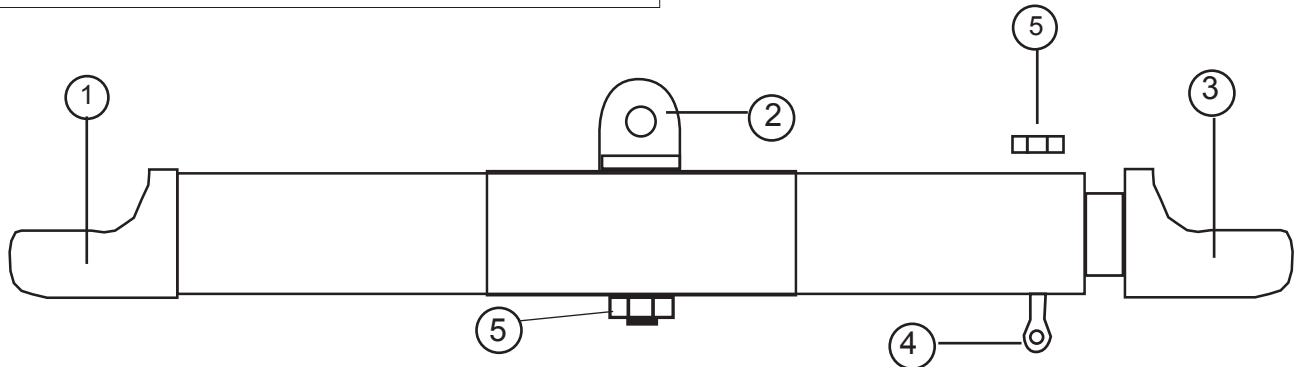

- |                         |  |
|-------------------------|--|
| 1 - 99000005:           | Embout à rotule<br>Tiller end cap<br>Pinnenendstück                  |
| 2 - 99221301:<br>PKG 4  | Vis violon<br>Violon screw<br>Schraube für Pinngelenk                |
| 3 - 99000010:           | Coulisseau réglable<br>Adjustable tiller end cap<br>Gleiter          |
| 4 - 99220010:<br>PKG 10 | Vis manillon<br>Tiller adjusting screw<br>Schraube                   |
| 5 - 99220012:<br>PKG 10 | Ecrou indessérable D8<br>Nylstop nut D8<br>Selbstsichernde Mutter D8 |

- |                          |   |
|--------------------------|---|
| 6 - 99500380:            | Kit d'articulation TCM<br>Tiller connector kit TCM<br>Verbindungsgelenk TCM |
| 7 - 99500331:            | Demi-pallier<br>Rubberspacer<br>Distanzhülse                                |
| 8 - 99220029:<br>PKG 20  | Demi-bille nylon<br>Half ball nylon<br>Nylon Halbkugel                      |
| 9 - 99500335:<br>PKG 10  | Ressort TCM<br>TCM spring<br>TCM-Feder                                      |
| 10 - 99220027:<br>PKG 10 | Vis TH 6 x 50<br>TH screw<br>TH Schraube                                    |
| 11 - 99220032:<br>PKG 10 | Rondelle inox<br>Stainless washer<br>Unterlegscheibe                        |
| 12 - 99220019:<br>PKG 10 | Ecrou indessérable D6<br>Nylstop nut D6<br>Selbstsichernde Mutter D6        |

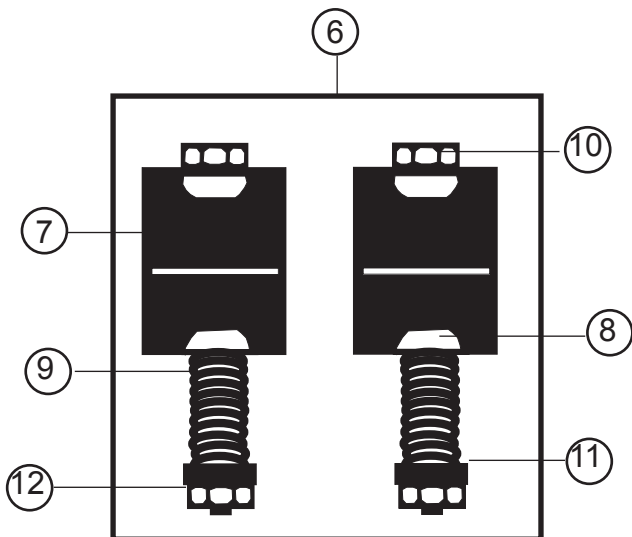

- |                          |   |
|--------------------------|---|
| 13 - 99062305 :          | Stick Alu<br>Aluminium tiller extension<br>Pinnenausleger Aluminium     |
| 14 - 14061315:<br>PKG 10 | Embout stick alu<br>Aluminium extension cap<br>Pinnenendstück Aluminium |
| 15 - 14061320 :<br>PKG 2 | Chape articulation stick<br>Stick articulation                          |



2008

## HC WAVE Club

Barre d'accouplement renforcée & Stick  
Tiller crossbar reinforced & Tiller extension  
Anlenkstange verstärkt & Pinengelenk

BARRE ACCOUPLEMENT RENFORCEE COMPLETE/TILLER  
CROSSBAR REINFORCED COMPLETE/ANLENKSTANGE  
VERSTÄRKT KOMPLET = 99062200

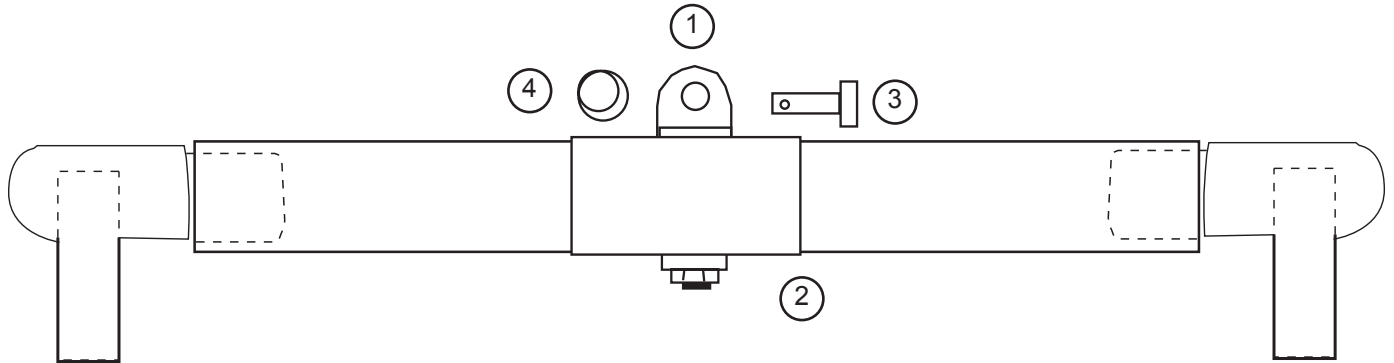

1 - 99221301: PKG 4	Vis violon Violon screw Schraube für Pinnengelenk
2 - 99220012: PKG 10	Ecrou indessérable D8 Nylstop nut D8 Siebtsichernde Mutter D8
3 - 14061240: PKG 10	Axe percé Clevis pin Bolzen
4 - 99220031: PKG 10	Anneau brisé Split ring Ring Splint
5 - 99062305 :	Stick Alu Aluminium tiller extension Pinnenausleger Aluminium
6 - 14061315: PKG 10	Embout stick alu Aluminium extension cap Pinnenendstück Aluminium
7 - 14061320 :	Chape articulation stick Stick articulation
8 - 12501395 :	Kit embout gouvernail Z
9 -	Embout Z barre d'accouplement



**HC WAVE Club**  
Mât/Mast/Mast

**Avant/Prior/Vor 2004**

Mât 1 pièce/1 piece Mast/Einteiliger Mast = **99042700**  
Mât 2 pièces/2-piece mast /Zweiteiliger Mast = **99042710**

Jeux de câbles HW/Cable set/Käbelsatz = **99070500**  
Sac d'accastillage/Rig bag/Takelagesack = **99080300**

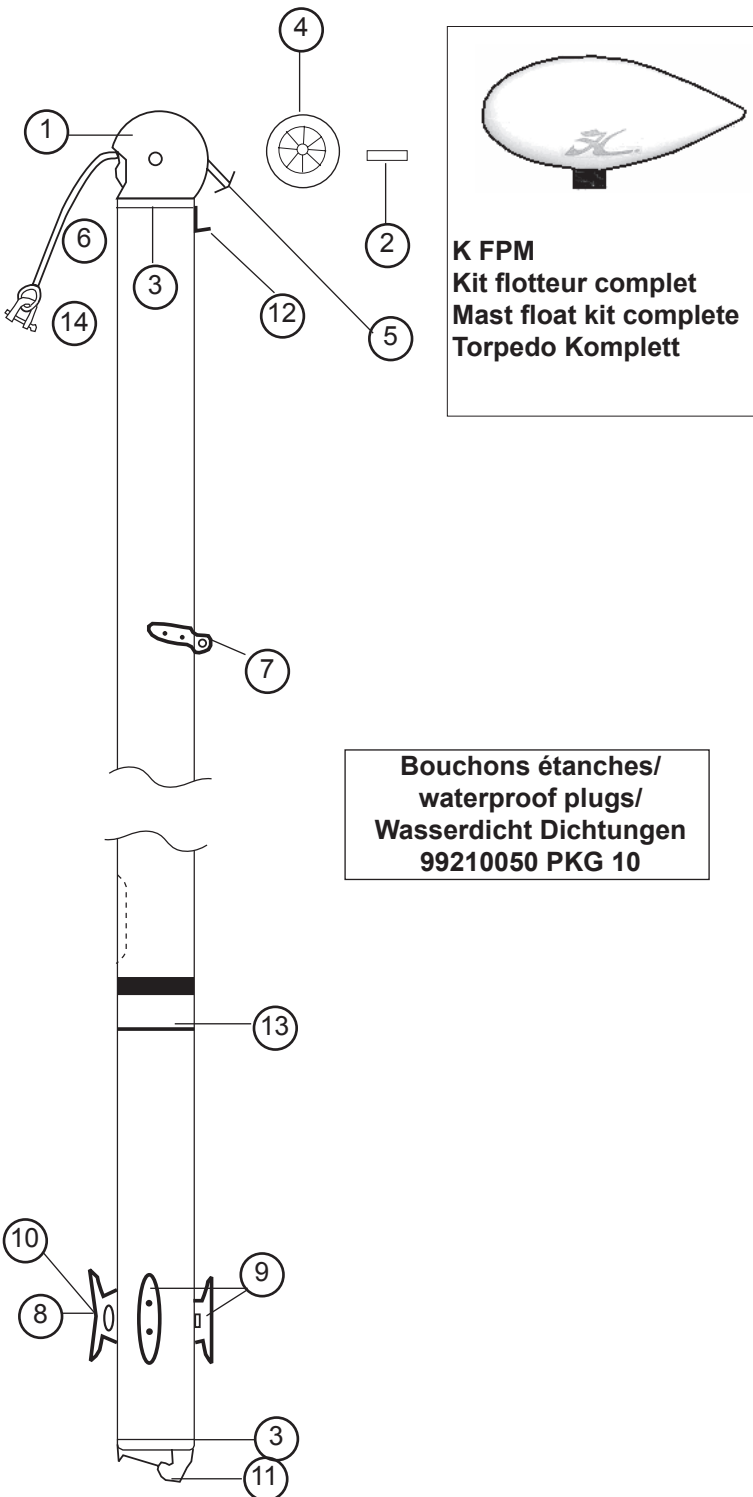

**K FPM**  
Kit flotteur complet  
Mast float kit complete  
Torpedo Komplet

**Bouchons étanches/  
waterproof plugs/  
Wasserdicht Dichtungen**  
99210050 PKG 10

- |     |            |   |
|-----|------------|---|
| 1-  | 14000015:  | Tête de mât noire<br>Black mast head<br>Mastkopf schwarz              |
| 2-  | 14041711:  | Axe tête de mât<br>Sheave pin mast head<br>Bolzen Mastkopf            |
| 3-  | 14042720:  | Sceau mât<br>Mast plug<br>Mast Abdichtung                             |
| 4-  | 14041712:  | Réa<br>Nylon sheave<br>Rolle  |
| 5-  | 13041751:  | Drisse câble GV<br>Main halyard wire<br>Grossfall Kabel               |
| 6-  | 14070460:  | Drisse cordage<br>Halyard rope<br>Fall                                |
| 7-  | 14041722:  | Ferrure capelage<br>Mast tang<br>Mastbeschlag                         |
| 8-  | 14041715 : | Taquet étarq amure<br>PKG 10<br>Downhall cleat<br>Klampe              |
| 9-  | 99220050 : | Taquet de drisse<br>PKG 10<br>Halyard Cleat<br>Niederholer Mastklemme |
| 10- | 99220051 : | Vis taquet<br>PKG 10<br>Screw<br>Schraube                             |
|     | 99220325   | Ecrou carré amure<br>Tack square nut<br>Viereckmutter                 |
| 11- | 14000020 : | Base mât noire<br>Black mast base<br>Mastfuss schwarz                 |
| 12- | 14041721 : | Hook de drisse<br>Halyard hook<br>Fallhaken                           |
| 13- | 14041723:  | Autocollant de sécurité<br>Mast caution label<br>Sicherheitsaufkleber |
| 14- | 99220035 : | Manille 6 mm<br>PKG 10<br>Shackle 5 mm<br>Schäkel 6 mm                |



# HC WAVE Club Mât/Mast/Mast

2004

Mât 1 pièce/1 piece Mast/Einteiliger Mast = **99042705**  
Mât 2 pièces/2-piece mast /Zweiteiliger Mast = **99042715**

Jeux de câbles HW/Cable set/Käbelsatz = **99070502**  
Sac d'accastillage/Rig bag/Takelagesack = **99080300**

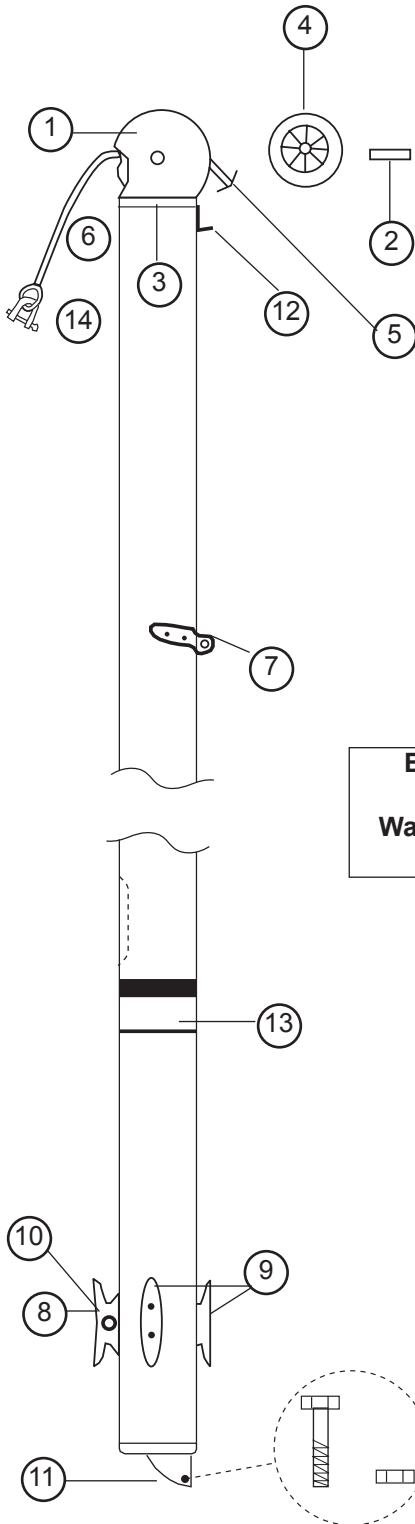

**Bouchons étanches/  
waterproof plugs/  
Wasserdicht Dichtungen  
99210050 PKG 10**

- |                |   |
|----------------|---|
| 1- 14000015:   | Tête de mât noire<br>Black mast head<br>Mastkopf schwarz              |
| 2- 14041711:   | Axe tête de mât<br>Sheave pin mast head<br>Bolzen Mastkopf            |
| 3- 14042720:   | Sceau mât<br>Mast plug<br>Mast Abdichtung                             |
| 4- 14041712:   | Réa<br>Nylon sheave<br>Rolle  |
| 5- 13041751:   | Drisse câble GV<br>Main halyard wire<br>Grossfall Kabel               |
| 6- 14070460:   | Drisse cordage<br>Halyard rope<br>Fall                                |
| 7- 14041722:   | Ferrure capelage<br>Mast tang<br>Mastbeschlag                         |
| 8- 14041715 :  | Taquet étarq amure<br>PKG 10 Downhall cleat<br>Klampe                 |
| 9- 99220050 :  | Taquet de drisse<br>PKG 10 Halyard Cleat<br>Niederholer Mastklemme    |
| 10-99220051 :  | Vis taquet<br>PKG 10 Screw<br>Schraube                                |
|                | 99220325 Ecrou carré amure<br>Tack square nut<br>Viereckmutter        |
| 11- 13600010 : | Base mât 2004<br>Mast base 2004<br>Mastfuss 2004                      |
| 12- 14041721 : | Hook de drisse<br>Halyard hook<br>Fallhaken                           |
| 13- 14041723:  | Autocollant de sécurité<br>Mast caution label<br>Sicherheitsaufkleber |
| 14- 99220035 : | Manille 6 mm<br>PKG 10 Shackle 6 mm<br>Schäkel 6 mm                   |

# HC WAVE Club

## Haubans/Shrouds/Wanten

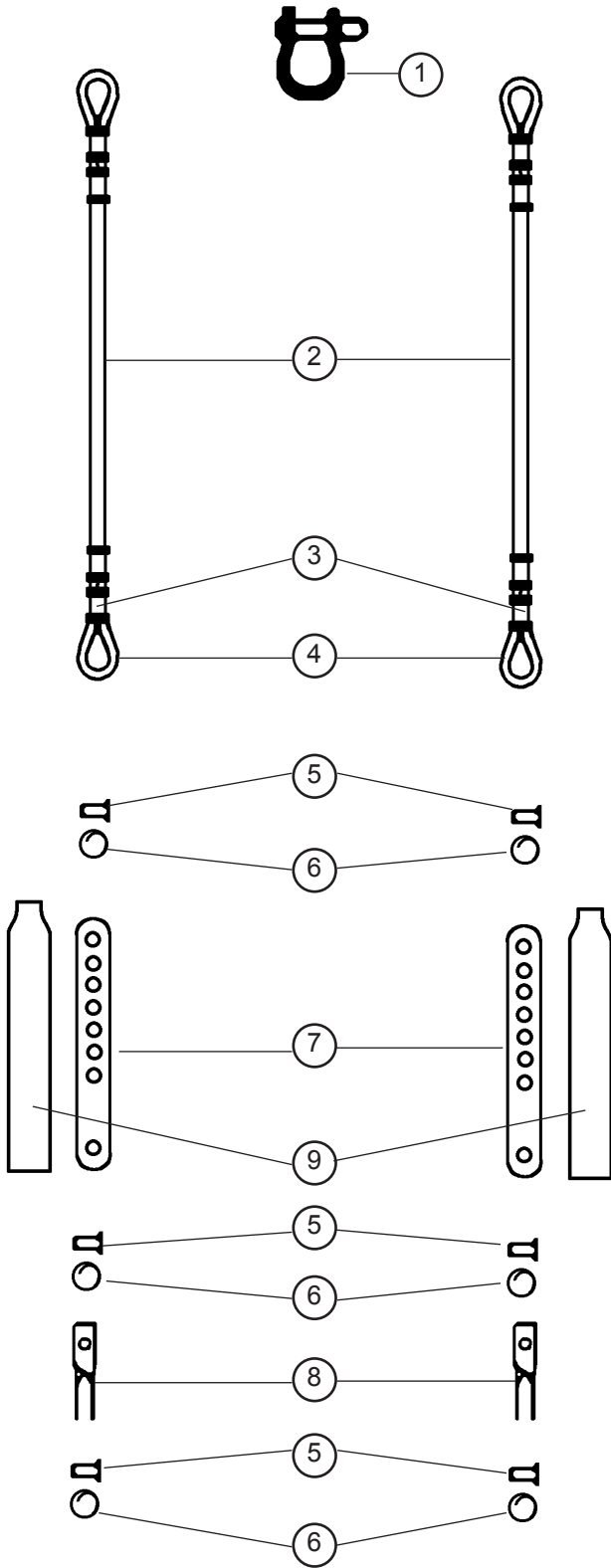

1-99220058: PKG 10	Manille Lyre 8mm Shackle 8 mm Mastschäkel 8 mm
2- 99060515 (2003): 99060520 (2004)	Hauban Shroud Want
3- 99300140: PKG 10	Manchon D4 Sleeve Hülse
4- 99300053: PKG 10	Cosse std Thimble Kausch Std
5- 99220034: PKG 10	Axe percé lat.ridoir Clevis pin Bolzen für Wanteisen
6- 99220031: PKG 10	Anneau brisé Split ring Ringsplint
7- 99220033: PKG 5	Latte universelle ridoir Stay adjuster Wanteisen
8- 16060312: PKG 10	Chape de hauban Toggle Wanten Toggle
9- 99500360: PKG 10	Protège lattes ridoires Shroud adjuster cover Wantenschutz

# HC WAVE Club

Etai & brides/Forestay and bridles/Vorstag und Hahnepot

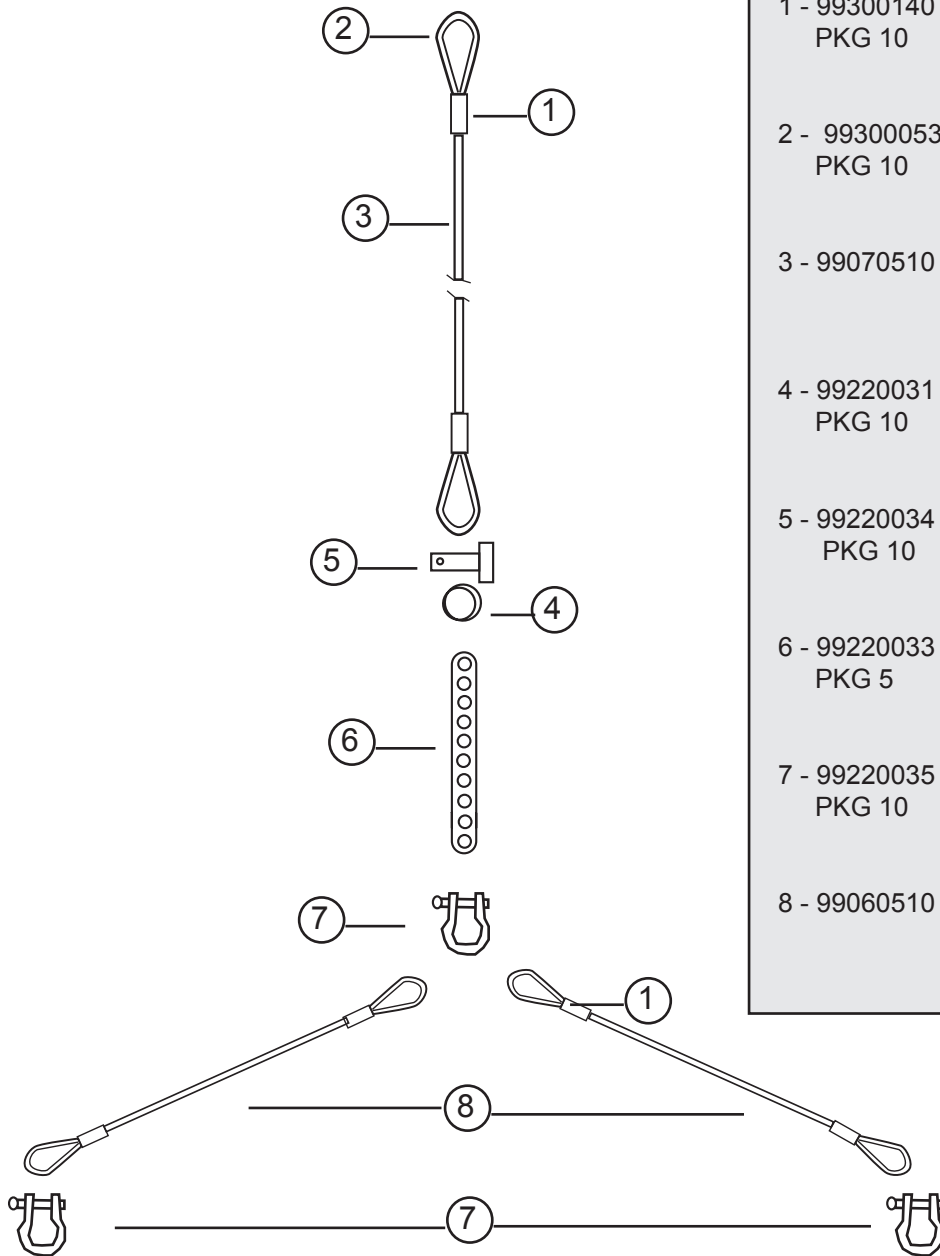

- |                |                                    |
|----------------|------------------------------------|
| 1 - 99300140 : | Manchon D4                         |
| PKG 10         | Sleeve<br>Hülse                    |
| 2 - 99300053 : | Cosse std                          |
| PKG 10         | Thimble<br>Kausch Std              |
| 3 - 99070510 : | Etai cable                         |
|                | Forestay<br>Vorstag Kabel          |
| 4 - 99220031 : | Anneau brisé                       |
| PKG 10         | Split ring<br>Ringsplint           |
| 5 - 99220034 : | Axe percé                          |
| PKG 10         | Clevis pin<br>Bolzen für Locheisen |
| 6 - 99220033 : | Latte universelle                  |
| PKG 5          | Stay adjuster<br>Locheisen         |
| 7 - 99220035 : | Manille lyre 6 mm                  |
| PKG 10         | Shackle 6 mm<br>Schäkel 6 mm       |
| 8 - 99060510 : | Bride                              |
|                | Bridle<br>Hahnepot                 |

**HC WAVE Club**  
Trampoline/Trampoline/Trampolin

Avant/Front/Vorder

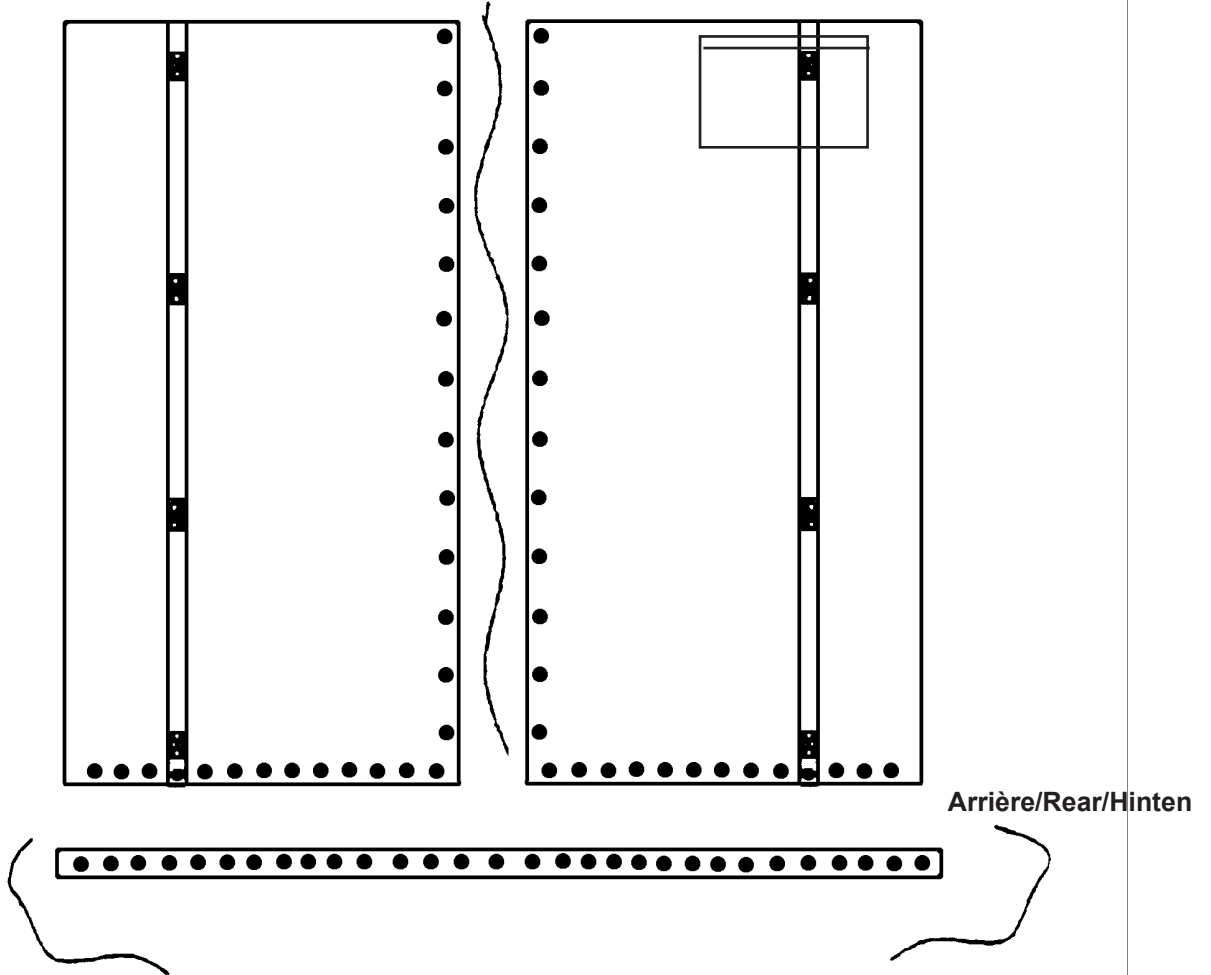

TRAMPOLIN 3 PIECES/3 PIECE TRAMPOLINE/3TEILIGER TRAMPOLIN

99025005      blanc/white/weiss  
99025215      Bleu/blue/blau

**HC WAVE Club**  
Grand-voile/Main sail/Gross-Segel

16990001	Grand-voile HC Wave blanche HC Wave white mainsail HC Wave Großsegel weiß
16990002	Grand-voile HC Wave couleur HC Wave coloured mainsail HC Wave Großsegel farbig
99034010	Jeu de lattes HC Wave HC Wave batten set HC Wave - Lattensatz
99070400	Sac de cordage GV + trampoline Rope bag mainsail and trampoline Linetasche für Großsegel u. trampoline

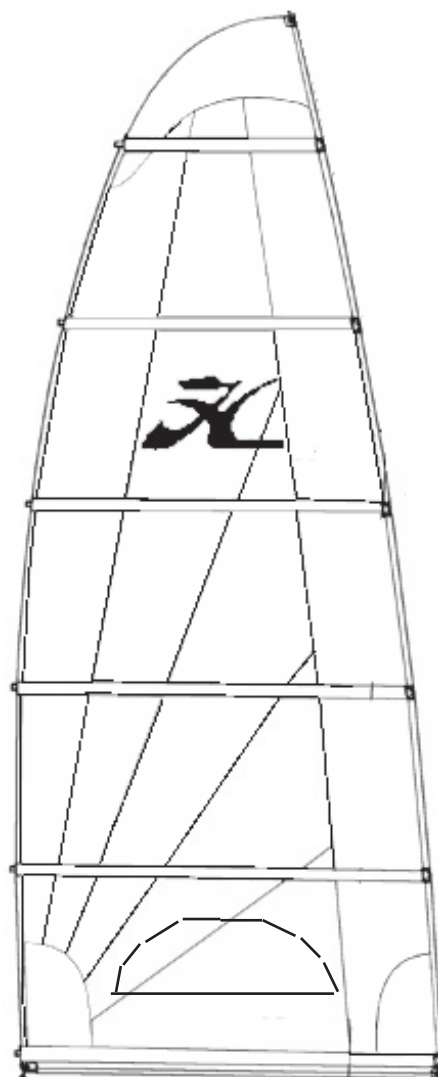

**HC WAVE Club**  
Poulies/Main blocks/Blöcke

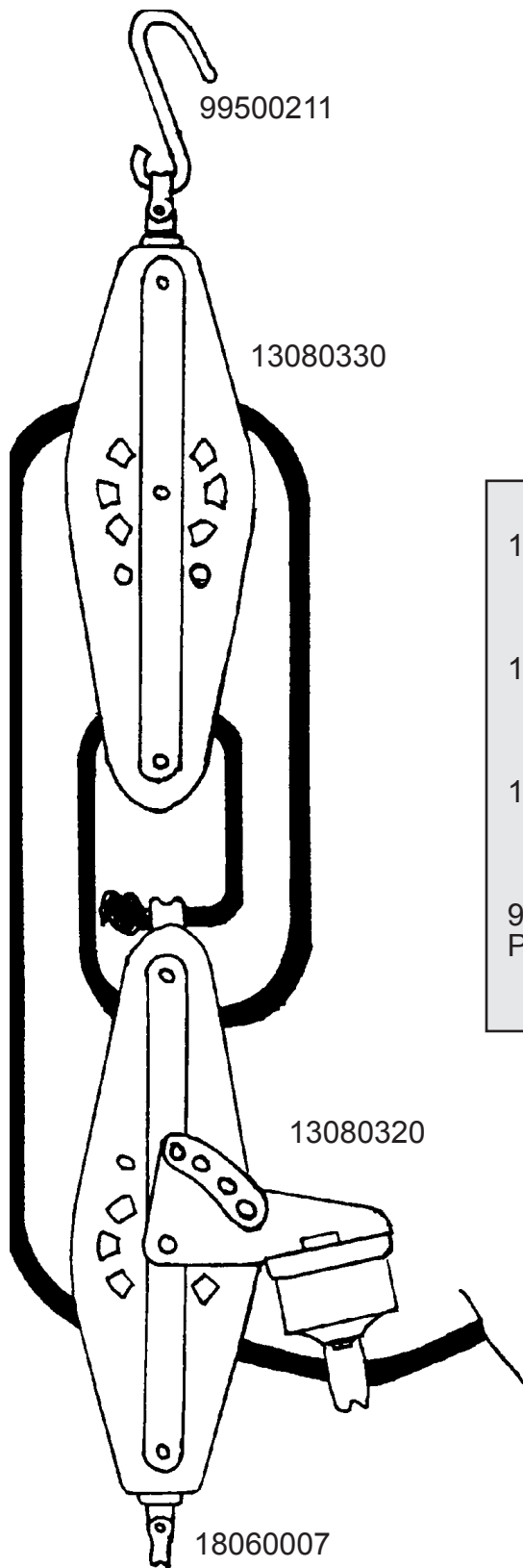

13080320	Poulie grand voile avec taquet Main block with cam cleat Block Gross-Segel mit Klemme
13080330	Poulie grand voile avec émerillon Main block with swivel Block Gross-Segel mit Wirbel
18060007	Manille de poulie Block shackle Blockschäkel
99500210 PKG 2	Crochet grand voile Main hook Großsegel Haken

# HC WAVE club Turbo

Kit de foc - Jib Kit - Fockkit

99600045

- |                |   |
|----------------|---|
| 1 - 99300140 : | Manchon D4  |
| PKG 10         | Sleeve<br>Hülse   |
| 2 - 99300053 : | Cosse std   |
| PKG 10         | Thimble<br>Kausch Std                                       |
| 3 - 99070520   | Estrope<br>Pigtail<br>Pigtail                               |
| 4 - 18042710 : | Manille longue  |
| PKG 5          | Long shackle<br>Länge Schäkel                               |
| 5 - 99500250 : | Poulie drisse de foc  |
|                | Jib halyard block<br>Fockfallumlenblock                     |
| 6 - 99220036 : | Manille lyre 4 mm   |
| PKG 10         | Shackle 4 mm<br>Schäkel 4 mm                                |
| 7 - 99080010 : | Tourelle de foc gauche + support                            |
|                | Jib block +plate left<br>Fockschotsblock mit Platte links   |
| 99080015 :     | Tourelle de foc droite+ support                             |
|                | Jib block +plate right<br>Fockschotsblock mit Platte rechts |

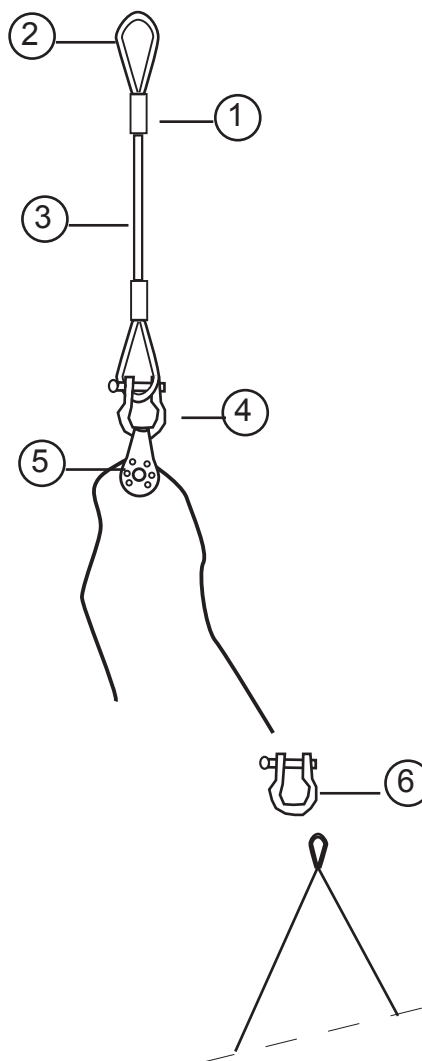

- 16990005 : Foc blanc/White jib/Fock weiss  
16990010 : Foc couleur/Coloured jib/Fock farbig

sur les coques/on the hulls/auf der Rumpfe

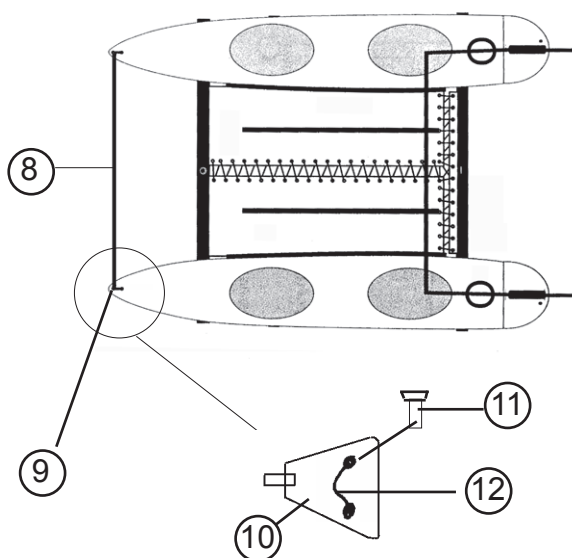
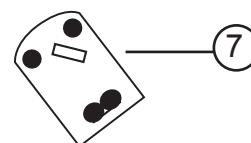

- |               |  |
|---------------|--|
| 8 - 99062320  | Barre de maintien parallèle                              |
|               | Parallel bow spreader bar<br>Holm Turbo                  |
| 9 - 99062330  | Embout barre de maintien                                 |
|               | Parallel bar end cap<br>Turbo Holm-Endstück              |
| 10 - 99056520 | Platine barre de maintien                                |
|               | Plate for parallel bow spreader bar<br>Platte Holm Turbo |
| 11 - 99220145 | vis platine  |
| PKG 10        | plate screw<br>Platte-Schraube                           |
| 12 - 99220216 | Pontet   |
| PKG 5         | Eyestay<br>Bügel   |